

*REF-100yct
 *REF-pfyct
 *REF-pfyct2
 *REF-pfyct3

F.A. RTE.	SECTION	COUNTY	TOTAL SHEETS	SHEET NO.
*	2004-025 RS	LAKE	116	30
STA.	TO STA.			
FED. ROAD DIST. NO.	ILLINOIS	FED. AID PROJECT		
* PARK ROADS		CONTRACT NO. 62745	IDNR FILE NO. 2-03-025	

EXIST. CURVE E-YAHT-1
 PI STA. = 8+69.25
 $\Delta = 89^\circ 59' 53''$ (RT)
 $D = 121^\circ 54' 21''$
 $R = 47.00'$
 $T = 47.00'$
 $L = 73.83'$
 $E = 19.47'$
 $\theta = \dots$
 T.P. = \dots
 S.E. RUN = \dots
 P.C. STA. = 8+22.25
 P.T. STA. = 8+96.08

EXIST. CURVE E-YAHT-2
 PI STA. = 10+59.07
 $\Delta = 90^\circ 00' 09''$ (RT)
 $D = 121^\circ 54' 21''$
 $R = 47.00'$
 $T = 47.00'$
 $L = 73.83'$
 $E = 19.47'$
 $\theta = \dots$
 T.P. = \dots
 S.E. RUN = \dots
 P.C. STA. = 10+12.07
 P.T. STA. = 10+85.90

EXIST. CURVE E-YAHT-3
 PI STA. = 18+61.16
 $\Delta = 90^\circ 00' 06''$ (RT)
 $D = 121^\circ 54' 21''$
 $R = 47.00'$
 $T = 47.00'$
 $L = 73.83'$
 $E = 19.47'$
 $\theta = \dots$
 T.P. = \dots
 S.E. RUN = \dots
 P.C. STA. = 18+14.16
 P.T. STA. = 18+87.99

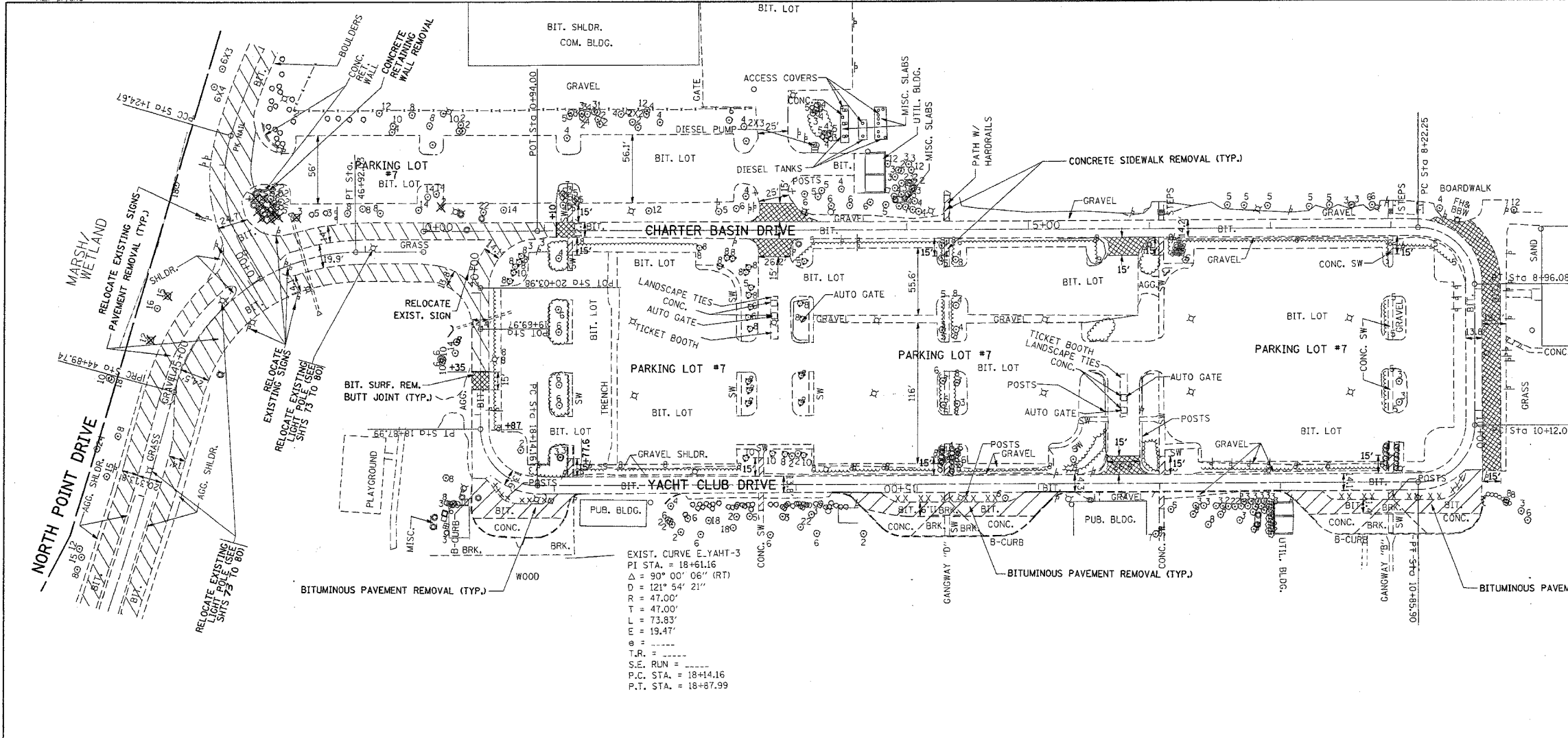

PLAN	SURVEYED	DATE
	NOTED	
	BY	

PROFILE	SURVEYED	DATE
	NOTED	
	BY	

595	EXIST. PROF. CHAIN "YACHTCLUB DR. (FORMERLY CLB2)" (PARKING LOT S.E.)															595	
590	EXIST. PROF. CHAIN "YACHTCLUB DR. (FORMERLY CLB2)" (PARKING LOT S.E.)															590	
585	EXIST. PROF. CHAIN "YACHTCLUB DR. (FORMERLY CLB2)" (PARKING LOT S.E.)															585	
	EXISTING PROFILE																
	0+00	1+00	2+00	3+00	4+00	5+00	6+00	7+00	8+00	9+00	10+00	11+00					
590	EXIST. PROF. CHAIN "YACHTCLUB DR. (FORMERLY CLB2)" (PARKING LOT S.E.)															590	
585	EXIST. PROF. CHAIN "YACHTCLUB DR. (FORMERLY CLB2)" (PARKING LOT S.E.)															585	
580	EXISTING PROFILE CONT'D															580	
	589.52	589.63	589.68	589.58	589.62	589.61	589.60	589.59	590.40								
	11+00	12+00	13+00	14+00	15+00	16+00	17+00	18+00	19+00								

EXIST. ROADWAY PLAN
 NORTH POINT MARINA
 YACHT CLUB DR.
 SCALE: VERT. 5 DRAWN BY: CAD
 HORIZ. 50 DATE: 1/24/2006