

REF-1067TH  
REF-p7TH

F.A. RTE.	SECTION	COUNTY	TOTAL SHEETS	SHEET NO.
*	2004-025 RS	LAKE	116	34
STA. 23+61.92		TO STA. 37+00		
FED. ROAD DIST. NO.		ILLINOIS FED. AID PROJECT		
* PARK ROADS		CONTRACT NO. 62745		
IDNR FILE NO. 2-03-025				

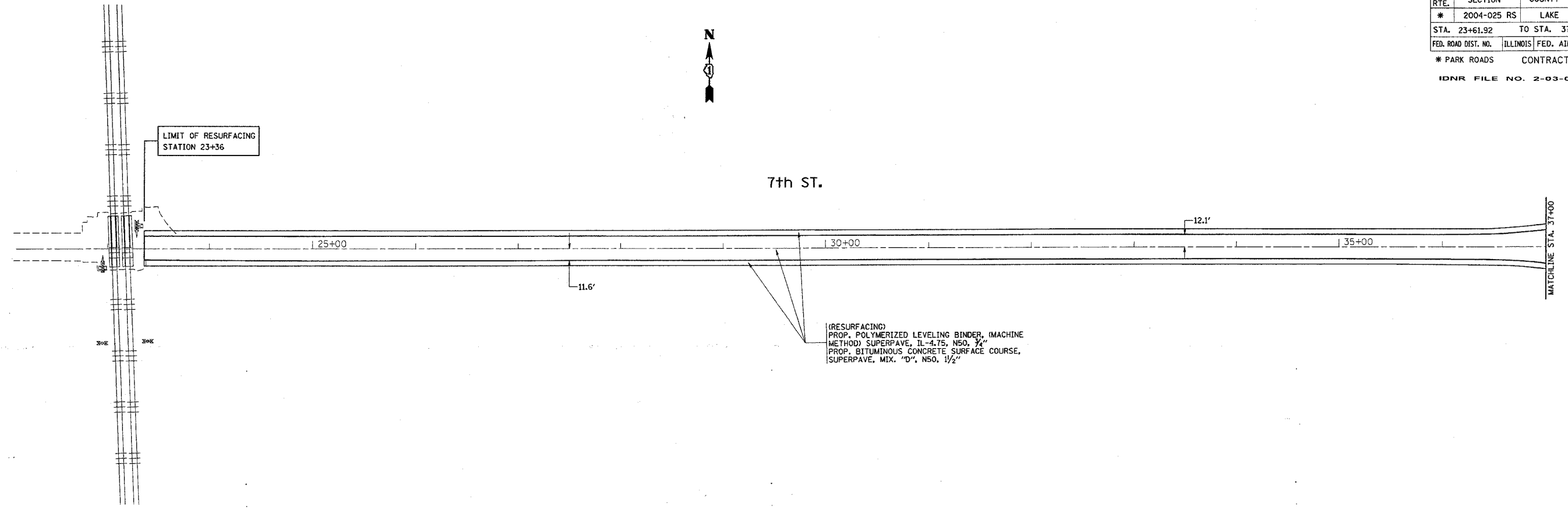

(RESURFACING)  
PROP. POLYMERIZED LEVELING BINDER, (MACHINE METHOD) SUPERPAVE, IL-4.75, N50, 3/4"  
PROP. BITUMINOUS CONCRETE SURFACE COURSE, SUPERPAVE, MIX. "D", N50, 1/2"

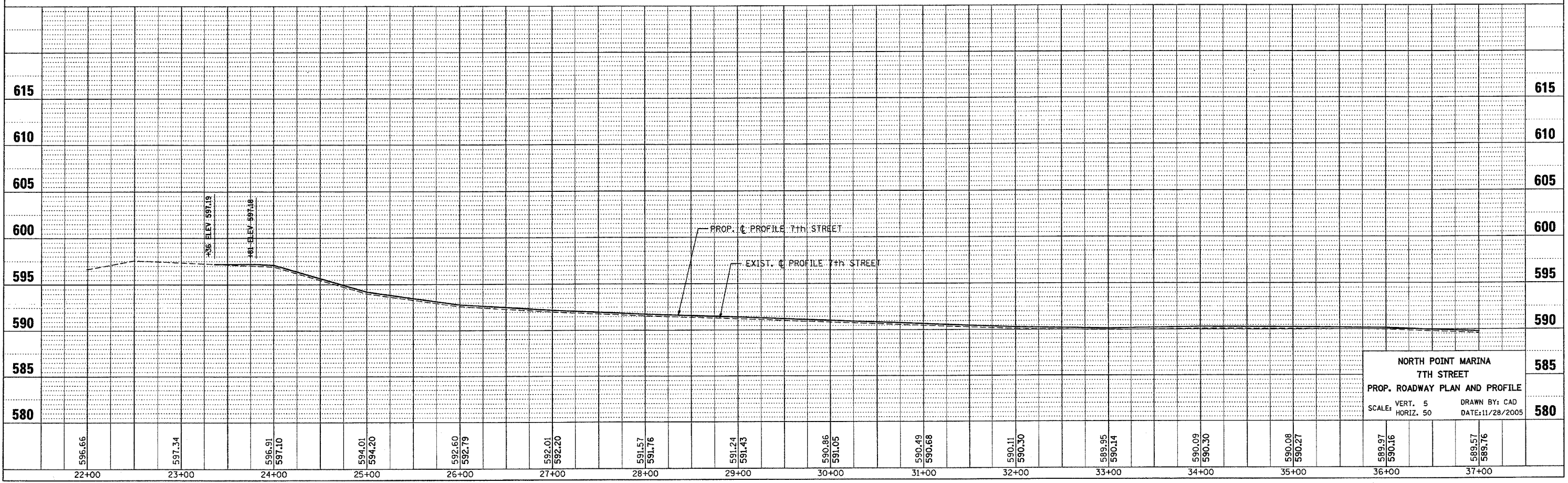

NORTH POINT MARINA  
7TH STREET  
PROP. ROADWAY PLAN AND PROFILE  
SCALE: VERT. 5  
HORIZ. 50  
DRAWN BY: CAD  
DATE: 11/28/2005