

STATE OF ILLINOIS
DEPARTMENT OF TRANSPORTATION

ROUTE NO. FAP 301	SECTION 28BR-1	COUNTY JO DAVIESS	SHEET NO. 53	SHEET NO. 14	SHEET NO. 6 27 SHEETS
FED. ROAD DIST. NO. 7		ILLINOIS	FED. AID PROJECT		

Contract # 64A49

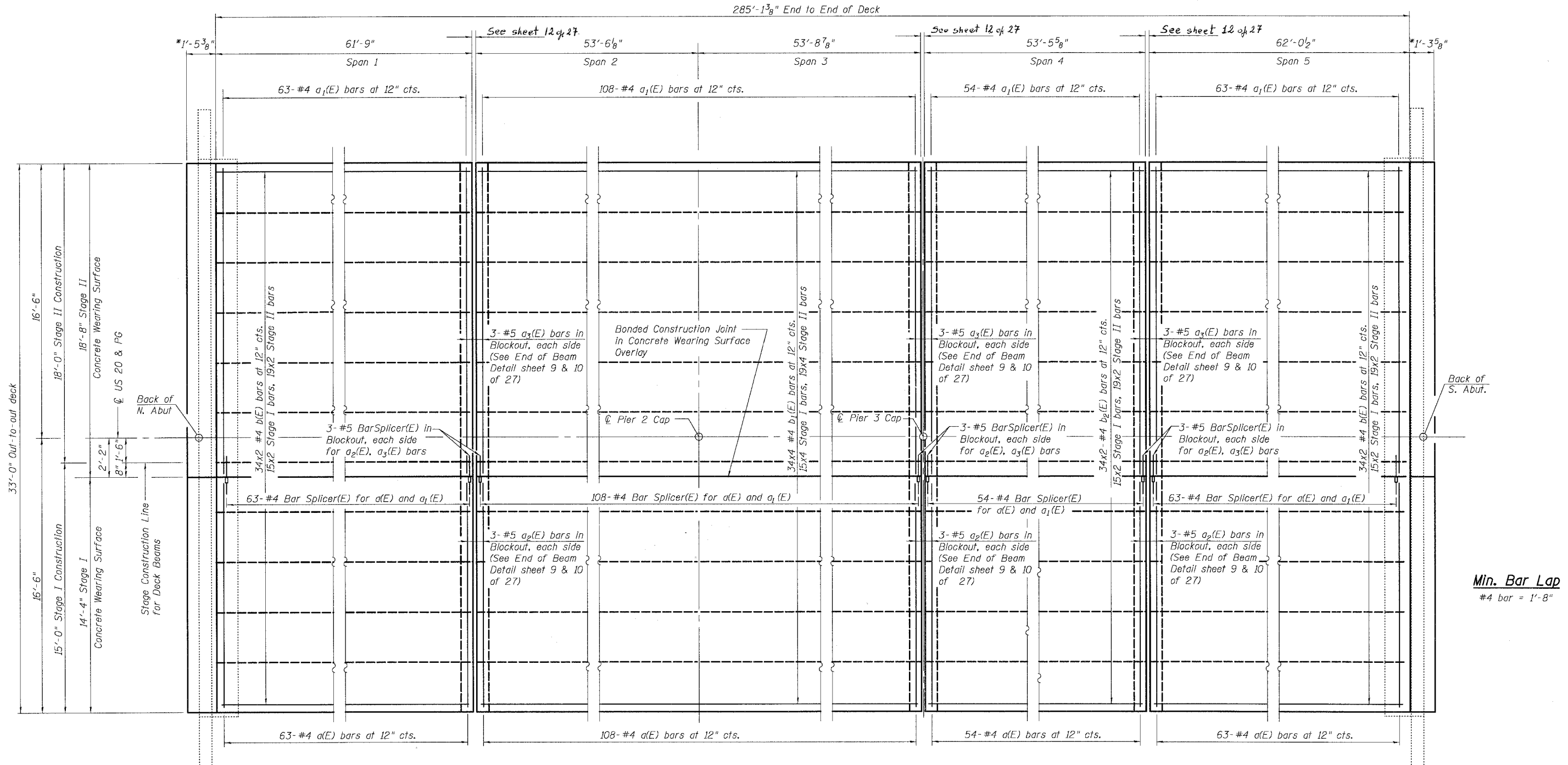
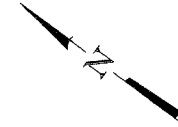

Min. Bar Lap
#4 bar = 1'-8"

PLAN

DESIGNED	MO
CHECKED	CB
DRAWN	RG
CHECKED	DF

Notes:
For remainder of superstructure details, see sheets 7 thru 10 of 27.
Reinforcement bars designated (E) shall be epoxy coated.
Bars indicated thus 34x2 - #4 etc. indicates 34 lines of bars with 2 length per line.
*Concrete to be poured after beams & concrete wearing surface are in place. See Section thru Abutment on Sheet 7 of 27.

SUPERSTRUCTURE
U.S. 20 OVER APPLE RIVER
F.A.P. ROUTE 301 - SEC. 28BR-1
JO DAVIESS COUNTY
STATION 1434+57.61
S.N. 043-0010