

GENERAL NOTES

- Contract #64001
- All new structural steel shall conform to AASHTO Classification M-270 Gr. 36, unless otherwise noted.
 - All new fasteners shall be high strength bolts. Holes shall be subpunched or subdrilled $\frac{1}{16}$ " dia. and reamed in the field to $\frac{3}{16}$ " dia. for $\frac{3}{4}$ " dia. bolts, unless otherwise noted. Holes shall be subpunched and subdrilled $\frac{13}{16}$ " dia. and reamed in the field to $\frac{15}{16}$ " dia. for $\frac{1}{2}$ " dia. bolts, unless otherwise noted.
 - Plan dimensions and details relative to existing structure have been taken from existing plans and are subject to nominal construction variations. It shall be the Contractor's responsibility to verify such dimensions and details in the field and make necessary approved adjustments prior to construction or ordering materials. Such variations shall not be cause for additional compensation for a change in the scope of the work, however, the Contractor will be paid for the quantity actually furnished at the unit price bid for the work.
 - Reinforcement bars shall conform to the requirements of AASHTO M-31, or M-322 Grade 60.
 - Finger Plate Expansion Joints shall be assembled in the proper position with the ends in place and shall be left assembled for shop inspection.
 - The finger plates shall be flame cut as provided in Article 505.04(k) of the Standard Specifications.
 - Existing structural steel shall only be cleaned and painted as required by the Special Provisions "Cleaning and Painting Contact Surface Areas of Existing Steel Structures".
 - Tapered shims shall be added under the stools, as required by the Engineer, to make a smooth finger joint. Cost shall be included with Furnishing and Erecting Structural Steel.
 - Cost of removal and/or re-installation of all members necessary to complete the work as detailed on the plans and as specified in the Special Provisions shall be included in the cost of Furnishing and Erecting Structural Steel.
 - All structural steel shall be shop painted with the inorganic zinc rich primer per AASHTO M300, Type I. Cost included with Furnishing and Erecting Structural Steel.
 - Calculated weight of new structural steel = 37,520 Pounds (M-270 Gr. 36).
14,700 Pounds (M-270 Gr. 50).
 - Joint openings shall be adjusted according to Article 503.10(g) of the Std. Spec's. when the deck is poured at an ambient temperature other than 50° F.
 - Prior to pouring the new concrete deck or placing the new finger plates, all loose rust, loose mill scale and other loose potentially detrimental foreign matter shall be removed from the surfaces of the beams or girders in contact with concrete. The cost of this work will be included in the pay item covering removal of the existing concrete. All heavy rust and other tightly adhered potentially detrimental foreign matter shall also be removed from the surfaces of the beams or girders in contact with concrete. Tightly adhered paint may remain unless otherwise noted. This removal shall be accomplished by methods that will not damage the steel. The cost of this work will be paid for according to Article 109.04 of The Standard Specifications.
 - The "Concrete Superstructure" shall be self-consolidating concrete. See Special Provisions for "Self-Consolidating Concrete for Cast-in-place Construction".
 - All Construction Joints shall be bonded.

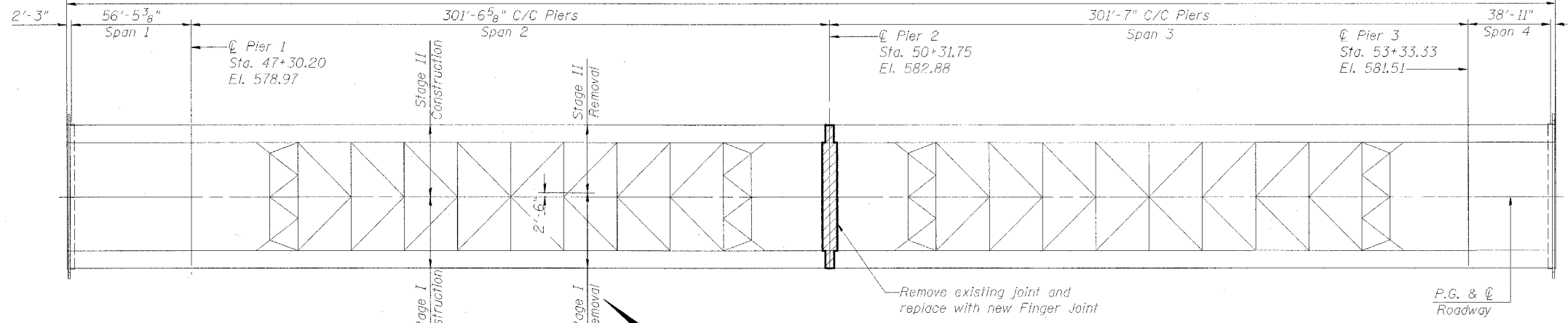
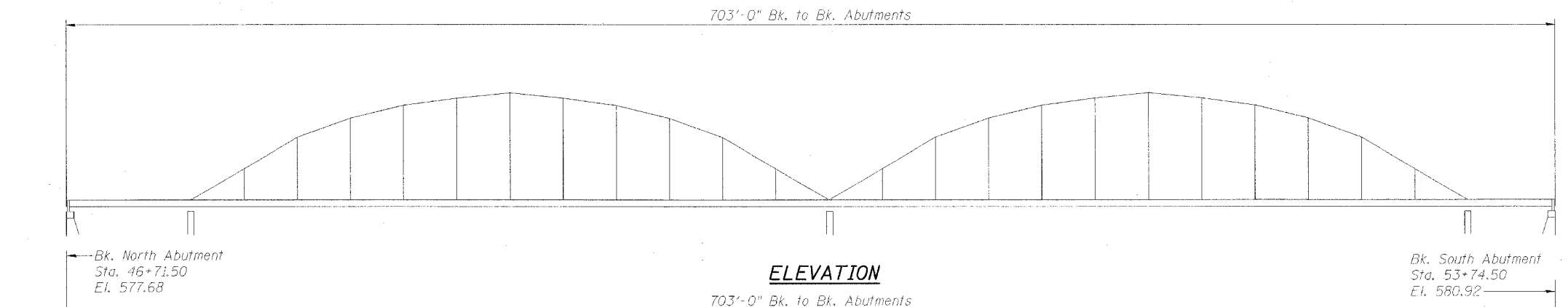

DESIGN STRESSES

NEW CONSTRUCTION

$f_c = 3,500$ psi
 $f_y = 60,000$ psi (reinforcement)
 $F_y = 50,000$ psi Structural Steel M270 Grade 50
 $F_y = 36,000$ psi Structural Steel M270 Grade 36

TOTAL BILL OF MATERIAL

ITEM	UNIT	QUANTITY
Concrete Removal	Cu. Yd.	10.5
Concrete Superstructure	Cu. Yd.	9.7
Reinforcement Bars, Epoxy Coated	Pound	1,510
Furnishing and Erecting Structural Steel	Pound	52,220
Mechanical Splice	Each	136
Fabric Reinforced Elastomeric Trough	Foot	69
Protective Coat	Sq. Yd.	29

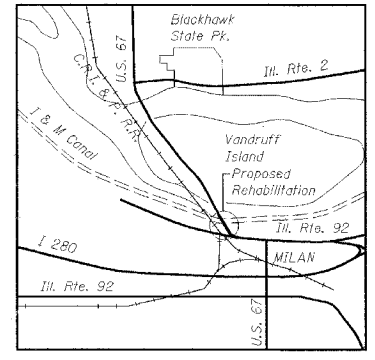
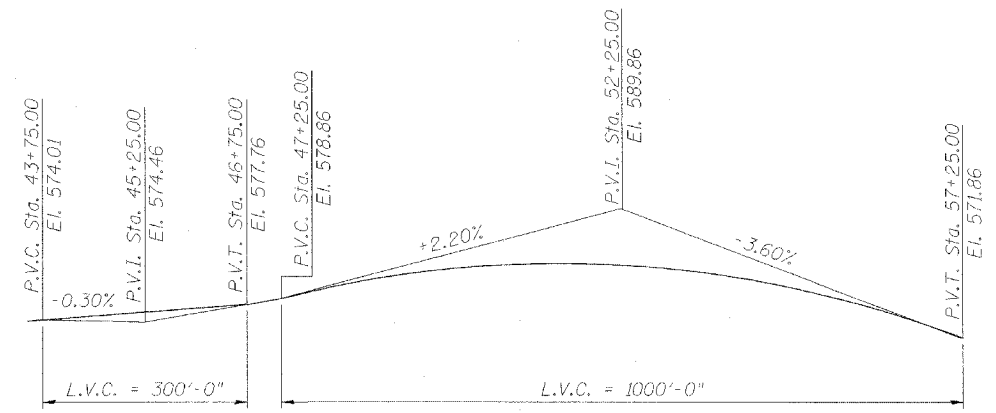

GENERAL PLAN AND ELEVATION

F.A. RT. 599 (US 67 OVER ROCK RIVER SOUTH CHANNEL AND ILLINOIS AND MISSISSIPPI CANAL) ROCK ISLAND COUNTY STATION 50+23.00 STRUCTURE NO. 081-0040



Majid Mobassehi
 Structural Engineer
 Clark Dietz, Inc.

DATE: 2-24-2006
 License Expires 11-30-2006

REVISIONS	
NAME	DATE

Clark Dietz

CHAMPAIGN, ILLINOIS
 CHICAGO, ILLINOIS
 EVANSVILLE, INDIANA
 INDIANAPOLIS, INDIANA
 KENOSHA, WISCONSIN
 SPRING GREEN, WISCONSIN

NOTE: DIMENSIONAL DATA IS NOT TO BE OBTAINED BY SCALING ANY PORTION OF THIS DRAWING.

DESIGNED BY: M.M. PROJECT NO: 102303
 DRAWN BY: MEW DATE: 1/06
 CHECKED BY: M.M.
 APPROVED BY: M.M.
 ACTIVITY: DETAILS

DRAWING NUMBER: **S-1**