

F.A.S. RTE.	SECTION	COUNTY	TOTAL SHEETS	SHEET NO.
1517(2)RS-3	(3)RS-4	MCLEAN	223	45
STA. _____ TO STA. _____		FED. ROAD DIST. NO. _____ ILLINOIS FED. AID PROJECT		

66383

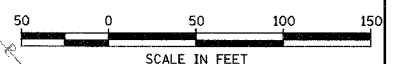

STONE DUMPED RIPRAP:  
 1. ADJACENT TO THE STRUCTURE, ERODED BANKS OF LITTLE KICKAPOO SHALL GRADED TO RESTORE CHANNEL SHAPE.  
 2. EXACT LOCATION FOR RIPRAP PLACEMENT SHALL BE DETERMINED BY THE ENGINEER.

PLAN	DATE
BY	
DATE	
BY	
DATE	
BY	
DATE	
BY	
DATE	

PROFILE	DATE
BY	
DATE	
BY	
DATE	
BY	
DATE	
BY	
DATE	

COMPANY NAME: #COMPANY NAME#  
 PROJECT CONTACT: #PROJECT CONTACT#  
 CLIENT: #CLIENT#  
 DATES: #DATES#  
 SHEETS: #SHEETS#

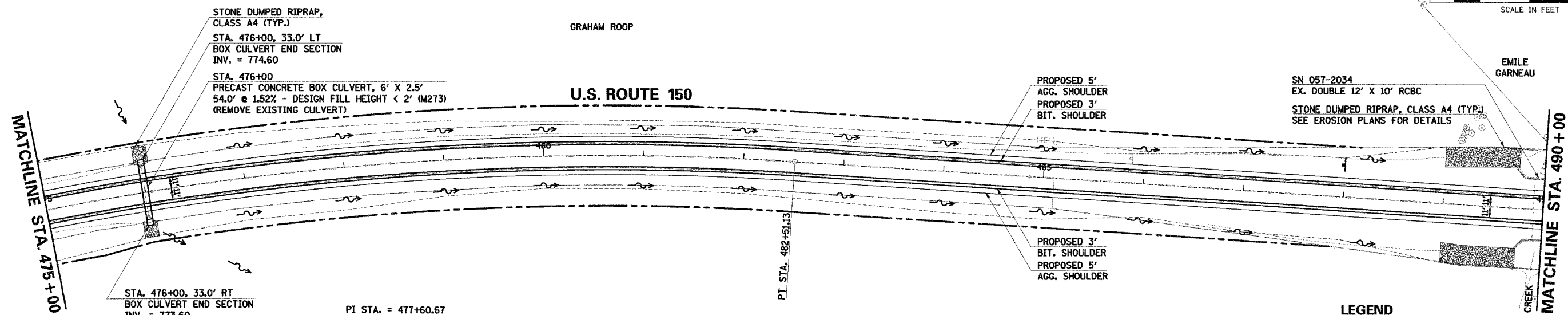

PI STA. = 477+60.67  
 $\Delta = 19^\circ 21' 50''$  (RT)  
 $D = 1^\circ 57' 18''$   
 $R = 2,930.65'$   
 $T = 499.99'$   
 $L = 990.45'$   
 $E = 42.35'$   
 $\theta = 3.3\%$   
 $T.R. = 37'$   
 $S.E. RUN = 81'$   
 $P.C. STA. = 472+60.68$   
 $P.T. STA. = 482+51.13$

**LEGEND**

	EXISTING R.O.W.
	PROPOSED R.O.W.
	TEMPORARY EASEMENT
	FLOW ARROW
	CONSTRUCTION LIMITS
	PAVEMENT REMOVAL
	TREE REMOVAL

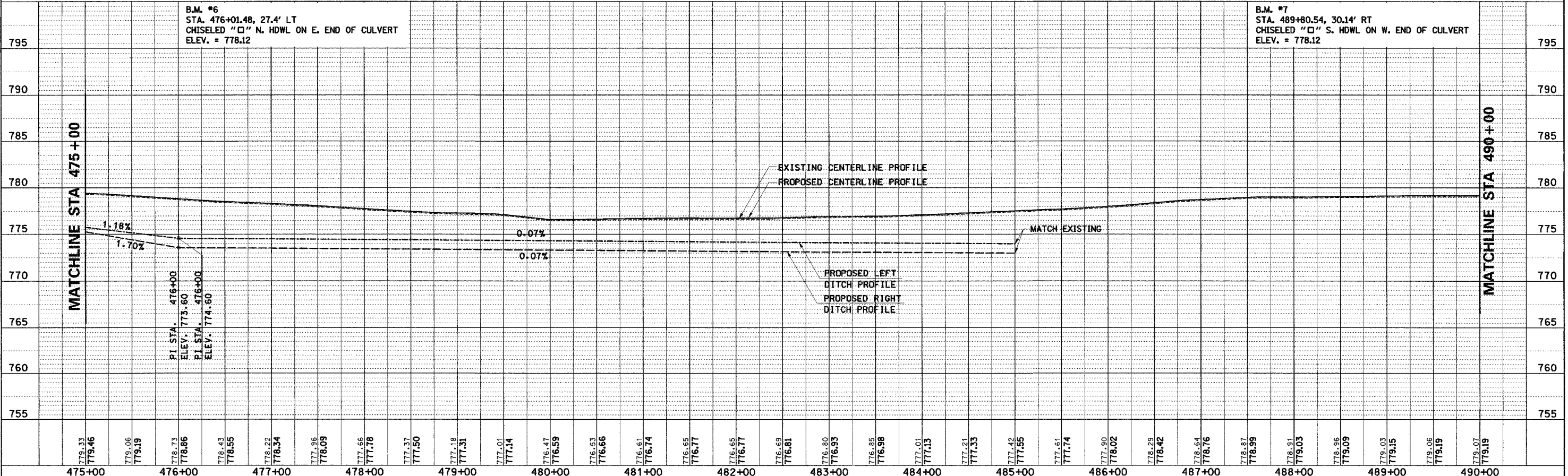

U.S. ROUTE 150 STA. 475+00 TO STA. 490+00 - PLAN AND PROFILE