

SCHEDULE OF DETOUR SIGNS

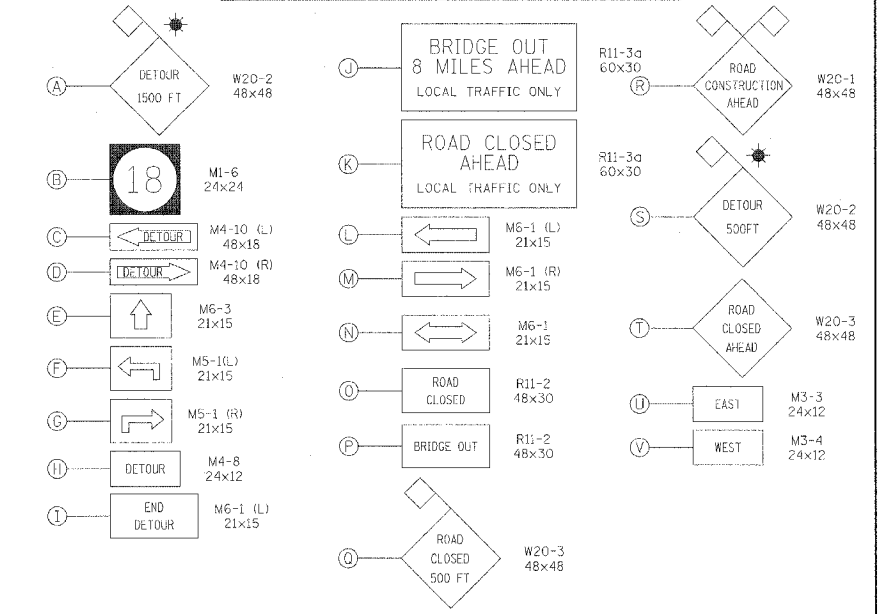

- LEGEND**
- ★ MONODIRECTIONAL FLASHING AMBER LIGHT
 - DIRECTION OF TRAFFIC
 - 1 TYPE III BARRICADE W/STEADY BURNING MONODIRECTIONAL LIGHT SIGN
 - ◇ ORANGE FLAG
 - ▬ PAVED UNDIVIDED BITUMINOUS HIGH TYPE
 - ▬ BITUMINOUS LOW TYPE
 - ▬ GRAVEL OR STONE
 - ▬ SOIL SURFACE
 - ▬ RAILROAD TRACKS
 - ▬ NOT KNOWN

REVISIONS	
NAME	DATE

ILLINOIS DEPARTMENT OF TRANSPORTATION
 F.A.P. ROUTE 653 (IL 18)

**DETOUR PLAN
 INTERSECTION DETAILS**

SCALE: VERT. NOT TO SCALE
 HORIZ. DATE: MARCH 15, 2006

DRAWN BY NEC
 CHECKED BY MRH