

F.A.I. RTE.	SECTION	COUNTY	TOTAL SHEETS	SHEET NO.
57	(38-6)T	IROQUOIS	23	1

INDEX OF SHEETS

- 1. COVER SHEET
- 2. GENERAL NOTES
- 3. SUMMARY OF QUANTITIES
- 4. TYPICAL SECTION
- 5 - 10. PLAN AND PROFILE SHEETS
- 11 - 23. CROSS SECTIONS SHEETS

STANDARDS

- 000001-04 STANDARD SYMBOLS, ABBREVIATIONS AND PATTERNS
- 280001-02 TEMPORARY EROSION CONTROL SYSTEMS
- 701101-01 OFF-ROAD OPERATIONS MULTILANE, 4.5 m (15') TO 600 mm (24") FROM PAVEMENT EDGE
- 701106-01 OFF-ROAD OPERATIONS, MULTILANE, MORE THAN 4.5 m (15') AWAY
- 701400-02 APPROACH TO LANE CLOSURE, FREEWAY/EXPRESSWAY
- 701406-04 LANE CLOSURE, FREEWAY/EXPRESSWAY, DAY OPERATIONS ONLY
- 702001-06 TRAFFIC CONTROL DEVICES

**STATE OF ILLINOIS
DEPARTMENT OF TRANSPORTATION
DIVISION OF HIGHWAYS**

**PROPOSED
HIGHWAY PLANS**

**F.A.I. ROUTE 57 (I-57)
SECTION (38-6)T**

**IROQUOIS COUNTY
C-93-026-06
GRADING AND SHAPING DITCHES**

D-93-002-06

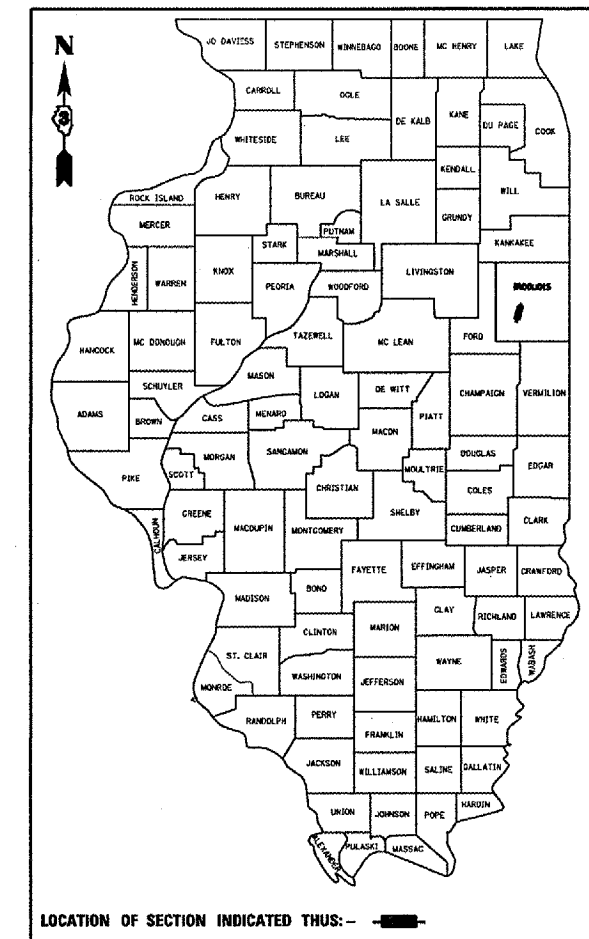

FUNCTIONAL CLASSIFICATION
RURAL: INTERSTATE
FAI ROUTE 57
2003 ADT = 16000
P.V. = 67.5% M.U. = 26.3% S.U. = 6.3%

BEGIN PROJECT
M.P. 279.1 SBL
(STA. 851+50)

END PROJECT
M.P. 277.7 SBL
(STA. 928+00)

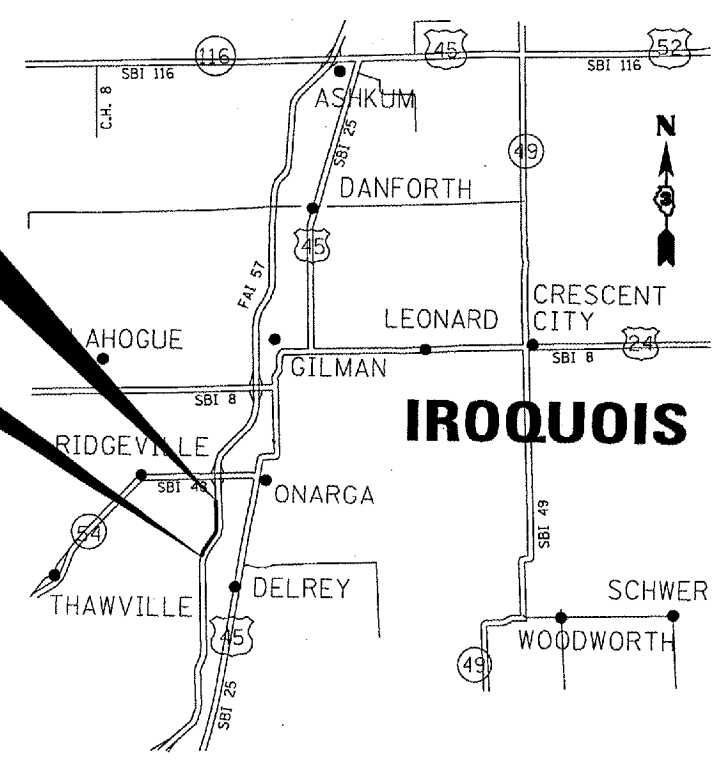

LOCATION MAP

NOT TO SCALE
GROSS LENGTH = 7650 FT. = 1.45 MI.
NET LENGTH = 7650 FT. = 1.45 MI

MICROFILMED _____
REEL NUMBER _____
AWARDED _____
RESIDENT ENGINEER _____
AS BUILT CHANGES WERE MADE
ON THE FOLLOWING SHEETS _____

J.U.L.I.E.
JOINT UTILITY LOCATION INFORMATION FOR EXCAVATION
1-800-892-0123

DISTRICT NO. 3 815-434-6131
PROJECT ENGINEER: JOE KANNEL 815-434-8420
UNIT CHIEF: RON WOODSHANK 815-434-8419

CONTRACT NO. 66622

STATE OF ILLINOIS
DEPARTMENT OF TRANSPORTATION
DIVISION OF HIGHWAYS

SUBMITTED March 30, 2006
George P. Menden
DEPUTY DIRECTOR OF HIGHWAYS, REGION ENGINEER

May 12, 2006
Mike Hene
ENGINEER OF DESIGN AND ENVIRONMENT

May 12, 2006
Nelson R. Sees, P.E.
DIRECTOR OF HIGHWAYS, CHIEF ENGINEER

**PRINTED BY THE AUTHORITY
OF THE STATE OF ILLINOIS**

F.A.I. RTE.	SECTION	COUNTY	TOTAL SHEETS	SHEET NO.
57	(38-6)T	ILLINOIS	23	2

GENERAL NOTES

THE CONTRACTOR SHALL BE RESPONSIBLE FOR PROTECTING UTILITY PROPERTY FROM CONSTRUCTION OPERATIONS AS OUTLINED IN ARTICLE 107.31 OF THE STANDARD SPECIFICATIONS. THE "JULIE" NUMBER IS 1-800-892-0123. A MINIMUM OF FORTY-EIGHT (48) HOURS ADVANCE NOTICE IS REQUIRED.

ABANDONED UNDERGROUND UTILITIES THAT CONFLICT WITH CONSTRUCTION SHALL BE DISPOSED OF OUTSIDE THE LIMITS OF THE RIGHT OF WAY ACCORDING TO ARTICLE 202.03 OF THE STANDARD SPECIFICATIONS AND AS DIRECTED BY THE ENGINEER. THIS WORK WILL NOT BE PAID FOR SEPARATELY BUT SHALL BE INCLUDED IN THE COST OF EARTH EXCAVATION.

ANY REFERENCE TO A STANDARD IN THESE PLANS SHALL BE INTERPRETED TO MEAN THE EDITION AS INDICATED BY THE SUBNUMBER LISTED ON THE INDEX OF SHEETS OR THE COPY OF THE STANDARD INCLUDED IN THESE PLANS.

ALL NEW REINFORCEMENT BARS SHALL BE "EPOXY COATED"

EXISTING REINFORCEMENT BARS EXTENDING INTO REMOVAL AREA SHALL BE CLEANED, STRAIGHTENED AND INCORPORATED INTO THE NEW CONSTRUCTION. ANY REINFORCEMENT BARS THAT ARE DAMAGED DURING CONCRETE REMOVAL SHALL BE REPLACED WITH AN APPROVED BAR SPLICER OR ANCHORAGE SYSTEM. COST INCLUDED WITH CONCRETE REMOVAL.

FOR STABILIZATION, ALL TYPE III BARRICADES SHALL REQUIRE A MINIMUM OF FOUR SAND BAGS PER BARRICADE.

SEEDING SHALL NOT BE PERMITTED AT ANY TIME WHEN THE GROUND IS FROZEN, WET, OR IN AN UNTILLABLE CONDITION. LOCATIONS TO BE SEEDED WILL BE DETERMINED BY THE ENGINEER.

THE FINISHED EARTHWORK SHALL HAVE A VEGETATION SUSTAINING SOIL COVERING THE TOP FOUR INCHES IN AREAS TO BE SEEDED OR SODDED. THE VEGETATION SUSTAINING SOIL REQUIRED WILL NOT BE PAID FOR SEPARATELY BUT SHALL BE INCLUDED IN THE COST OF "FURNISHED EXCAVATION".

ALL ELEVATIONS REFERRING TO U.S.G.S. MEAN SEA LEVEL DATUM.

THE FOLLOWING RATES OF APPLICATION HAVE BEEN USED IN CALCULATING PLAN QUANTITIES:

TEMPORARY DITCH CHECKS	9	BALES OR
	5	TONS AGGREGATE

PREPARED BY:
 DISTRICT STUDIES & PLANS ENGINEER

DATE: 3/30/06

EXAMINED BY:
 DISTRICT CONSTRUCTION ENGINEER

DISTRICT MATERIALS ENGINEER

DISTRICT OPERATIONS ENGINEER

REVISIONS	
NAME	DATE

ILLINOIS DEPARTMENT OF TRANSPORTATION

GENERAL NOTES

SCALE: VERT. DRAWN BY: RLW
 HORIZ. CHECKED BY:
 DATE: 10/20/2005

F.A.I. RTE.	SECTION	COUNTY	TOTAL SHEETS	SHEET NO.
57	(38-6)T	IRROUOIS	23	3

SUMMARY OF QUANTITIES

CONSTRUCTION CODE TYPE: Y003

RURAL
100% STATE
TOTAL
QUANTITY

CODE NO.	ITEM	UNIT	QUANTITY
20201200	REMOVAL AND DISPOSAL OF UNSUITABLE MATERIAL	CU YD	752
20400800	FURNISHED EXCAVATION	CU YD	767
21400100	GRADING AND SHAPING DITCHES	FOOT	7650
25000210	SEEDING, CLASS 2A	ACRE	9
25000400	NITROGEN FERTILIZER NUTRIENT	POUND	810
25000500	PHOSPHORUS FERTILIZER NUTRIENT	POUND	810
25000600	POTASSIUM FERTILIZER NUTRIENT	POUND	810
25100115	MULCH, METHOD 2	ACRE	9
25101005	HEAVY DUTY EXCELSIOR BLANKET	SQ YD	1000
28000250	TEMPORARY EROSION CONTROL SEEDING	POUND	900
28000300	TEMPORARY DITCH CHECKS	EACH	15
67100100	MOBILIZATION	L SUM	1
70100700	TRAFFIC CONTROL AND PROTECTION, STANDARD 701406	L SUM	1

REVISIONS	
NAME	DATE

ILLINOIS DEPARTMENT OF TRANSPORTATION
SUMMARY OF QUANTITIES
SCALE: VERT. DRAWN BY RLW
 HORIZ. CHECKED BY
 DATE 10/20/2005

F.A.I. RTE.	SECTION	COUNTY	TOTAL SHEETS	SHEET NO.
57	(38-6)T	IROQUOIS	23	4

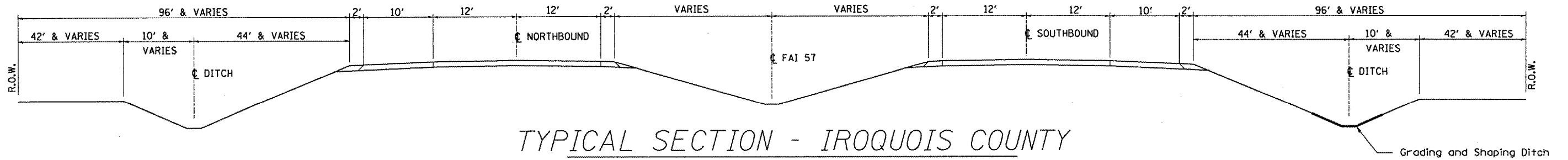

TYPICAL SECTION - IROQUOIS COUNTY
 STA. 850+00 TO STA. 928+00
 LOOKING SOUTH

REVISIONS	
NAME	DATE

ILLINOIS DEPARTMENT OF TRANSPORTATION

TYPICAL SECTIONS

SCALE: VERT. DRAWN BY RLW
 HORIZ. CHECKED BY
 DATE 10/20/2005

F.A.I. RTE.	SECTION	COUNTY	TOTAL SHEETS	SHEET NO.
57	(38-6)T	IRROUOIS	23	5

BM 1 (100.00) STA. 854+00 RT TOP OF ROW MARKER +/-111' OFFSET

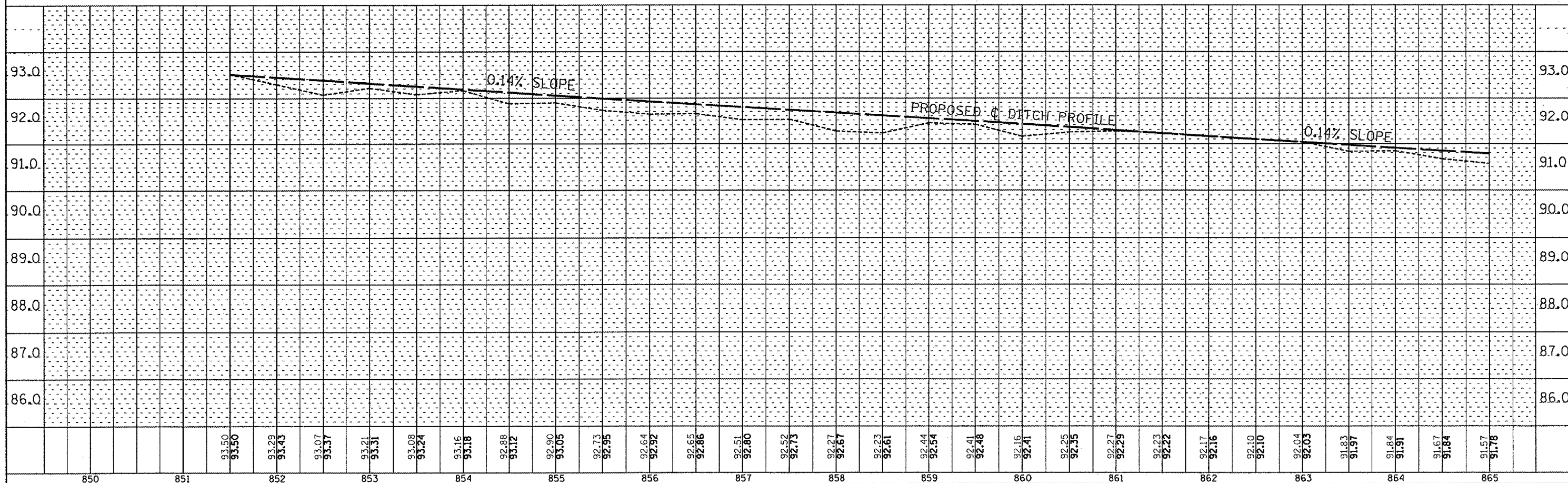
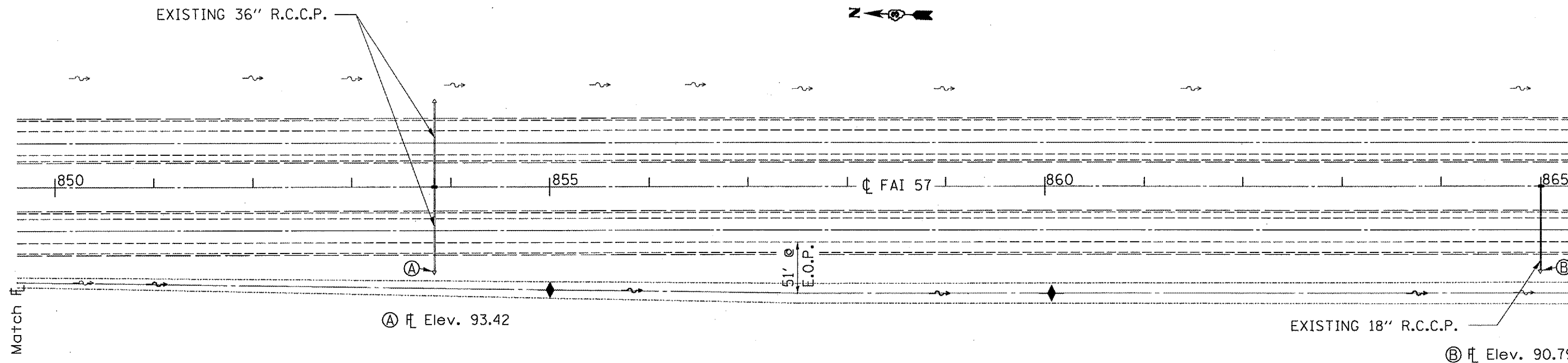

STA. 850+00 TO STA 865+00

F.A.I. RTE.	SECTION	COUNTY	TOTAL SHEETS	SHEET NO.
57	(38-6)T	IROQUOIS	23	6

BM 2 (98.38) STA. 867+00 RT TOP OF ROW MARKER +/-111' OFFSET
 BM 3 (98.66) STA. 871+35 RT TOP OF ROW MARKER +/-111' OFFSET

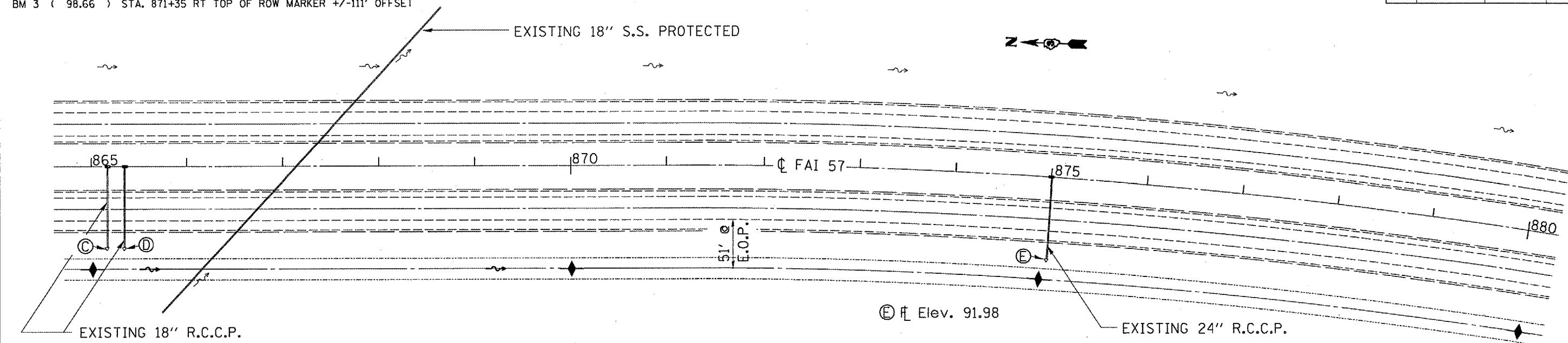

⊙ Elev. 90.73
 ⊙ Elev. 91.26

⊙ Elev. 91.98

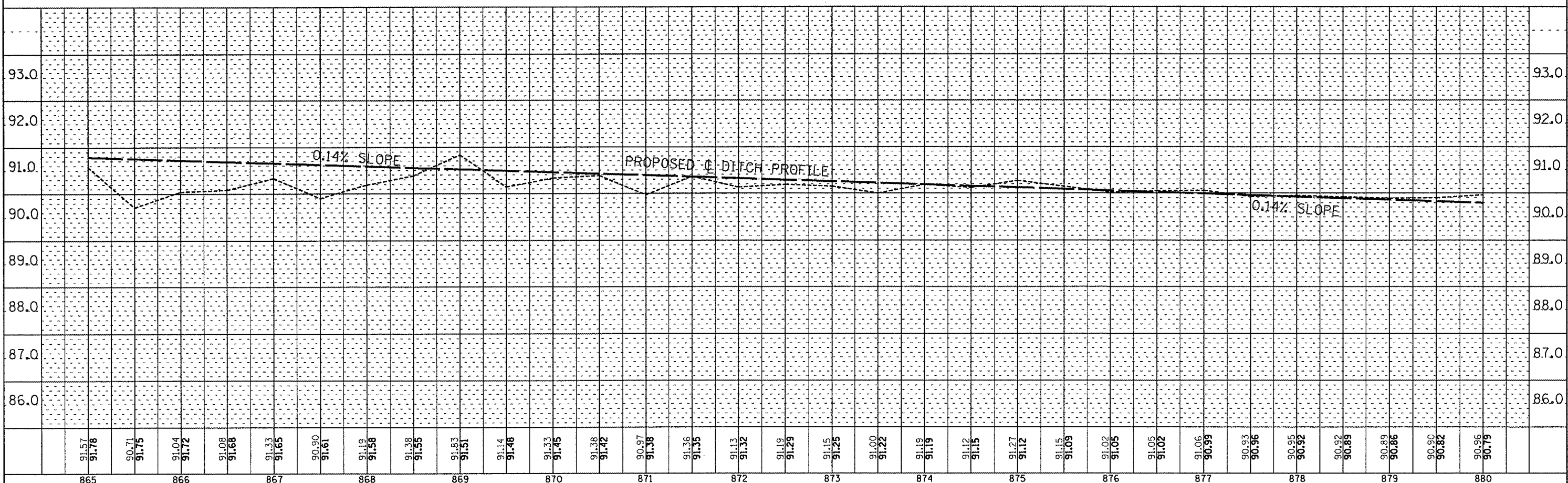

91.57	91.78	90.71	91.75	91.04	91.72	91.08	91.68	91.33	91.65	90.90	91.61	91.19	91.58	91.38	91.55	91.83	91.51	91.14	91.48	91.33	91.45	91.38	91.42	90.97	91.38	91.36	91.35	91.13	91.32	91.19	91.29	91.15	91.25	91.00	91.22	91.19	91.19	91.12	91.15	91.27	91.12	91.15	91.09	91.02	91.05	91.05	91.02	91.06	90.99	90.93	90.96	90.95	90.92	90.89	90.89	90.86	90.90	90.82	90.96	90.79
865	866	867	868	869	870	871	872	873	874	875	876	877	878	879	880																																													

F.A.I. RTE.	SECTION	COUNTY	TOTAL SHEETS	SHEET NO.
57	(38-6)T	IROQUOIS	23	7

BM 4 (97.46) STA. 881+00 RT TOP OF ROW MARKER +/-110' OFFSET
 BM 5 (98.11) STA. 892+00 RT TOP OF ROW MARKER +/-113' OFFSET
 BM 6 (100.17) STA. 894+85 RT TOP OF ROW MARKER +/-118' OFFSET

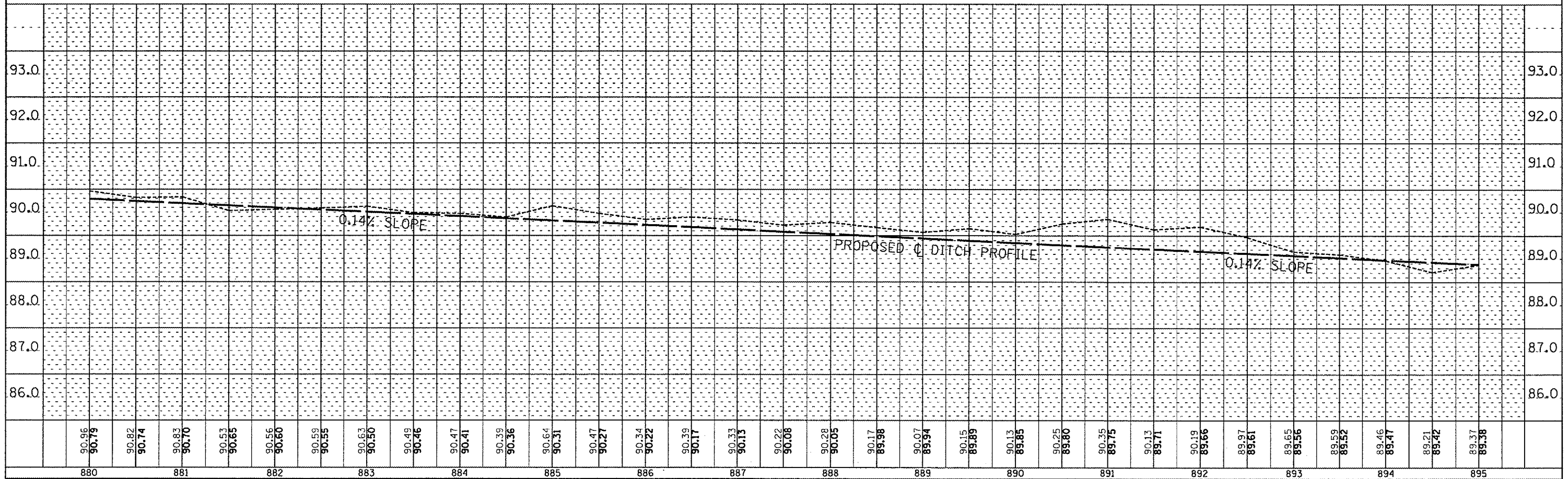
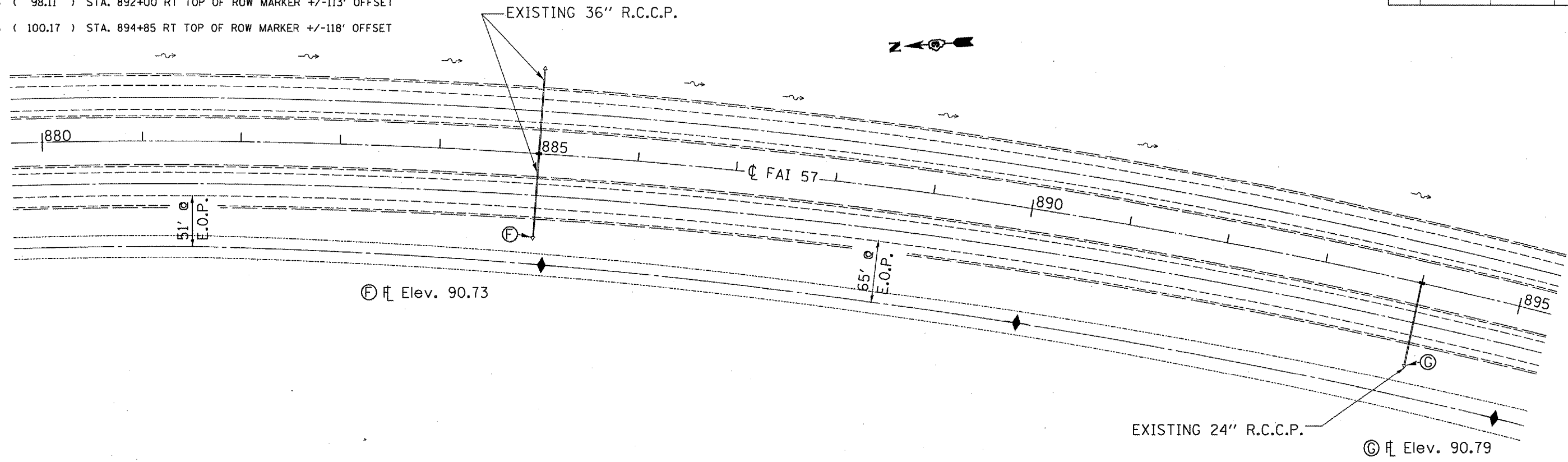

F.A.I. RTE.	SECTION	COUNTY	TOTAL SHEETS	SHEET NO.
57	(38-6)T	IROQUOIS	23	8

BM 7 (99.60) STA. 905+50 RT TOP OF ROW MARKER +/-118' OFFSET

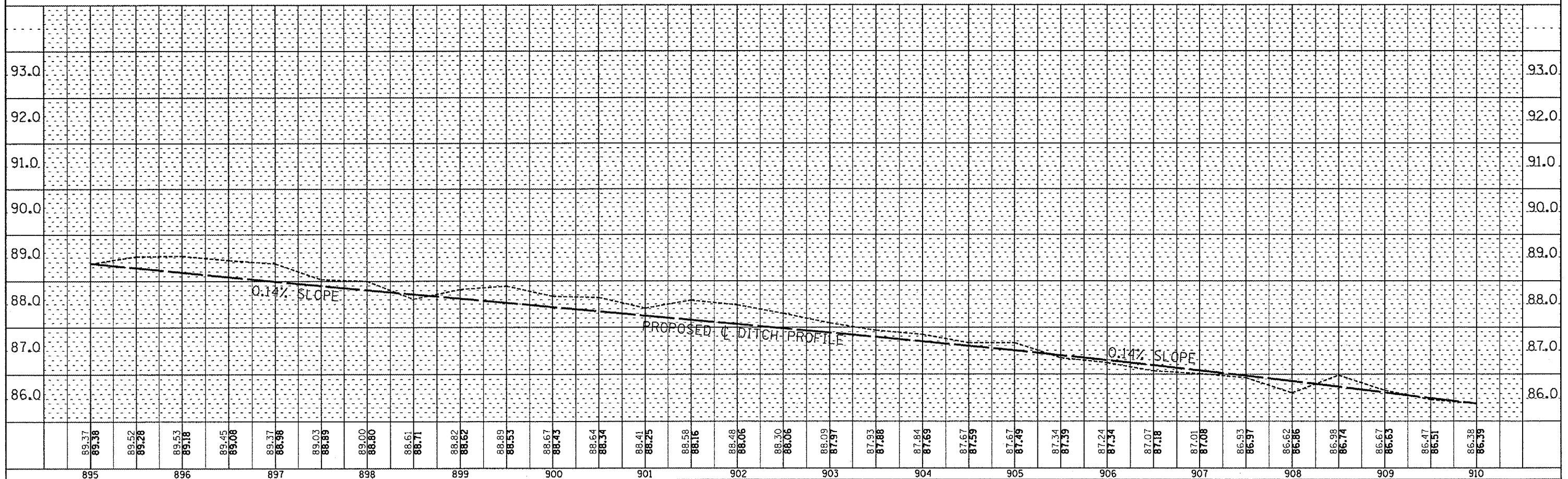
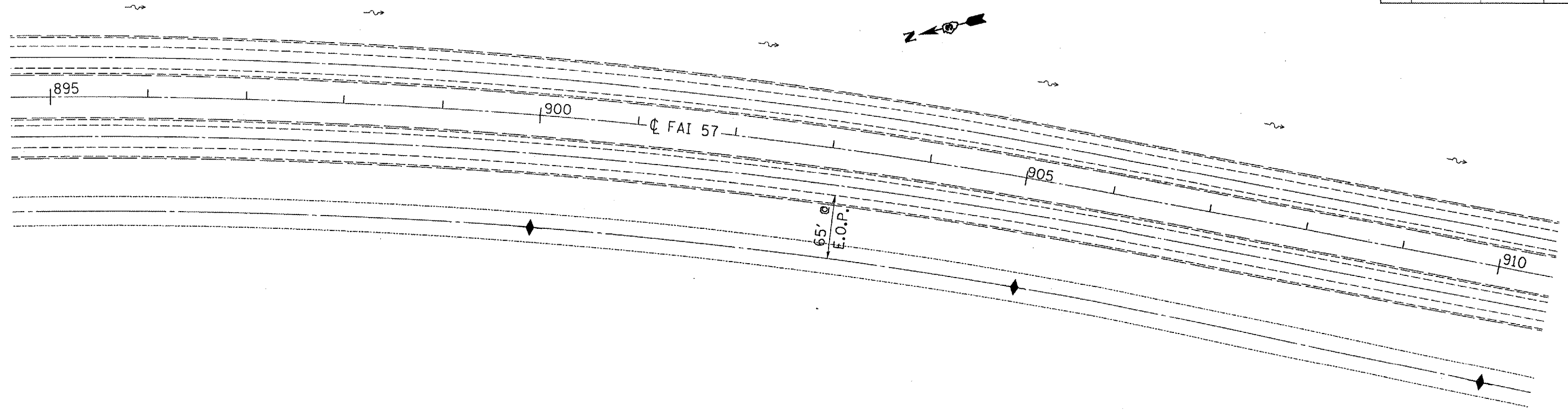

F.A.I. RTE.	SECTION	COUNTY	TOTAL SHEETS	SHEET NO.
57	(38-6)T	IROUOIS	23	9

BM 8 (100.41) STA. 910+25 RT TOP OF ROW MARKER +/-119' OFFSET

BM 9 (96.54) STA. 915+75 RT TOP OF ROW MARKER +/-120' OFFSET

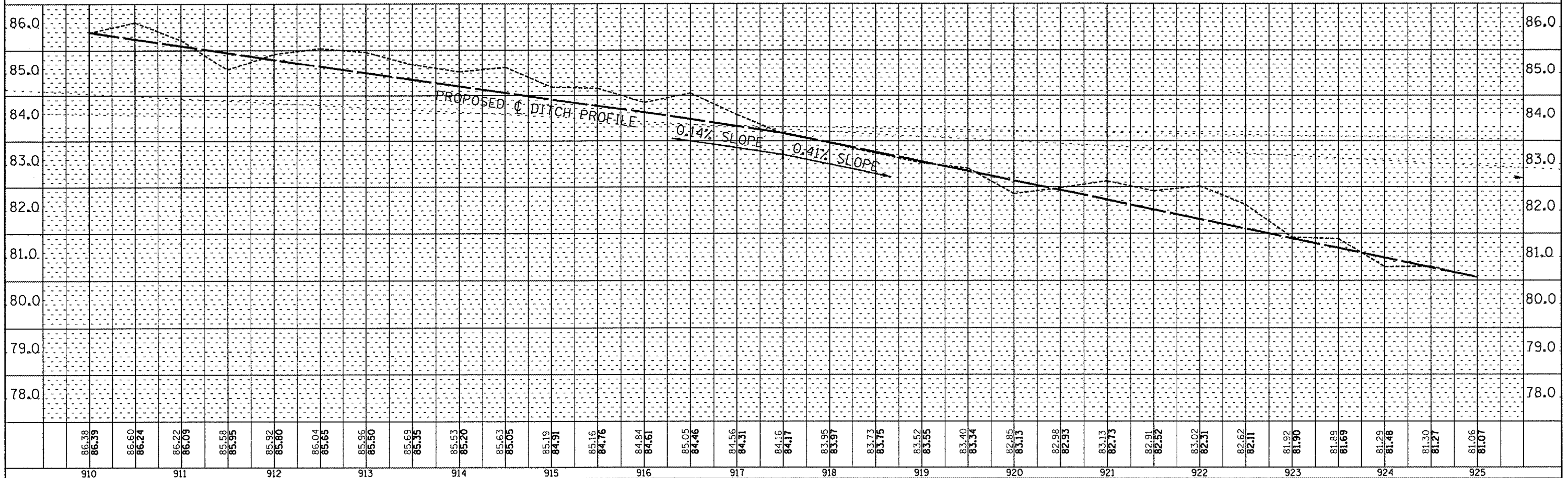
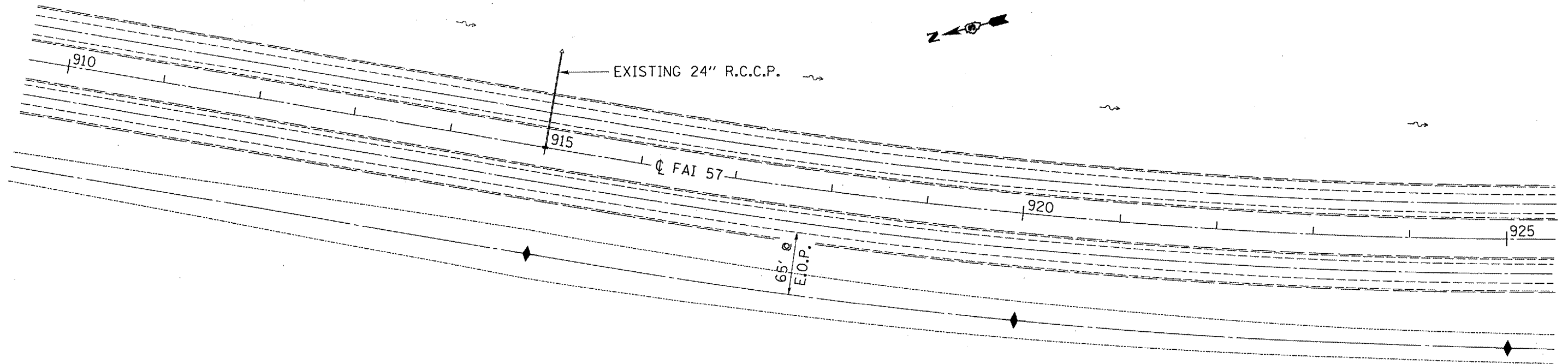

F.A.I. RTE.	SECTION	COUNTY	TOTAL SHEETS	SHEET NO.
57	(38-6)T	IROQUOIS	23	10

BM 10 (97.95) STA. 927+84 RT CHISLED X ON N.E. CORNER OF STRUCTURE WINGWALL

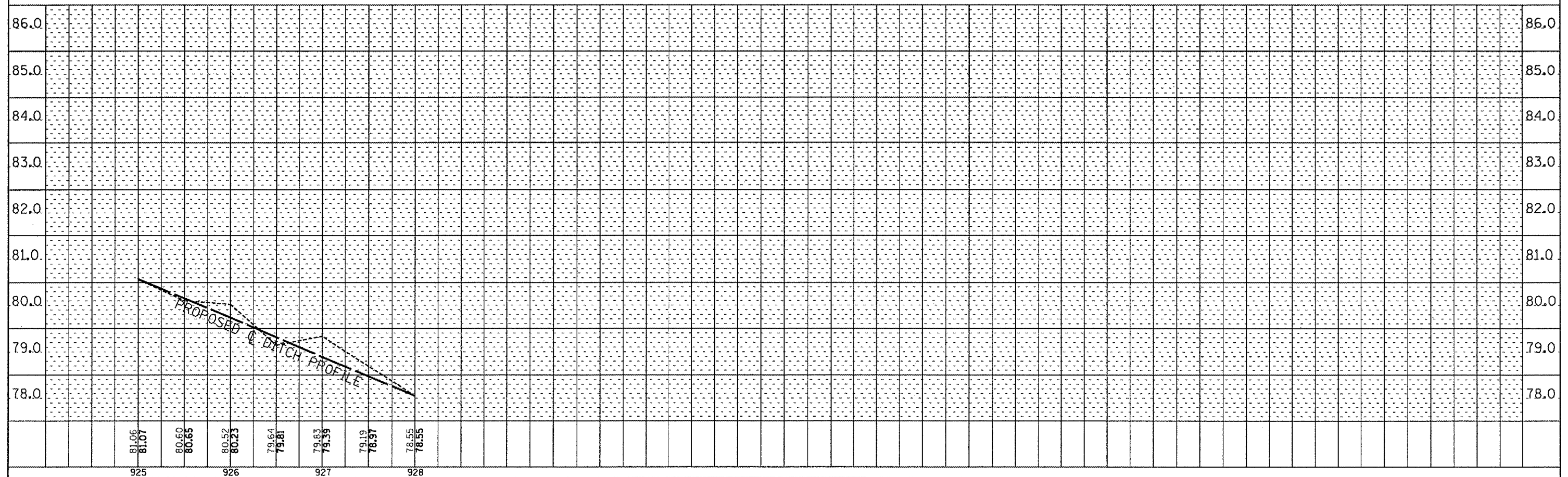
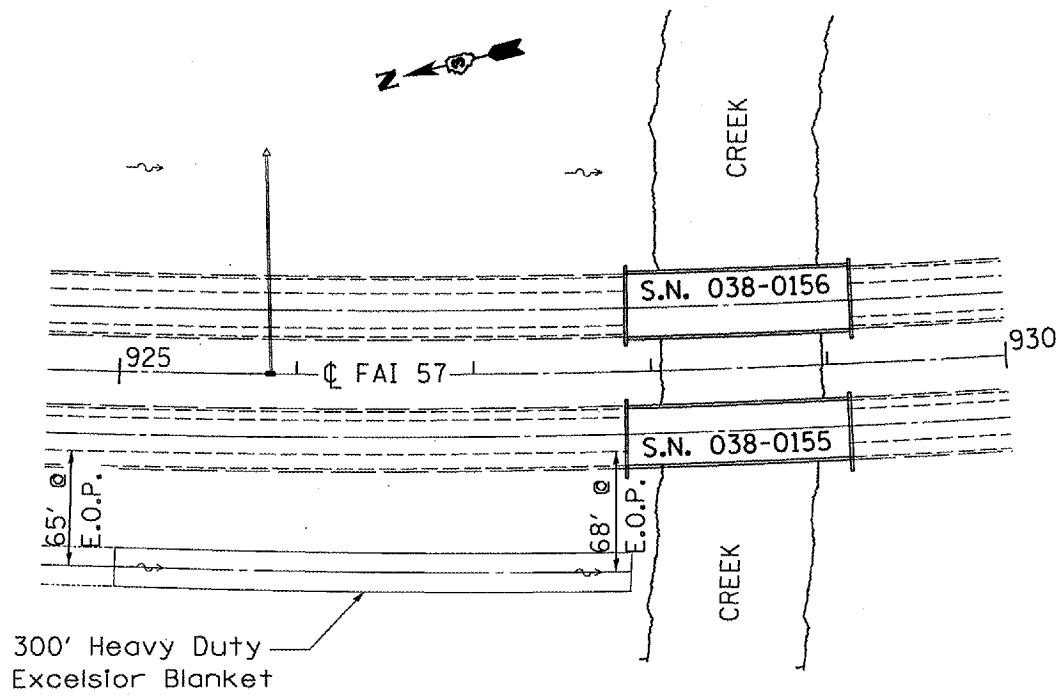

F.A.I. RTE.	SECTION	COUNTY	TOTAL SHEETS	SHEET NO.
57	(38-6)T	IROQUOIS	23	11
STA. 851+00	TO STA. 928+00			
FED. ROAD DIST. NO.	ILLINOIS	FED. AID PROJECT		

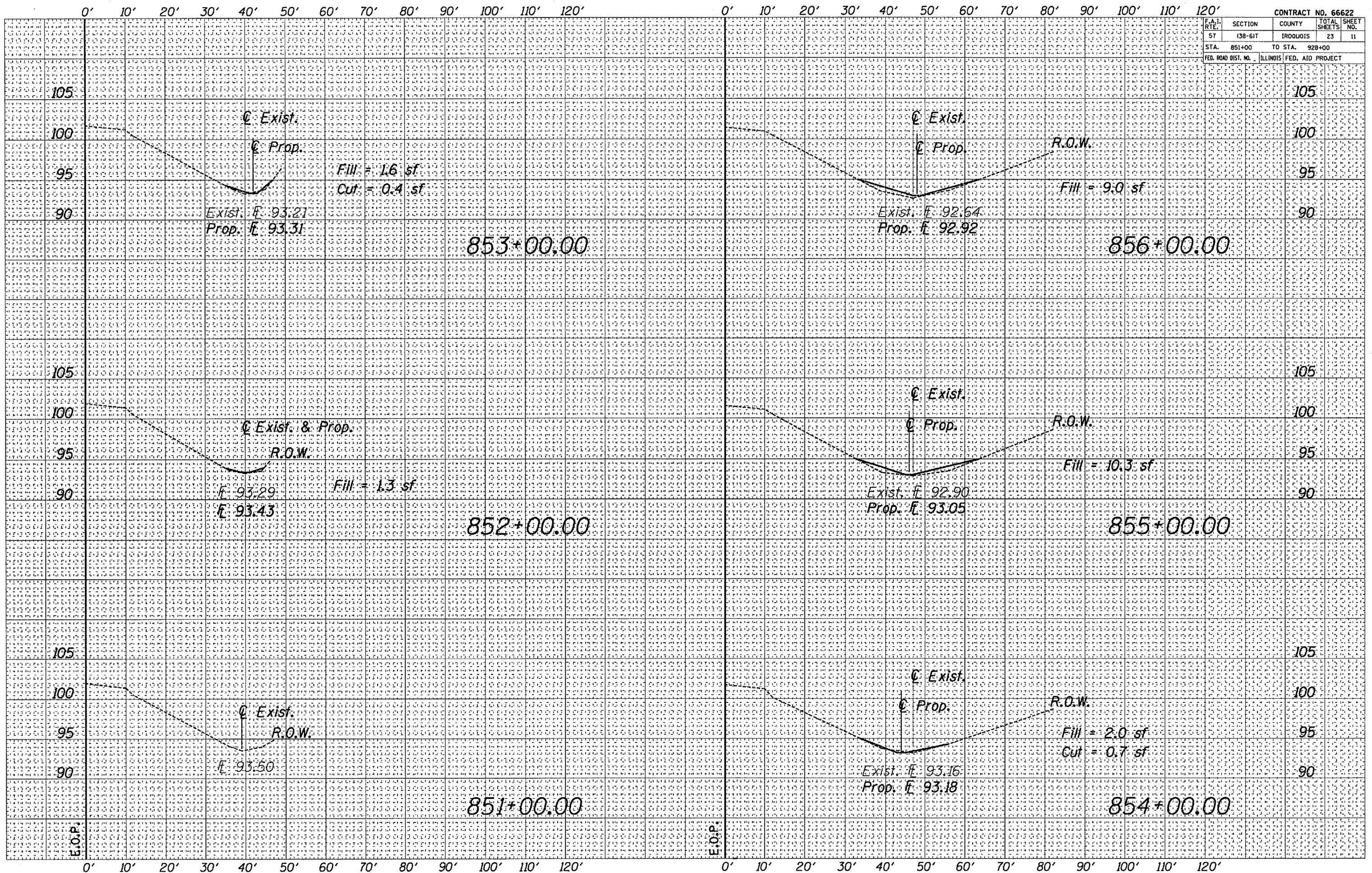

F.A.I. RTE.	SECTION	COUNTY	TOTAL SHEETS	SHEET NO.
57	(38-6)T	IROQUOIS	23	12
STA. 851+00		TO STA. 928+00		
FED. ROAD DIST. NO.	ILLINOIS	FED. AID PROJECT		

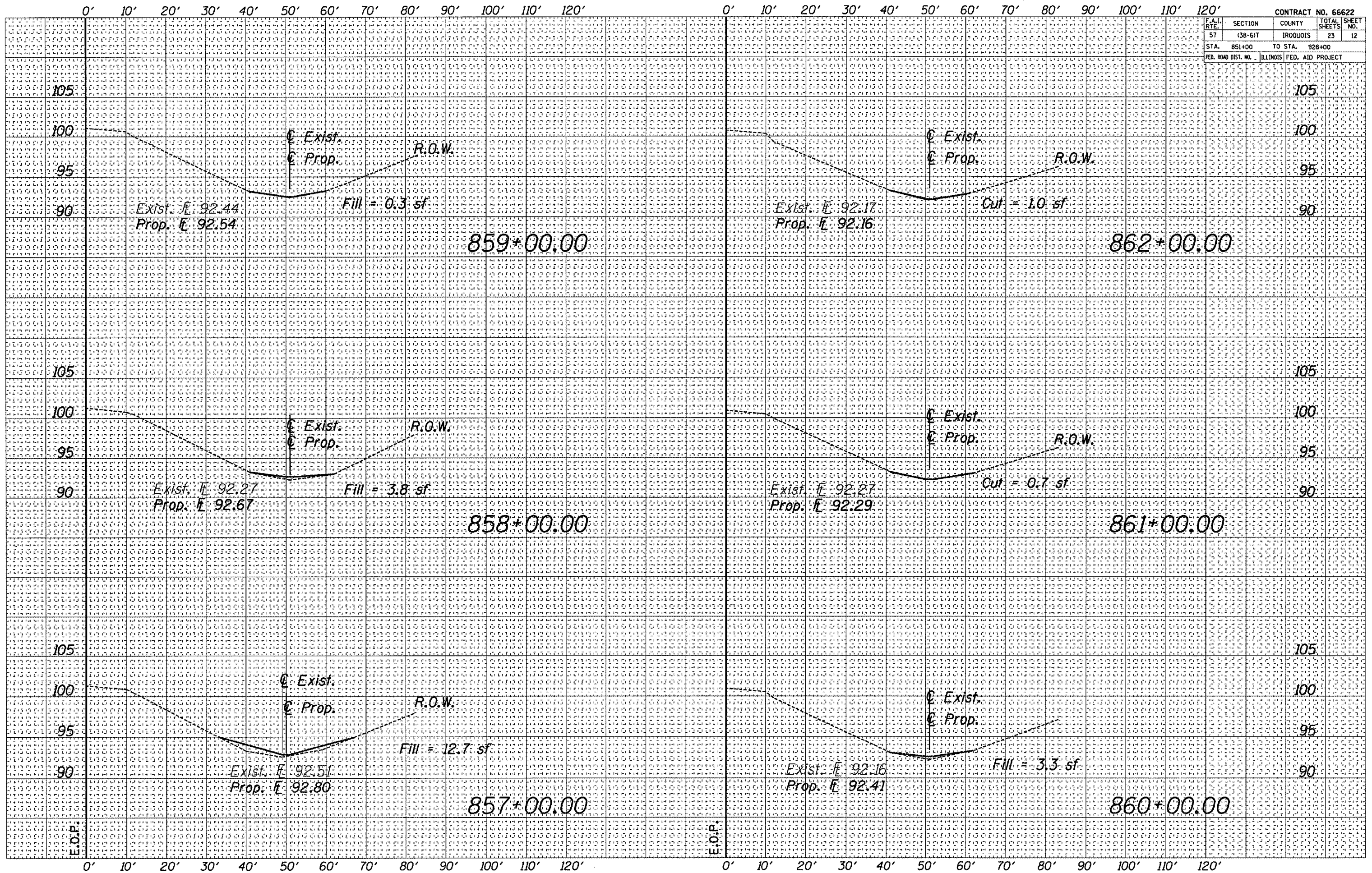

F.A.I. RTE.	SECTION	COUNTY	TOTAL SHEETS	SHEET NO.
57	(38-6)T	IROQUOIS	23	13
STA. 851+00	TO STA. 928+00			
FED. ROAD DIST. NO.	ILLINOIS	FED. AID PROJECT		

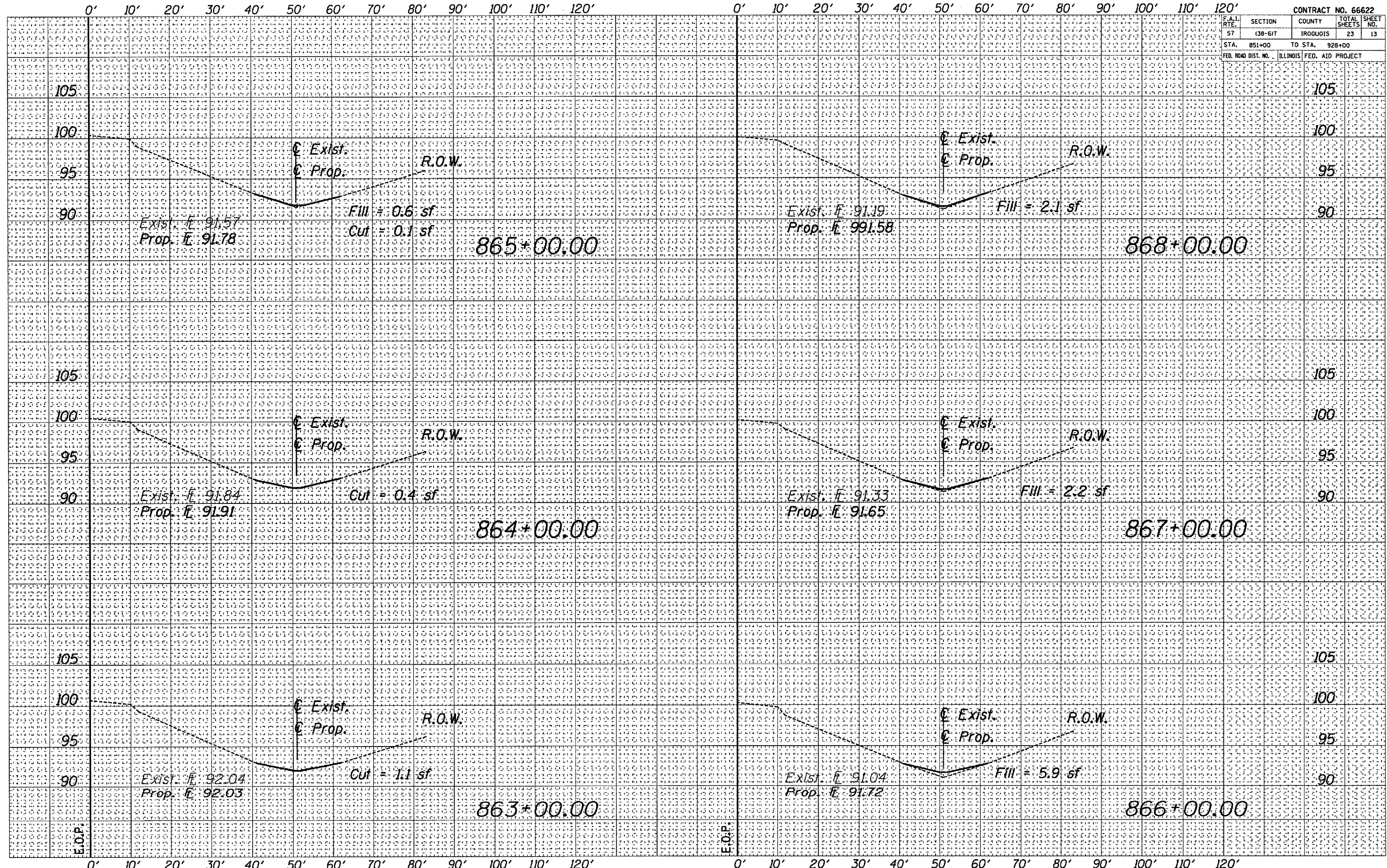

F.A.I. RTE.	SECTION	COUNTY	TOTAL SHEETS
57	(38-6)T	IROQUOIS	23
STA. 851+00	TO STA. 928+00		14
FED. ROAD DIST. NO.	ILLINOIS	FED. AID PROJECT	

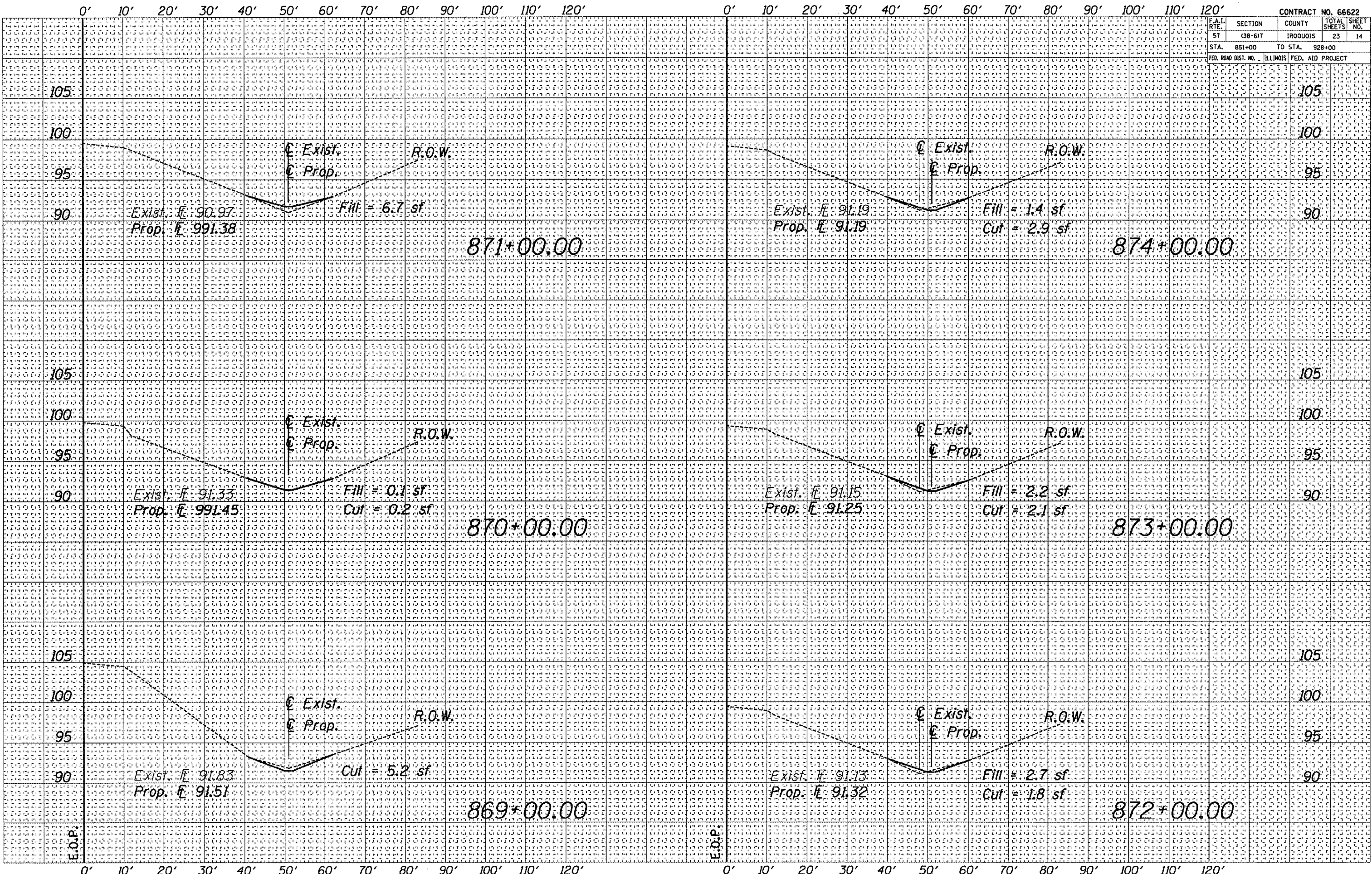

F.A.I. RTE.	SECTION	COUNTY	TOTAL SHEETS
57	(38-6)T	IROQUOIS	23
STA. 851+00	TO STA. 928+00		NO. 15
FED. ROAD DIST. NO.	ILLINOIS	FED. AID PROJECT	

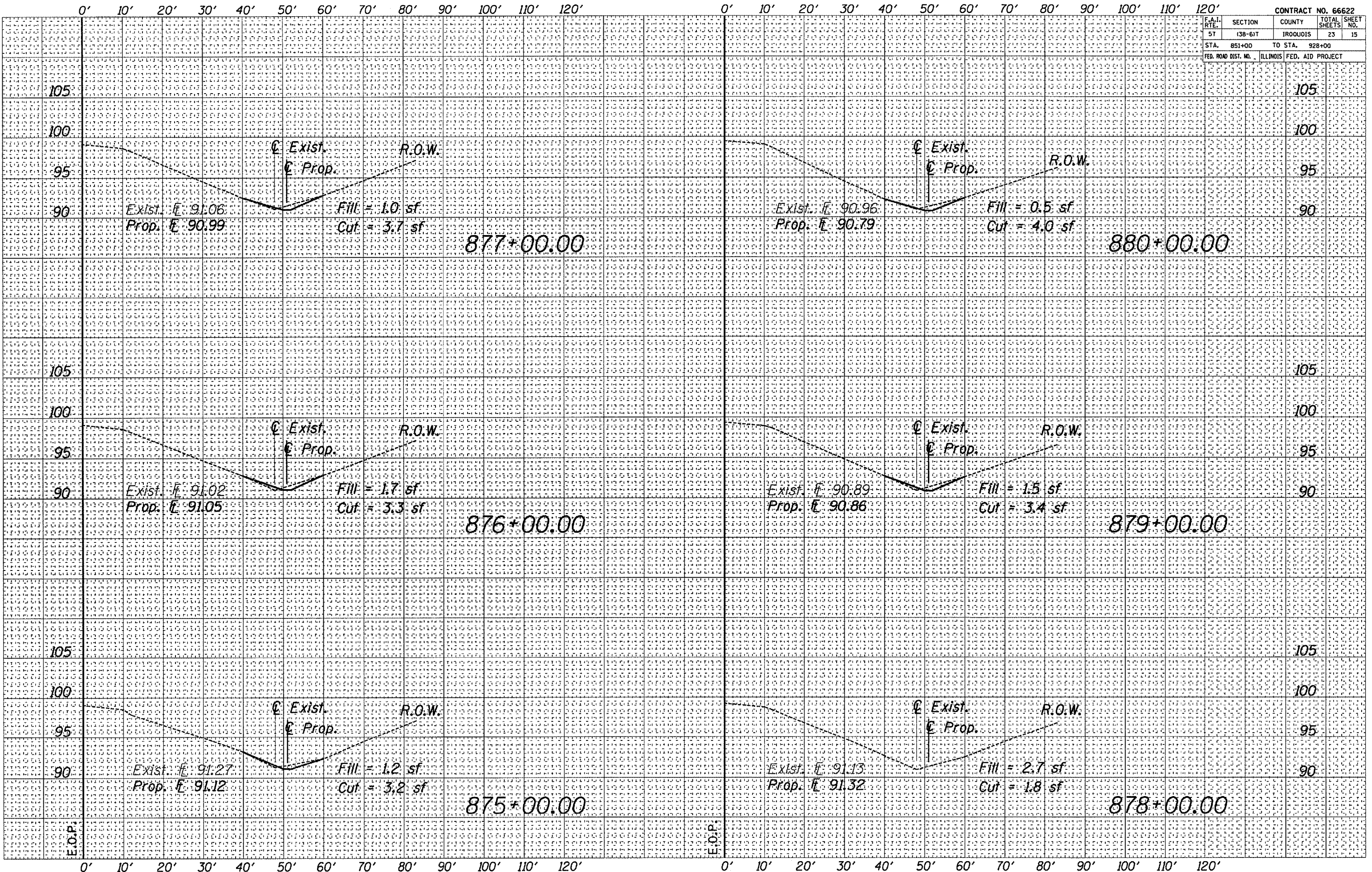

F.A.I. RTE.	SECTION	COUNTY	TOTAL SHEETS	SHEET NO.
57	(38-6)T	IROQUOIS	25	16
STA. 851+00	TO STA. 928+00			
FED. ROAD DIST. NO.	ILLINOIS	FED. AID PROJECT		

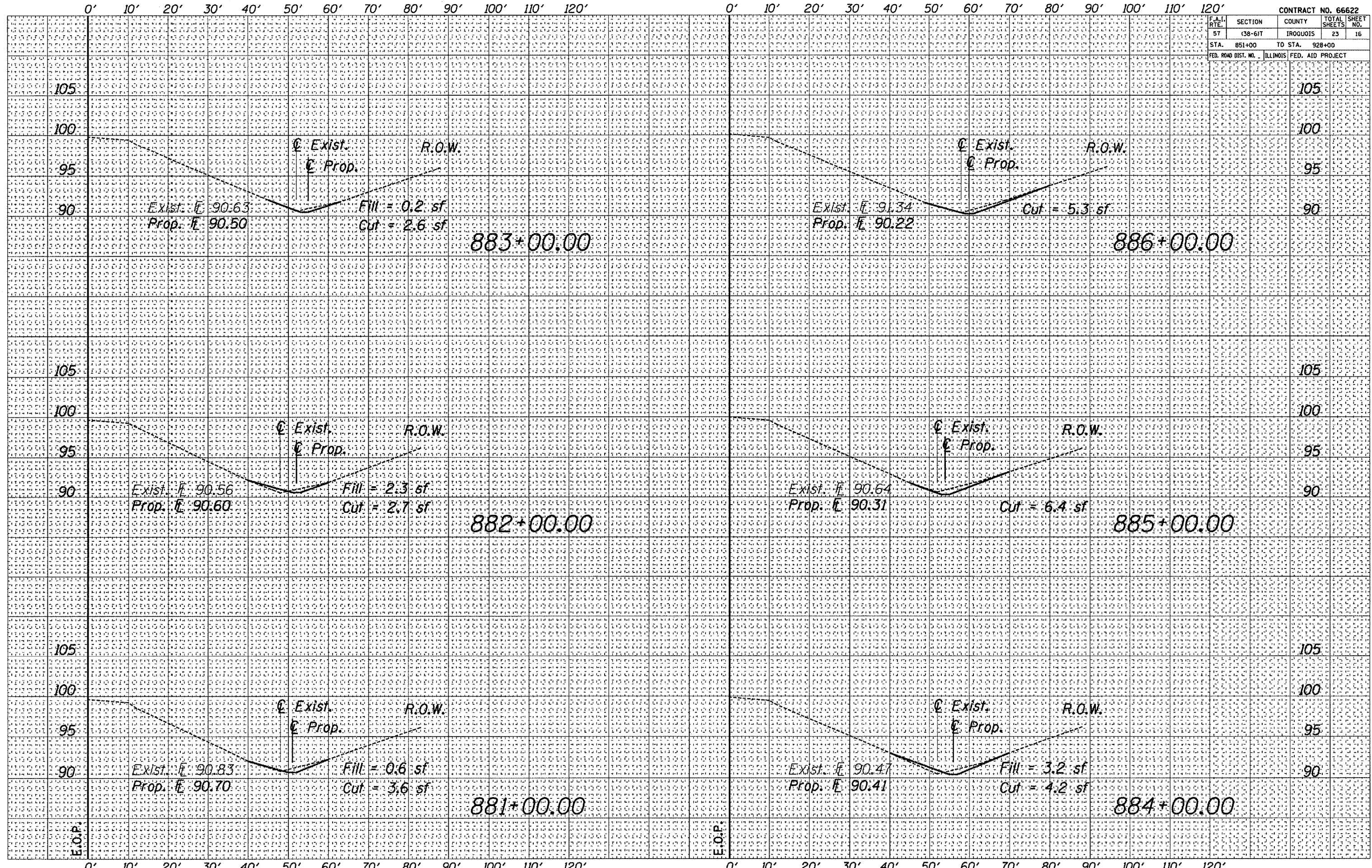

F.A.I. SECTION	COUNTY	TOTAL SHEETS	SHEET NO.
57 (38-6T)	IROQUOIS	23	17
STA. 851+00 TO STA. 928+00			
FED. ROAD DIST. NO.		ILLINOIS FED. AID PROJECT	

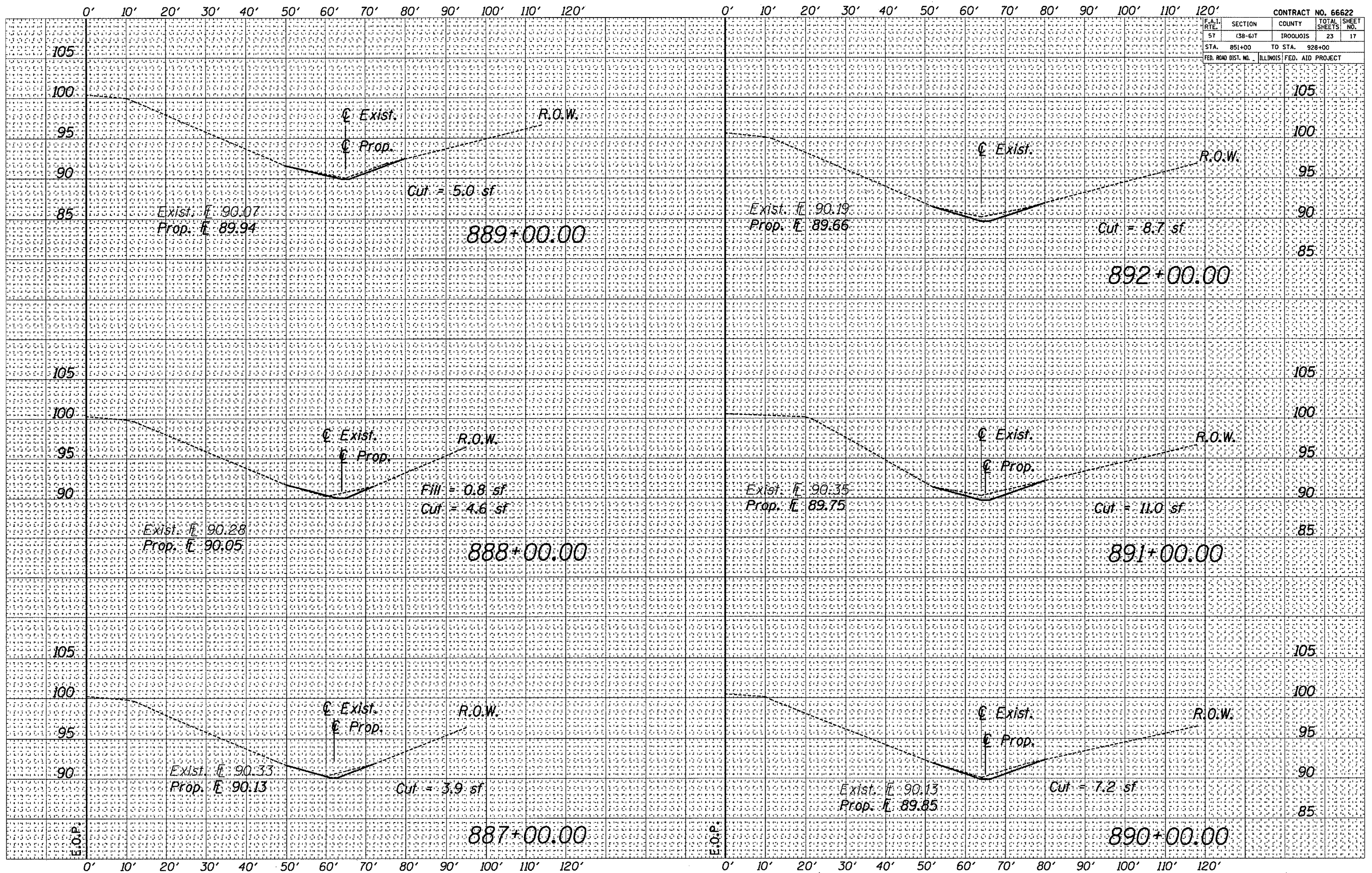

F.A.I. RTE.	SECTION	COUNTY	TOTAL SHEETS	SHEET NO.
57	(38-6)T	IROQUOIS	23	18
STA. 851+00	TO STA. 928+00			
FED. ROAD DIST. NO.	ILLINOIS	FED. AID PROJECT		

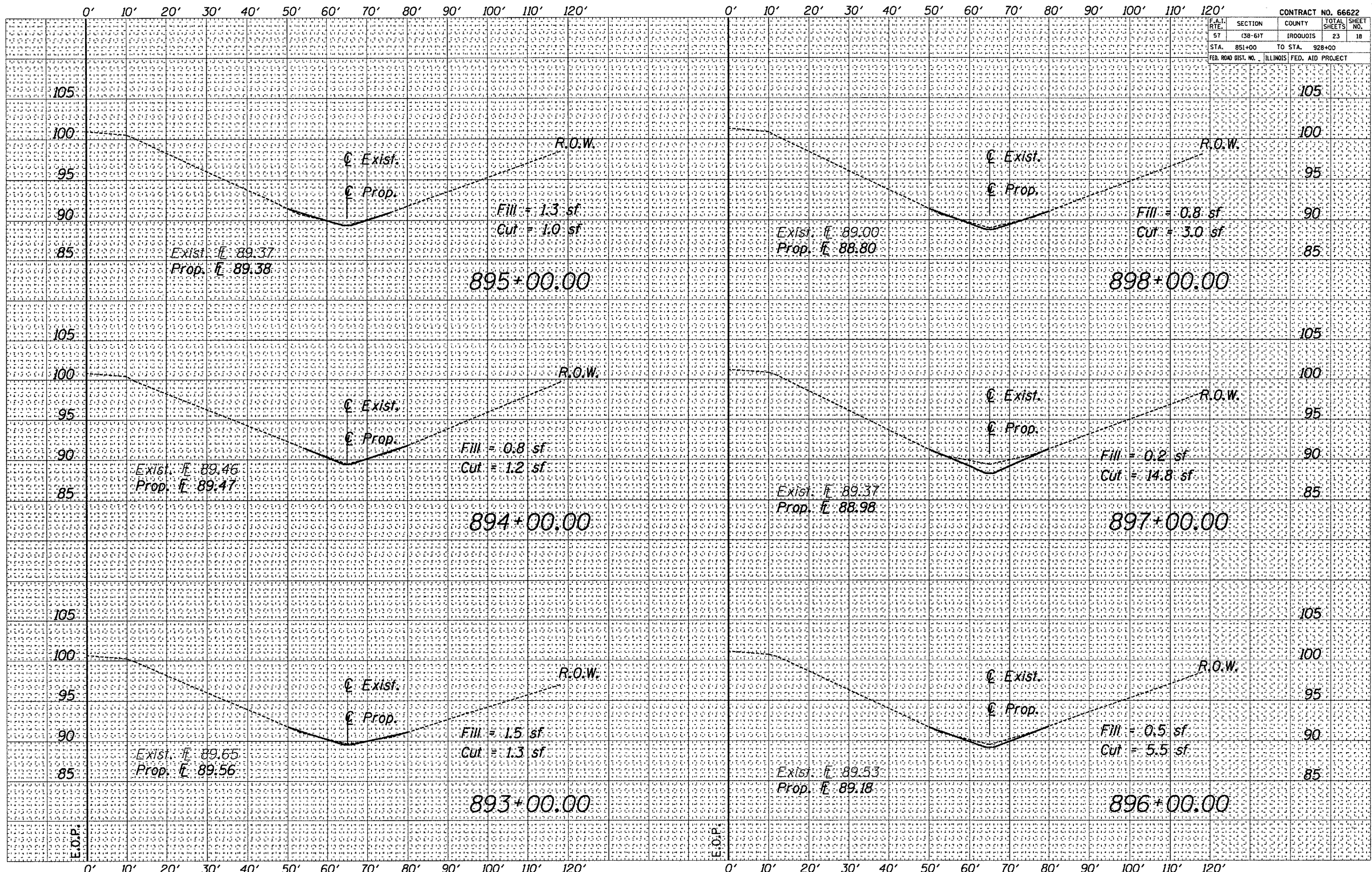

F.A.I. RTE.	SECTION	COUNTY	TOTAL SHEETS	SHEET NO.
57	(38-6)T	IROQUOIS	23	19
STA. 851+00	TO STA. 928+00			
FED. ROAD DIST. NO.	ILLINOIS	FED. AID PROJECT		

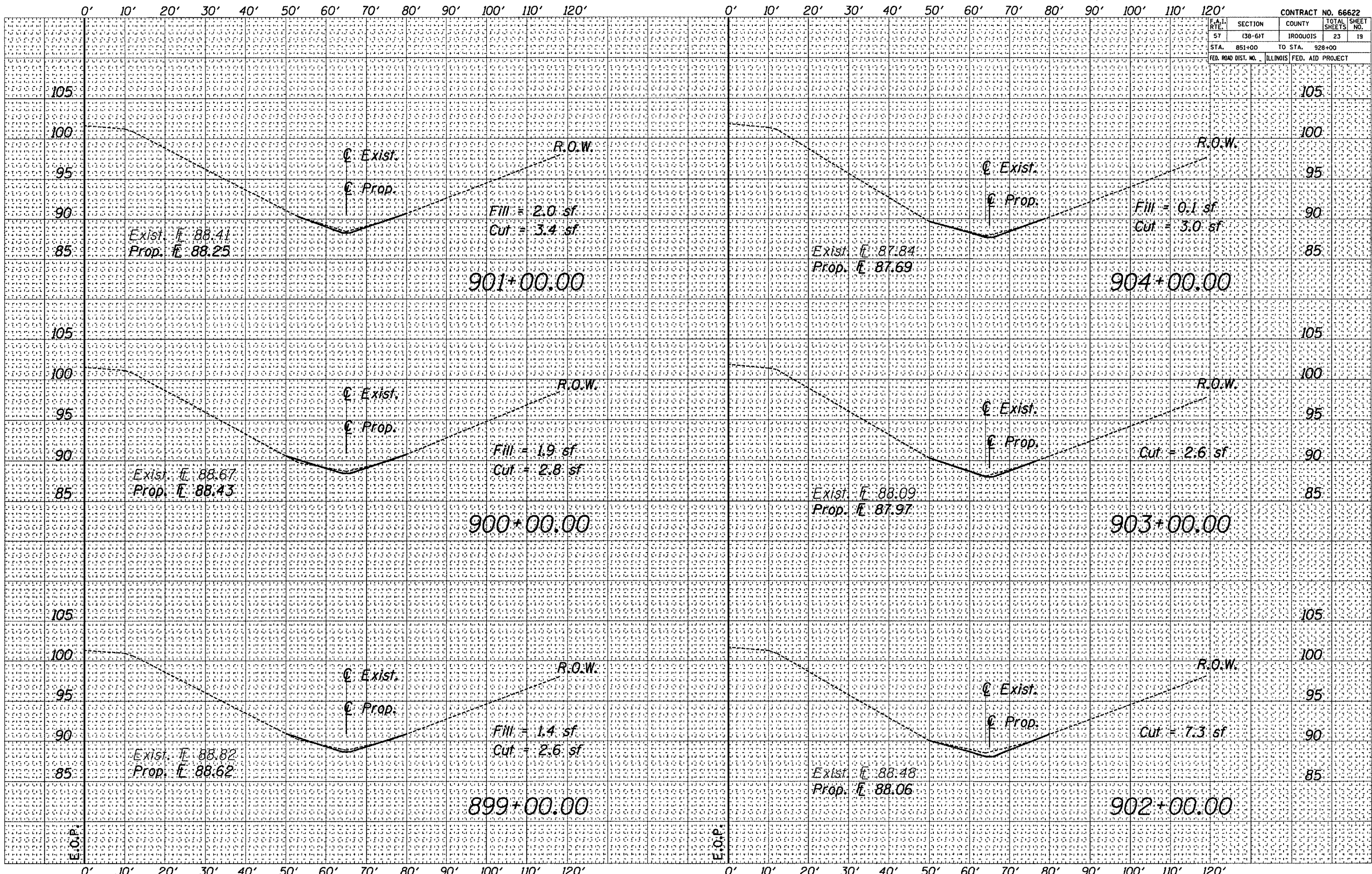

F.A.I. RTE.	SECTION	COUNTY	TOTAL SHEETS	SHEET NO.
57	(38-6)T	ILLINOIS	23	20
STA. 851+00		TO STA. 928+00		
FED. ROAD DIST. NO.		ILLINOIS FED. AID PROJECT		

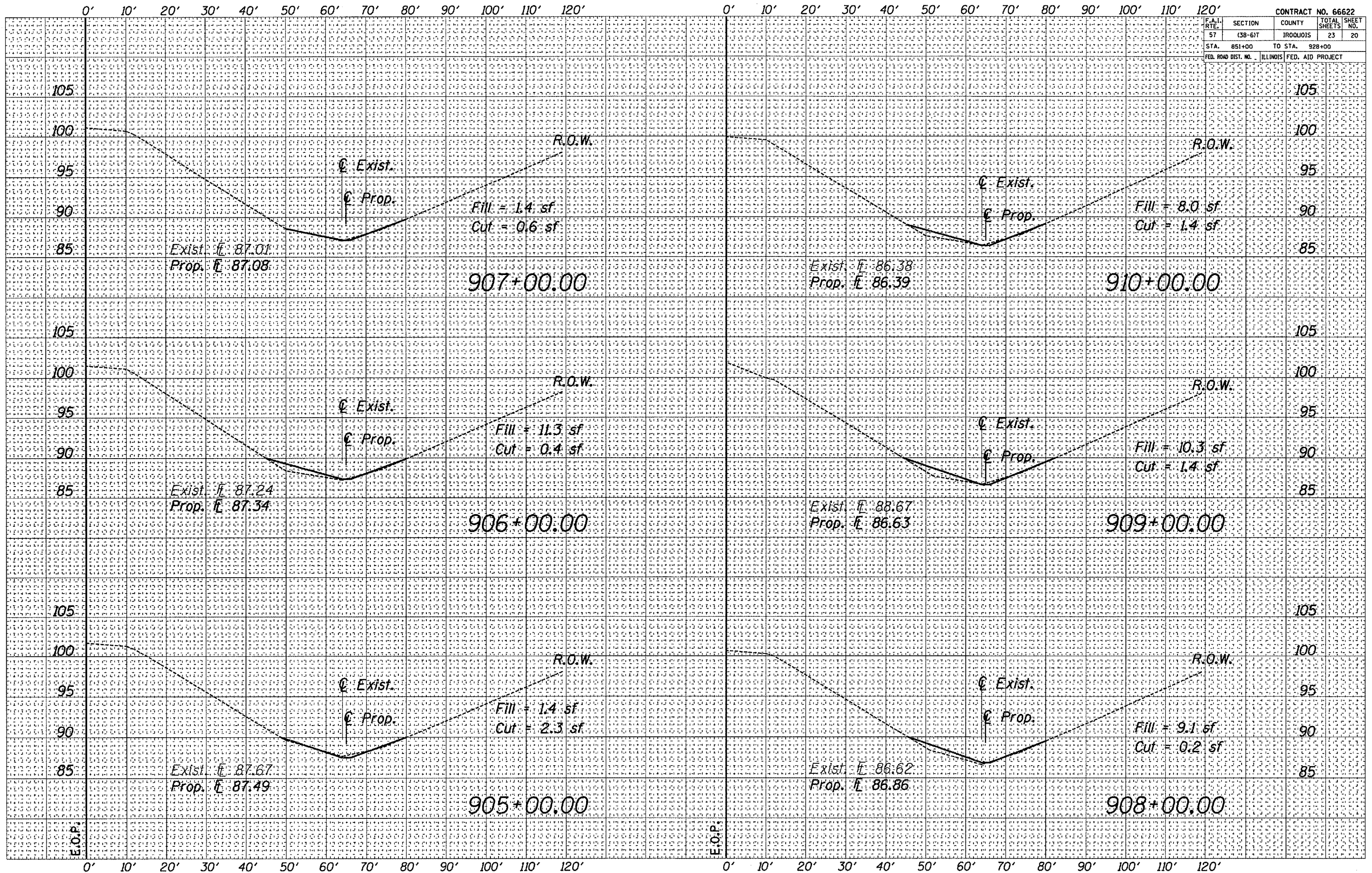

F.A.I. RTE.	SECTION	COUNTY	TOTAL SHEETS
57	(38-6)T	IROQUOIS	23
STA. 851+00	TO STA. 928+00		21
FED. ROAD DIST. NO.	ILLINOIS	FED. AID PROJECT	

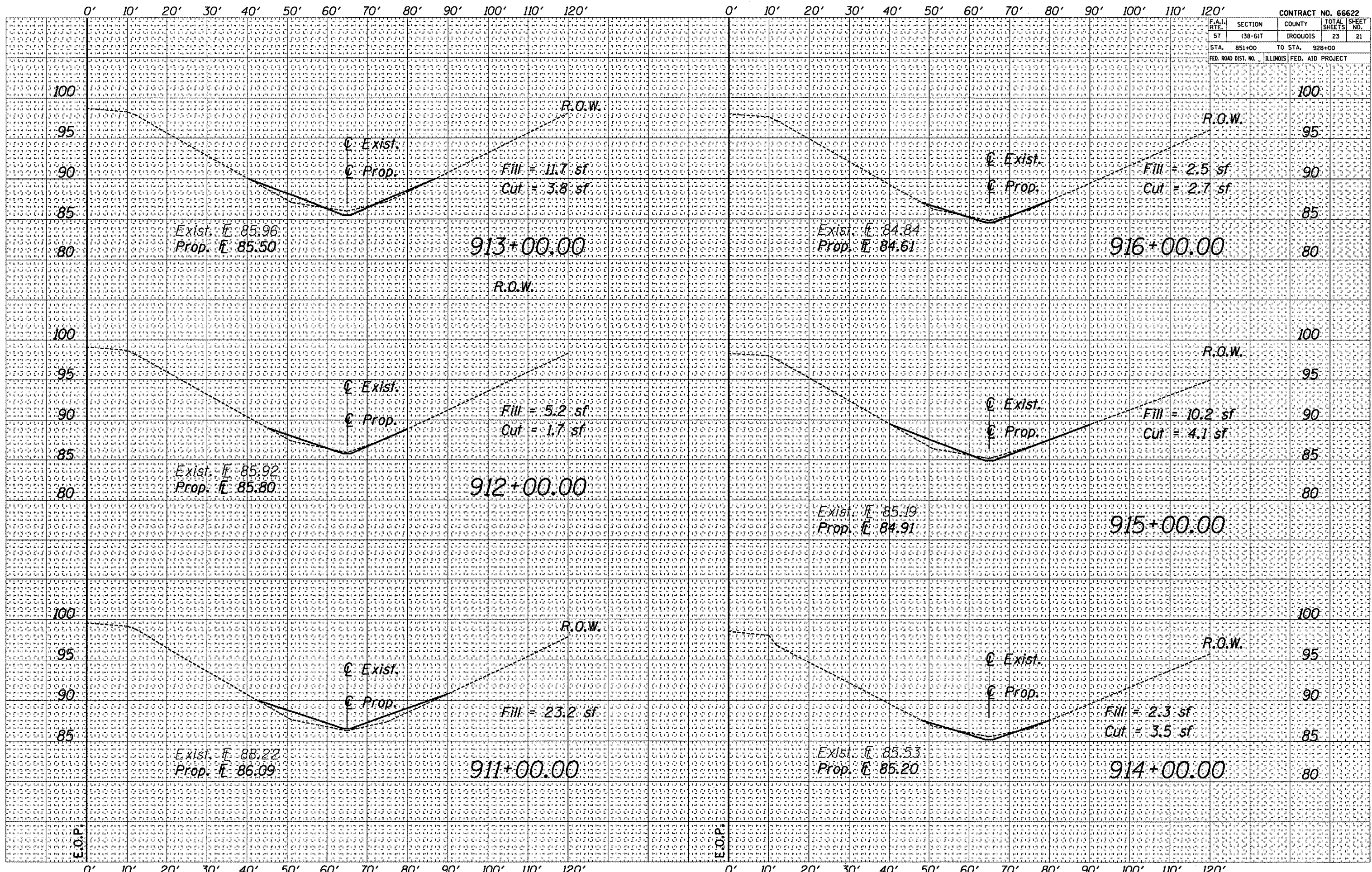

F.A.I. RTE.	SECTION	COUNTY	TOTAL SHEETS
57	(38-6)T	IROQUOIS	23
STA. 851+00	TO STA. 928+00		22
FED. ROAD DIST. NO.	ILLINOIS	FED. AID PROJECT	

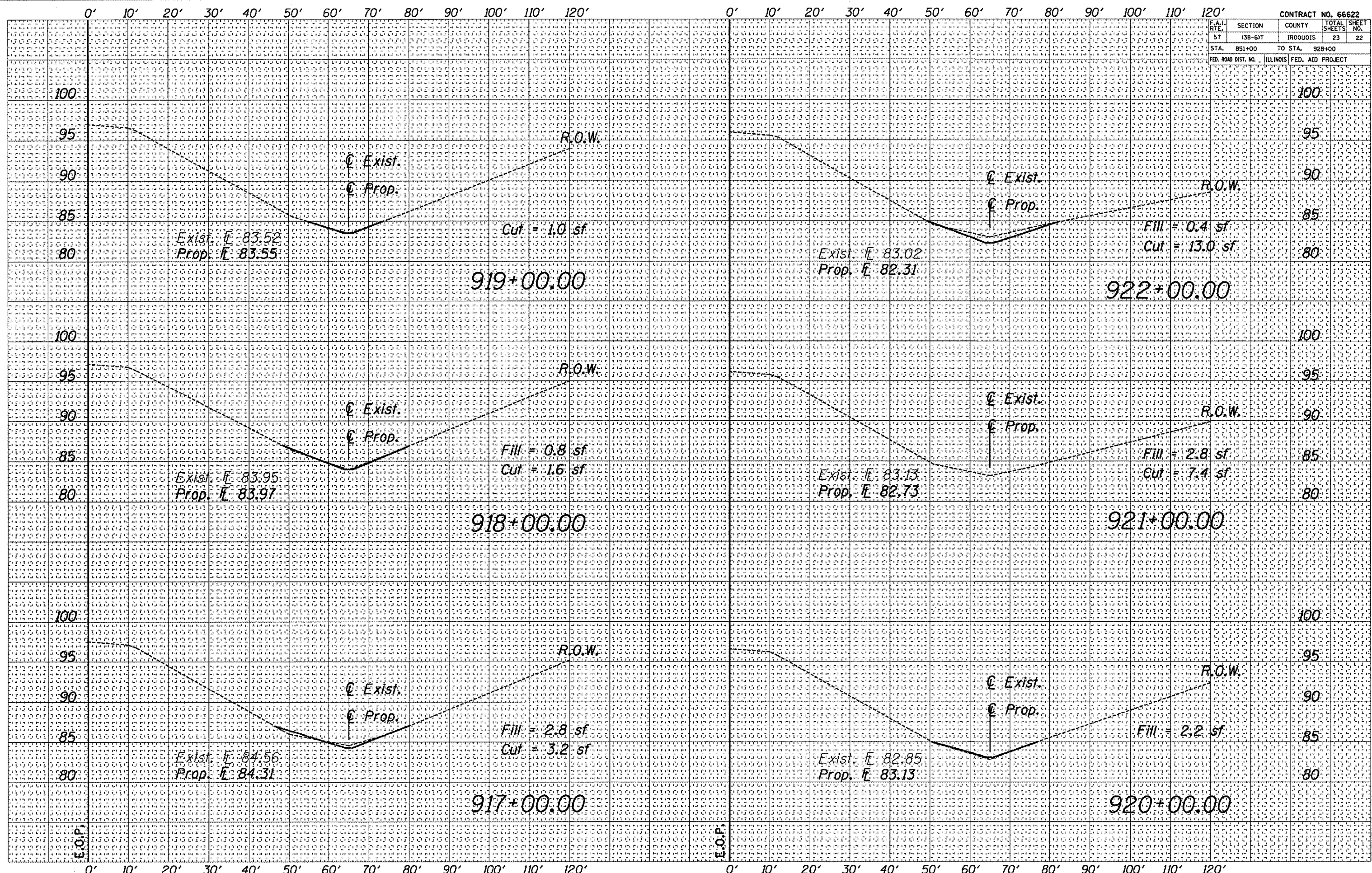

F.A.I. RTE.	SECTION	COUNTY	TOTAL SHEETS	SHEET NO.
57	(38-6)T	IROQUOIS	23	23
STA. 851+00	TO STA. 928+00			
FED. ROAD DIST. NO.	ILLINOIS	FED. AID PROJECT		

