

F.A.I. RTE.	SECTION	COUNTY	TOTAL SHEETS	SHEET NO.
80	(50-2HB)I-1	LASALLE	26	24
ILLINOIS			STATE PROJECT	

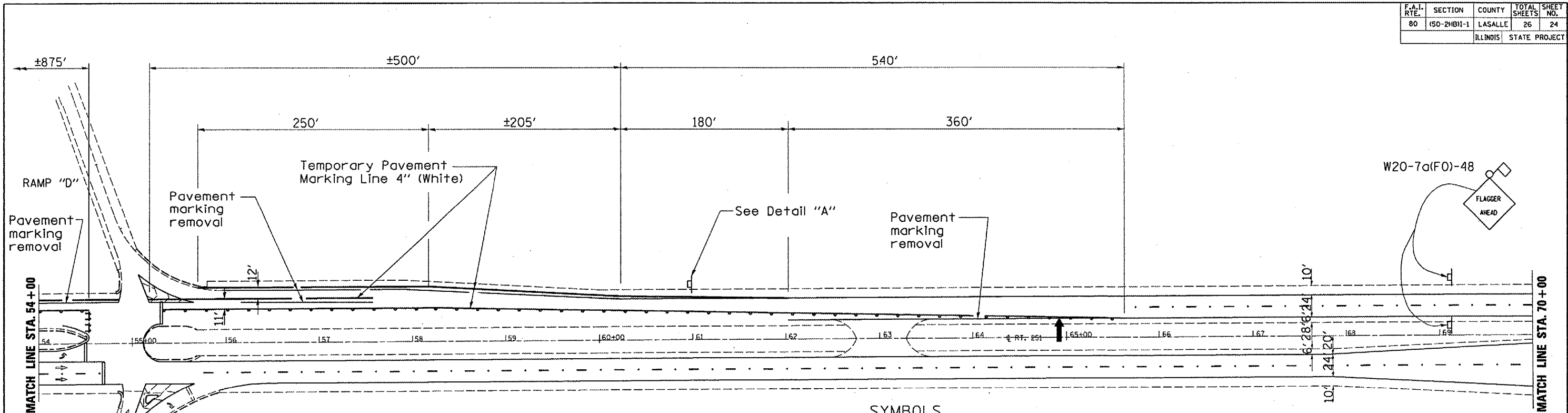

SYMBOLS

- Work area
- Sign
- Type III barricades or drums with steady burning monodirectional light
- Drums with steady burning monodirectional light @ 25' cts.
- Arrow Board

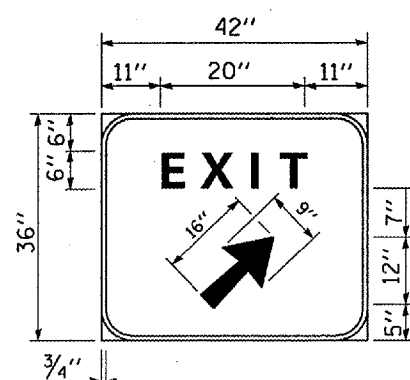

Background - Green
 Border and legend - White
 "D" size letters
 EXIT SIGN - SPECIAL

DETAIL A

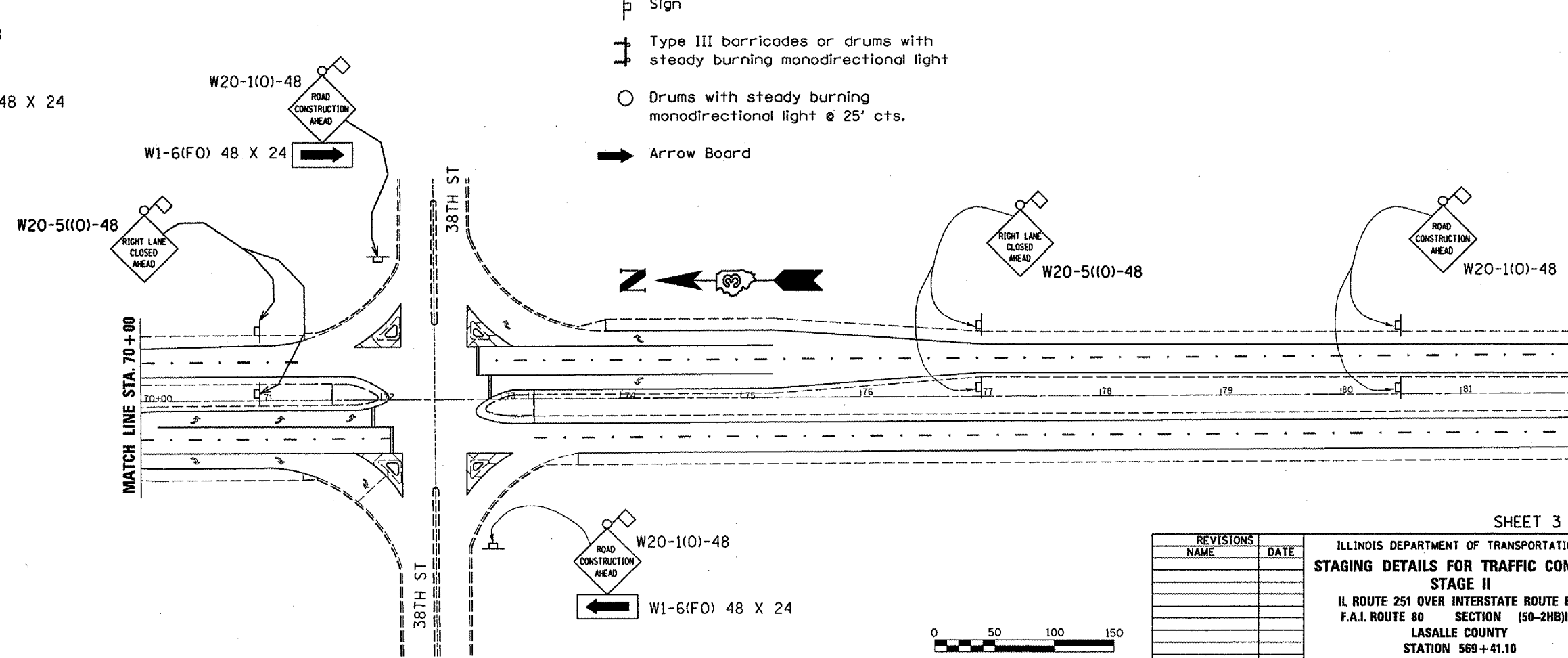

REVISIONS	
NAME	DATE

SHEET 3 OF 3

ILLINOIS DEPARTMENT OF TRANSPORTATION
STAGING DETAILS FOR TRAFFIC CONTROL
STAGE II
 IL ROUTE 251 OVER INTERSTATE ROUTE 80
 F.A.I. ROUTE 80 SECTION (50-2HB)I-1
 LASALLE COUNTY
 STATION 569 + 41.10

DATE 01/17/2006 DRAWN BY RLW

DATE: 01/17/2006
 c:\projects\main07\cm305\details.dgn