

ALIGNMENT TIES

F.A.P. RTE.	SECTION	COUNTY	TOTAL SHEETS	SHEET NO.
315	55-2	McDONOUGH	1025	61
STA.	TO STA.			
FED. ROAD DIST. NO. 4	ILLINOIS	FED. AID PROJECT		

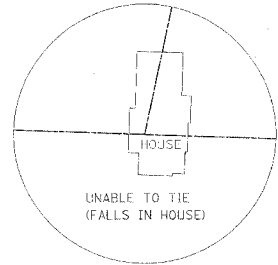

P.T. STA. 0+00.00
PROPOSED ϕ U.S. ROUTE 136 (RELOCATED) = STA. 139+91.36
PROPOSED ϕ IL. ROUTE 336
N=1362811.58
E=2104877.03

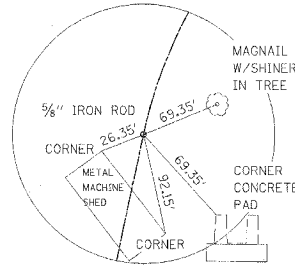

P.C. STA. 2+05.32
PROPOSED ϕ U.S. ROUTE 136 (RELOCATED)
CURVE NO. 136-1
N=1363012.46
E=2104919.45
EL. = 673.51

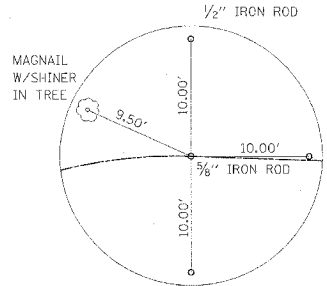

P.T. STA. 9+38.35
PROPOSED ϕ U.S. ROUTE 136 (RELOCATED)
CURVE NO. 136-1
N=1363428.70
E=2105450.74

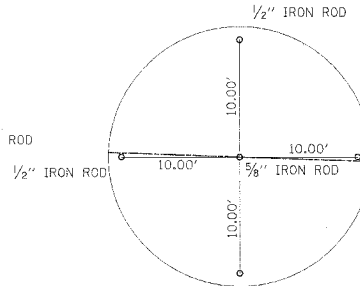

P.O.L. STA. 16+00.00
PROPOSED ϕ U.S. ROUTE 136 (RELOCATED)
N=1363406.49
E=2106112.02

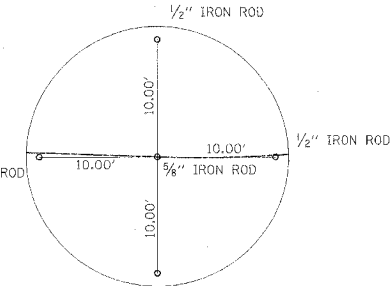

P.C. STA. 21+65.30
PROPOSED ϕ U.S. ROUTE 136 (RELOCATED)
CURVE NO. 136-2
N=1363387.52
E=2106677.00

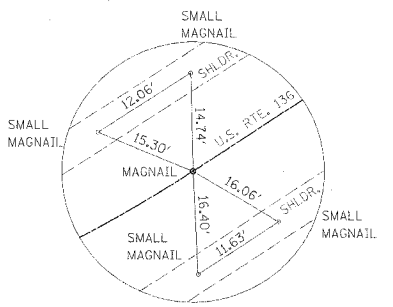

P.T. STA. 30+25.03
PROPOSED ϕ U.S. ROUTE 136 (RELOCATED)
CURVE NO. 136-2
N=1363616.08
E=2107491.83
EL. = 682.66

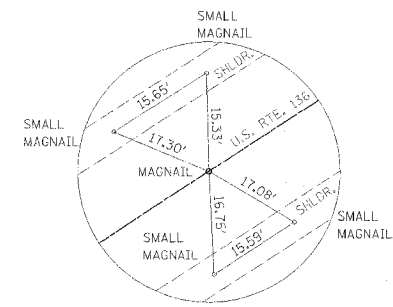

P.O.L. STA. 31+74.65
PROPOSED ϕ U.S. ROUTE 136 (RELOCATED)
CURVE NO. 136-2
N=1363698.15
E=2107616.94
EL. = 682.71

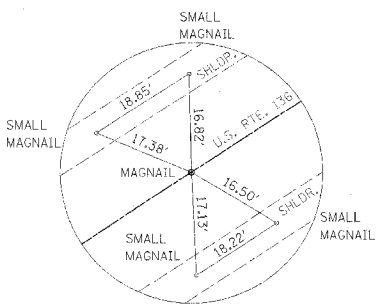

P.O.L. STA. 35+98.30
PROPOSED ϕ U.S. ROUTE 136 (RELOCATED)
CURVE NO. 136-2
N=1363929.65
E=2107971.74
EL. = 682.63

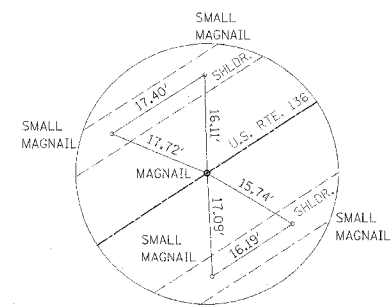

P.O.L. STA. 39+88.95
PROPOSED ϕ U.S. ROUTE 136 (RELOCATED)
CURVE NO. 136-2
N=1364144.02
E=2108296.32

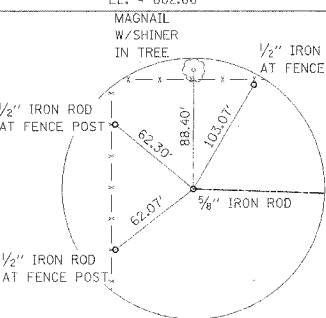

P.O.L. STA. 0+00.00
PROPOSED ϕ SERVICE DRIVE
N=1362556.41
E=2106610.46

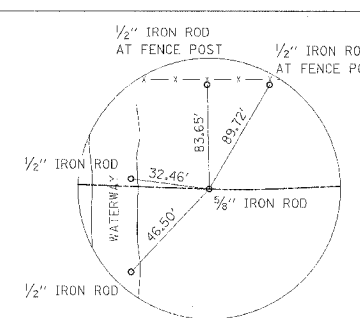

P.C. STA. 3+07.68
CURVE NO. SD-1
PROPOSED ϕ SERVICE DRIVE
N=1362546.08
E=2106917.97

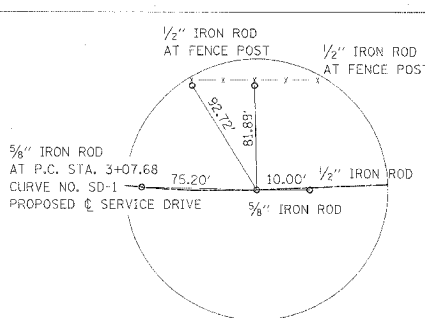

P.T. STA. 3+07.68
CURVE NO. SD-1
PROPOSED ϕ SERVICE DRIVE
N=1362546.39
E=2106993.15

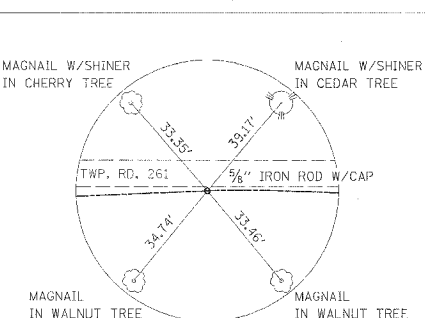

P.C. STA. 15+99.11
CURVE NO. SD-2
PROPOSED ϕ SERVICE DRIVE
N=1362597.01
E=2108208.33
EL. = 674.26

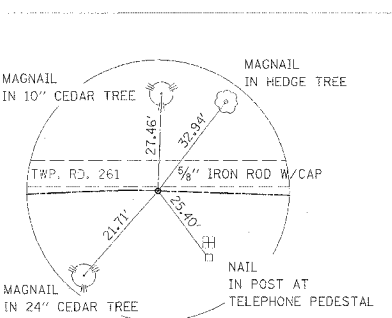

P.T. STA. 16+72.69
CURVE NO. SD-2
PROPOSED ϕ SERVICE DRIVE
N=1362597.37
E=2108281.89

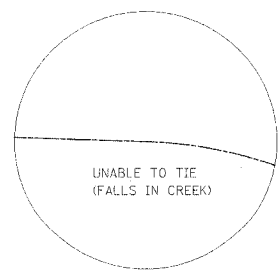

P.C. STA. 19+55.11
CURVE NO. SD-3
PROPOSED ϕ SERVICE DRIVE
N=1362588.35
E=2108564.17

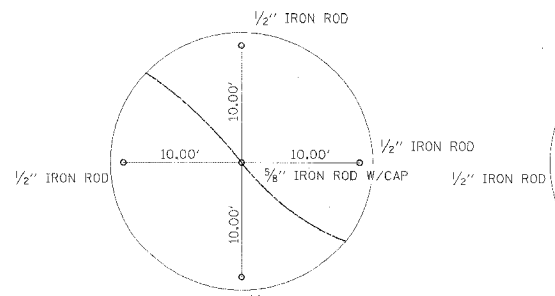

P.T. STA. 23+79.10
CURVE NO. SD-3
PROPOSED ϕ SERVICE DRIVE
N=1362401.20
E=2108929.34
EL. = 663.99

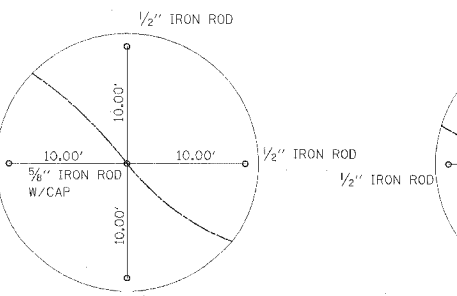

P.C. STA. 23+81.45
CURVE NO. SD-4
PROPOSED ϕ SERVICE DRIVE
N=1362399.33
E=2108930.78

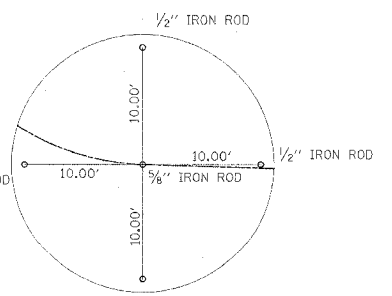

P.T. STA. 26+28.78
CURVE NO. SD-4
PROPOSED ϕ SERVICE DRIVE
N=1362290.16
E=2109143.80

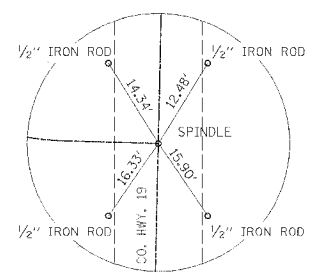

P.I. STA. 27+40.33
PROPOSED ϕ SERVICE DRIVE = STA. 5+95.46
EXISTING ϕ CO. HWY. 19
N=1362286.60
E=2109255.29
EL. = 674.19

REVISIONS	
NAME	DATE

ILLINOIS DEPARTMENT OF TRANSPORTATION
**ALIGNMENT TIES AND BENCHMARKS
U.S. ROUTE 136 (RELOCATED) AND
SERVICE DRIVE**

DATE 3/30/06
DRAWN BY
CHECKED BY