

F.A.P. RTE.	SECTION	COUNTY	TOTAL SHEET SHEETS NO.
315	55-2	MCDONOUGH	1025 72
STA. 139+00 TO STA. 155+00		FED. ROAD DIST. NO. 4 ILLINOIS FED. AID PROJECT	

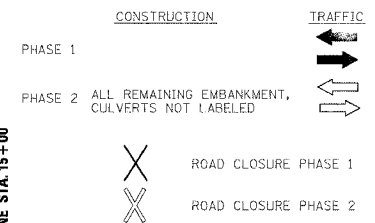

- CONSTRUCTION:**
1. CONSTRUCT TEMPORARY DRAINAGE (LT. SIDE U.S. ROUTE 136).
 2. CONSTRUCT TEMPORARY CONCRETE BARRIER AND ATTENUATORS, RT. STA. 139+00 TO STA. 142+24.
 3. CONSTRUCT EASTBOUND AND WESTBOUND IL. ROUTE 336, STA. 139+00 TO STA. 141+25+1 OMIT 10' SHOULDER EASTBOUND LANES, STA. 139+00 TO STA. 141+25.
 4. CONSTRUCT U.S. ROUTE 136 (RELOCATED) STA. 0+00 TO STA. 15+00

- TRAFFIC:**
1. MAINTAIN 2 WAY TRAFFIC ON EXISTING U.S. ROUTE 136.

TRAFFIC CONTROL:
HIGHWAY STANDARDS:
701006
701326

STAGE I PHASE 1

- * ① 20'± FIELD ACCESS PATH FOR FIELD ACCESS NEAR TOE OF FILL SLOPE.
 - ② & ③ TEMPORARY CROSSING FOR FARM PURPOSES.
 - ④ DRIVEWAY FOR FIELD ACCESS. (2 PROPERTIES)
- CONTRACTOR AND/OR RESIDENT ENGINEER TO COORDINATE WITH ADJACENT PROPERTY OWNERS TO PROVIDE FARMING ACCESS.

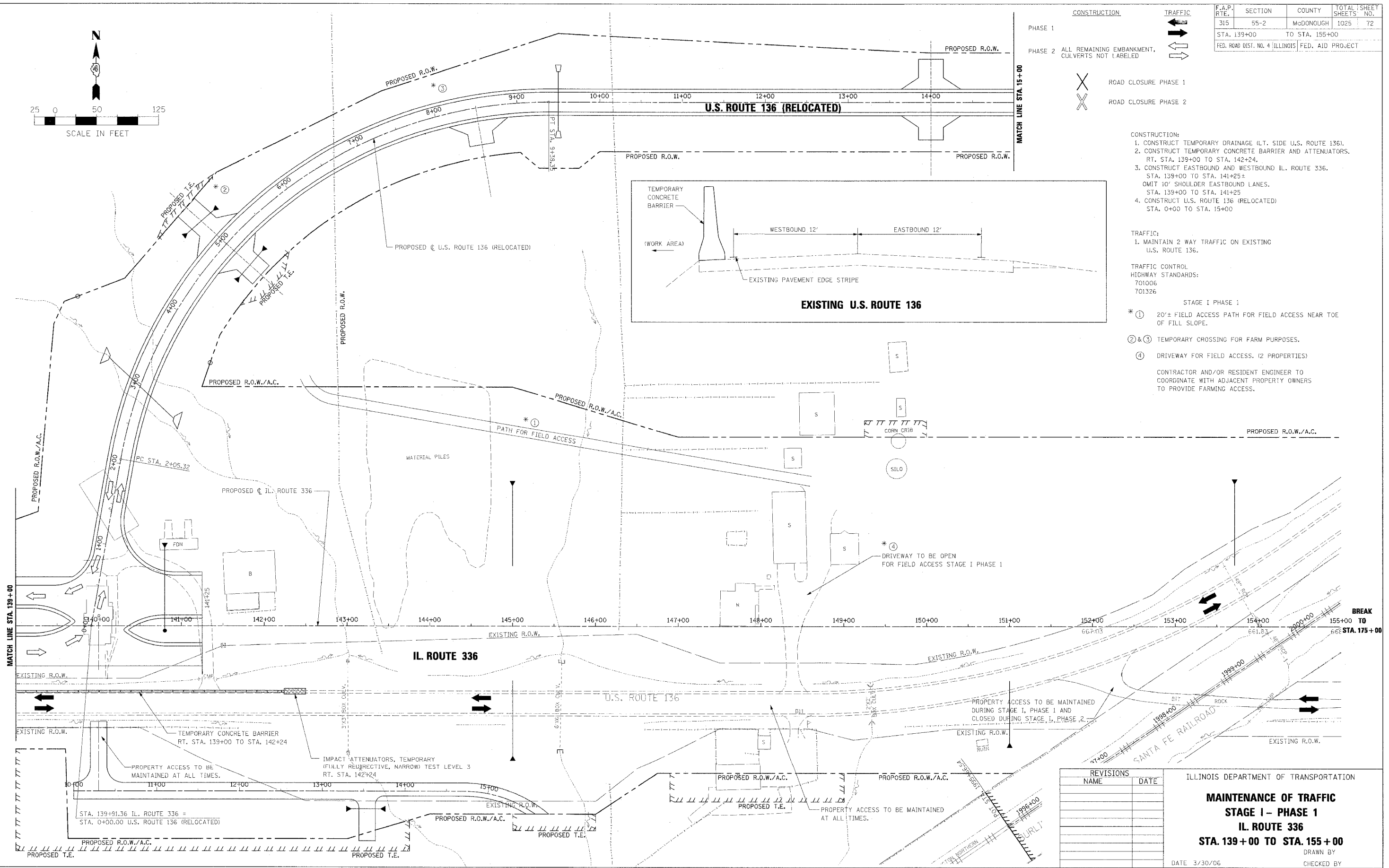
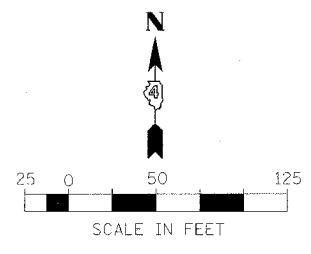

REVISIONS	
NAME	DATE

ILLINOIS DEPARTMENT OF TRANSPORTATION

**MAINTENANCE OF TRAFFIC
STAGE I - PHASE 1
IL. ROUTE 336
STA. 139+00 TO STA. 155+00**

DATE 3/30/06

DRAWN BY _____
CHECKED BY _____