

F.A.P. RTE.	SECTION	COUNTY	TOTAL SHEETS	SHEET NO.
315	55-2	McDONOUGH	1025	75
STA. 175+00		TO STA. 187+00		
FED. ROAD DIST. NO. 4 ILLINOIS FED. AID PROJECT				

- TRAFFIC**
- PHASE 1
 - PHASE 2
 - ROAD CLOSURE PHASE 1
 - ROAD CLOSURE PHASE 2
 - PHASE 1
 - PHASE 2
 - PHASE 1
 - PHASE 2
- CONSTRUCTION:**
- PHASE 1
 1. RECONSTRUCT TWP. RD. 350E.
 2. CONSTRUCT INTERSECTION OF IL. ROUTE 336 AND TWP. RD. 350E. STA. 183+00± TO STA. 185+00± TOP 2 LIFTS ON IL. RTE. 336 TO BE DONE IN STAGE II.
 3. CONSTRUCT SERVICE DRIVE. STA. 0+00 TO STA. 27+29.32
 4. CONSTRUCT DRAINAGE STRUCTURE STA. 176+31.26.
 - PHASE 2
 1. CONSTRUCT IL. ROUTE 336 EARTHWORK PRIOR TO STA. 183+00± AND AFTER STA. 185+00±.
- TRAFFIC:**
- PHASE 1
 1. TWP. RD. 350E CLOSED
 - PHASE 2
 1. OPEN TWP. RD. 350E USING TEMPORARY CROSSING.
 2. PROVIDE TYPE III BARRICADES ON IL. ROUTE 336 AS SHOWN.

NOTE:
FOR PERMANENT PAVEMENT MARKING SEE PAVEMENT MARKING AND SIGNING PLAN.

TRAFFIC CONTROL:
HIGHWAY STANDARDS:
BLR-18
BLR-22

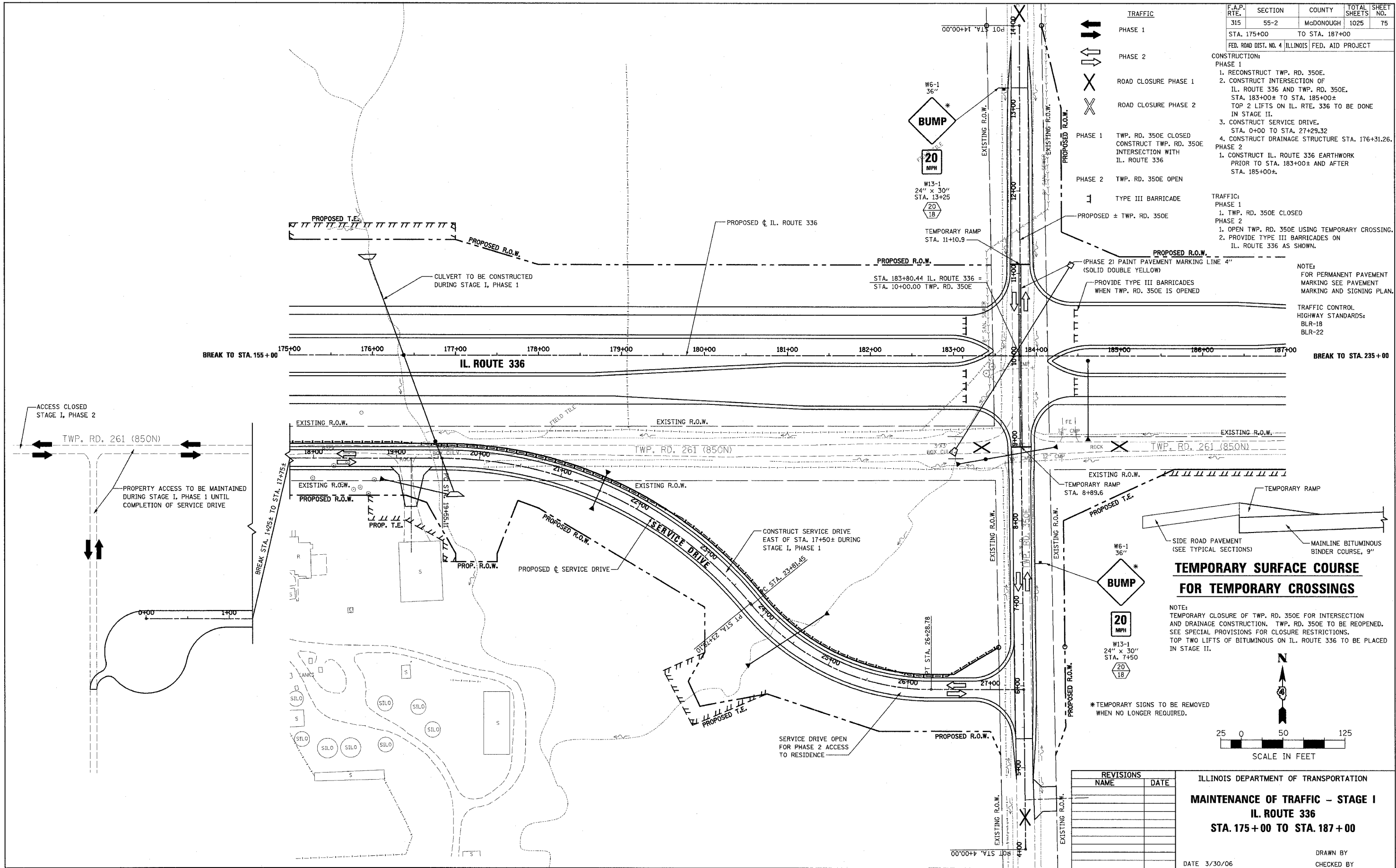

TEMPORARY SURFACE COURSE FOR TEMPORARY CROSSINGS

NOTE:
TEMPORARY CLOSURE OF TWP. RD. 350E FOR INTERSECTION AND DRAINAGE CONSTRUCTION. TWP. RD. 350E TO BE REOPENED. SEE SPECIAL PROVISIONS FOR CLOSURE RESTRICTIONS. TOP TWO LIFTS OF BITUMINOUS ON IL. ROUTE 336 TO BE PLACED IN STAGE II.

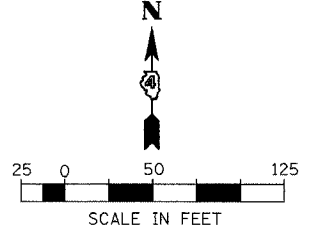

REVISIONS	
NAME	DATE

ILLINOIS DEPARTMENT OF TRANSPORTATION
MAINTENANCE OF TRAFFIC - STAGE I
IL. ROUTE 336
STA. 175+00 TO STA. 187+00

DATE 3/30/06
DRAWN BY
CHECKED BY