

F.A.P. RTE.	SECTION	COUNTY	TOTAL SHEETS	SHEET NO.
315	55-2	McDONOUGH	1025	80
STA. 383+00		TO STA. 412+00		
FED. ROAD DIST. NO. 4 ILLINOIS FED. AID PROJECT				

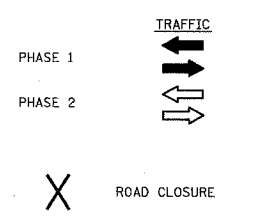

NOTE:  
SEE PERMANENT PAVEMENT MARKING PLANS FOR TWP. RD. 200 (RELOCATED) AND TWP. RD. 900N (RELOCATED).

**TRAFFIC AND CONSTRUCTION**

**PHASE 1:**  
TWP. RD. 900N AND TWP. RD. 200 CLOSED, SIGNED DETOUR ROUTE, CONSTRUCT TWP. RD. 900N (RELOCATED) AND TWP. RD. 200 (RELOCATED).

**TRAFFIC CONTROL**  
HIGHWAY STANDARD:  
BLR-22

**PHASE 2:**  
REMOVE DETOUR SIGNING, OPEN TWP. RD. 900N (RELOCATED) AND TWP. RD. 200 (RELOCATED), CONTINUE WITH IL. ROUTE 336 CONSTRUCTION.

**NOTE:**  
COORDINATE WITH PROPERTY OWNERS TO PROVIDE FIELD ACCESS WHEN REQUIRED AND FULL-TIME ACCESS TO THE RESIDENCE.

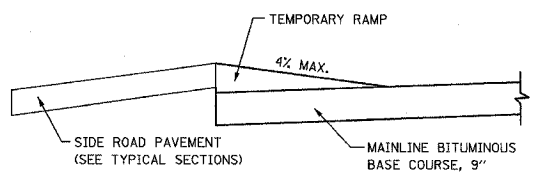
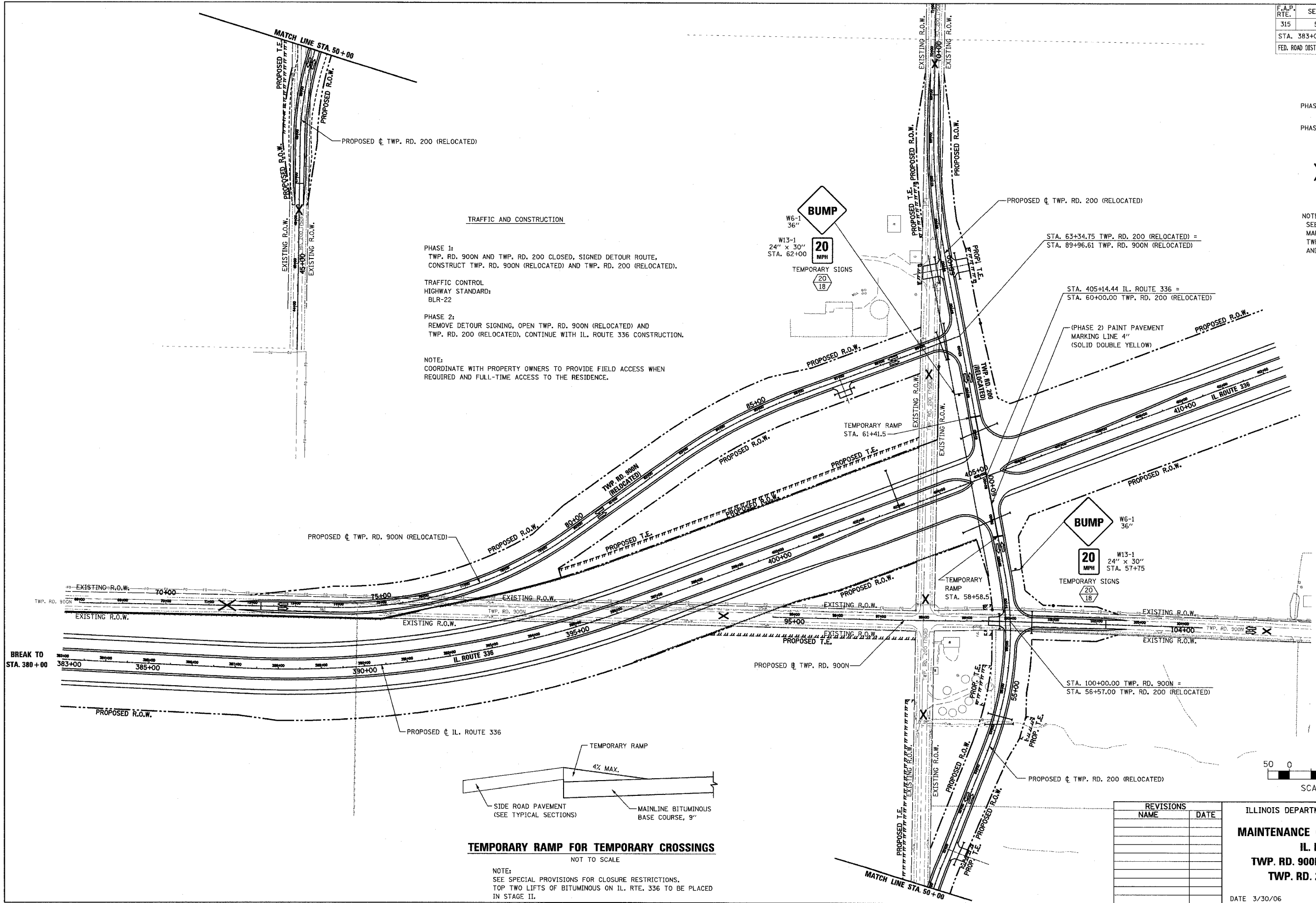

**TEMPORARY RAMP FOR TEMPORARY CROSSINGS**  
NOT TO SCALE

NOTE:  
SEE SPECIAL PROVISIONS FOR CLOSURE RESTRICTIONS.  
TOP TWO LIFTS OF BITUMINOUS ON IL. RTE. 336 TO BE PLACED IN STAGE II.

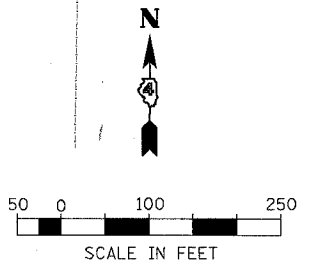
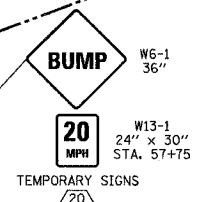

REVISIONS	
NAME	DATE

ILLINOIS DEPARTMENT OF TRANSPORTATION  
**MAINTENANCE OF TRAFFIC - STAGE I**  
**IL. ROUTE 336**  
**TWP. RD. 900N (RELOCATED) AND**  
**TWP. RD. 200 (RELOCATED)**  
DRAWN BY  
DATE 3/30/06  
CHECKED BY