



F.A.P. RTE.	SECTION	COUNTY	TOTAL SHEETS	SHEET NO.
315	55-2	McDONOUGH	1025	85
STA. 100+00		TO STA. 113+00		
FED. ROAD DIST. NO. 4		ILLINOIS FED. AID PROJECT		

DIRECTION OF TRAFFIC FLOW 

 TYPE III BARRICADE  
 ROAD CLOSURE

- CONSTRUCTION:
1. OPEN TWP. RD. 118.
  2. REMOVE TWP. RD. 118 (TEMPORARY RUN-AROUND).
  3. COMPLETE GAPPED AREA OF IL. ROUTE 336.
  4. RESTORE TO ORIGINAL CONDITION DISTURBED AREAS OF TEMPORARY RUN-AROUND INSIDE TEMPORARY EASEMENT.
  5. COMPLETE PAVEMENT AND DRAINAGE.
  6. REMOVE TEMPORARY SIGNS

TRAFFIC:  
1. TWP. RD. 118 REOPENED.

TRAFFIC CONTROL  
HIGHWAY STANDARDS:  
701001  
701006  
701201  
BLR-18

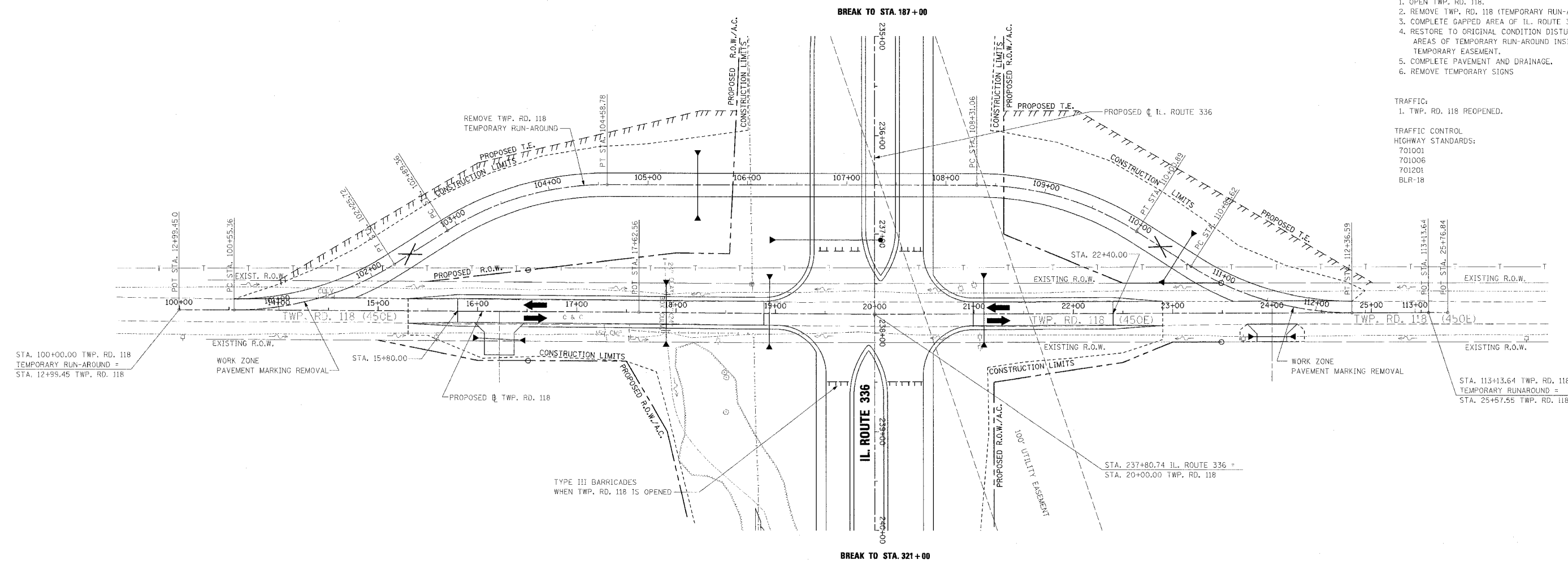

STA. 100+00.00 TWP. RD. 118  
TEMPORARY RUN-AROUND =  
STA. 12+99.45 TWP. RD. 118

WORK ZONE  
PAVEMENT MARKING REMOVAL

PROPOSED  $\emptyset$  TWP. RD. 118

TYPE III BARRICADES  
WHEN TWP. RD. 118 IS OPENED

STA. 237+80.74 IL. ROUTE 336 =  
STA. 20+00.00 TWP. RD. 118

STA. 113+13.64 TWP. RD. 118  
TEMPORARY RUNAROUND =  
STA. 25+57.55 TWP. RD. 118

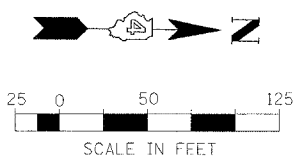

REVISIONS	
NAME	DATE

ILLINOIS DEPARTMENT OF TRANSPORTATION  
**MAINTENANCE OF TRAFFIC – STAGE II**  
**TWP. RD. 118 TEMPORARY RUN-AROUND**  
**STA. 100+00 TO STA. 113+00**

DATE 3/30/06  
DRAWN BY  
CHECKED BY