

F.A.P. RTE.	SECTION	COUNTY	TOTAL SHEETS	SHEET NO.
315	55-2	McDONOUGH	1025	166
STA. 150+00 TO STA. 161+00				
FED. ROAD DIST. NO. 4 ILLINOIS FED. AID PROJECT				

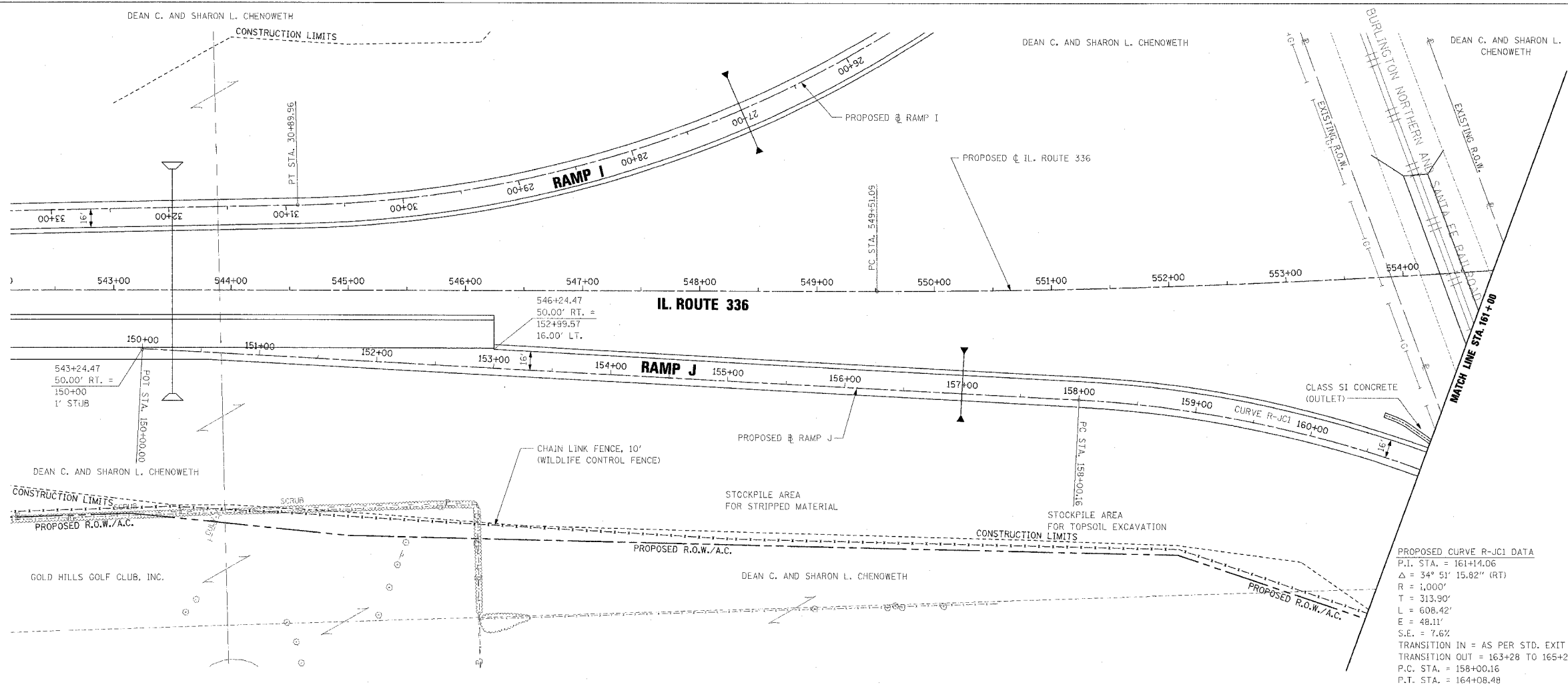

PROPOSED CURVE R-JC1 DATA  
 P.I. STA. = 161+14.06  
 $\Delta = 34^\circ 51' 15.82''$  (RT)  
 R = 1,000'  
 T = 313.90'  
 L = 608.42'  
 E = 48.11'  
 S.E. = 7.6%  
 TRANSITION IN = AS PER STD. EXIT TERMINAL  
 TRANSITION OUT = 163+28 TO 165+23  
 P.C. STA. = 158+00.16  
 P.T. STA. = 164+08.48

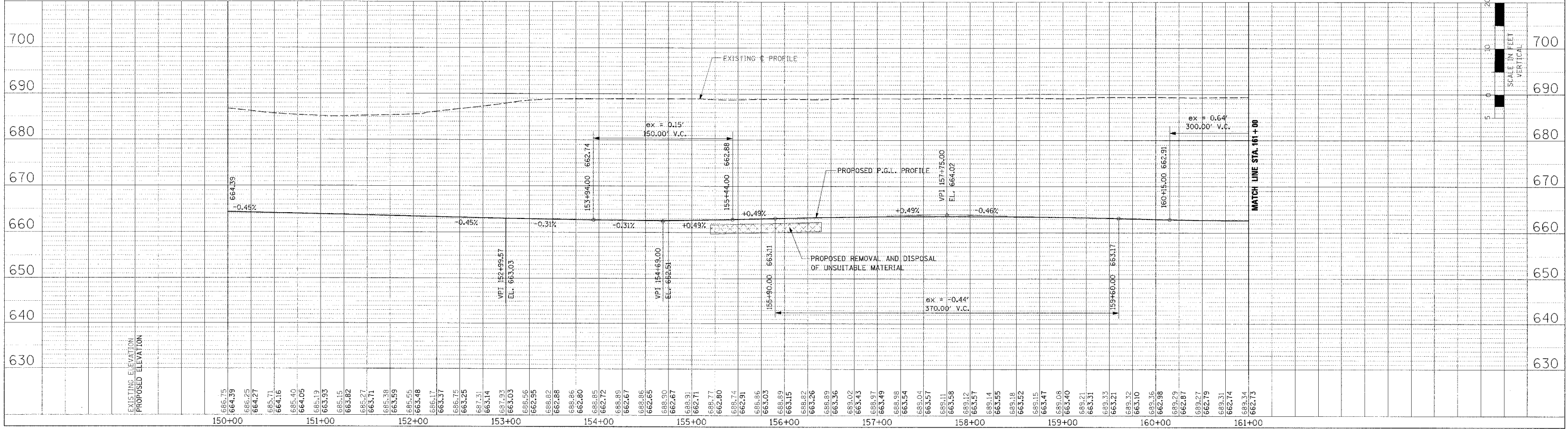
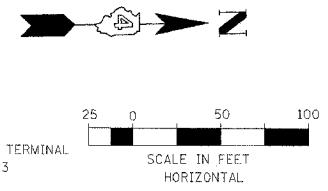

ROADWAY PLAN AND PROFILE - RAMP J - STA. 150+00 TO STA. 161+00

PLAN	DATE
DESIGNED	BY
CHECKED	BY
NOTED	BY
FILED	BY

PROFILE	DATE
DESIGNED	BY
CHECKED	BY
NOTED	BY
FILED	BY