

F.A.P. RTE.	SECTION	COUNTY	TOTAL SHEETS	SHEET NO.
315	55-2	McDONOUGH	1025	349
STA. 32+00		TO STA. 42+39.96		
FED. ROAD DIST. NO. 4 ILLINOIS FED. AID PROJECT				

- TEMPORARY EROSION CONTROL LEGEND**
- TEMPORARY DITCH CHECK
 - INLET AND PIPE PROTECTION
 - EROSION CONTROL BLANKET
 - HEAVY DUTY EROSION CONTROL BLANKET
 - AGGREGATE DITCH (TO BE PLACED UPON COMPLETION OF DITCH CUT)
 - PERIMETER EROSION BARRIER

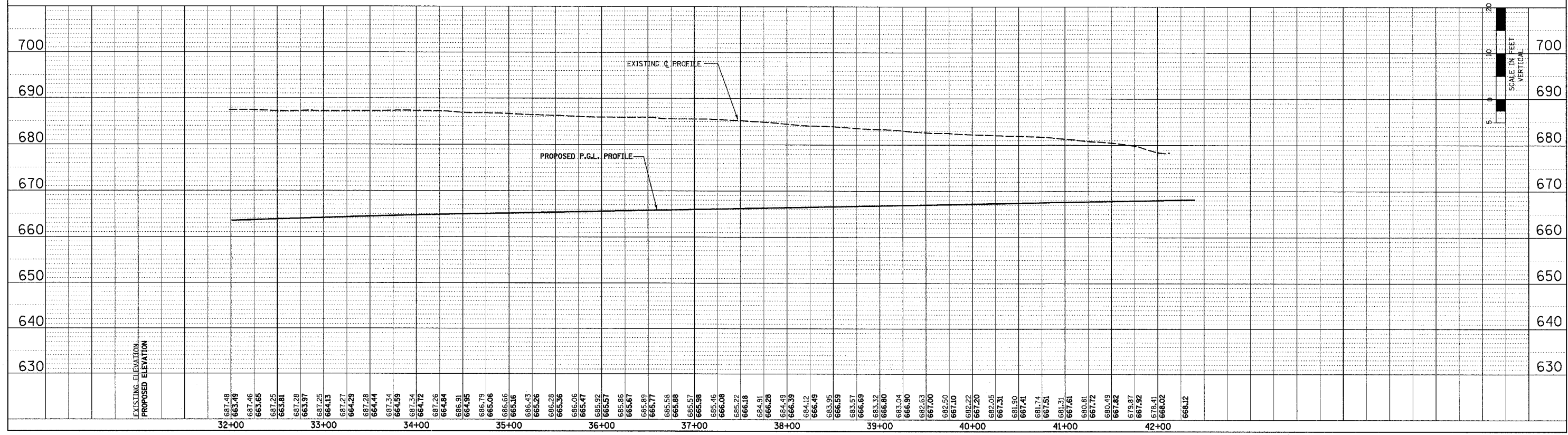
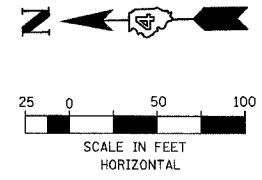
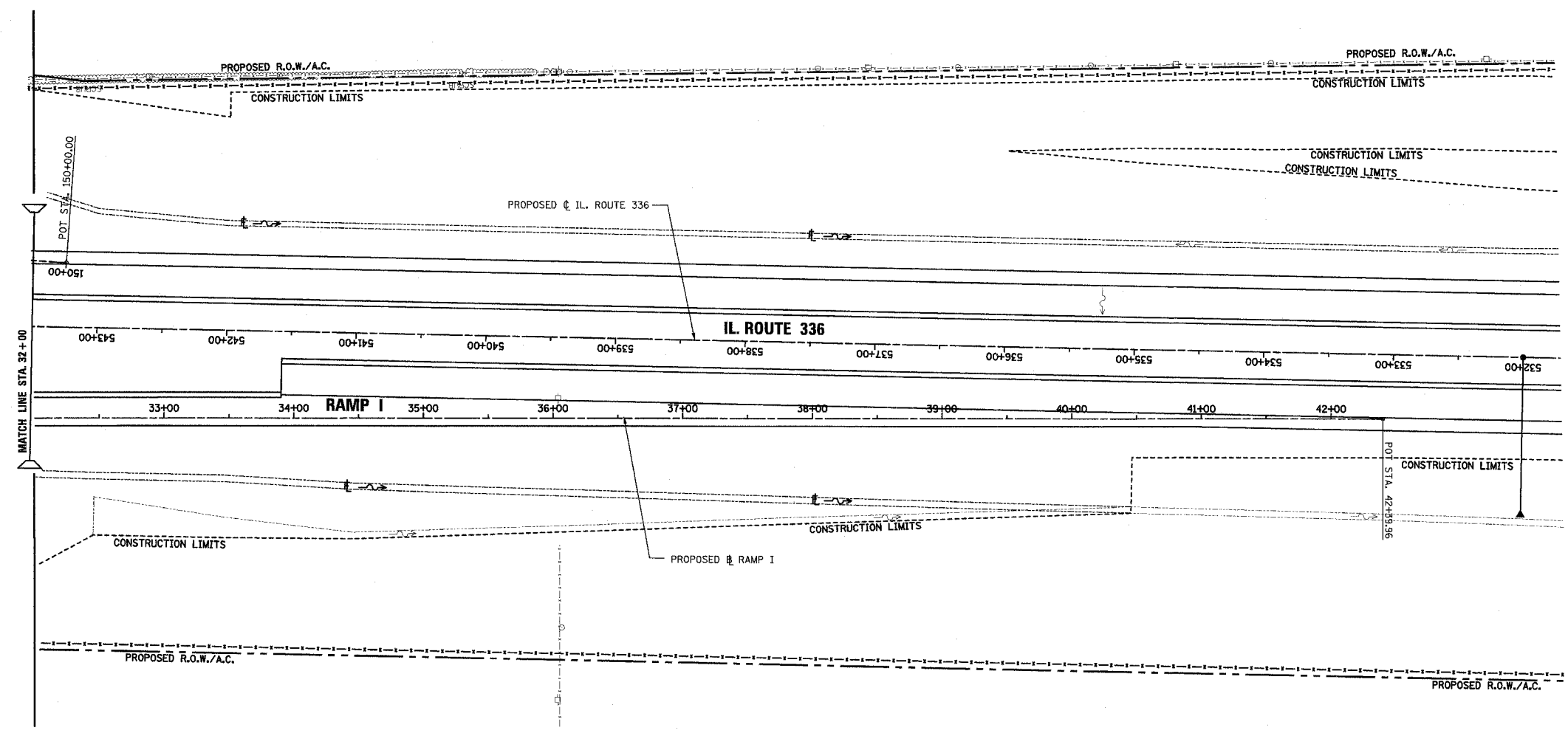

EROSION CONTROL PLAN AND PROFILE - RAMP I - STA. 32+00 TO STA. 42+39.96

PLAN

REVISIONS	BY	DATE
PLOTTED		
ALIGNMENT CHECKED		
FIELD FILE NAME		
NO.		

PROFILE

REVISIONS	BY	DATE
GRADES CHECKED		
STRUCTURE NOTATIONS OK'D		
NO.		

RAMP I EROSION CONTROL PLAN AND PROFILE - STA. 32+00 TO STA. 42+39.96