

F.A.P. RITE	SECTION	COUNTY	TOTAL SHEETS	SHEET NO.
315	55-2	McDONOUGH	1025	397
STA. 281+00		TO STA. 305+00		
FED. ROAD DIST. NO. 4		ILLINOIS FED. AID PROJECT		

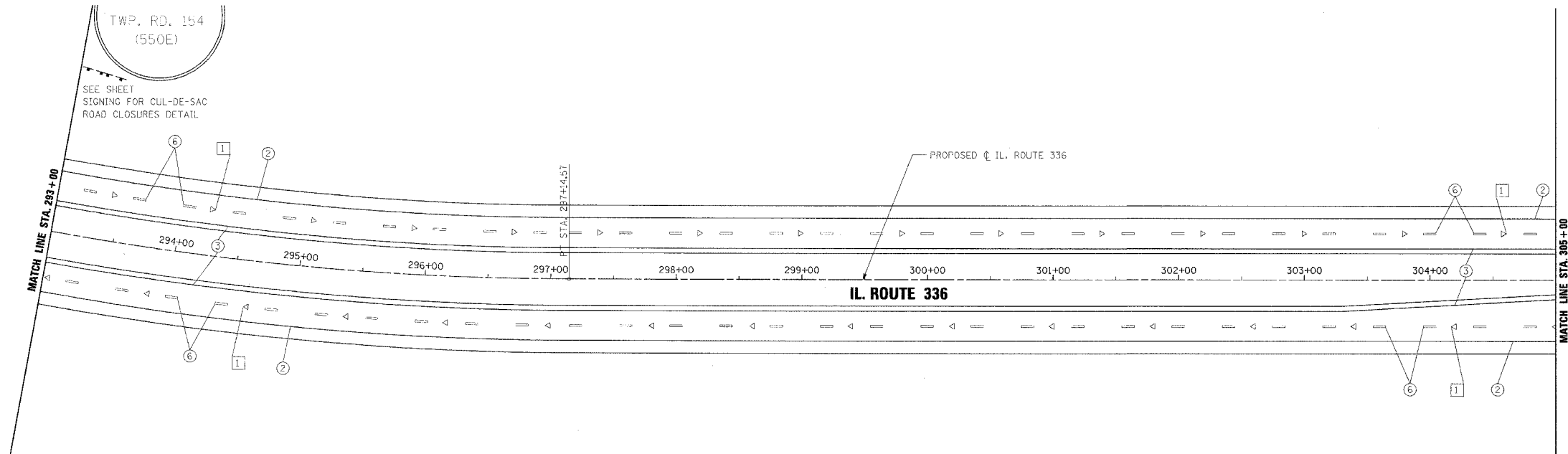

- PAVEMENT MARKING LEGEND**
- ① EPOXY PAVEMENT MARKING - LETTERS AND SYMBOLS
  - ② EPOXY PAVEMENT MARKING - LINE 4" WHITE SOLID
  - ③ EPOXY PAVEMENT MARKING - LINE 4" YELLOW SOLID
  - ④ EPOXY PAVEMENT MARKING - LINE 4" YELLOW SOLID (DOUBLE LINE)
  - ⑤ EPOXY PAVEMENT MARKING - LINE 4" YELLOW SKIP DASH
  - ⑥ PREFORMED PLASTIC PAVEMENT MARKING - LINE 6" WHITE SKIP DASH
  - ⑦ EPOXY PAVEMENT MARKING - LINE 8" WHITE SOLID
  - ⑧ EPOXY PAVEMENT MARKING - LINE 8" WHITE SKIP DASH
  - ⑨ EPOXY PAVEMENT MARKING - LINE 12" WHITE SOLID
  - ⑩ EPOXY PAVEMENT MARKING - LINE 12" YELLOW SOLID
  - ⑪ EPOXY PAVEMENT MARKING - LINE 24" WHITE SOLID (STOP BAR)
1. PAVEMENT MARKINGS SHALL BE IN ACCORDANCE WITH DISTRICT CADD DETAILS - STANDARD 780001.

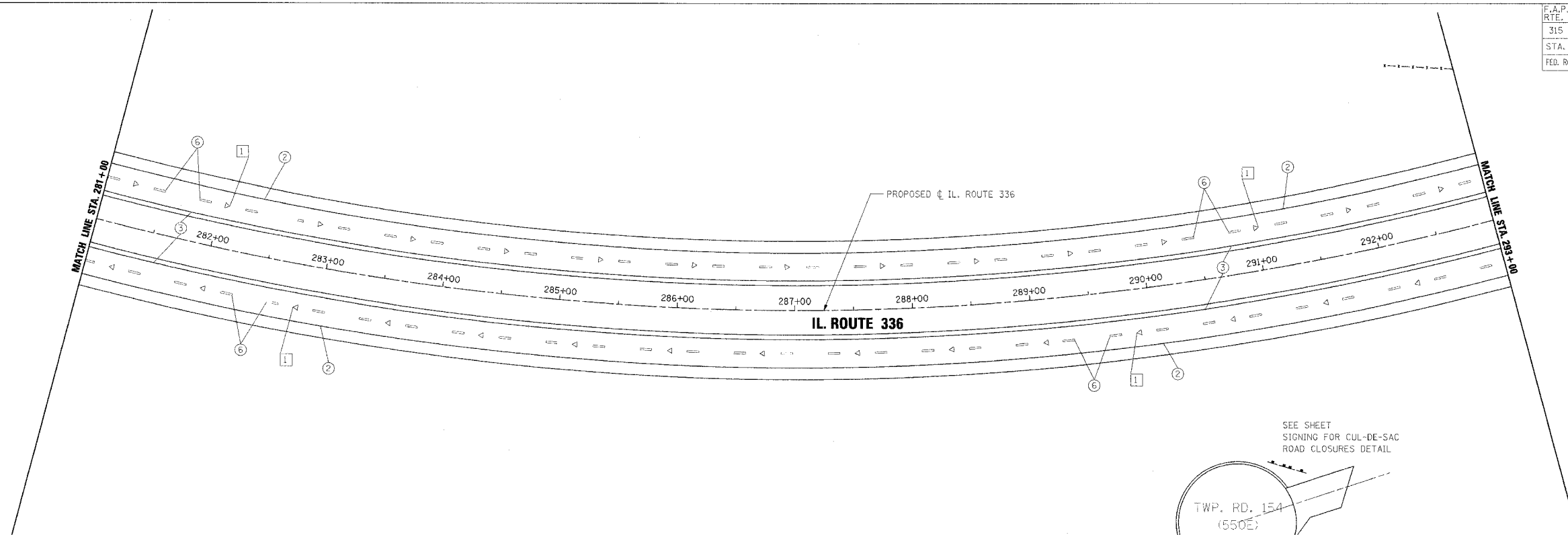
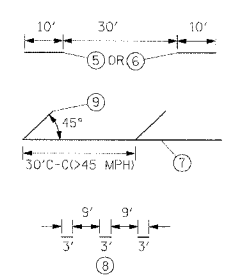

- RAISED REFLECTIVE PAVEMENT MARKERS (RRPM) LEGEND**
- ① ▲ ONE-WAY CRYSTAL MARKER AT 80' CENTERS
  - ② ▲ ONE-WAY CRYSTAL MARKER AT 40' CENTERS
  - ③ ▲ ONE-WAY CRYSTAL MARKER AT 20' CENTERS
  - ④ ▲ ONE-WAY AMBER MARKER AT 40' CENTERS
  - ⑤ ▲ ONE-WAY AMBER MARKER AT 20' CENTERS
  - ⑥ ◆ TWO-WAY AMBER MARKER AT 40' CENTERS

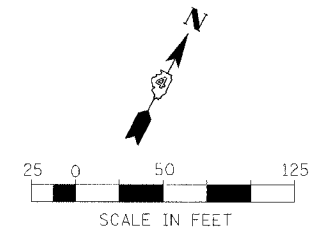
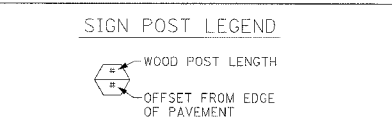

REVISIONS	
NAME	DATE

ILLINOIS DEPARTMENT OF TRANSPORTATION  
**PAVEMENT MARKING AND SIGNING**  
**IL. ROUTE 336**  
**STA. 281+00 TO STA. 305+00**

DATE 3/30/06

DRAWN BY \_\_\_\_\_  
CHECKED BY \_\_\_\_\_