

F.A.P. RTE.	SECTION	COUNTY	TOTAL SHEETS	SHEET NO.
315	55-2	McDONOUGH	1025	411
STA. 0+00.00		TO STA. 18+50		
FED. ROAD DIST. NO. 4 ILLINOIS FED. AID PROJECT				

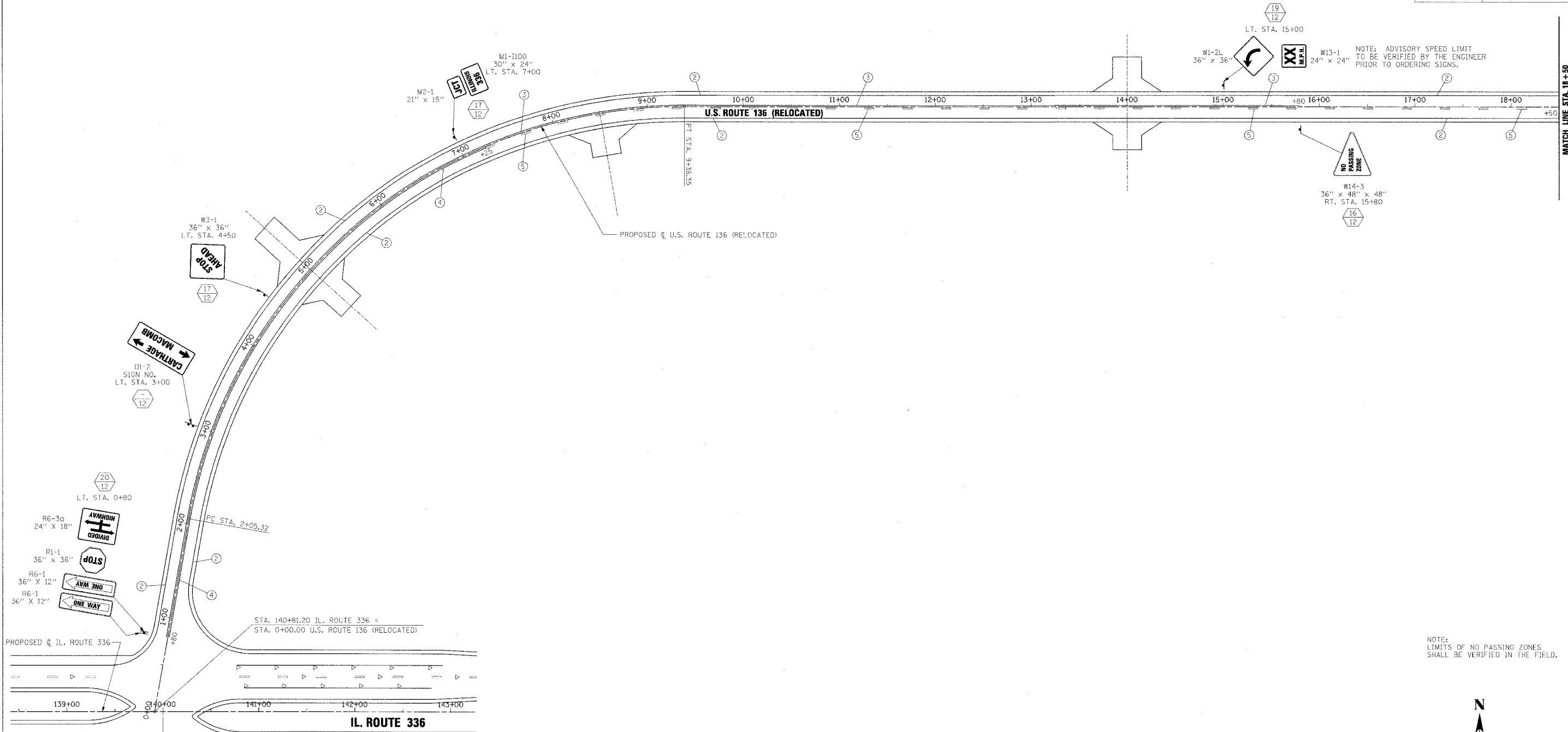

NOTE: ADVISORY SPEED LIMIT TO BE VERIFIED BY THE ENGINEER PRIOR TO ORDERING SIGNS.

NOTE: LIMITS OF NO PASSING ZONES SHALL BE VERIFIED IN THE FIELD.

①	EPOXY PAVEMENT MARKING - LETTERS AND SYMBOLS
②	EPOXY PAVEMENT MARKING - LINE 4" WHITE SOLID
③	EPOXY PAVEMENT MARKING - LINE 4" YELLOW SOLID
④	EPOXY PAVEMENT MARKING - LINE 4" YELLOW SOLID (DOUBLE LINE)
⑤	EPOXY PAVEMENT MARKING - LINE 4" YELLOW SKIP DASH
⑥	PREFORMED PLASTIC PAVEMENT MARKING - LINE 6" WHITE SKIP DASH
⑦	EPOXY PAVEMENT MARKING - LINE 8" WHITE SOLID
⑧	EPOXY PAVEMENT MARKING - LINE 8" WHITE SKIP DASH
⑨	EPOXY PAVEMENT MARKING - LINE 12" WHITE SOLID
⑩	EPOXY PAVEMENT MARKING - LINE 12" YELLOW SOLID
⑪	EPOXY PAVEMENT MARKING - LINE 24" WHITE SOLID (STOP BAR)

1. PAVEMENT MARKINGS SHALL BE IN ACCORDANCE WITH DISTRICT CADD DETAILS - STANDARD 780001.

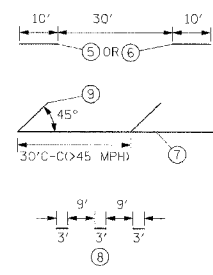

①	▲ ONE-WAY CRYSTAL MARKER AT 80' CENTERS
②	▲ ONE-WAY CRYSTAL MARKER AT 40' CENTERS
③	▲ ONE-WAY CRYSTAL MARKER AT 20' CENTERS
④	▲ ONE-WAY AMBER MARKER AT 40' CENTERS
⑤	▲ ONE-WAY AMBER MARKER AT 20' CENTERS
⑥	◆ TWO-WAY AMBER MARKER AT 40' CENTERS

①	WOOD POST LENGTH
②	OFFSET FROM EDGE OF PAVEMENT

NAME	DATE

ILLINOIS DEPARTMENT OF TRANSPORTATION
PAVEMENT MARKING AND SIGNING
U.S. ROUTE 136 (RELOCATED)
STA. 0+00.00 TO STA. 18+50

DATE 3/30/06
DRAWN BY
CHECKED BY