

Benchmark: Chiseled "□" on W. Headwall of Box Culvert (N. End) 1.2 miles S. of Rte. 136 on 850 E. Elevation = 610.51

Existing Structure: None

STATE OF ILLINOIS
DEPARTMENT OF TRANSPORTATION

ROUTE NO.	SECTION	COUNTY	TOTAL SHEETS	SHEET NO.
F.A.P. 315	55-2	McDONOUGH	1025	442
FED. ROAD DIST. NO. 4	ILLINOIS	FED. AID PROJECT		

Contract No. 68205

INDEX OF SHEETS

- Sheet
- 1 General Plan & Elevation
 - 2 General Notes & Total Bill of Material
 - 3 Plan With Apron Detail
 - 4 Sections & Reinforcement, Bill of Material
 - 5 Reinforcement Bars
 - 6-7 Boring Logs

SEISMIC DATA

Seismic Performance Category (SPC) = A
Bedrock Acceleration Coefficient (A) = 4.0%
Site Coefficient (S) = 1.0

LOADING HS20-44

Allow 50#/sq. ft. for future wearing surface.

DESIGN SPECIFICATIONS

2002 AASHTO

DESIGN STRESSES

FIELD UNITS

$f'_c = 3,500$ psi
 $f_y = 60,000$ psi (Reinf.)

$\Delta = 32^\circ-22'-09.34"$ (LT)
 $R = 4,250'$
 $D = 1^\circ-20'-53.29"$
 $T = 1,233.50'$
 $L = 2,401.04'$
 $E = 175.38'$
Trans. In = Sta. 477+55.00 to Sta. 481+80.00
Trans. Out = Sta. 502+95.00 to Sta. 507+20.00
S.E. = 4.20%
P.C. Sta. = 480+37.41
P.T. Sta. = 504+38.45
P.I. Sta. = 492+70.91

IL 336 PROPOSED
CURVE DATA

WATERWAY INFORMATION

Drainage Area = 1.90 sq. mi. Low Grade Elev. 616.98 @ Sta. 479+53.10

Flood	Freq. Yr.	Q C.F.S.	Opening Sq. Ft.		*Nat. H.W.E.	Head - Ft.		Headwater El.	
			Exist.	Prop.		Exist.	Prop.	Exist.	Prop.
Design	50	1144	-	168	604.45	-	0.24	-	604.21
Base	100	1345	-	168	604.16	-	0.98	-	605.14
Overtopping	-	-	-	-	-	-	-	-	-
Max. Calc.	500	1974	-	168	604.50	-	3.07	-	607.57

* upstream face of culvert

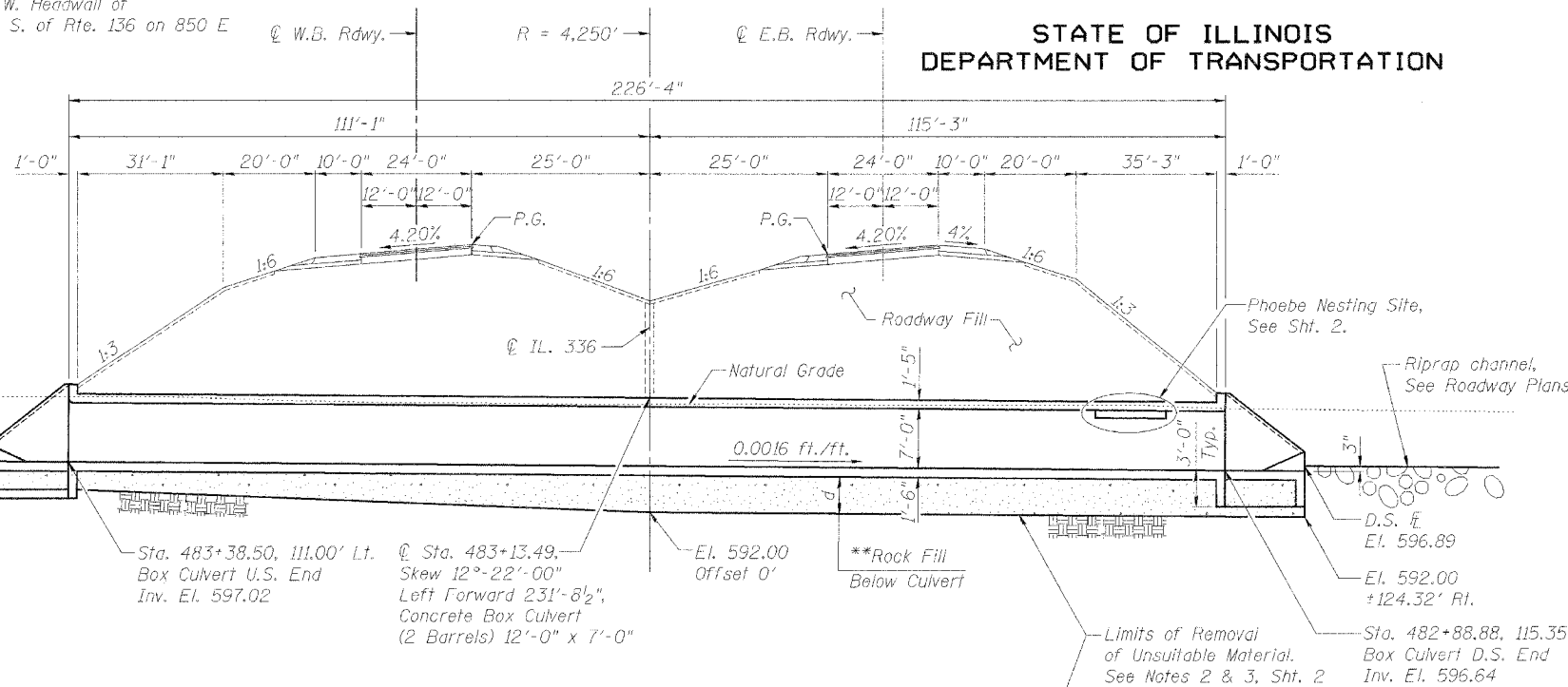

LONGITUDINAL SECTION

(Looking North)

Roadway and Fill Dimensions are at Right L's to Roadway

**See Soil Boring Log Sheets

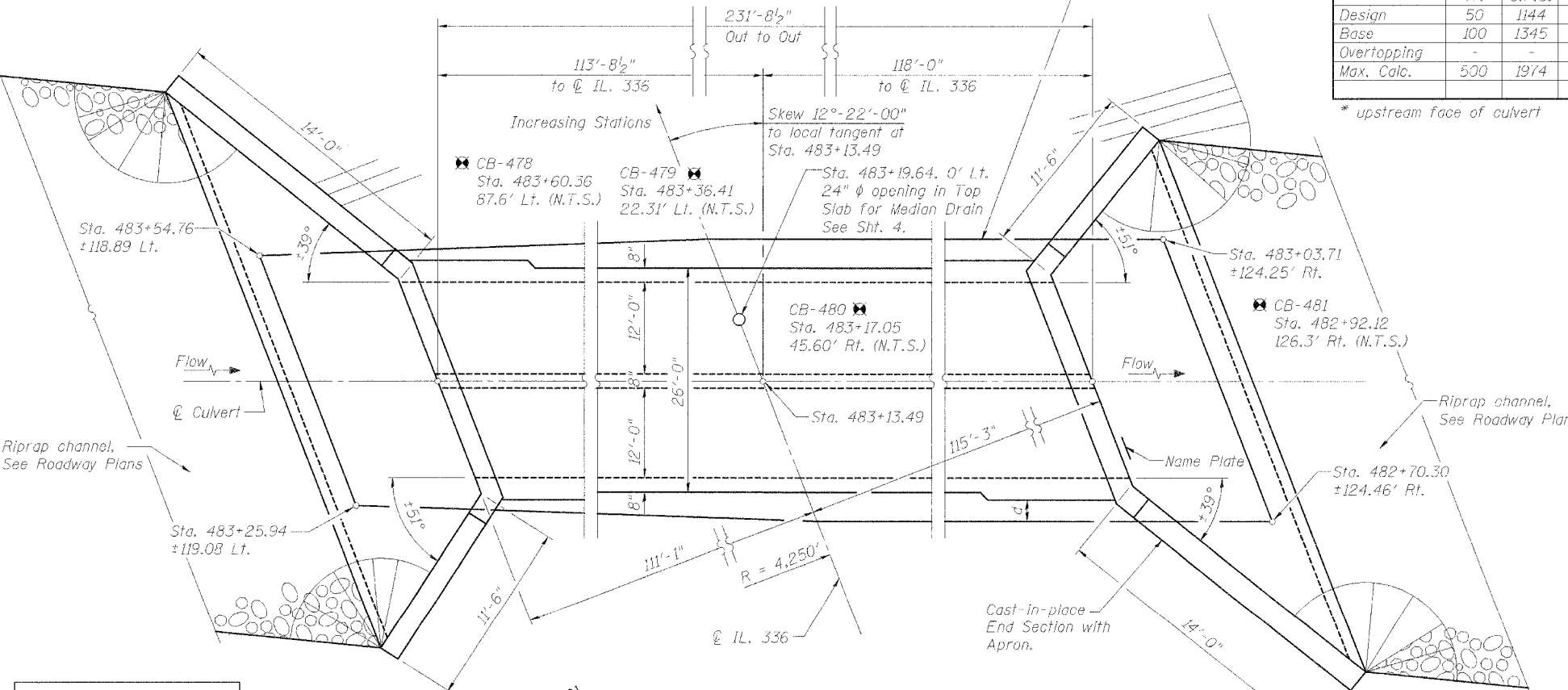

PLAN

(Boring Locations Indicated as such: ⓧ)

STATION 483+13.49
BUILT 200_ BY
STATE OF ILLINOIS
F.A.P. RT. 315 SEC. 55-2
LOADING HS20
STR. NO. 055 2503

NAME PLATES
(See Std. 515001)

APPROVED
FOR STRUCTURAL ADEQUACY ONLY

Ralph E. Adams
ENGINEER OF BRIDGES AND STRUCTURES

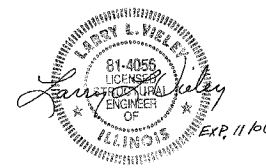

Larry L. Vieley
Illinois Licensed Structural Engineer
NO. 081-004056
License Expires: November 30, 2006

Date: 3/30/2006

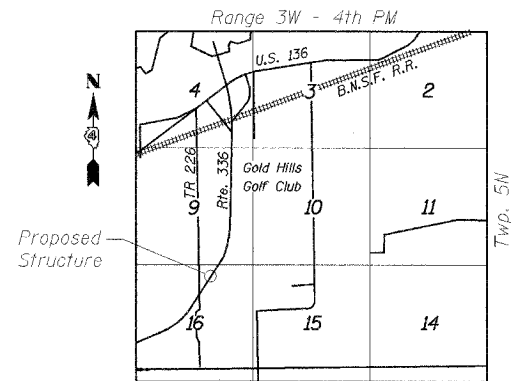

LOCATION SKETCH

GENERAL PLAN & ELEVATION
IL. ROUTE 336 OVER
TRIBUTARY TO KILLJORDAN CREEK
IL. ROUTE 336
F.A.P. ROUTE 315 SECT. 55-2
McDONOUGH COUNTY
STATION 483+13.49
STRUCTURE NO. 055-2503



DESIGNED	LLV
CHECKED	PJL
DRAWN	MGM
CHECKED	LLV