

F.A.P. RTE.	SECTION	COUNTY	TOTAL SHEETS	SHEET NO.
315	55-2	McDONOUGH	1025	572
STA.		TO STA.		
FED. ROAD DIST. NO. 4 ILLINOIS		FED. AID PROJECT		

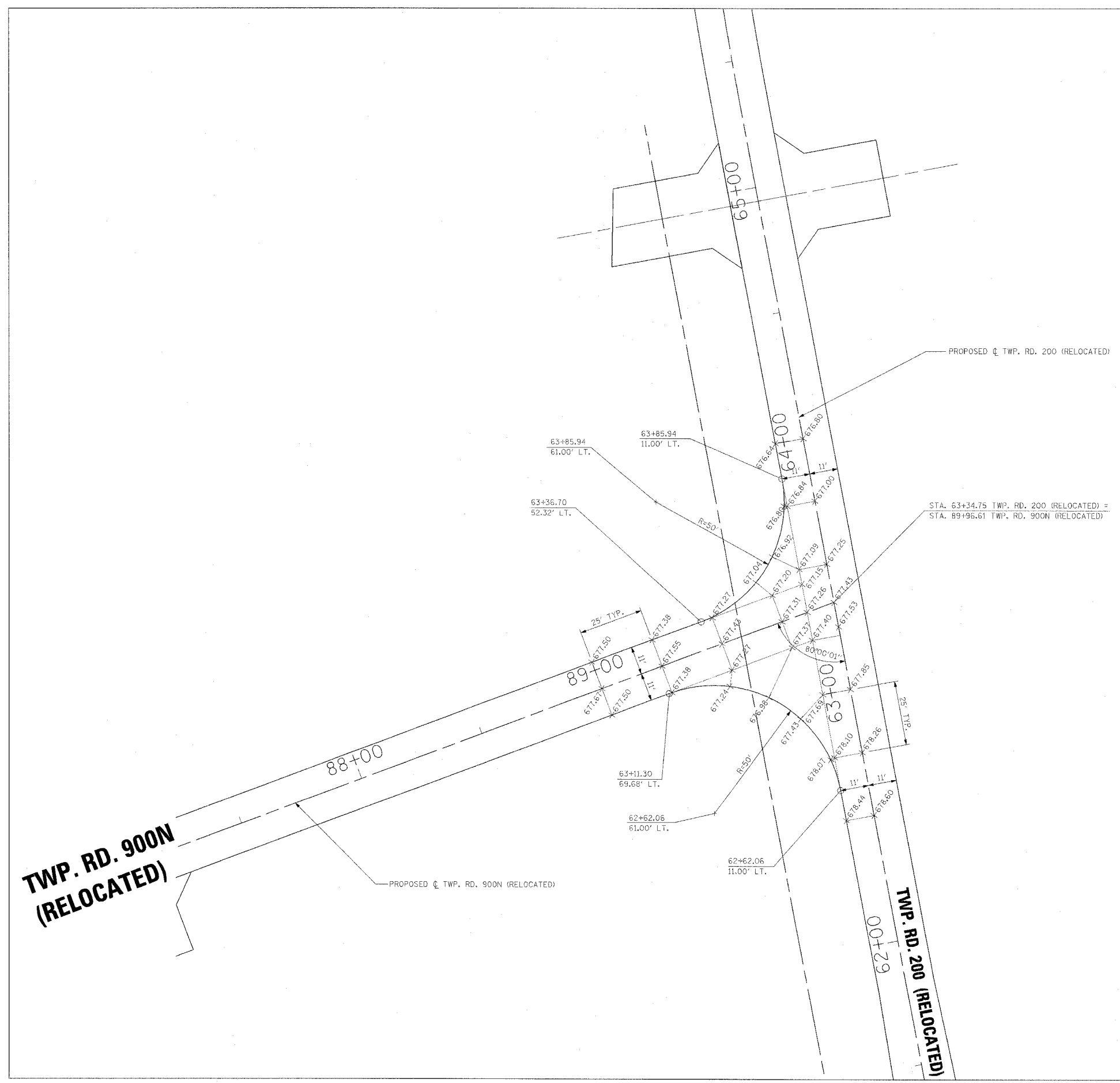

**TWP. RD. 900N
(RELOCATED)**

**TWP. RD. 200
(RELOCATED)**

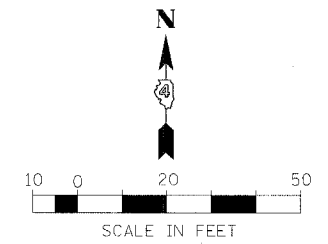

REVISIONS	
NAME	DATE

ILLINOIS DEPARTMENT OF TRANSPORTATION
**INTERSECTION DETAILS
TWP. RD. 200 (RELOCATED) WITH
TWP. RD. 900N (RELOCATED)**

DATE 3/30/06
DRAWN BY
CHECKED BY