

F.A.P. RTE.	SECTION	COUNTY	TOTAL SHEETS	SHEET NO.
315	55-2	MCDONOUGH	1025	578
STA.		TO STA.		
FED. ROAD DIST. NO. 4 (ILLINOIS) FED. AID PROJECT				

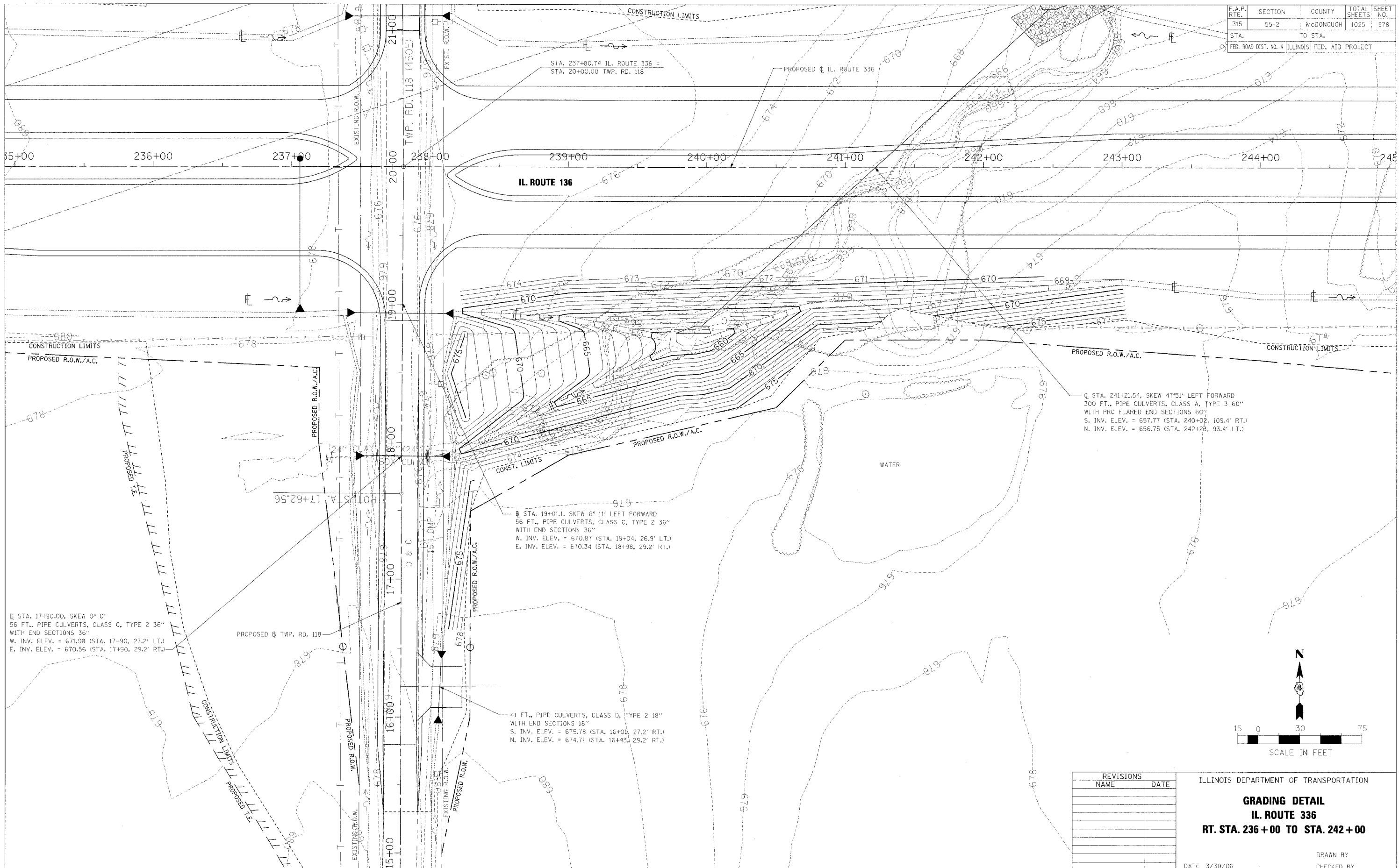

④ STA. 17+90.00, SKEW 0° 0'  
56 FT., PIPE CULVERTS, CLASS C, TYPE 2 36"  
WITH END SECTIONS 36"  
W. INV. ELEV. = 671.08 (STA. 17+90, 27.2' LT.)  
E. INV. ELEV. = 670.56 (STA. 17+90, 29.2' RT.)

PROPOSED TWP. RD. 118

④ STA. 19+01.1, SKEW 6° 11' LEFT FORWARD  
56 FT., PIPE CULVERTS, CLASS C, TYPE 2 36"  
WITH END SECTIONS 36"  
W. INV. ELEV. = 670.87 (STA. 19+04, 26.9' LT.)  
E. INV. ELEV. = 670.34 (STA. 18+98, 29.2' RT.)

41 FT., PIPE CULVERTS, CLASS D, TYPE 2 18"  
WITH END SECTIONS 18"  
S. INV. ELEV. = 675.78 (STA. 16+01, 27.2' RT.)  
N. INV. ELEV. = 674.71 (STA. 16+43, 29.2' RT.)

④ STA. 241+21.54, SKEW 47° 31' LEFT FORWARD  
300 FT., PIPE CULVERTS, CLASS A, TYPE 3 60"  
WITH PRC FLARED END SECTIONS 60"  
S. INV. ELEV. = 657.77 (STA. 240+02, 109.4' RT.)  
N. INV. ELEV. = 656.75 (STA. 242+25, 93.4' LT.)

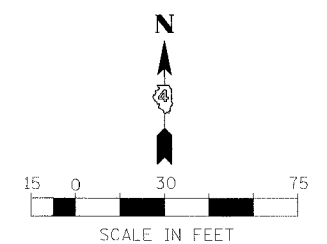

REVISIONS	
NAME	DATE

ILLINOIS DEPARTMENT OF TRANSPORTATION  
**GRADING DETAIL**  
**IL. ROUTE 336**  
**RT. STA. 236+00 TO STA. 242+00**

DATE 3/30/06  
DRAWN BY  
CHECKED BY