

F.A. RTE.	SECTION	COUNTY	TOTAL SHEETS	SHEET NO.
315	55-2	McDONOUGH	1025	946
STA.		TO STA.		
FED. ROAD DIST. NO.		ILLINOIS FED. AID PROJECT		

DATE	3/1
DESIGNED	
PLOTTED	
NOTED	
APPROVED	

DATE	3/1
DESIGNED	
PLOTTED	
NOTED	
APPROVED	

DATE	3/1
DESIGNED	
PLOTTED	
NOTED	
APPROVED	

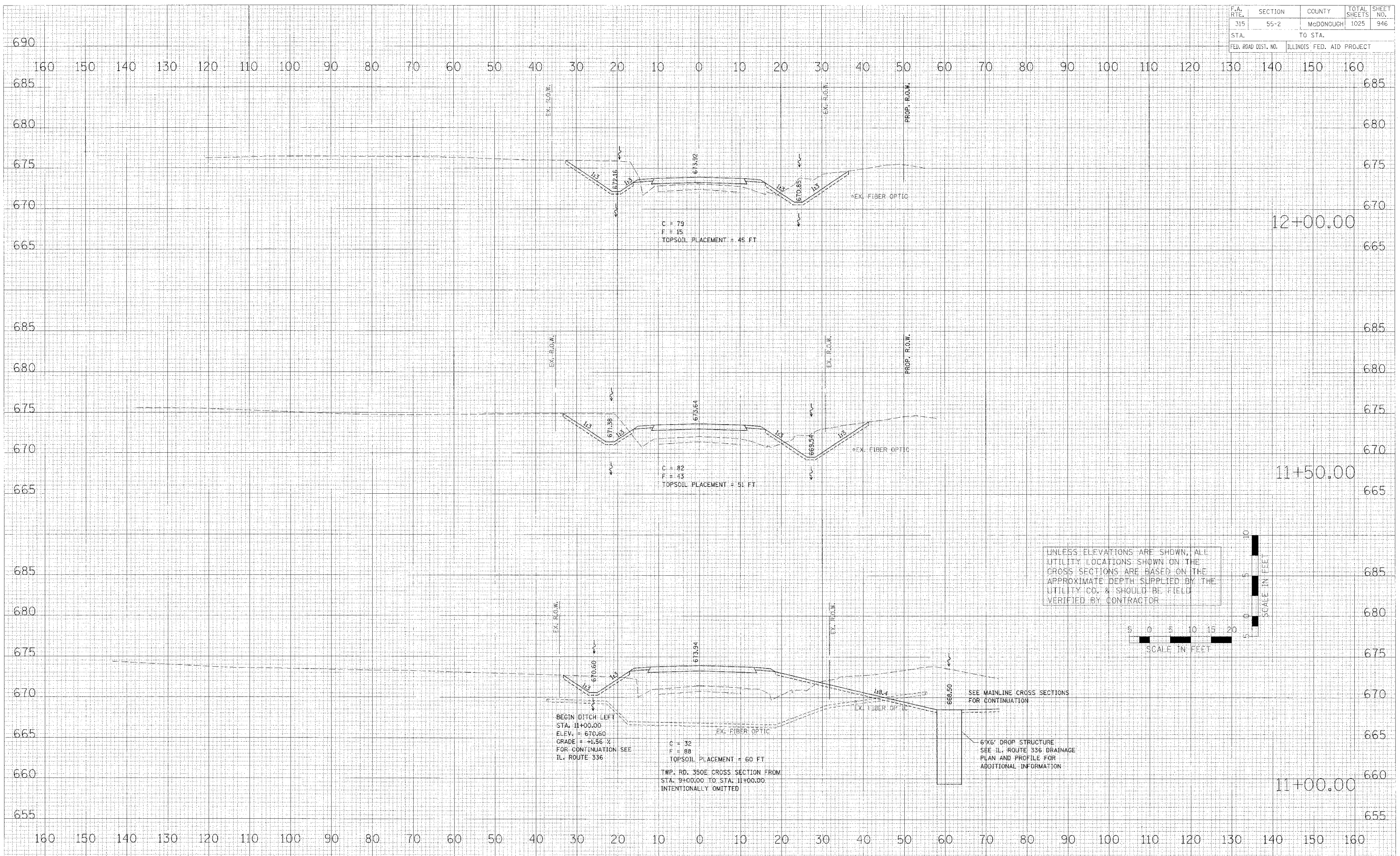

CROSS SECTIONS - TWP. RD. 350E