

F.A.P. RTE.	SECTION	COUNTY	TOTAL SHEETS	SHEET NO.
646	1130-11N-5,TS	PEORIA		14
STA.		TO STA.		
FED. ROAD DIST. NO. 4 ILLINOIS FED. AID PROJECT				

NOTE
 THE CCC&G AT BOTH THE E.O.P. AND THE MEDIAN SHALL BE PLACED SO THAT THE EDGE OF PAV MATCHES EXISTING PAVEMENT ELEVATION. DUE TO LACK OF SURVEY AND EXISTING INFORMATION, THIS SHALL ACT AS CONTROL FOR ALL DRAINAGE STRUCTURES. INFORMATION IS GIVEN FOR EXISTING STRUCTURES TO ASSIST IN BID PREPARATION. IT SHALL BE THE CONTRACTORS RESPONSIBILITY TO VERIFY OR ESTABLISH PROPOSED DRAINAGE STRUCTURE INFORMATION.

ALIGNMENT INFORMATION IS GIVEN FOR QUANTITY LOCATIONS AND SHOULD NOT BE USED FOR LAYOUT DUE TO LACK OF SURVEY AND TIES. LAYOUT SHOULD BE MEASURED FROM EXISTING FEATURES AS SHOWN ON GEOMETRICS SHEETS.

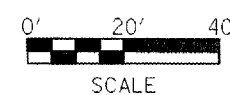
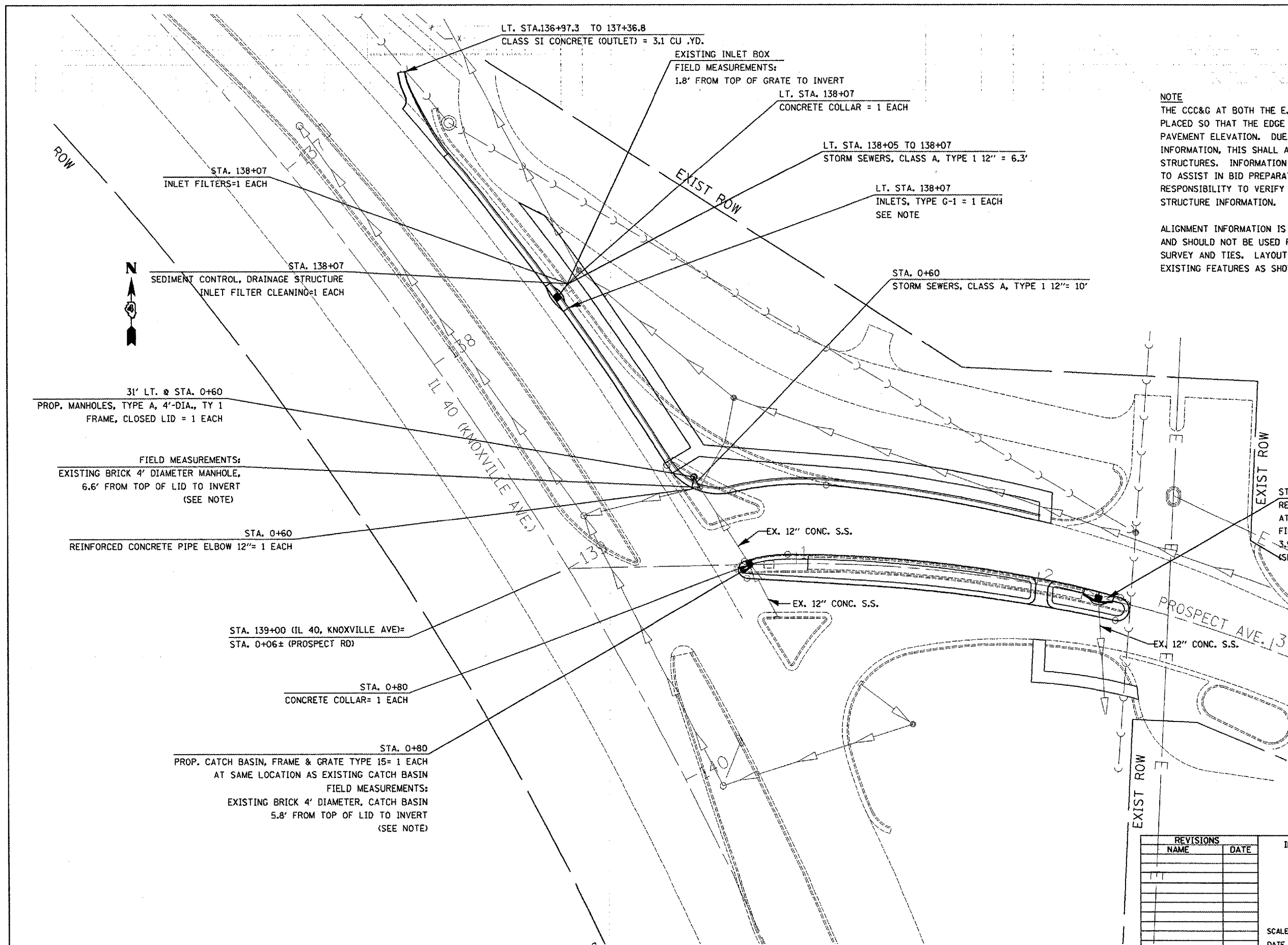

REVISIONS	
NAME	DATE

ILLINOIS DEPARTMENT OF TRANSPORTATION
PROPOSED DRAINAGE
 SCALE: VERT. DATE: HORIZ. DRAWN BY: CHECKED BY:

PLOT DATE = 3/31/2006
 FILE NAME = c:\proje\68600\asf\sy\146\prospect\plan\sheet.dgn
 PLOT SCALE = 48.0000' / 1" IN.
 USER NAME = russellm