

F.A.P. RTE.	SECTION	COUNTY	TOTAL SHEETS	SHEET NO.
332		VERMILION	30	21

STA. 217+00	TO STA. 223+00
FED. ROAD DIST. NO.	ILLINOIS FED. AID PROJECT
•(RX,46Z-1RS-1 & 147R-1RS)	

TYPICAL PAVEMENT MARKING LEGEND

- 1 4" (100) SKIP-DASH (YELLOW)
- 2 4" (100) SOLID (YELLOW)
- 7 4" (100) SKIP-DASH (WHITE)

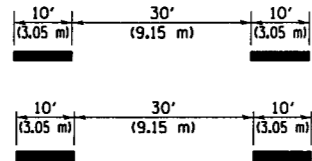

CURVE 50
 P.I. STA = 223+61.96
 $\Delta = 10^\circ 18' 02.05''$
 $D = 0^\circ 57' 22.80''$
 $R = 5,991.19$
 $T = 540.00$
 $L = 1,077.99$
 $E = 24.29$
 $e =$
 $T.R. =$
 $S.E. RUN =$
 $P.C. STA = 218+21.96$
 $P.T. STA = 228+99.05$

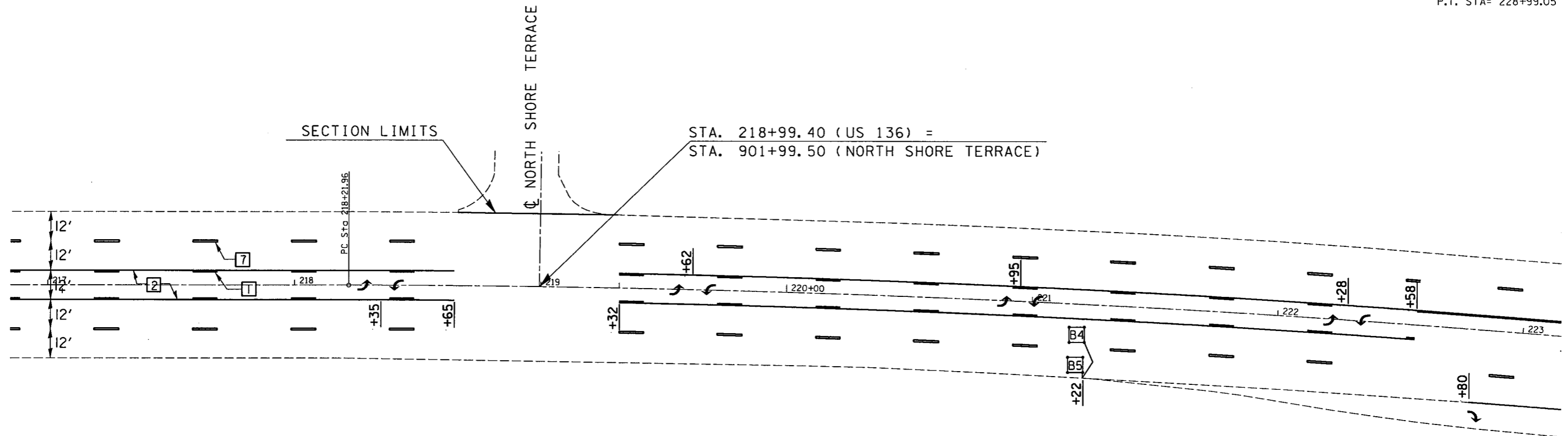

DETAIL OF DETECTOR LOOP WIRING
 WIRED IN SERIES WITH SINGLE PAIR CABLE

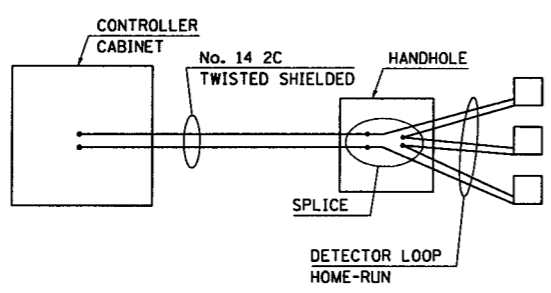

DETECTOR LOOP DATA
 IL. RTE. 1 & LAKE SHORE DR / VILLAGE MALL ENT

LOOP	SIZE	TURNS
A1-3	6' X 6'	3
A4-5	6' X 6'	4
B1-3	6' X 6'	3
B4-5	6' X 6'	4

The existing detector loop lead-in cable is:
 No. 14 2/C, Twisted Shielded

NOTE: ALL ADVANCE LOOPS SHALL BE REPLACED PER EXISTING LOCATION UNLESS OTHERWISE NOTED.

REVISIONS		ILLINOIS DEPARTMENT OF TRANSPORTATION
NAME	DATE	
		PAVEMENT MARKING & DETECTOR LOOP PLANS
SCALE: VERT. HORIZ.	DRAWN BY	CHECKED BY
DATE		

PLOT DATE: 5/28/2006
 PLOT SCALE: 1/8" = 1'-0"
 USER NAME: carroll-t