

PROJECT ENGINEER: TIM BRANDENBURG (217)465-4181
SQUAD LEADER: JAY EDWARDS
DESIGNER: JUSTIN CEARLOCK

STATE OF ILLINOIS DEPARTMENT OF TRANSPORTATION DIVISION OF HIGHWAYS PLANS FOR PROPOSED HIGHWAY IMPROVEMENT

FOR INDEX OF SHEETS, SEE SHEET NO. 2
FOR SUMMARY OF QUANTITIES, SEE SHEET NO. 4 - 6

PLAN 1:20
PROFILE HORIZ. 1:20
PROFILE VERT. 1:2
CROSS SECTIONS 1:5 HORIZONTAL 1:2 VERTICAL

F.A.P. ROUTE 749 (IL ROUTE 133) SECTION 14RS-2,122RS-3&(123NRS,14)BR EDGAR COUNTY PROJECT F-0749(019)

RESURFACING (3P) AND CULVERT REPLACEMENTS FROM IL 49 TO IL 16 IN PARIS

C-95-126-00

FAP ROUTE	SECTION	COUNTY	TOTAL SHEETS	SHEET NO.
749		EDGAR	75	1
PROJECT				
• 14RS-2,122RS-3&(123NRS,14)BR				
CONTRACT NO. 70134				
D-95-064-00				

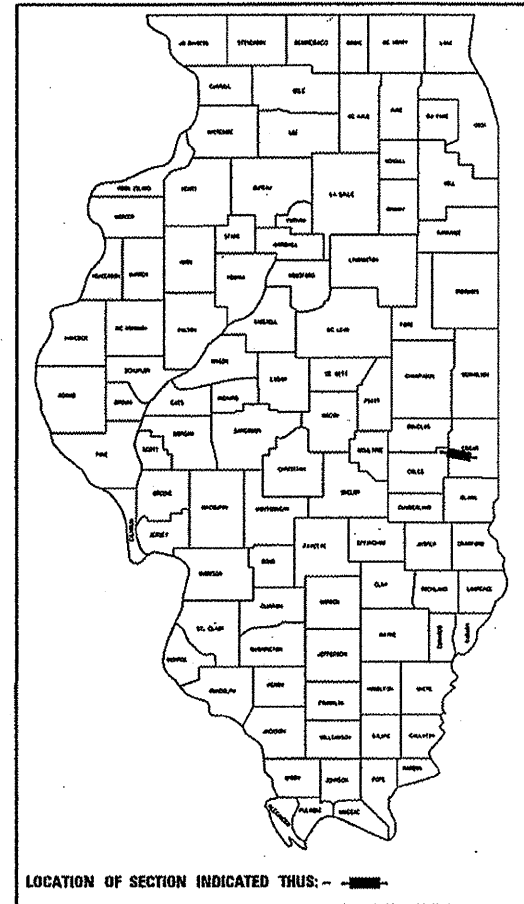

- (A) CULVERT REPLACEMENT; SN 023-8302 (EX); SN 023-8313 (PR); STA 8+76.00
- (B) CULVERT INLAY; SN 023-2011; STA 232+00.00
- (C) CULVERT REPLACEMENT; SN 023-2012 (EX); SN 023-2015 (PR); STA 280+24.00
- (D) CULVERT INLAY; SN 023-8303; STA 290+52.00
- (E) CULVERT INLAY; SN 023-8304; STA 322+00.00
- (F) CULVERT REPLACEMENT; SN 023-8305 (EX); SN 023-8314 (PR); STA 367+52.00
- (G) BRIDGE INLAY; SN 023-0016; STA 418+28.00
- (H) CULVERT INLAY; SN 023-8306; STA 513+80.00
- (I) CULVERT REPLACEMENT; SN 023-2009 (EX); SN 023-2016 (PR); STA 539+68.00

TRAFFIC DATA		
	IL 49 TO SPRINGFIELD AVE.	SPRINGFIELD AVE. TO IL 16
	LEG A	LEG A
CURRENT ADT	2,150	4,850
20 YEAR ADT	2,800	5,300
P.U. + P.C. %	79.8	88.5
S.U. %	5.7	3.9
M.U. %	14.5	7.6

DESIGN DESIGNATION
MINOR ATERIAL

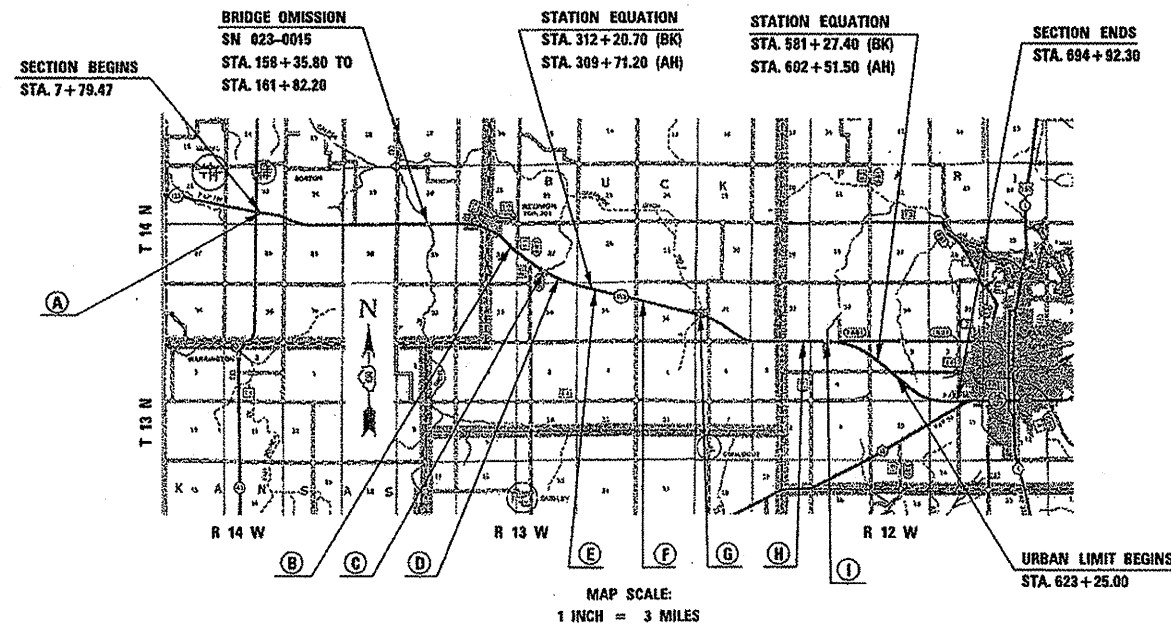

STATE OF ILLINOIS
DEPARTMENT OF TRANSPORTATION
DIVISION OF HIGHWAYS

SUBMITTED Feb 10, 2006
DEPUTY DIRECTOR OF HIGHWAYS, REGIONAL ENGINEER

EXAMINED May 12, 2006
ENGINEER OF DESIGN AND ENVIRONMENT

APPROVED May 12, 2006
DIRECTOR OF HIGHWAYS, CHIEF ENGINEER

FOR UNDERGROUND UTILITY
LOCATIONS CALL
TOLL FREE J.U.L.I.E. TELEPHONE NO.
1-800-892-0123

U.S. DEPARTMENT OF TRANSPORTATION
FEDERAL HIGHWAY ADMINISTRATION

APPROVED _____
DIVISION ADMINISTRATOR DATE

CONTRACT NO. 70134

F.A.P. ROUTE 749 SECTION 14RS-2,122RS-3&(123NRS,14)BR EDGAR COUNTY

TOTAL LENGTH OF SECTION & PROJECT = 66,838.23 FEET = 12.659 MILES
NET LENGTH OF SECTION & PROJECT = 66,491.83 FEET = 12.593 MILES

PRINTED BY AUTHORITY OF THE STATE OF ILLINOIS