

F.A.P. RTE.	SECTION	COUNTY	TOTAL SHEETS	SHEET No.
315	34-5	HANCOCK	612	67
STA. 1212+00		TO STA. 1242+00		
FED. ROAD DIST. No.	ILLINOIS	FED. AID PROJECT		

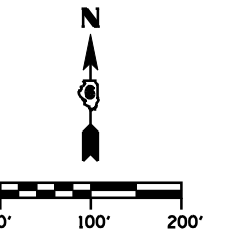

B.M. *TA-238 SET GOD SPIKE IN P.P. ±100' EAST OF JCT. TR 302, NORTH OF CL EL 575.54

CURVE TR302 DATA
 PI STA 12+02.82
 Δ = 21° 54' 36" (RT)
 D = 18° 47' 08"
 R = 305.00'
 T = 59.04'
 L = 116.63'
 E = 5.66'
 PC STA 11+43.78
 PT STA 12+60.41

EX CURVE EC11
 PI STA 522+21.74
 Δ = 38° 16' 02" (LT)
 D = 2° 19' 31"
 R = 2,463.99'
 T = 854.85'
 L = 1,645.67'
 E = 144.08'
 PC STA 513+66.89
 PT STA 530+12.56

EX CURVE TR320C1
 PI STA 7+27.47
 Δ = 36° 18' 18" (RT)
 D = 38° 11' 48"
 R = 150.00'
 T = 49.18'
 L = 95.05'
 E = 7.86'
 PC STA 6+78.29
 PT STA 7+73.34

EX CURVE TR320C1
 PI STA 3+56.82
 Δ = 21° 31' 58" (RT)
 D = 12° 30' 00"
 R = 458.37'
 T = 87.16'
 L = 172.26'
 E = 8.21'
 PC STA 2+69.66
 PT STA 4+41.92

CURVE C1 DATA
 PI STA 1238+44.42
 Δ = 38° 15' 04" (LT)
 D = 2° 43' 40"
 R = 2,100.46'
 T = 728.40'
 L = 1,402.28'
 E = 122.71'
 PC STA 1231+16.02
 PT STA 1245+18.30

EX CURVE EC11
 PI STA 522+21.74
 Δ = 38° 16' 02" (LT)
 D = 2° 19' 31"
 R = 2,463.99'
 T = 854.85'
 L = 1,645.67'
 E = 144.08'
 PC STA 513+66.89
 PT STA 530+12.56

CURVE TR320 DATA
 PI STA 21+63.82
 Δ = 20° 55' 18" (RT)
 D = 18° 47' 08"
 R = 305.00'
 T = 56.31'
 L = 111.37'
 E = 5.15'
 PC STA 21+07.50
 PT STA 22+18.88

EX CURVE TR320C2
 PI STA 9+04.24
 Δ = 39° 16' 23" (LT)
 D = 38° 11' 52"
 R = 150.00'
 T = 53.52'
 L = 102.82'
 E = 9.26'
 PC STA 8+50.72
 PT STA 9+53.53

EX CURVE TR320C2
 PI STA 7+76.74
 Δ = 21° 20' 02" (LT)
 D = 14° 19' 00"
 R = 400.20'
 T = 75.38'
 L = 149.01'
 E = 7.04'
 PC STA 7+01.36
 PT STA 8+50.38

CURVE CH31-2 DATA
 PI STA 17+09.73
 Δ = 35° 04' 34" (RT)
 D = 18° 47' 08"
 R = 305.00'
 T = 96.39'
 L = 186.72'
 E = 14.87'
 PC STA 16+13.44
 PT STA 18+00.16

CURVE CH31-1 DATA
 PI STA 12+83.16
 Δ = 53° 40' 13" (LT)
 D = 18° 47' 08"
 R = 305.00'
 T = 154.30'
 L = 285.70'
 E = 36.81'
 PC STA 11+29.33
 PT STA 14+15.04

EX CURVE CH31C1
 PI STA 11+58.65
 Δ = 45° 04' 12" (LT)
 D = 22° 45' 00"
 R = 251.85'
 T = 104.50'
 L = 198.11'
 E = 20.82'
 PC STA 10+54.15
 PT STA 12+52.26

CURVE PE - 1 DATA
 PI STA 309+72.31
 Δ = 57° 34' 08" (LT)
 D = 28° 38' 52"
 R = 200.00'
 T = 109.88'
 L = 200.95'
 E = 28.20'
 PC STA 308+62.43
 PT STA 310+63.38

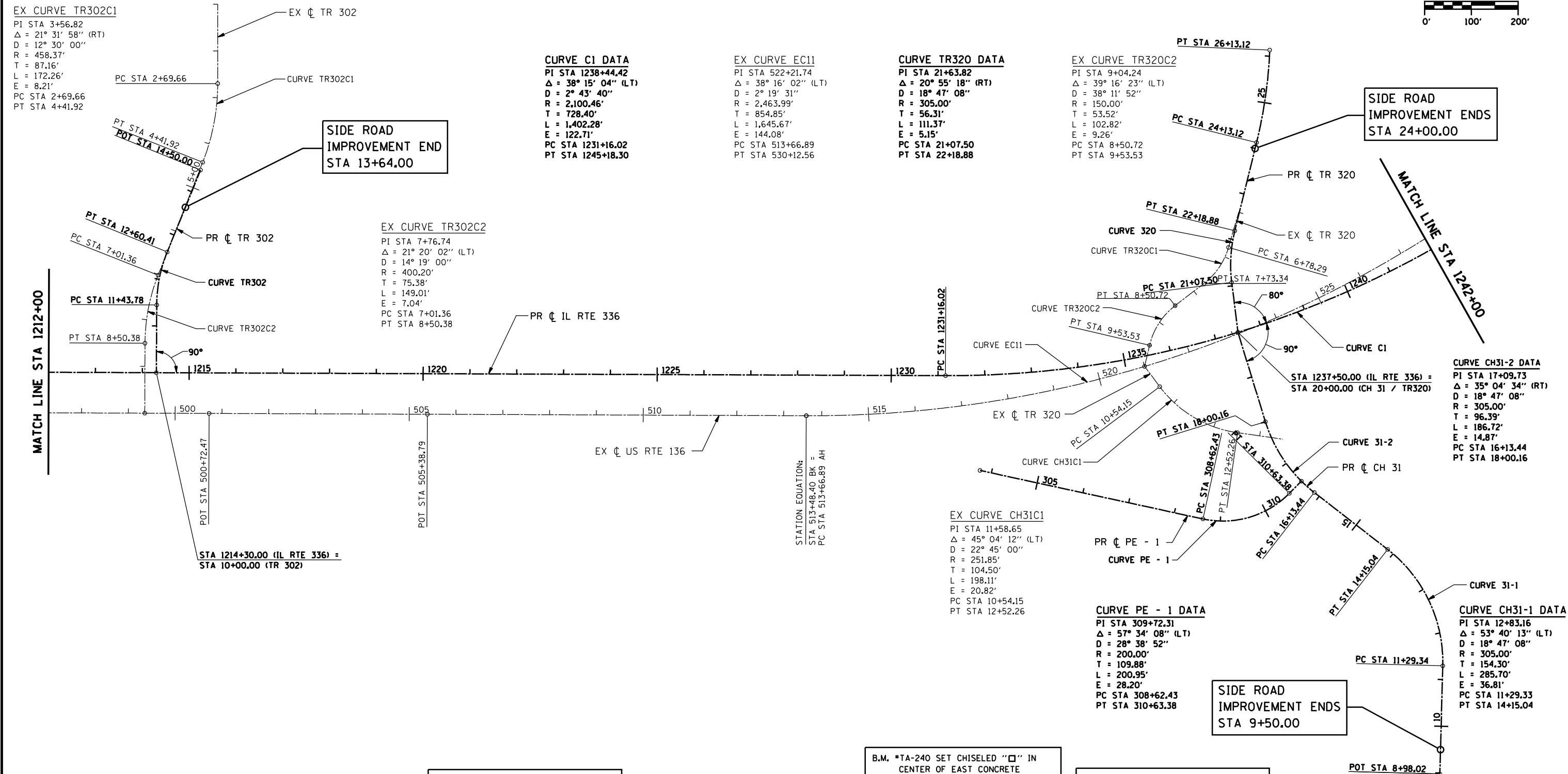

B.M. *TA-239 FOUND GOD SPIKE IN P.P. 0.20 MILES EAST ALONG US RTE 136 FROM TR 302, NORTH OF CL EL 608.78

B.M. *TA-240 SET CHISELED "□" IN CENTER OF EAST CONCRETE EXTENSION FOR CULVERT @ SE CORNER TR 320 & US RTE 136 0.40 MILES EAST FROM TR 302, EL 600.85

B.M. *TA-241 SET GOD SPIKE NAIL IN P.P. 0.65 MILES EAST ALONG US RTE 136 FROM TR 302, SOUTH OF CL EL 554.93

•DGN: SPEC•
 •DATE: TIME•
 •REF: 01