

F.A.P. RTE.	SECTION	COUNTY	TOTAL SHEETS	SHEET No.
315	34-5	HANCOCK	612	100
STA. 1167+00 TO STA. 1182+00		FED. ROAD DIST. No. ILLINOIS FED. AID PROJECT		

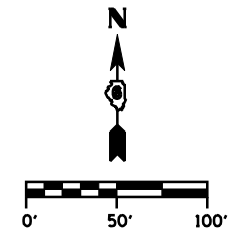

**SECTION BEGINS
STA. 1174 + 00.00**

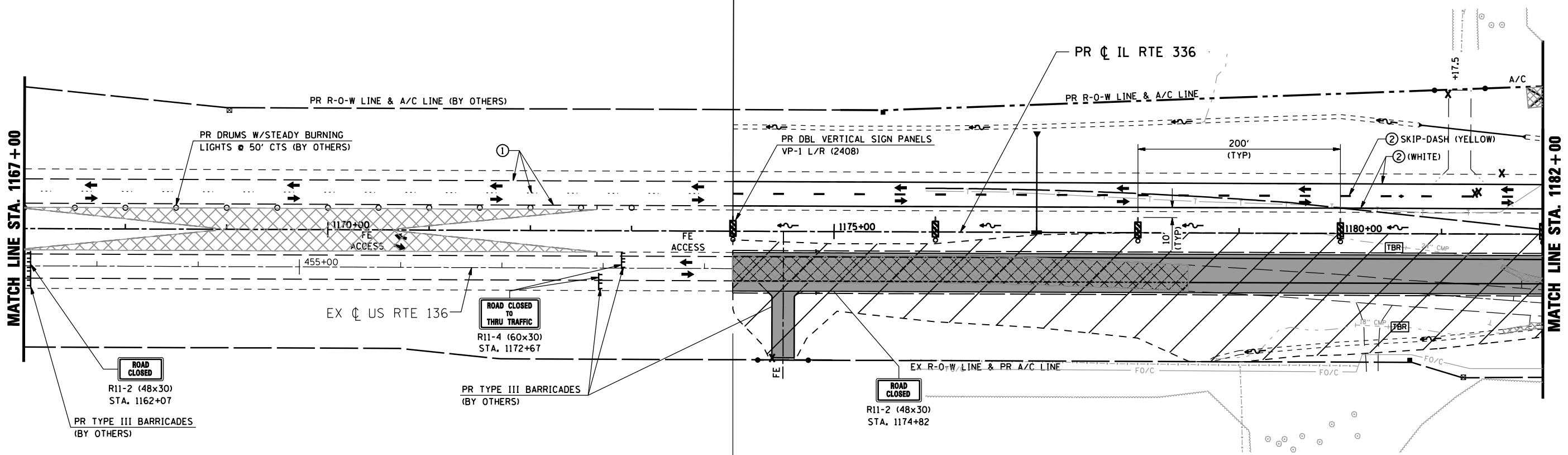

LEGEND

- ➔ DIRECTION OF TRAFFIC
- TT TYPE III BARRICADE W/ PROPER ROAD CLOSURE SIGNS
- ~ PERMANENT ROADWAY DITCH FLOW
- ➔ TEMPORARY STAGE DITCH FLOW
- ~ EXISTING ROADWAY DITCH FLOW
- ▨ STAGE CONSTRUCTION LIMITS
- █ STAGE CONSTRUCTION
- XXXXX REMOVAL
- ① EXISTING PAVEMENT MARKING
- ② TEMP PAINT PAVEMENT MARKING - LINE 5"
- ③ TEMP PAINT PAVEMENT MARKING - LINE 6"
- ④ TEMP PAINT PAVEMENT MARKING - LINE 12"
- ⑤ TEMP PAINT PAVEMENT MARKING - LINE 24"
- ⑥ TEMP PAINT PAVEMENT MARKING - LETTERS & SYMBOLS

PR TRAFFIC CONTROL & PROTECTION (BY OTHERS)
NOTE: ADJACENT CONTRACT

CASE II CONTINUED

REVISIONS	
NAME	DATE

ILLINOIS DEPARTMENT OF TRANSPORTATION
**MAINTENANCE OF TRAFFIC
IL RTE 336 (STAGE 2) (CASE II)
STA. 1167+00 TO STA. 1182+00**
SCALE: DATE: MARCH 10, 2006
DRAWN BY: RG
CHECKED BY: JAC

•DGN-SPEC•
•DATE-TIME•
•REF01