

F.A.P. RTE.	SECTION	COUNTY	TOTAL SHEETS	SHEET No.
315	34-5	HANCOCK	612	134
STA. 1311+00		TO STA. 1325+00		
FED. ROAD DIST. No.		ILLINOIS	FED. AID PROJECT	

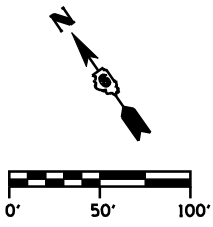

**END IMPROVEMENT  
TR 358  
STA. 35+00**

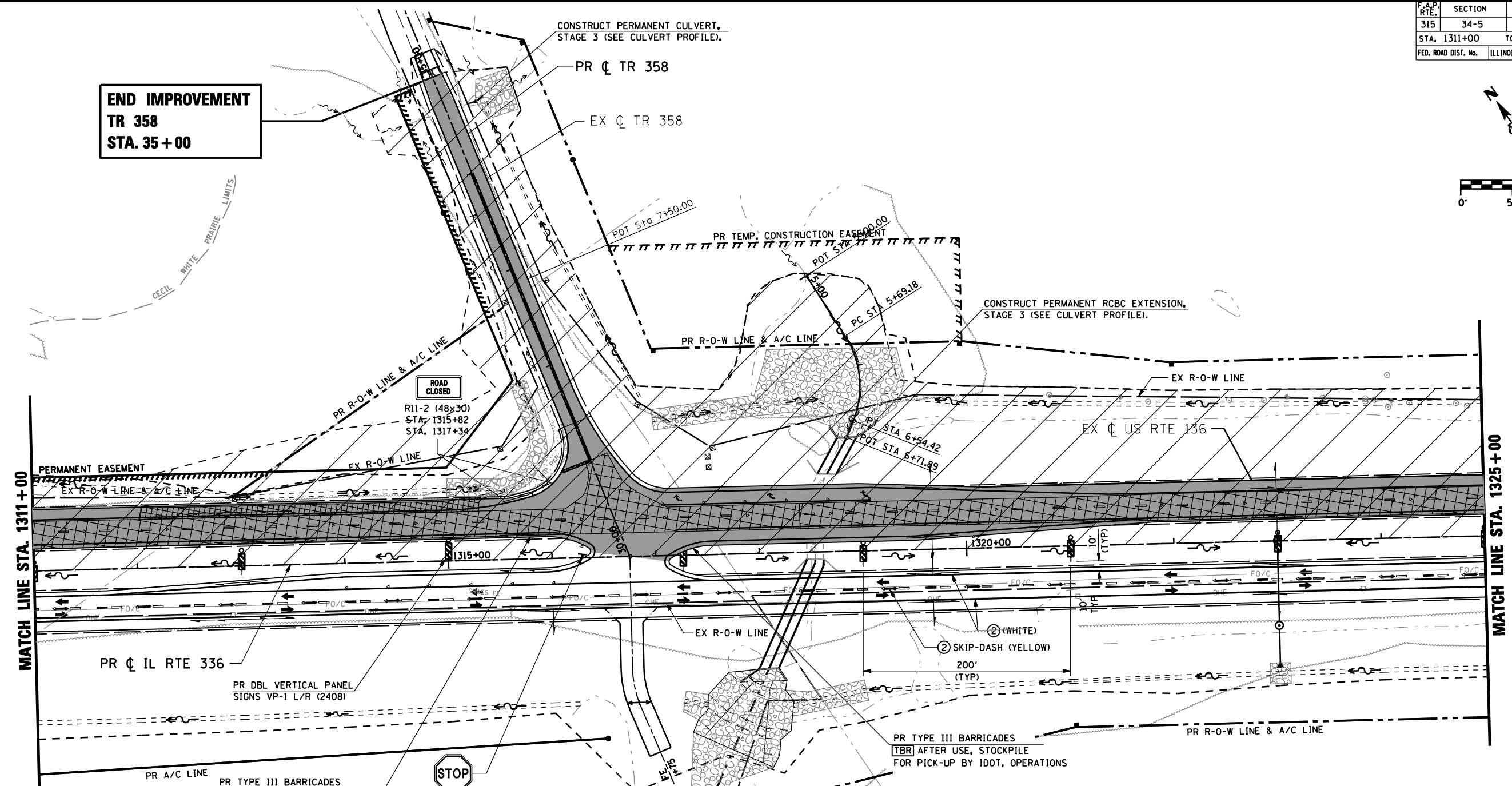

MATCH LINE STA. 1311+00

MATCH LINE STA. 1325+00

**LEGEND**

- ➔ DIRECTION OF TRAFFIC
- TT TYPE III BARRICADE W/ PROPER ROAD CLOSURE SIGNS
- ~ PERMANENT ROADWAY DITCH FLOW
- ➔ TEMPORARY STAGE DITCH FLOW
- ~ EXISTING ROADWAY DITCH FLOW
- ▨ STAGE CONSTRUCTION LIMITS
- ▨ STAGE CONSTRUCTION
- ▨ REMOVAL
- ① EXISTING PAVEMENT MARKING
- ② TEMP PAINT PAVEMENT MARKING - LINE 5"
- ③ TEMP PAINT PAVEMENT MARKING - LINE 6"
- ④ TEMP PAINT PAVEMENT MARKING - LINE 12"
- ⑤ TEMP PAINT PAVEMENT MARKING - LINE 24"
- ⑥ TEMP PAINT PAVEMENT MARKING - LETTERS & SYMBOLS

REVISIONS	
NAME	DATE

ILLINOIS DEPARTMENT OF TRANSPORTATION  
**MAINTENANCE OF TRAFFIC**  
**IL 336 (STAGE 3)**  
**STA. 1311+00 TO STA. 1325+00**  
 SCALE: DATE: MARCH 10, 2006  
 DRAWN BY: RG  
 CHECKED BY: JAC

\*DGN-SPEC\*  
 \*DATE-TIME\*  
 \*REF01