

F.A.P. RTE.	SECTION	COUNTY	TOTAL SHEETS	SHEET No.
315	34-5	HANCOCK	612	140
STA. 1393+00 TO STA. 1406+00				
FED. ROAD DIST. No.		ILLINOIS	FED. AID PROJECT	

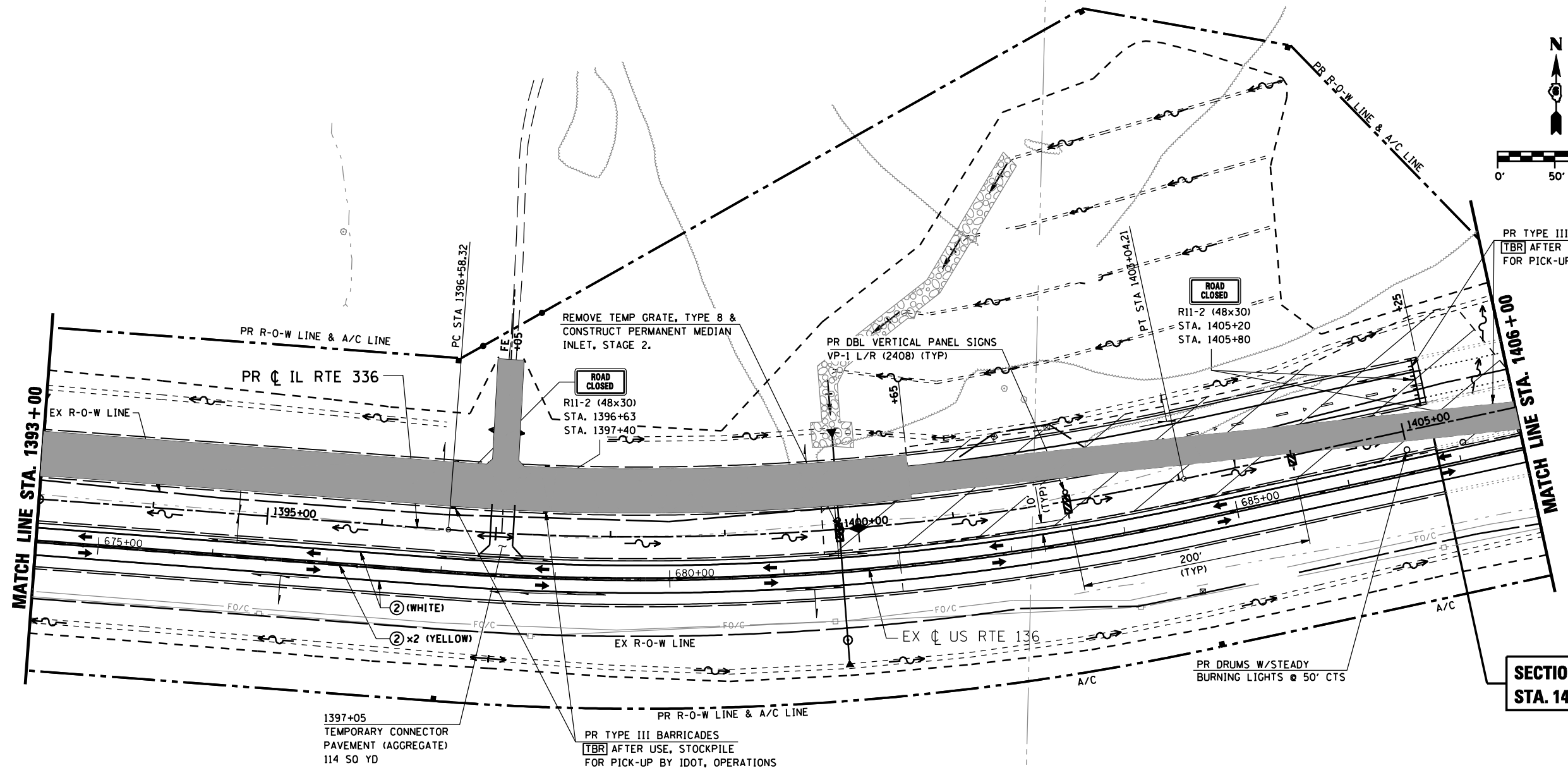
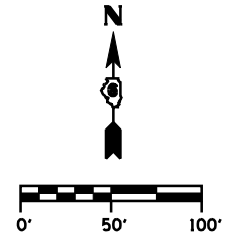

PR TYPE III BARRICADES
 [TBR] AFTER USE, STOCKPILE
 FOR PICK-UP BY IDOT, OPERATIONS

REMOVE TEMP GRATE, TYPE 8 &
 CONSTRUCT PERMANENT MEDIAN
 INLET, STAGE 2.

ROAD CLOSED
 R11-2 (48x30)
 STA. 1405+20
 STA. 1405+80

ROAD CLOSED
 R11-2 (48x30)
 STA. 1396+63
 STA. 1397+40

SECTION ENDS
 STA. 1405 + 25.00

LEGEND

- DIRECTION OF TRAFFIC
- TT TYPE III BARRICADE W/ PROPER ROAD CLOSURE SIGNS
- ~ PERMANENT ROADWAY DITCH FLOW
- TEMPORARY STAGE DITCH FLOW
- ~ EXISTING ROADWAY DITCH FLOW
- STAGE CONSTRUCTION LIMITS
- █ STAGE CONSTRUCTION
- ▨ REMOVAL
- ① EXISTING PAVEMENT MARKING
- ② TEMP PAINT PAVEMENT MARKING - LINE 5"
- ③ TEMP PAINT PAVEMENT MARKING - LINE 6"
- ④ TEMP PAINT PAVEMENT MARKING - LINE 12"
- ⑤ TEMP PAINT PAVEMENT MARKING - LINE 24"
- ⑥ TEMP PAINT PAVEMENT MARKING - LETTERS & SYMBOLS

REVISIONS	
NAME	DATE

ILLINOIS DEPARTMENT OF TRANSPORTATION
MAINTENANCE OF TRAFFIC
IL RTE 336 (STAGE 3)
STA. 1393+00 TO STA. 1406+00
 SCALE: DATE: MARCH 10, 2006 DRAWN BY: RG CHECKED BY: JAC

DGN-SPEC
 DATE-TIME
 *REF01