

F.A.P. RTE.	SECTION	COUNTY	TOTAL SHEETS	SHEET No.
315	34-5	HANCOCK	612	215
STA. 1279+00		TO STA. 1285+00		
FED. ROAD DIST. No.	ILLINOIS	FED. AID PROJECT		

RADIUS POINT
 STA 1280+43.27
 14,415.00' LT

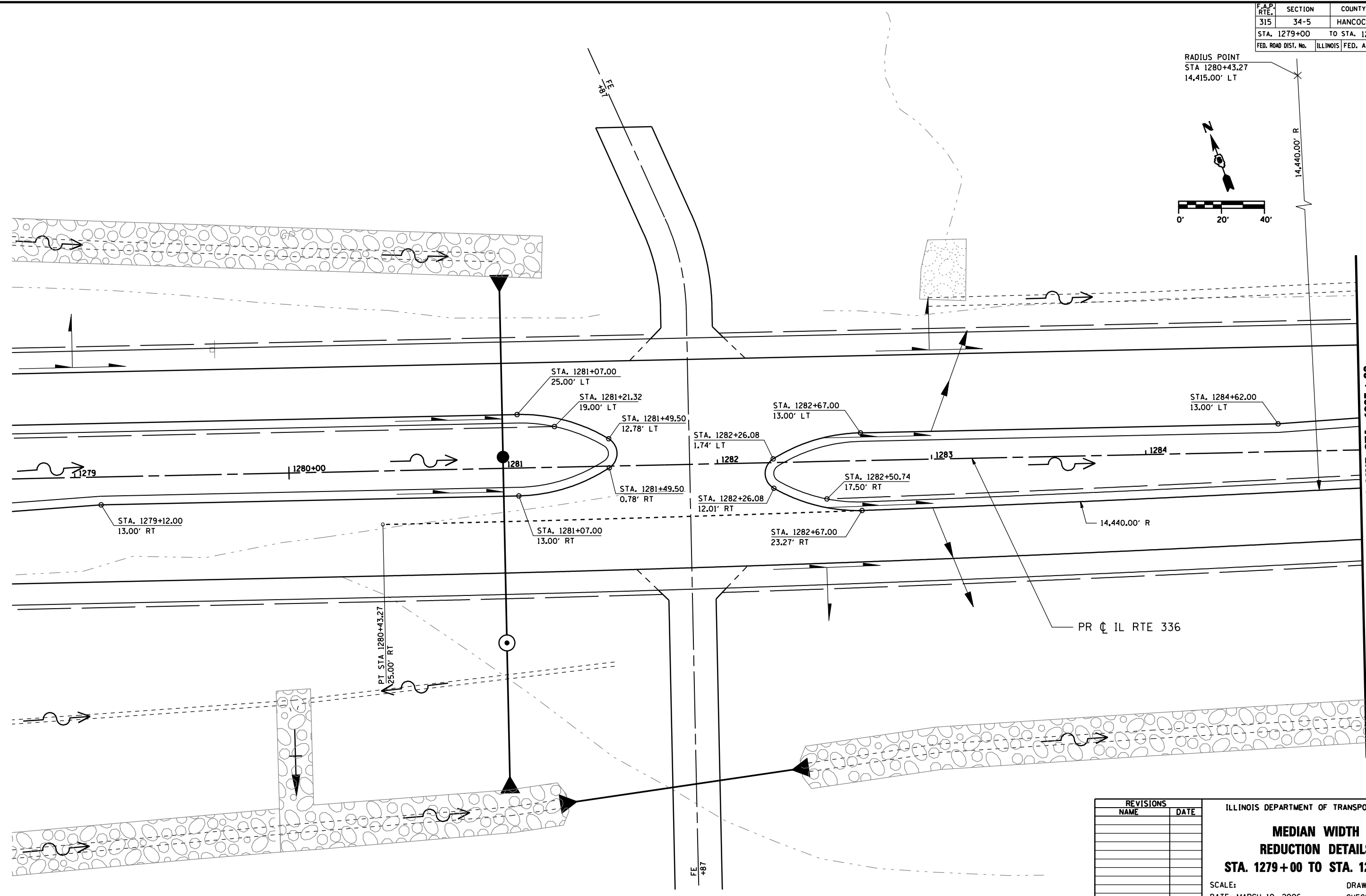
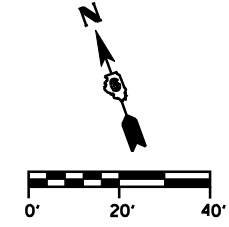

•DGN: SPEC•
 •DATE: TIME•
 •REF: 01

D6 PROJECT: FILE:

REVISIONS	
NAME	DATE

ILLINOIS DEPARTMENT OF TRANSPORTATION
**MEDIAN WIDTH
 REDUCTION DETAILS**
STA. 1279+00 TO STA. 1285+00
 SCALE: DATE: MARCH 10, 2006
 DRAWN BY: RG
 CHECKED BY: JAC