

F.A.P. RTE.	SECTION	COUNTY	TOTAL SHEETS	SHEET No.
315	34-5	HANCOCK	612	231
STA. 1297+00		TO STA. 1311+00		
FED. ROAD DIST. No.	ILLINOIS	FED. AID PROJECT		

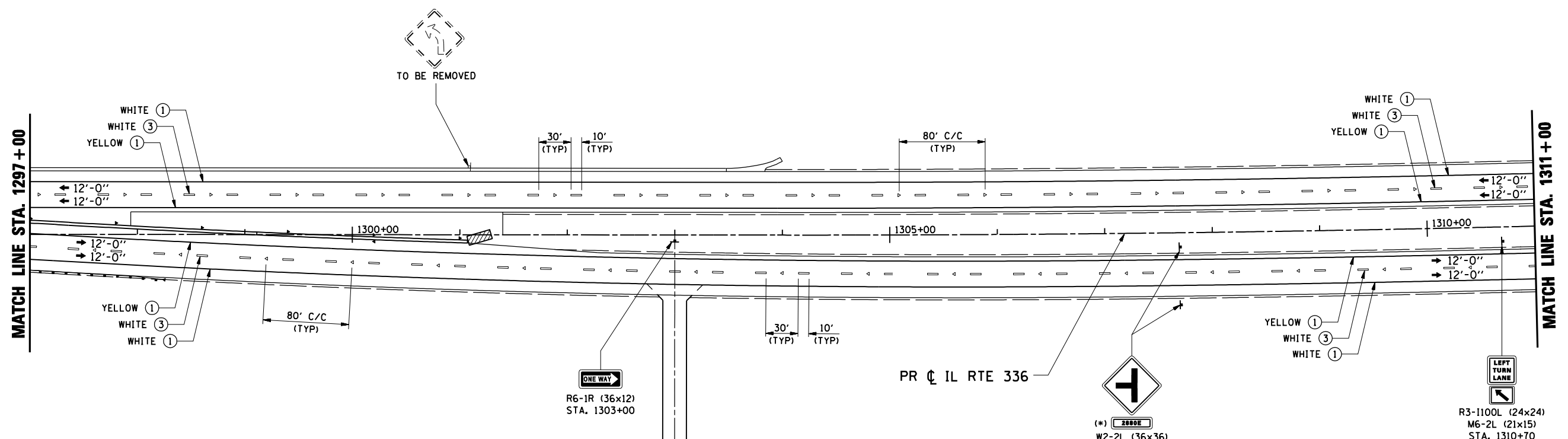
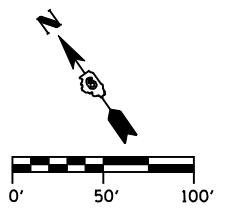

- LEGEND**
- ① POLYUREA PAVEMENT MARKING TYPE II - LINE 5"
  - ② POLYUREA PAVEMENT MARKING TYPE II - LINE 6"
  - ③ PREFORMED PLASTIC PAVEMENT MARKING, TYPE B - LINE 5"
  - ④ PREFORMED PLASTIC PAVEMENT MARKING, TYPE B - LINE 24"
  - ⑤ POLYUREA PAVEMENT MARKING, TYPE II - LETTERS & SYMBOLS
  - ◁ RAISED REFLECTIVE PAVEMENT MARKER (ONE-WAY CRYSTAL)
  - ◄ RAISED REFLECTIVE PAVEMENT MARKER (ONE-WAY AMBER)
  - ◆ RAISED REFLECTIVE PAVEMENT MARKER (TWO-WAY AMBER)
  - SIGN PANEL AND POST
  - PERMANENT TYPE III BARRICADE

(\*)  
 W2-2L (36x36)  
 W16-8 (2880E)  
 STA. 1307+70  
 SIGN006 (SEE  
 "SIGN DETAILS")

(\*) PLATE TO BE FURNISHED AND  
 INSTALLED LATER BY DISTRICT  
 SIGN SHOP.

REVISIONS	
NAME	DATE

ILLINOIS DEPARTMENT OF TRANSPORTATION  
**PAVEMENT MARKING & SIGNING PLAN**  
**IL RTE 336**  
**STA. 1297+00 TO STA. 1311+00**  
 SCALE: DATE: MARCH 10, 2006  
 DRAWN BY: RG  
 CHECKED BY: JAC

•DGN: SPEC•  
 •DATE: TIME•  
 •REF: 01