

F.A.P. RTE.	SECTION	COUNTY	TOTAL SHEETS	SHEET NO.	SHEET NO. 9 18 SHEETS
315	34-5(5B)	HANCOCK	612	257	
FED. ROAD DIST. NO. 7 ILLINOIS FED. AID PROJECT -					

Contract No: 72682

Sta. 1294+80.00

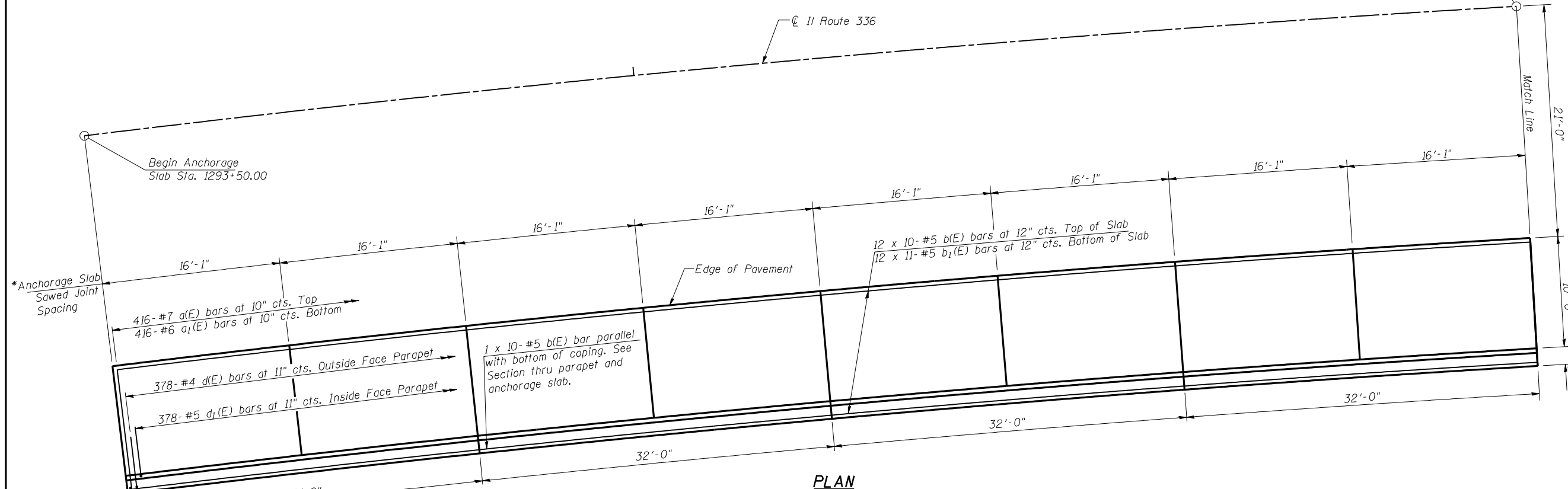

PLAN

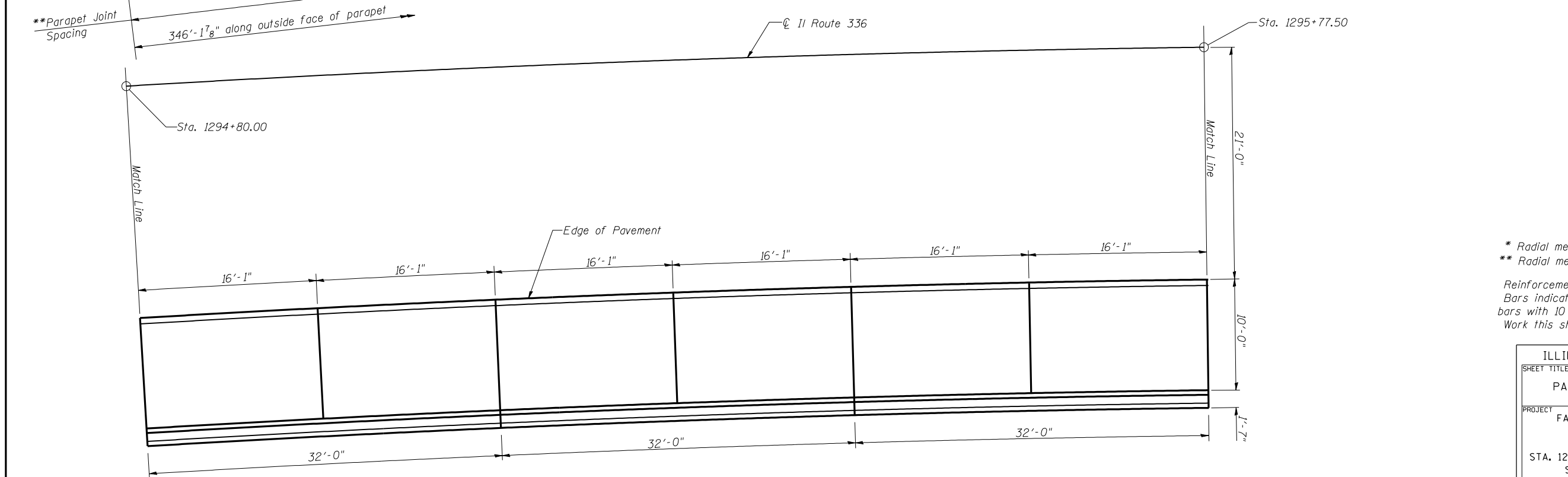

PLAN



MIN. BAR LAP
#5 bars = 1'-8"

* Radial measured along edge of pavement
 ** Radial measured along outside face of parapet
 Reinforcement Bars designated (E) shall be epoxy coated.
 Bars indicated thus 12 x 10 #5 etc. indicates 12 lines of bars with 10 lengths per line.
 Work this sheet with sheets 10 and 11 of 18.

ILLINOIS DEPARTMENT OF TRANSPORTATION	
STRUCTURE NUMBER 037-0069 PARAPET AND ANCHORAGE SLAB DETAILS STRUCTURE NUMBER 037-0069	
PROJECT FAP ROUTE 315 (IL 336/US 136) SECTION 34-5(5B) HANCOCK COUNTY STA. 1293+50.00(R) TO STA. 1297+00.00(R) STRUCTURE NUMBER 034-2521	PROJECT NO. 02076-R SCALE 9450 DATE 12/22/05 DRAWN BY TFG CHECKED BY BD/MCB DRAWING NO. 10 OF 18 SHTS
COOMBE-BLOXDORF P.C. Engineers / Land Surveyors Springfield, Illinois Design Firm License No. 184-002703	

5/4/2006
#FILE#BBREV#