

N. NO. 27, 6" BOAT SPIKE IN ROUGH LEAF HACKBERRY  
10' LT. STA. 16+73.0, L. ROWY. "C", ELEV. 571.873  
OTE: No Deck Posts Will be Permitted On The Structure

CURVE DATA  
(Ramp "D")  
P.I. STA. 16+87.71  
Δ = 110°-21'-03"  
D = 6°-30"  
R = 681.47'  
T = 1267.11'  
L = 1637.70'  
E = 562.08'  
S.E. = 0.078 V.  
P.C. STA. 16+20.60  
P.T. STA. 16+18.30

054-0051

NO.	SECTION	REMARKS	TOTAL SHEETS	SHEET NO.
1	1-11	1-11	11	11
2	2-11	2-11	11	11
3	3-11	3-11	11	11
4	4-11	4-11	11	11
5	5-11	5-11	11	11
6	6-11	6-11	11	11
7	7-11	7-11	11	11
8	8-11	8-11	11	11
9	9-11	9-11	11	11
10	10-11	10-11	11	11
11	11-11	11-11	11	11
12	12-11	12-11	11	11
13	13-11	13-11	11	11
14	14-11	14-11	11	11
15	15-11	15-11	11	11
16	16-11	16-11	11	11
17	17-11	17-11	11	11
18	18-11	18-11	11	11
19	19-11	19-11	11	11
20	20-11	20-11	11	11
21	21-11	21-11	11	11
22	22-11	22-11	11	11
23	23-11	23-11	11	11
24	24-11	24-11	11	11
25	25-11	25-11	11	11
26	26-11	26-11	11	11
27	27-11	27-11	11	11
28	28-11	28-11	11	11
29	29-11	29-11	11	11
30	30-11	30-11	11	11
31	31-11	31-11	11	11
32	32-11	32-11	11	11
33	33-11	33-11	11	11
34	34-11	34-11	11	11
35	35-11	35-11	11	11
36	36-11	36-11	11	11
37	37-11	37-11	11	11
38	38-11	38-11	11	11
39	39-11	39-11	11	11
40	40-11	40-11	11	11
41	41-11	41-11	11	11
42	42-11	42-11	11	11
43	43-11	43-11	11	11
44	44-11	44-11	11	11
45	45-11	45-11	11	11
46	46-11	46-11	11	11
47	47-11	47-11	11	11
48	48-11	48-11	11	11
49	49-11	49-11	11	11
50	50-11	50-11	11	11
51	51-11	51-11	11	11
52	52-11	52-11	11	11
53	53-11	53-11	11	11
54	54-11	54-11	11	11
55	55-11	55-11	11	11
56	56-11	56-11	11	11
57	57-11	57-11	11	11
58	58-11	58-11	11	11
59	59-11	59-11	11	11
60	60-11	60-11	11	11
61	61-11	61-11	11	11
62	62-11	62-11	11	11
63	63-11	63-11	11	11
64	64-11	64-11	11	11
65	65-11	65-11	11	11
66	66-11	66-11	11	11
67	67-11	67-11	11	11
68	68-11	68-11	11	11
69	69-11	69-11	11	11
70	70-11	70-11	11	11
71	71-11	71-11	11	11
72	72-11	72-11	11	11
73	73-11	73-11	11	11
74	74-11	74-11	11	11
75	75-11	75-11	11	11
76	76-11	76-11	11	11
77	77-11	77-11	11	11
78	78-11	78-11	11	11
79	79-11	79-11	11	11
80	80-11	80-11	11	11
81	81-11	81-11	11	11
82	82-11	82-11	11	11
83	83-11	83-11	11	11
84	84-11	84-11	11	11
85	85-11	85-11	11	11
86	86-11	86-11	11	11
87	87-11	87-11	11	11
88	88-11	88-11	11	11
89	89-11	89-11	11	11
90	90-11	90-11	11	11
91	91-11	91-11	11	11
92	92-11	92-11	11	11
93	93-11	93-11	11	11
94	94-11	94-11	11	11
95	95-11	95-11	11	11
96	96-11	96-11	11	11
97	97-11	97-11	11	11
98	98-11	98-11	11	11
99	99-11	99-11	11	11
100	100-11	100-11	11	11

GENERAL NOTES

All reinforcement bars shall be lapped 24 diameters unless otherwise shown.  
Fasteners shall be high strength bolts. Bolts 5/8" #, open holes 1 1/8" # unless otherwise noted. Bolts 3/4" # open holes 1 1/8" # unless otherwise noted.  
Calculated weight of Structural Steel = 220,730 lbs.  
The Basic Lead Silico Chromate paint system shall be used for shop and field painting of structural steel.  
Anchor bolts shall be set before bolting diaphragms over supports. Slope wall shall be reinforced with welded wire fabric 6" x 6" mesh, weighing 58# per 100 sq. ft. (For Quantity, see Sheet #1 Bill of Material.)  
Concrete piles at abutments shall be driven in holes precast through the embankment in accordance with Article 513.09(k) of the Standard Specs. The embankment configuration shown shall be the minimum embankment that must be constructed prior to construction of the abutments.  
The concrete rail section above the mandatory construction joint at the top of the slab shall be constructed of Class X Concrete, except the aggregates shall conform to the requirements of Handrail Concrete.  
Protective Coat shall not be applied to surfaces to which Cool Tar Interlayer Protective Coat is applied.  
Field welding of construction accessories will not be permitted to the bottom flange of beams and girders nor to the top flange for a distance equal to one-fourth the span length each way from the pier supports. Field welding in other areas will be permitted only when approved by the Engineer.  
The Contractor shall drive one concrete test pile in a permanent location at the West Abutment, and one Timber test pile in a permanent location at Pier 2 as directed by the Engineer before ordering the remainder of piles.

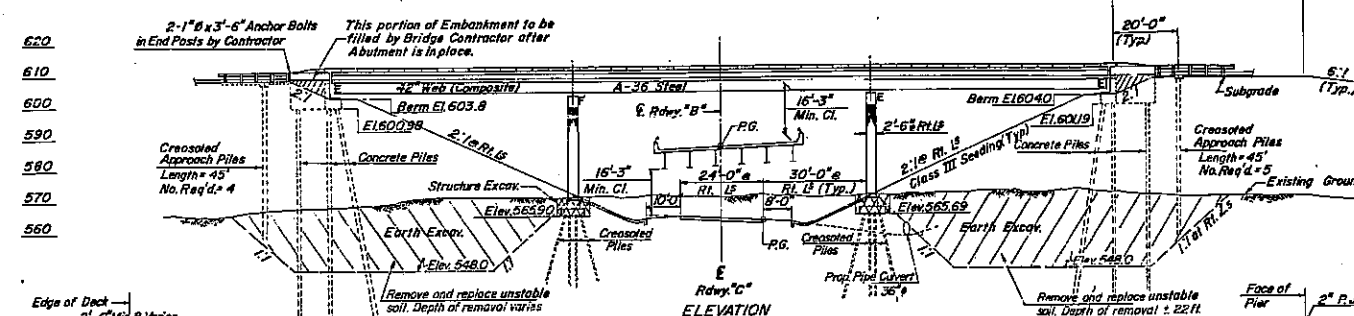

NOTE: For additional information on Earth Excavation and Porous Granular Embankment see Sheets #8 & #10 of Roadway Plans & Special Provisions.

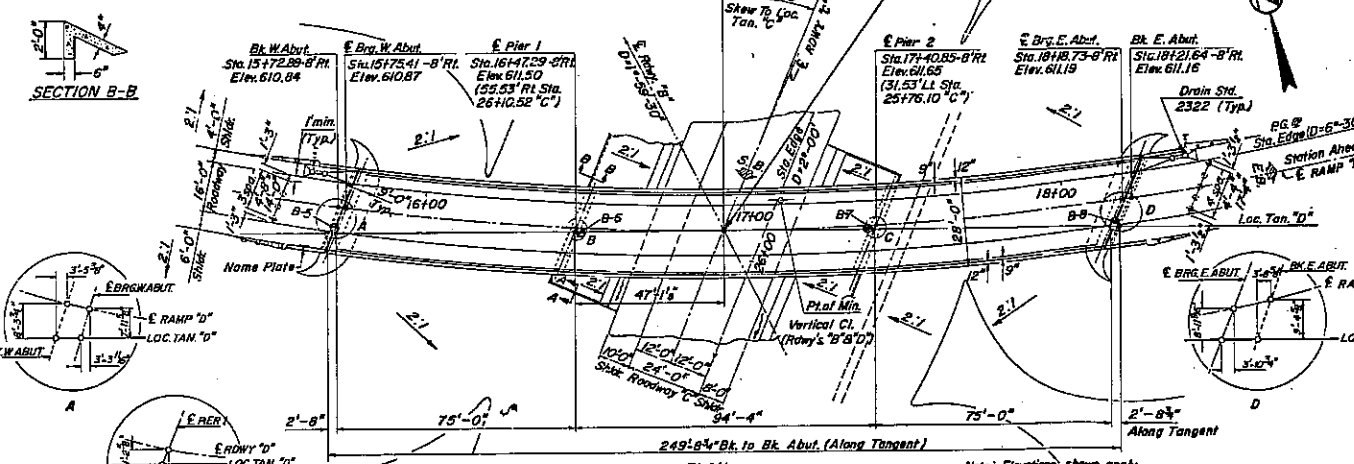

STATION 16+93.48 RAMP "D"  
BUILT BY  
STATE OF ILLINOIS  
F.A.I. RT. 55 SEC. 54-4HB  
LOADING HS20 & ALT.

NAME PLATE  
See Std. 2113

SEC. THRU SLOPEWALL  
(For Slope Wall Layout, See Sheet #19)

TOTAL BILL OF MATERIALS

ITEM	UNIT	SUPER	SUB	TOTAL
Structure Excavation	Cu. Yds.		170	170
Protective Coat	Sq. Yds.	215		215
Class X Concrete	Cu. Yds.	235.3	209.9	445.2
Structural Steel	Lump Sum			
Stud Shear Connectors	Each	2100		2100
Aluminum Railing	Lin. Ft.	546		546
Crossed Piles (Over 38')	Lin. Ft.		405	405
Concrete Piles	Lin. Ft.		1152	1152
Test Piles Concrete	Each		1	1
Test Piles Timber	Each		1	1
Crossed Piles (20' to 38')	Lin. Ft.		2130	2130
Cool Tar Interlayer Protective Coat	Sq. Yds.	674		674
Bituminous Conc. Sur. Cree. Class I	Tons	55		55
Preformed Joint Sealer	Lin. Ft.	30		30
Neoprene Expansion Joint (2"x)	Lin. Ft.	32		32
Name Plates	Each		1	1
Reinforcement Bars	Lbs.	55,500	35,370	90,870

\* Calculated weight of Structural = 220,730 lbs.  
\*\* Included in Sec. 54-4

FIELD UNITS  
fc = 1200 psi (Deck Slab)  
fc = 1400 psi (Other Concrete & Sub.)  
fs = 20,000 psi (Reinft.)  
fs = 20,000 psi (Struct.)  
fv = 75 psi (Fig.)  
n = 10

Allow 25% Se. Fl. for Initial Class I Surf.  
Allowable 4" Deflection L/1800 Comp.  
Design Specifications 1969 AASHTO (as applicable)

FUTURE W.S. = 25' / S.F.L.  
LOADING HS20-24 R. ALT.

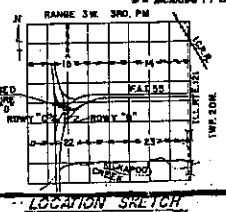

054-0051

GENERAL PLAN & ELEVATION  
SUPPL. FREEWAY, E.B. (RAMP "D")  
OVER SUPPL. FREEWAY, N.B. (ROWY "B")  
OVER F.A.I. RTE. 55, S.B. (ROWY "C")  
LOGAN COUNTY SEC. 54-4HB  
STA. 16+93.48-BRT, RAMP "D"  
STA. 16+55.68 ROWY "B"  
STA. 25+94.04-12' RT. ROWY "C"

DESIGNED	D.V.K.	EXAMINED	
CHECKED	G.E.P.	PASSED	
DRAWN	D.E.	APPROVED	
DATE			

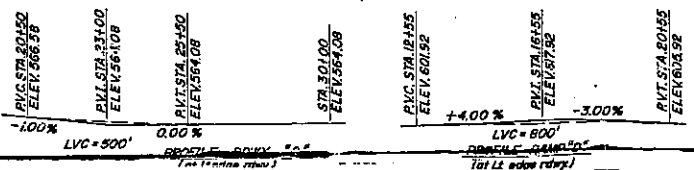

SN 054-0051  
EXISTING BRIDGE PLANS  
FOR INFORMATION ONLY  
(NOT TO SCALE)