

F.A. RTE.	SECTION	COUNTY	TOTAL SHEETS	SHEET NO.
•	••	MARION	17	5
STA.		TO STA.		
FED. ROAD DIST. NO.		ILLINOIS FED. AID PROJECT		

- VARIOUS ROUTES
- D7 SIGNAL MODERIZATION 2006-2

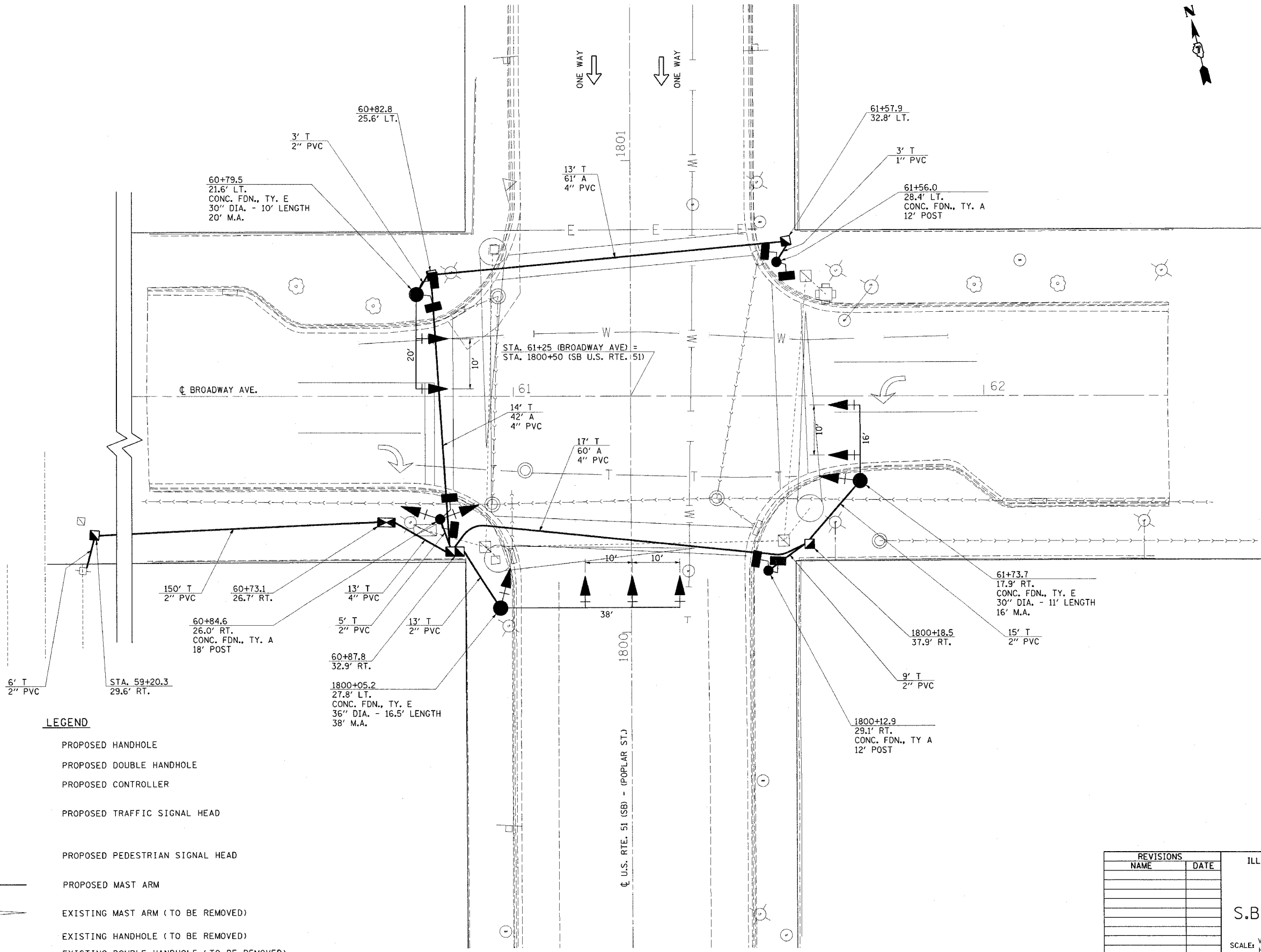

LEGEND

- PROPOSED HANDHOLE
- PROPOSED DOUBLE HANDHOLE
- PROPOSED CONTROLLER
- PROPOSED TRAFFIC SIGNAL HEAD
- PROPOSED PEDESTRIAN SIGNAL HEAD
- PROPOSED MAST ARM
- EXISTING MAST ARM (TO BE REMOVED)
- EXISTING HANDHOLE (TO BE REMOVED)
- EXISTING DOUBLE HANDHOLE (TO BE REMOVED)

PLOT DATE = 5/22/2006
 FILE NAME = #FILE#
 PLOT SCALE = #SCALE#
 USER NAME = #USER#

REVISIONS	
NAME	DATE

ILLINOIS DEPARTMENT OF TRANSPORTATION

SIGNAL LAYOUT
S.B. U.S. 51 & BROADWAY

SCALE: VERT. _____
 HORIZ. _____

DATE _____ DRAWN BY _____
 CHECKED BY _____