







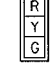

F.A. RTE.	SECTION	COUNTY	TOTAL SHEETS	SHEET NO.
*	**	MARION	17	9
STA.		TO STA.		
FED. ROAD DIST. NO.		ILLINOIS FED. AID PROJECT		

- * VARIOUS ROUTES
- ** D7 SIGNAL MODERIZATION 2006-2

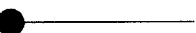
LEGEND

-  PROPOSED HANDHOLE
-  PROPOSED DOUBLE HANDHOLE
-  PROPOSED CONTROLLER
-  PROPOSED TRAFFIC SIGNAL HEAD
-  PROPOSED PEDESTRIAN SIGNAL HEAD
-  PROPOSED MAST ARM
-  EXISTING MAST ARM (TO BE REMOVED)
-  EXISTING HANDHOLE (TO BE REMOVED)
-  EXISTING DOUBLE HANDHOLE (TO BE REMOVED)

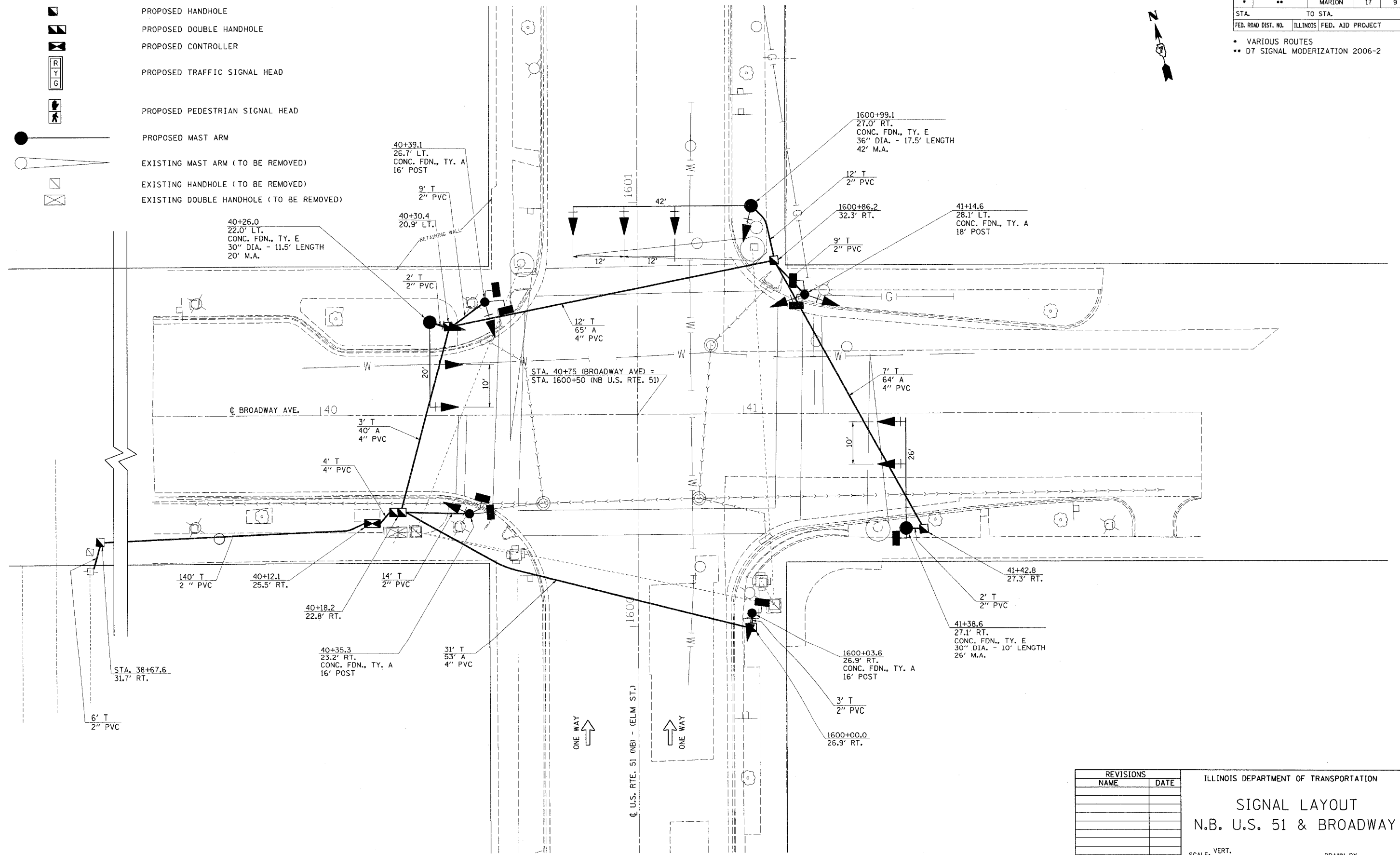

REVISIONS	
NAME	DATE

ILLINOIS DEPARTMENT OF TRANSPORTATION

SIGNAL LAYOUT
N.B. U.S. 51 & BROADWAY

SCALE: VERT. _____
DATE: _____

DRAWN BY _____
CHECKED BY _____

PLOT DATE = 5/22/2006
FILE NAME = #FILE#
PLOT SCALE = #SCALE#
USER NAME = #USER#

Rev. Sheet 5-31-06