







F.A. RTE.	SECTION	COUNTY	TOTAL SHEETS	SHEET NO.
•	**	MARION	17	10
STA.		TO STA.		
FED. ROAD DIST. NO.	ILLINOIS	FED. AID PROJECT		

- VARIOUS ROUTES
- D7 SIGNAL MODERIZATION 2006-2

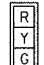
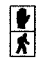
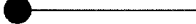
**LEGEND**

-  PROPOSED HANDHOLE
-  PROPOSED DOUBLE HANDHOLE
-  PROPOSED CONTROLLER
-  PROPOSED TRAFFIC SIGNAL HEAD
-  PROPOSED PEDESTRIAN SIGNAL HEAD
-  PROPOSED MAST ARM
-  EXISTING MAST ARM (TO BE REMOVED)
-  EXISTING HANDHOLE (TO BE REMOVED)
-  EXISTING DOUBLE HANDHOLE (TO BE REMOVED)

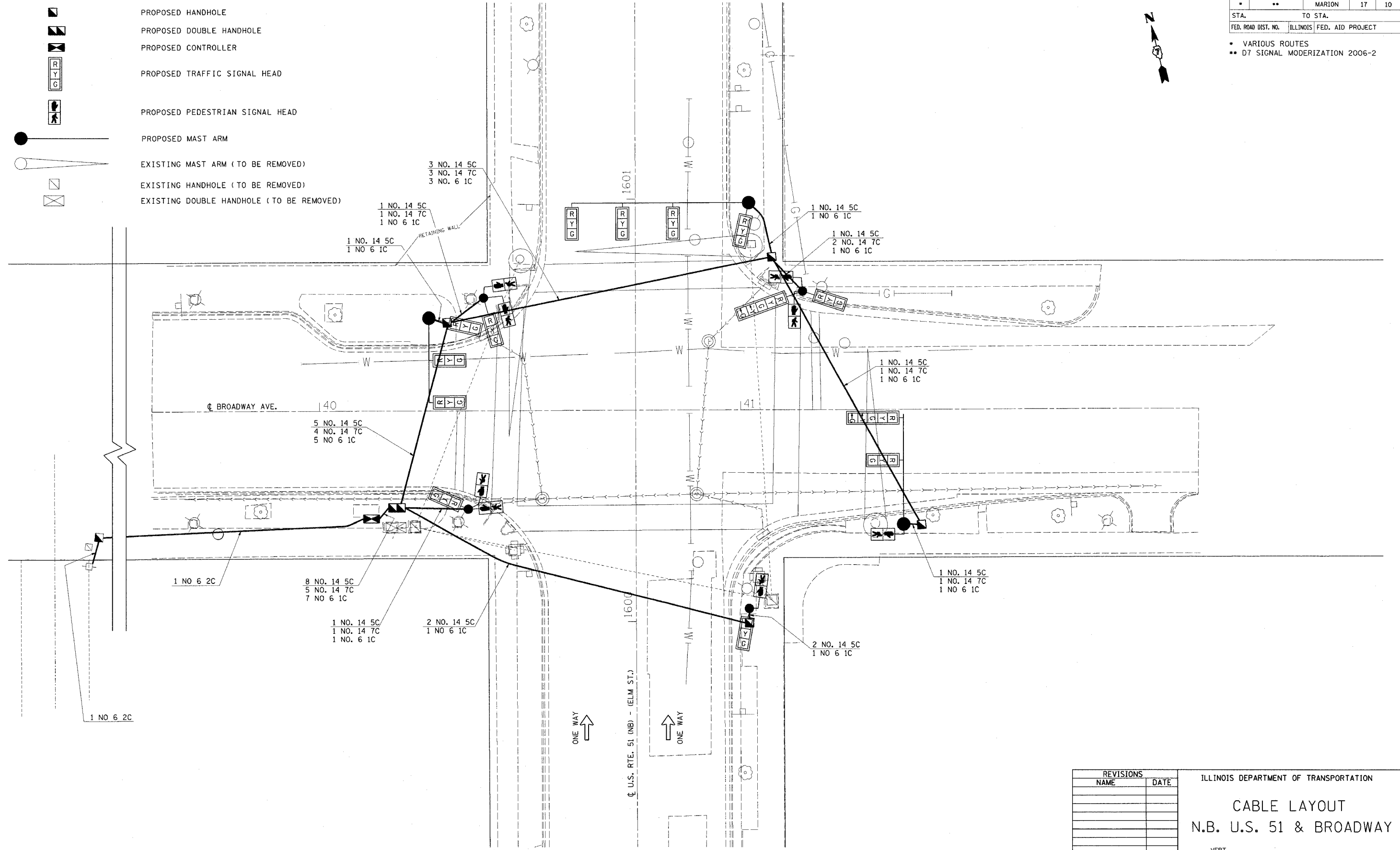

PLOT DATE = 3/25/2006  
 FILE NAME = MDELS  
 USER NAME = distprst

REVISIONS		DATE
NAME		

ILLINOIS DEPARTMENT OF TRANSPORTATION

### CABLE LAYOUT

#### N.B. U.S. 51 & BROADWAY

SCALE: VERT. \_\_\_\_\_  
 HORIZ. \_\_\_\_\_

DRAWN BY \_\_\_\_\_  
 CHECKED BY \_\_\_\_\_