







F.A. RTE.	SECTION	COUNTY	TOTAL SHEETS	SHEET NO.
*	**	MARION	17	13
STA.	TO STA.			
FED. ROAD DIST. NO.	ILLINOIS	FED. AID PROJECT		

- VARIOUS ROUTES
- D7 SIGNAL MODERIZATION 2006-2

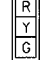
LEGEND

-  PROPOSED HANDHOLE
-  PROPOSED DOUBLE HANDHOLE
-  PROPOSED CONTROLLER
-  PROPOSED TRAFFIC SIGNAL HEAD
-  PROPOSED PEDESTRIAN SIGNAL HEAD
-  PROPOSED MAST ARM
-  EXISTING MAST ARM (TO BE REMOVED)
-  EXISTING HANDHOLE (TO BE REMOVED)
-  EXISTING DOUBLE HANDHOLE (TO BE REMOVED)

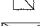
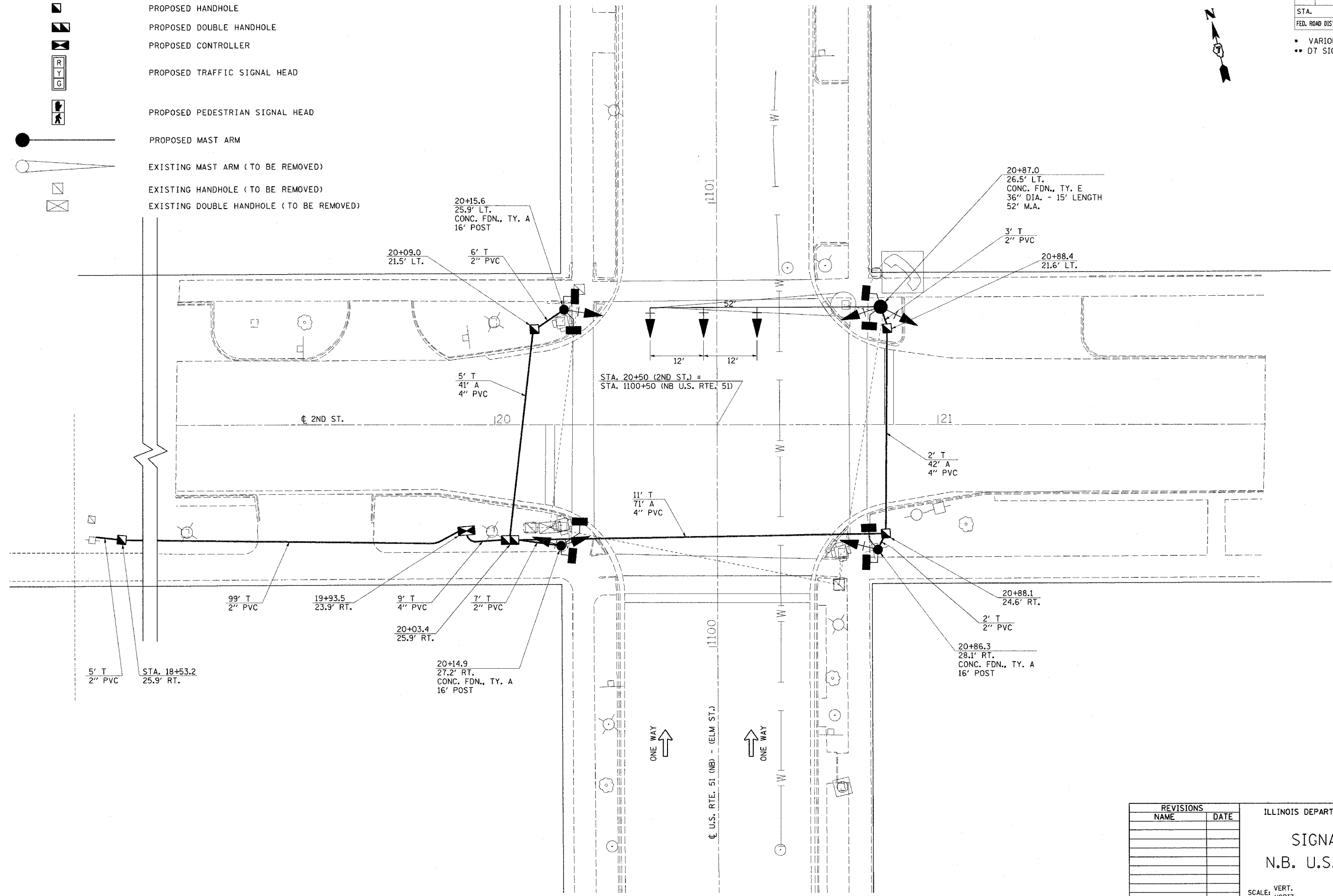

PLOT DATE = 3/28/2006
 FILE NAME = BFILEL8
 USER NAME = Bstump

REVISIONS	
NAME	DATE

ILLINOIS DEPARTMENT OF TRANSPORTATION

SIGNAL LAYOUT

N.B. U.S. 51 & 2ND ST.

SCALE: VERT. _____
 HORIZ. _____

DATE _____ DRAWN BY _____
 CHECKED BY _____