

F.A. RTE.	SECTION	COUNTY	TOTAL SHEETS	SHEET NO.
*	**	MARION	17	17
STA.		TO STA.		
FED. ROAD DIST. NO.		ILLINOIS	FED. AID PROJECT	

- * VARIOUS ROUTES
- ** D7 SIGNAL MODERIZATION 2006-2

LEGEND

- TRAFFIC SIGNAL HEAD
- PEDESTRIAN SIGNAL HEAD
- PEDESTRIAN PUSH-BUTTON

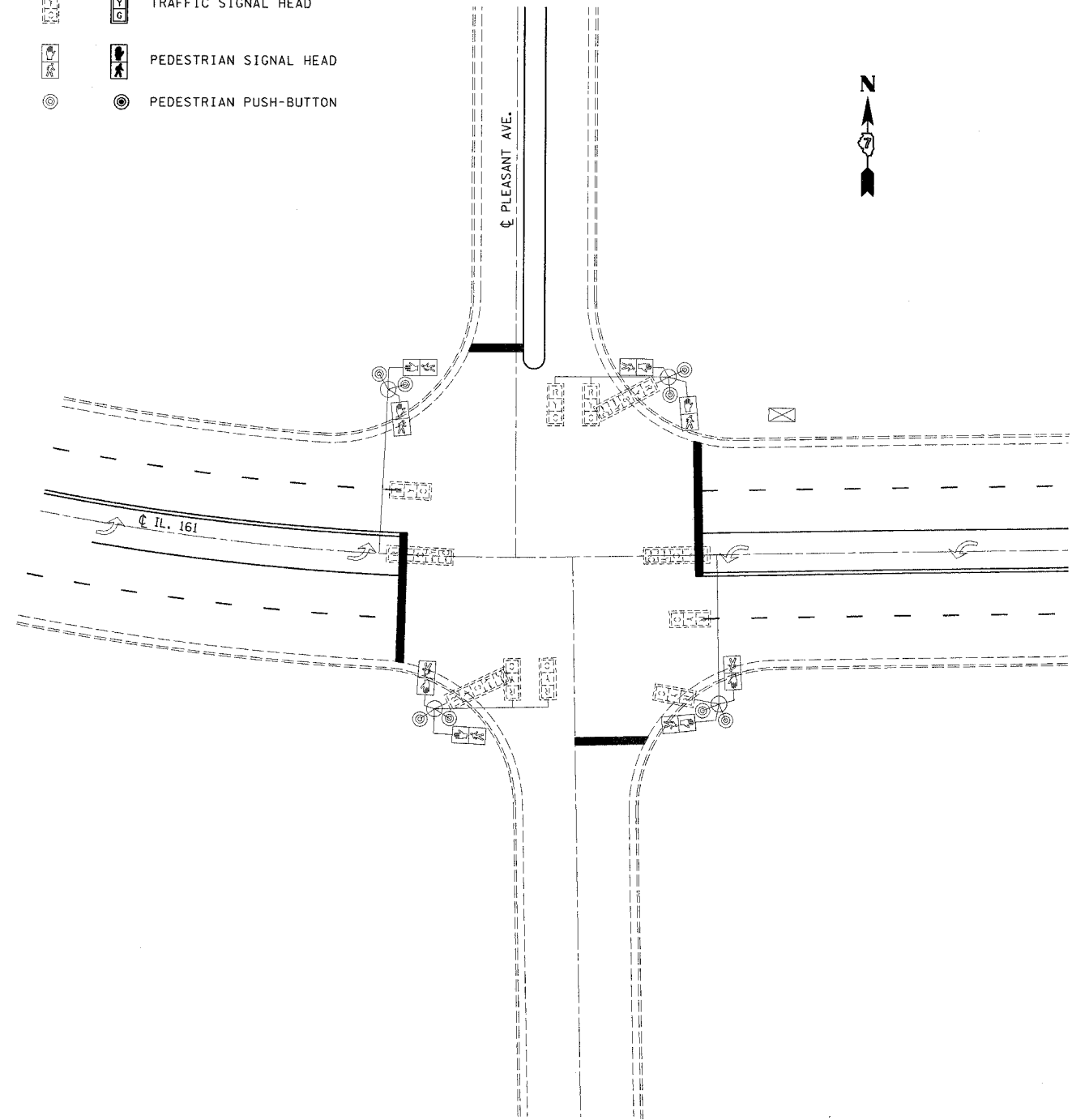

LEGEND

- TRAFFIC SIGNAL HEAD
- PEDESTRIAN SIGNAL HEAD
- PEDESTRIAN PUSH-BUTTON

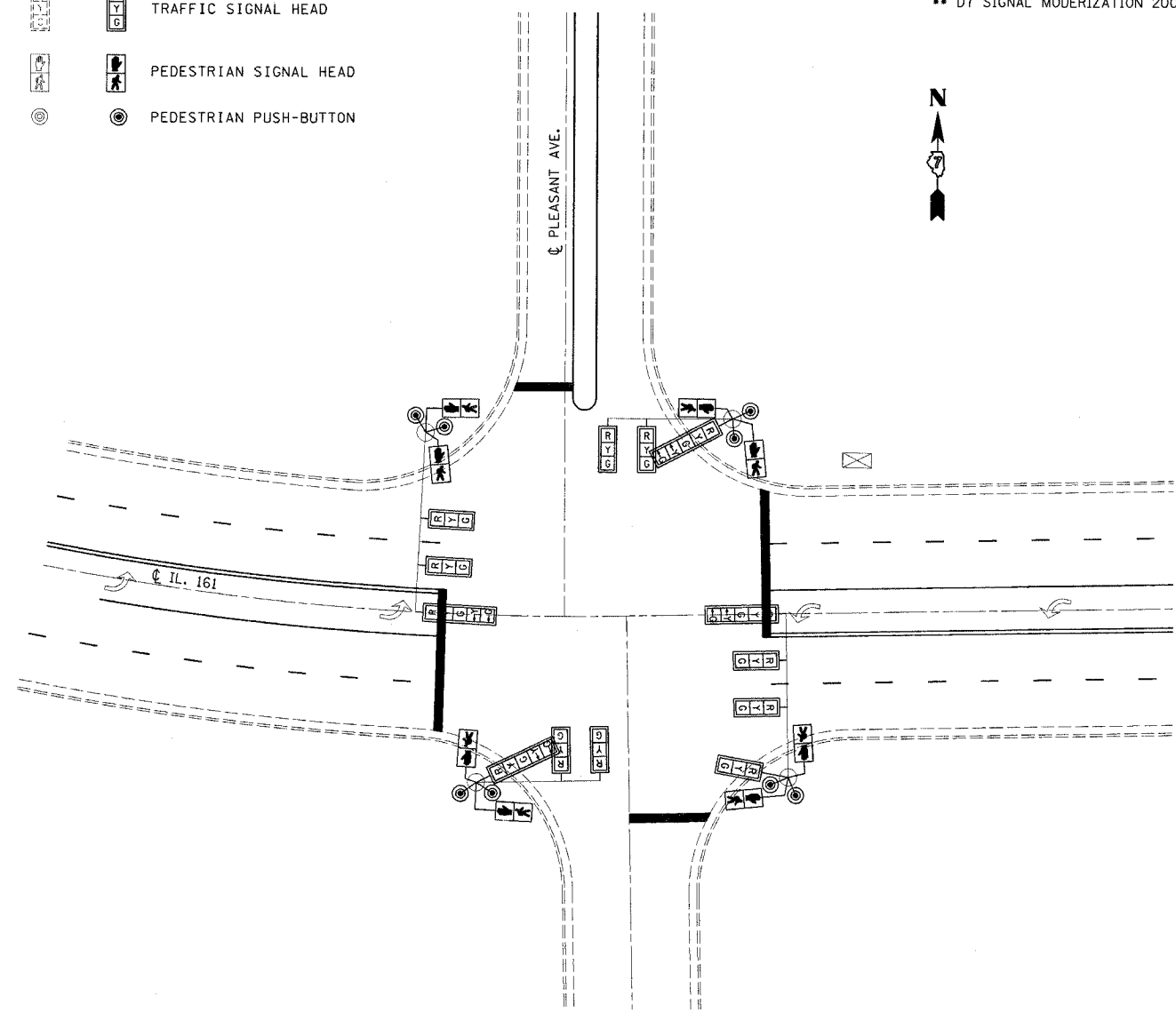

BILL OF MATERIALS
IL. RTE. 161 & PLEASANT AVE.

ITEM	UNIT	QUANTITY
ELECTRIC CABLE IN CONDUIT, SIGNAL, NO. 14 7C	FOOT	30.0
TRAFFIC SIGNAL BACKPLATE, LOUVERED, FORMED PLASTIC	EACH	13.0
PEDESTRIAN PUSH BUTTON	EACH	8.0
MODIFY EXISTING CONTROLLER CABINET	EACH	1.0
REMOVE EXISTING TRAFFIC SIGNAL EQUIPMENT	EACH	1.0
SIGNAL HEAD, POLYCARBONATE, LED, 1-FACE, 3-SECTION, BRACKET MOUNTED	EACH	1.0
SIGNAL HEAD, POLYCARBONATE, LED, 1-FACE, 3-SECTION, MAST ARM MOUNTED	EACH	8.0
SIGNAL HEAD, POLYCARBONATE, LED, 1-FACE, 5-SECTION, BRACKET MOUNTED	EACH	2.0
SIGNAL HEAD, POLYCARBONATE, LED, 1-FACE, 5-SECTION, MAST ARM MOUNTED	EACH	2.0
PEDESTRIAN SIGNAL HEAD, POLYCARBONATE, LED, 2-FACE	EACH	4.0

REVISIONS	
NAME	DATE

ILLINOIS DEPARTMENT OF TRANSPORTATION

SIGNAL LAYOUT
IL. 161 & PLEASANT AVE.

SCALE: VERT. _____
HORIZ. _____

DATE _____ DRAWN BY _____
CHECKED BY _____

PLOT DATE = 3/20/2006
PLOT SCALE = AS SHOWN
USER NAME = dbrist