

F.A. RTE.	SECTION	COUNTY	TOTAL SHEETS	SHEET NO.
*	**	JEFFERSON	6	1

- VARIOUS ROUTES
- D7 SIGNAL MODERNIZATION 2006-4

D-97-019-05

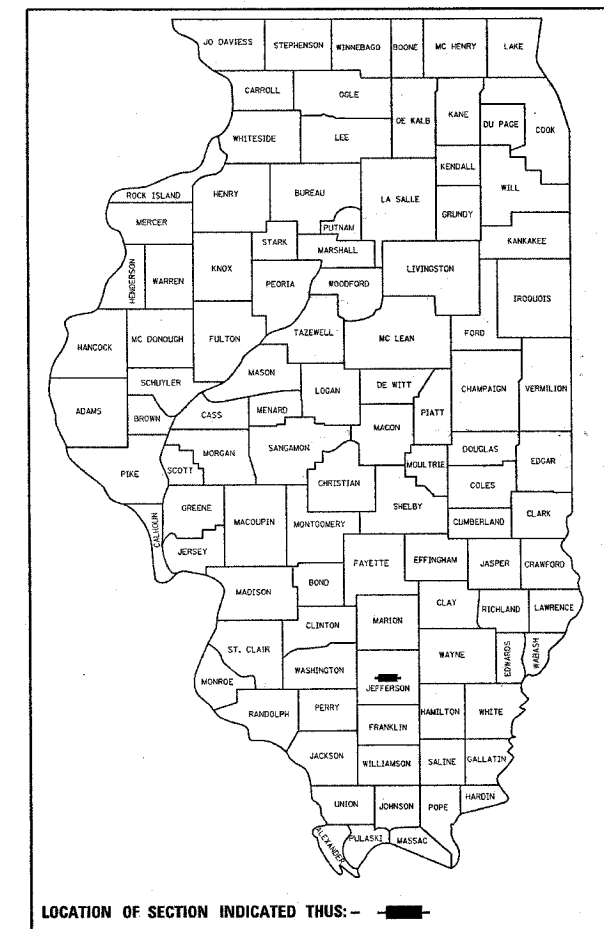

STATE OF ILLINOIS
 DEPARTMENT OF TRANSPORTATION
 DIVISION OF HIGHWAYS

**PROPOSED
 HIGHWAY PLANS**

F.A.P. ROUTE 821 (IL. 15 EB) & 12TH ST.

F.A.P. ROUTE 821 (IL. 15) & 27TH ST.

& PROJECT: HS-0005(485)

F.A.P. ROUTE 724 (IL. 37) & JORDAN ST.

SECTION D7 SIGNAL MODERNIZATION 2006-4

JEFFERSON COUNTY

C-97-050-05

FOR INDEX OF SHEETS, SEE SHEET NO. 2

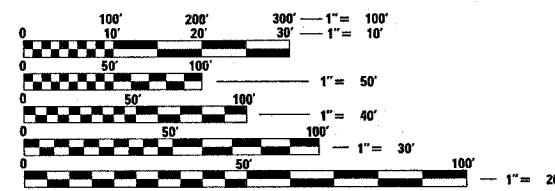
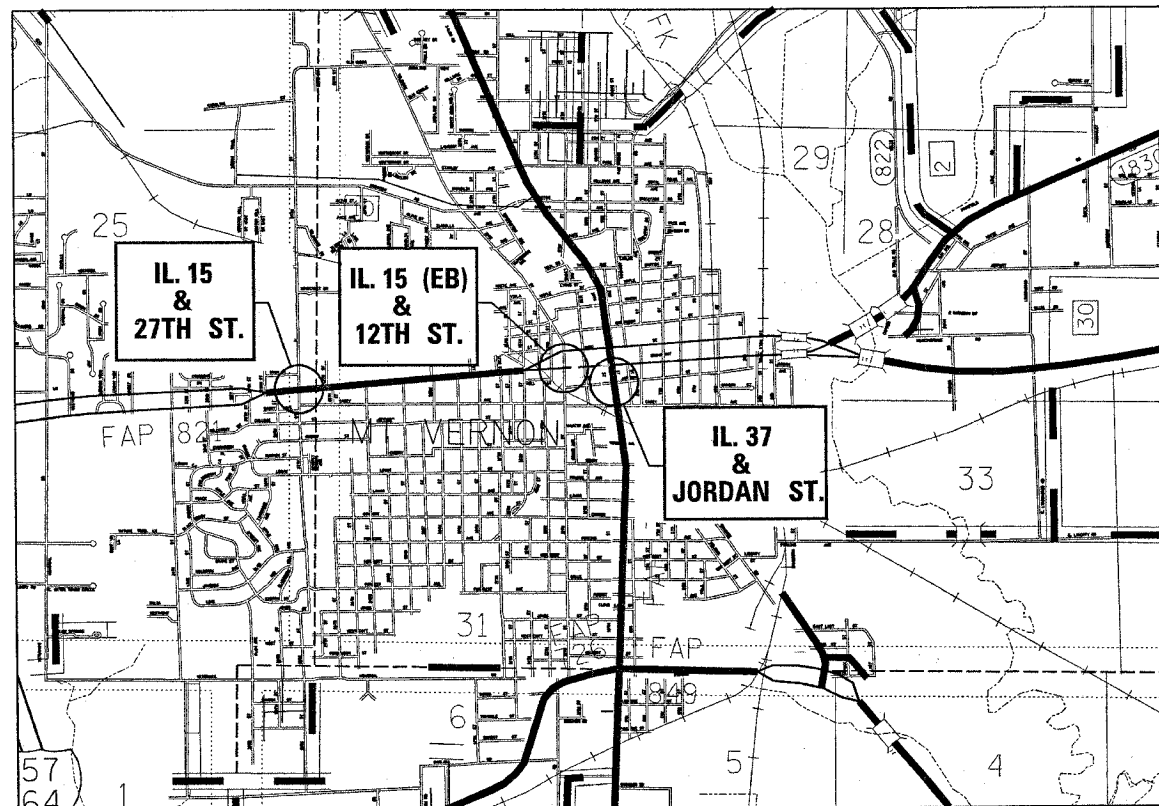

FULL SIZE PLANS HAVE BEEN PREPARED USING STANDARD ENGINEERING SCALES. REDUCED SIZED PLANS WILL NOT CONFORM TO STANDARD SCALES. IN MAKING MEASUREMENTS ON REDUCED PLANS, THE ABOVE SCALES MAY BE USED.

J.U.L.I.E.
 JOINT UTILITY LOCATION INFORMATION FOR EXCAVATION
 1-800-892-0123

CITY OF MT. VERNON
 IL. 15 & 27TH ST.
 IL. 15 & 12TH ST.
 IL. 37 & JORDAN ST.

STATE OF ILLINOIS
 DEPARTMENT OF TRANSPORTATION
 DIVISION OF HIGHWAYS

SUBMITTED March 8, 2006
Christ H. Reed
 DEPUTY DIRECTOR OF HIGHWAYS, REGION ENGINEER

May 12, 2006
Mike Hine
 ENGINEER OF DESIGN AND ENVIRONMENT

May 12, 2006
Milton P. Sees, P.E.
 DIRECTOR OF HIGHWAYS, CHIEF ENGINEER

**PRINTED BY THE AUTHORITY
 OF THE STATE OF ILLINOIS**

PROJECT ENGINEER : ROB MACKLIN
 DESIGNER : LYNN MCCLELLAN
 TELEPHONE : 217/342-3951 EX 245

CONTRACT NO. 74091

F.A. RTE.	SECTION	COUNTY	TOTAL SHEETS	SHEET NO.
*	**	JEFFERSON	6	2
STA.		TO STA.		
FED. ROAD DIST. NO.	ILLINOIS	FED. AID PROJECT		

- * VARIOUS ROUTES
- ** D7 SIGNAL MODERNIZATION 2006-4

GENERAL NOTES

THIS SECTION SHALL BE CONSTRUCTED IN ACCORDANCE WITH THE PLANS, THE "STANDARD SPECIFICATIONS FOR ROAD AND BRIDGE CONSTRUCTION", ADOPTED JANUARY 1, 2002; THE "SUPPLEMENTAL SPECIFICATIONS AND RECURRING SPECIAL PROVISIONS" ADOPTED MARCH 1, 2004; AND "THE SPECIAL PROVISIONS" INCLUDED IN THE PROPOSAL.

THIS PROJECT IS LOCATED AT THREE DIFFERENT LOCATIONS: THE INTERSECTION OF IL ROUTE 15 AND 27TH STREET, THE INTERSECTION OF IL ROUTE 15 (EB) & 12TH STREET AND THE INTERSECTION OF IL ROUTE 37 & JORDAN STREET IN THE CITY OF MT. VERNON, IN JEFFERSON COUNTY. THE WORK INCLUDED IN THIS SECTION CONSISTS OF INSTALLING TRAFFIC SIGNALS, RETROFITTING TRAFFIC SIGNAL HEADS AND PEDESTRIAN SIGNAL HEADS AND ALL OTHER WORK NECESSARY TO COMPLETE THIS SECTION.

THE CONTRACTOR SHALL VERIFY THE EXACT LOCATION OF ALL UNDERGROUND UTILITIES PRIOR TO BEGINNING CONSTRUCTION. CALL J.U.L.I.E. AT 1-800-892-0123.

THE LOCATION OF ALL TRAFFIC COMPONENTS AS SHOWN ON THE PLANS ARE APPROXIMATE ONLY. THE FINAL LOCATION SHALL BE DETERMINED BY THE ENGINEER IN THE FIELD.

ALL HARDWARE SHALL BE TIGHTENED AND WELL SECURED. CABLES SHALL BE NEATLY WOUND IN HANDHOLES. CABLES SHALL BE NEATLY TRAINED IN THE CONTROLLER CABINET.

ALL THREADS OF BOLTS USED IN ASSEMBLY OF TRAFFIC SIGNAL COMPONENTS SHALL BE COATED WITH A NON-LEAD BASED ANTI-SEIZE COMPOUND, SIMILAR TO LEAD PLATE, PRIOR TO ASSEMBLY.

THE NUMBER OF CONDUCTORS FOR ELECTRIC CABLES AS SHOWN ON THE PLANS SHALL BE THE MINIMUM NUMBER OF CONDUCTORS FURNISHED FOR EACH LOCATION. THE CONTRACTOR MAY SUBSTITUTE AN ELECTRIC CABLE WITH MORE CONDUCTORS THAN SPECIFIED BUT NO ADDITIONAL COMPENSATION WILL BE MADE FOR THE EXTRA CONDUCTORS.

ALL NEW TRAFFIC AND PEDESTRIAN SIGNAL WIRING SHALL EXTEND FROM CONTROLLER TO SIGNAL. SPLICES IN HANDHOLES WILL NOT BE ALLOWED.

ALL MAST ARM MOUNTED SIGNAL HEADS ON AN INDIVIDUAL MAST ARM SHALL BE MOUNTED SO THAT THE RED INDICATIONS ARE LEVEL WITH EACH OTHER.

THERE ARE 12 LOAD SWITCHES AT THE INTERSECTION OF IL 15 & 27TH STREET, 6 LOAD SWITCHES AT THE INTERSECTION OF IL 15 & 12TH STREET AND 8 LOAD SWITCHES AT THE INTERSECTION OF IL 37 & JORDAN STREET THAT WILL NEED TO BE REMOVED AND REPLACED. THIS WILL BE INCLUDED WITH THE MODIFY CONTROLLER CABINET PAY ITEM.

THIS WORK SHALL BE DONE IN ACCORDANCE WITH THE APPLICABLE SECTION OF 895 OF THE STANDARD SPECIFICATIONS. ALL EXISTING EQUIPMENT THAT IS TO BE REPLACED UNDER THIS CONTRACT WILL BECOME THE PROPERTY OF THE CITY OF MT. VERNON. THE CONTRACTOR SHALL SAVE HARMLESS AND DELIVER THE EQUIPMENT TO:

CITY OF MT. VERNON CONTACT:
 ELBERT CAIN
 SUPERVISOR OF PUBLIC WORKS
 1100 MAIN ST.
 MT. VERNON, IL 62864

INDEX OF SHEETS

- 1 COVER SHEET
- 2 INDEX OF SHEETS AND GENERAL NOTES
- 3 SUMMARY OF QUANTITIES
- 4 IL 15 & 27TH STREET SIGNAL LAYOUT
- 5 IL 15 (EB) & 12TH STREET SIGNAL LAYOUT
- 6 IL 37 & JORDAN STREET SIGNAL LAYOUT

STANDARDS IN THE PLANS

THE FOLLOWING STANDARDS ARE A PART OF THESE PLANS AND ARE INCLUDED AFTER SHEET NO. 6:

- 000001-04 STANDARD SYMBOLS, ABBREVIATIONS AND PATTERNS
- 701301-02 LANE CLOSURE, 2L, 2W, SHORT TIME OPERATIONS
- 701601-04 URBAN LANE CLOSURE, MULTILANE, 1W OR 2W W/NONTRAVERSABLE MEDIAN
- 701602-02 URBAN LANE CLOSURE, MULTILANE, 2W W/BIDIRECTIONAL LEFT TURN LANE
- 701606-04 URBAN LANE CLOSURE, MULTILANE, 2W W/MOUNTABLE MEDIAN
- 701701-04 URBAN LANE CLOSURE, MULTILANE INTERSECTION
- 702001-06 TRAFFIC CONTROL DEVICES
- 720001 SIGN PANEL MOUNTING DETAILS
- 880006 TRAFFIC SIGNAL MOUNTING DETAILS

PLOT DATE = 3/8/2006
 FILE NAME = #FILE#
 PLOT SCALE = #SCALE#
 USER NAME = #USER#

REVISIONS	
NAME	DATE

ILLINOIS DEPARTMENT OF TRANSPORTATION

GENERAL NOTES & INDEX OF SHEETS

SCALE: VERT.
 DATE: HORIZ.

DRAWN BY
 CHECKED BY

Rev.

F.A. RTE.	SECTION	COUNTY	TOTAL SHEETS	SHEET NO.
*	**	JEFFERSON	6	3
STA.		TO STA.		
FED. ROAD DIST. NO.		ILLINOIS	FED. AID PROJECT	

90% FED. 5% STATE 5% CITY
 90% FED. 7.5% STATE 2.5% CITY

SUMMARY OF QUANTITIES			URBAN TOTAL QUANTITIES	CONSTRUCTION TYPE CODE		
CODE NO	ITEM	UNIT		Y031-1F	Y031-1F	Y031-1F
				IL. RTE. 15 & 27TH ST.	IL. RTE. 15 & 12TH ST.	IL. RTE. 37 & JORDAN ST.
67100100	MOBILIZATION	L SUM	1	0.34	0.33	0.33
70102625	TRAFFIC CONTROL AND PROTECTION, STANDARD 701606	L SUM	1			1
70102630	TRAFFIC CONTROL AND PROTECTION, STANDARD 701601	L SUM	1		1	
70102632	TRAFFIC CONTROL AND PROTECTION, STANDARD 701602	L SUM	1	1		
70102635	TRAFFIC CONTROL AND PROTECTION, STANDARD 701701	L SUM	1	0.34	0.33	0.33
87301245	ELECTRIC CABLE IN CONDUIT, SIGNAL NO. 14 5C	FOOT	138	45	93	
88200410	TRAFFIC SIGNAL BACKPLATE, LOUVERED, FORMED PLASTIC	EACH	30	14	8	8
88800100	PEDESTRIAN PUSH-BUTTON	EACH	12	8		4
89500100	RELOCATE EXISTING SIGNAL HEAD	EACH	2	2		
89502210	MODIFY EXISTING CONTROLLER CABINET	EACH	3	1	1	1
89502375	REMOVE EXISTING TRAFFIC SIGNAL EQUIPMENT	EACH	3	1	1	1
X0323336	LED SIGNAL FACE RETROFIT, RED BALL	EACH	26	11	7	8
X0323337	LED SIGNAL FACE RETROFIT, GREEN BALL	EACH	26	11	7	8
X0323339	LED SIGNAL FACE RETROFIT, WALK/DON'T WALK SPECIAL	EACH	24	8	8	8
X0323418	LED SIGNAL FACE RETROFIT, YELLOW BALL	EACH	26	11	7	8
X0323419	LED SIGNAL FACE RETROFIT, YELLOW ARROW	EACH	6	6		
X0323420	LED SIGNAL FACE RETROFIT, GREEN ARROW	EACH	6	6		
X8801300	SIGNAL HEAD, POLYCARBONATE, LED, 1-FACE, 3-SECTION, BRACKET MOUNTED	EACH	1		1	
X8801310	SIGNAL HEAD, POLYCARBONATE, LED, 1-FACE, 3-SECTION, MAST ARM MOUNTED	EACH	3	3		

- VARIOUS ROUTES
- D7 SIGNAL MODERNIZATION 2006-4

REVISIONS	
NAME	DATE

ILLINOIS DEPARTMENT OF TRANSPORTATION

SUMMARY OF QUANTITIES

SCALE: VERT. _____
 HORIZ. _____

DATE _____

DRAWN BY _____
 CHECKED BY _____

BILL OF MATERIALS
IL ROUTE 15 & 27th STREET

F.A. RTE.	SECTION	COUNTY	TOTAL SHEETS	SHEET NO.
*	**	JEFFERSON	6	4
STA.		TO STA.		
FED. ROAD DIST. NO.	ILLINOIS	FED. AID PROJECT		



- * VARIOUS ROUTES
- ** D7 SIGNAL MODERNIZATION 2006-4

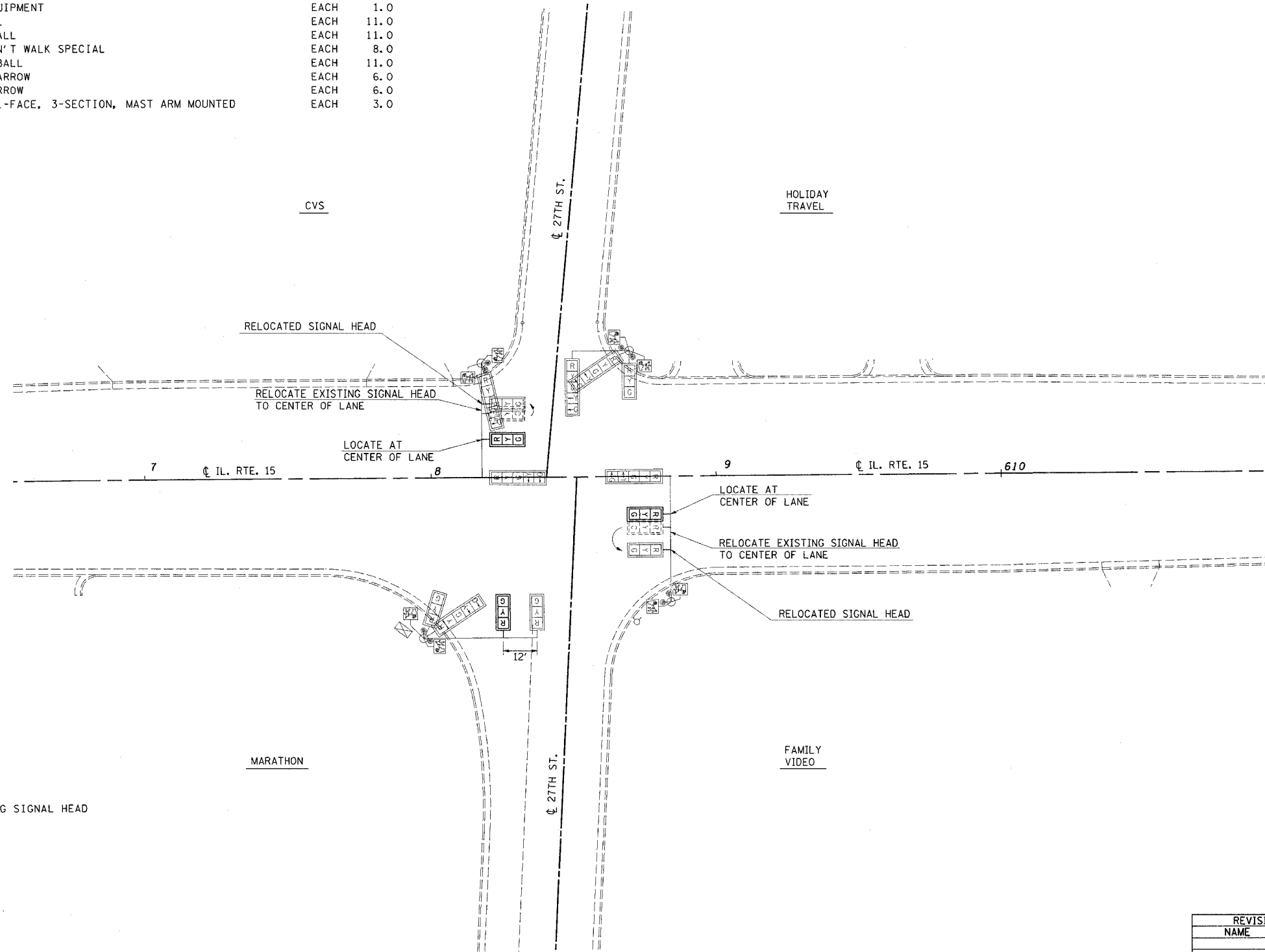

ITEM	UNIT	QUANTITY
ELECTRIC CABLE IN CONDUIT, SIGNAL, NO. 14 5C	FOOT	45.0
TRAFFIC SIGNAL BACKPLATE, LOUVERED, FORMED PLASTIC	EACH	14.0
PEDESTRIAN PUSH BUTTON	EACH	8.0
RELOCATE EXISTING SIGNAL HEAD	EACH	2.0
MODIFY EXISTING CONTROLLER CABINET	EACH	1.0
REMOVE EXISTING TRAFFIC SIGNAL EQUIPMENT	EACH	1.0
LED SIGNAL FACE RETROFIT, RED BALL	EACH	11.0
LED SIGNAL FACE RETROFIT, GREEN BALL	EACH	11.0
LED SIGNAL FACE RETROFIT, WALK/DON'T WALK SPECIAL	EACH	8.0
LED SIGNAL FACE RETROFIT, YELLOW BALL	EACH	11.0
LED SIGNAL FACE RETROFIT, YELLOW ARROW	EACH	6.0
LED SIGNAL FACE RETROFIT, GREEN ARROW	EACH	6.0
SIGNAL HEAD, POLYCARBONATE, LED, 1-FACE, 3-SECTION, MAST ARM MOUNTED	EACH	3.0

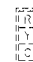
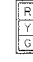

LEGEND

-  - RELOCATE EXISTING SIGNAL HEAD
-  - LED RETROFIT
-  - NEW SIGNAL HEAD
-  - LED RETROFIT

REVISIONS	
NAME	DATE

ILLINOIS DEPARTMENT OF TRANSPORTATION

**IL. RTE. 15
&
27TH STREET**

SCALE: VERT. _____
 DATE _____ HORIZ. _____

DRAWN BY _____
 CHECKED BY _____

PLOT DATE = 3/6/2006
 PLOT SCALE = 1"=40'-0"
 USER NAME = dist101

F.A. RTE.	SECTION	COUNTY	TOTAL SHEETS	SHEET NO.
*	**	JEFFERSON	6	5

STA.	TO STA.

FED. ROAD DIST. NO. ILLINOIS FED. AID PROJECT
 • VARIOUS ROUTES
 •• D7 SIGNAL MODERNIZATION 2006-4



BILL OF MATERIALS IL ROUTE 15 & 12th STREET

ITEM	UNIT	QUANTITY
ELECTRIC CABLE IN CONDUIT, SIGNAL, NO. 14 5C	FOOT	93.0
TRAFFIC SIGNAL BACKPLATE, LOUVERED, FORMED PLASTIC	EACH	8.0
MODIFY EXISTING CONTROLLER CABINET	EACH	1.0
REMOVE EXISTING TRAFFIC SIGNAL EQUIPMENT	EACH	1.0
LED SIGNAL FACE RETROFIT, RED BALL	EACH	7.0
LED SIGNAL FACE RETROFIT, GREEN BALL	EACH	7.0
LED SIGNAL FACE RETROFIT, WALK/DON'T WALK SPECIAL	EACH	8.0
LED SIGNAL FACE RETROFIT, YELLOW BALL	EACH	7.0
SIGNAL HEAD, POLYCARBONATE, LED, 1-FACE, 3-SECTION, BRACKET MOUNTED	EACH	1.0

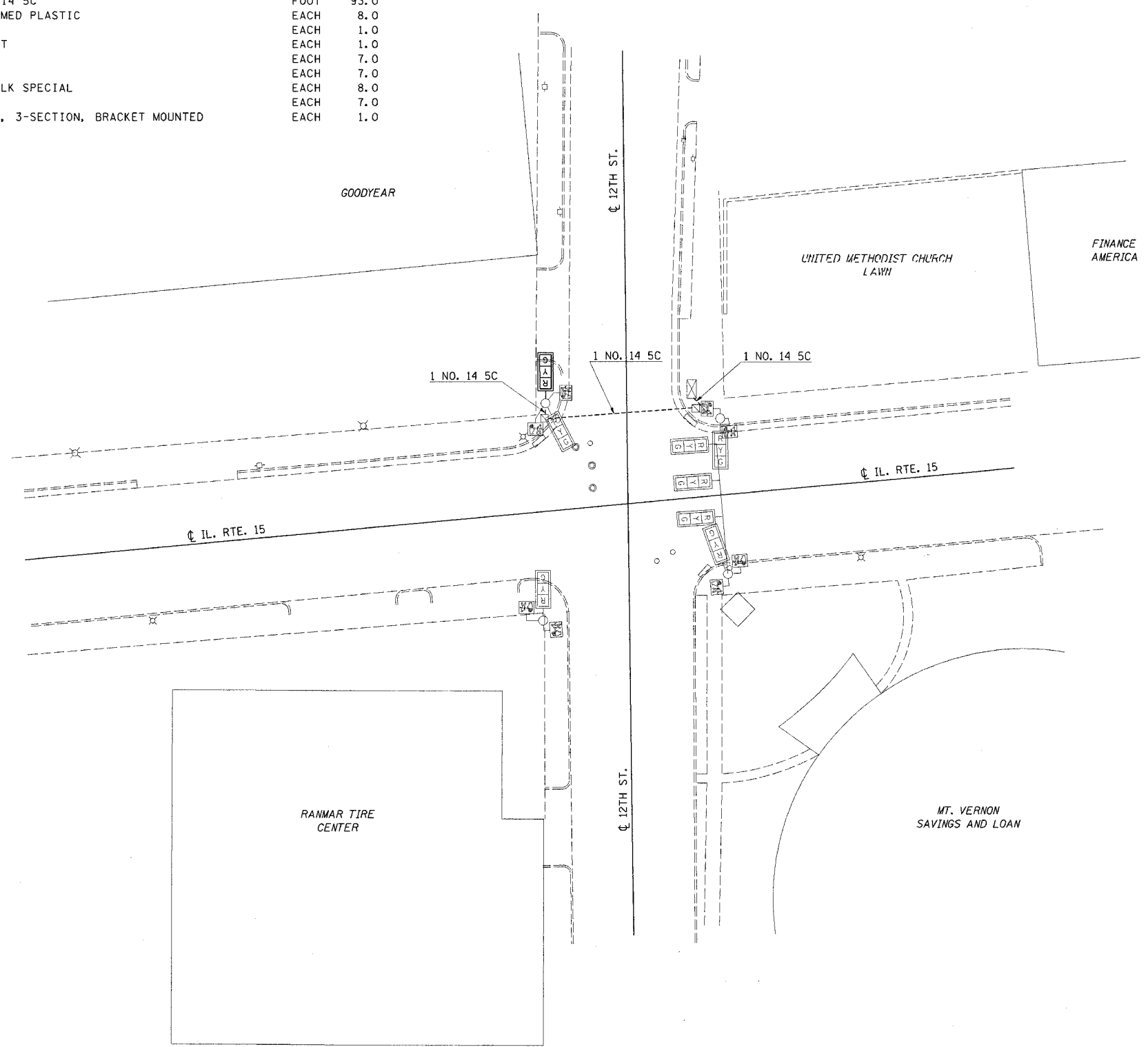

LEGEND

- LED RETROFIT
- NEW SIGNAL HEAD
- LED RETROFIT

PLOT DATE = 3/6/2006
 FILE NAME = WFL1512
 USER NAME = dbrunet

REVISIONS	
NAME	DATE

ILLINOIS DEPARTMENT OF TRANSPORTATION

IL. RTE. 15 & 12TH STREET

SCALE: VERT. _____
HORIZ. _____

DRAWN BY _____
CHECKED BY _____

F.A. RTE.	SECTION	COUNTY	TOTAL SHEETS	SHEET NO.
*	**	JEFFERSON	6	6
STA.		TO STA.		
FED. ROAD DIST. NO.	ILLINOIS	FED. AID PROJECT		



- * VARIOUS ROUTES
- ** D7 SIGNAL MODERNIZATION 2006-4

BILL OF MATERIALS
IL ROUTE 37 & JORDAN STREET

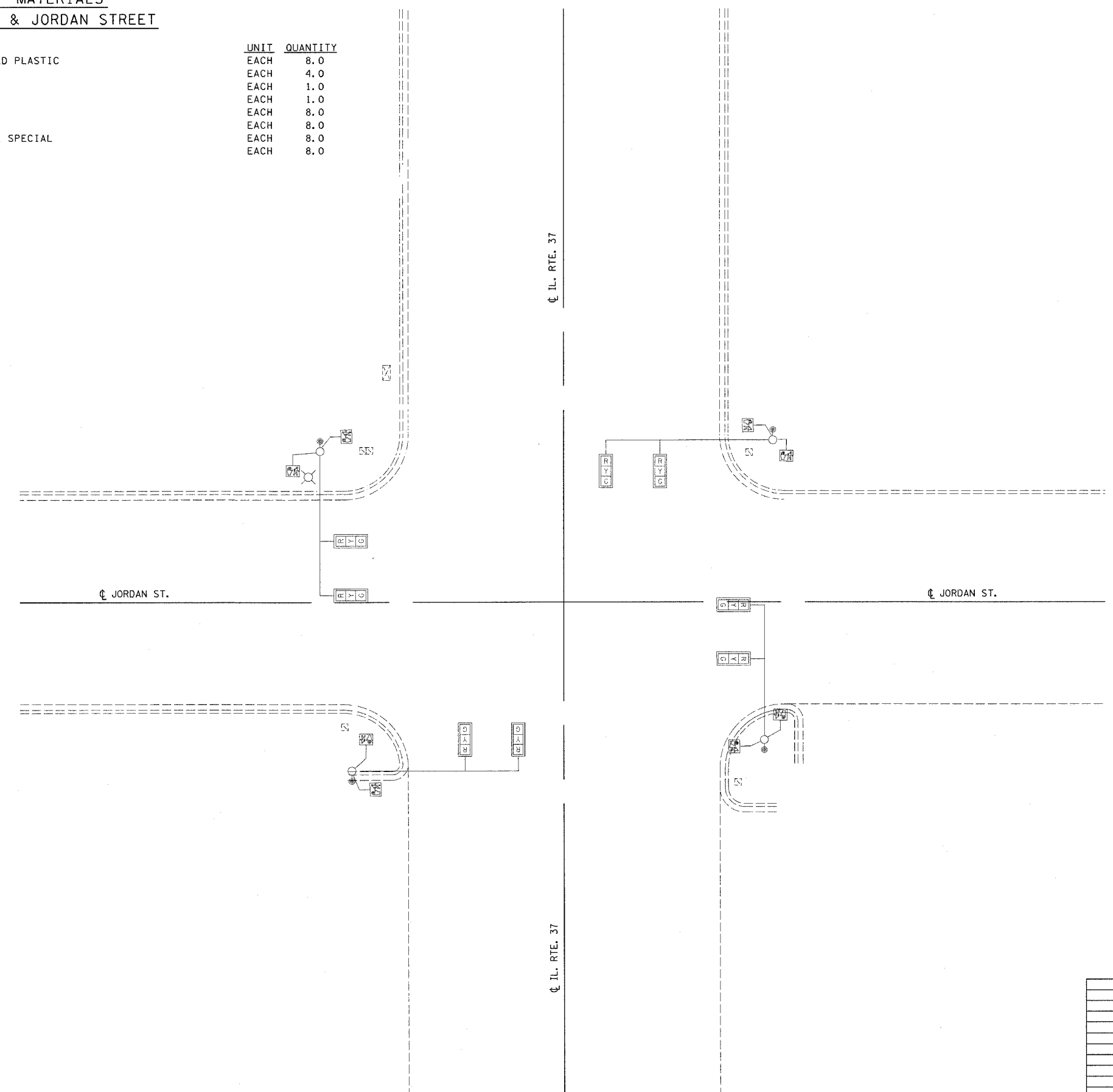
ITEM	UNIT	QUANTITY
TRAFFIC SIGNAL BACKPLATE, LOUVERED, FORMED PLASTIC	EACH	8.0
PEDESTRIAN PUSH BUTTON	EACH	4.0
MODIFY EXISTING CONTROLLER CABINET	EACH	1.0
REMOVE EXISTING TRAFFIC SIGNAL EQUIPMENT	EACH	1.0
LED SIGNAL FACE RETROFIT, RED BALL	EACH	8.0
LED SIGNAL FACE RETROFIT, GREEN BALL	EACH	8.0
LED SIGNAL FACE RETROFIT, WALK/DON'T WALK SPECIAL	EACH	8.0
LED SIGNAL FACE RETROFIT, YELLOW BALL	EACH	8.0



LEGEND

-  - LED RETROFIT
-  - NEW SIGNAL HEAD
-  - LED RETROFIT

PLOT DATE = 01/02/06
 FILE NAME = #FILE#
 PLOT SCALE = #SCALE#
 USER NAME = district

REVISIONS	
NAME	DATE

ILLINOIS DEPARTMENT OF TRANSPORTATION

IL. RTE. 37
&
JORDAN STREET

SCALE: VERT. _____
HORIZ. _____
DATE _____

DRAWN BY _____
CHECKED BY _____