

F.A.P. RTE.	SECTION	COUNTY	TOTAL SHEETS	SHEET NO.
774	(107, 107Z) I-2	EFFINGHAM	12	1
FED. ROAD DIST. NO.		ILLINOIS FED. AID PROJECT		

CONTRACT NO. 74129

D-97-003-06

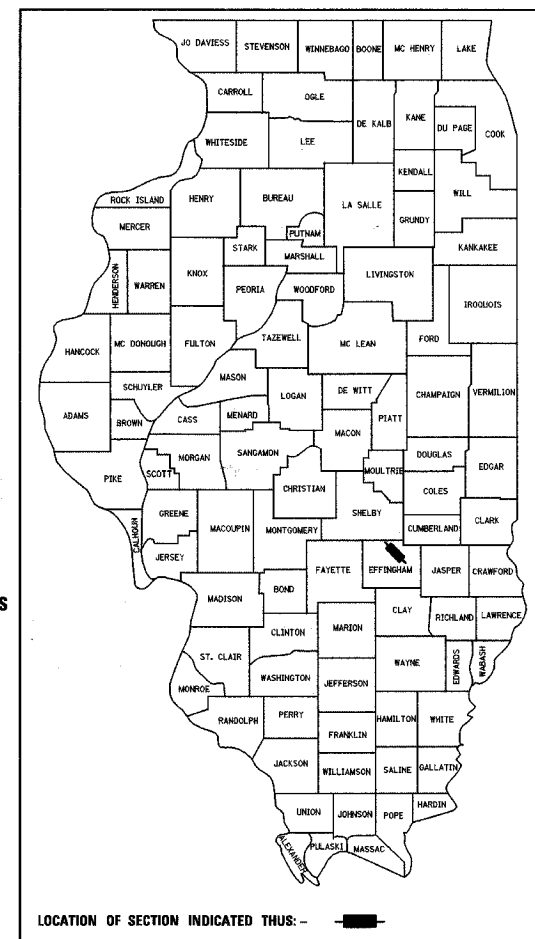

INDEX OF SHEETS

SHEET NO.	ITEM
1	COVER SHEET
2	GENERAL NOTES & HIGHWAY STANDARDS
3	SUMMARY OF QUANTITIES
4	SCHEDULE OF QUANTITIES
5	HORIZONTAL ALIGNMENT PLAN
6-10	PAVEMENT MARKING PLAN
11-12	TYPICAL APPLICATION OF PAVEMENT MARKINGS

STATE OF ILLINOIS
DEPARTMENT OF TRANSPORTATION
DIVISION OF HIGHWAYS

PLANS FOR PROPOSED FEDERAL HIGHWAY PROJECT

F.A.P. ROUTE 774 (ILLINOIS ROUTE 32/33)
SECTION (107, 107Z) I-2
PROJECT: F-0774-(025)
EFFINGHAM COUNTY
C-97-005-06

FOR SUMMARY OF QUANTITIES, SEE SHEET NO 3

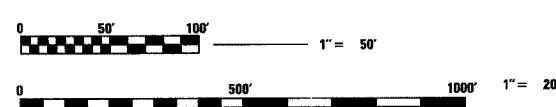
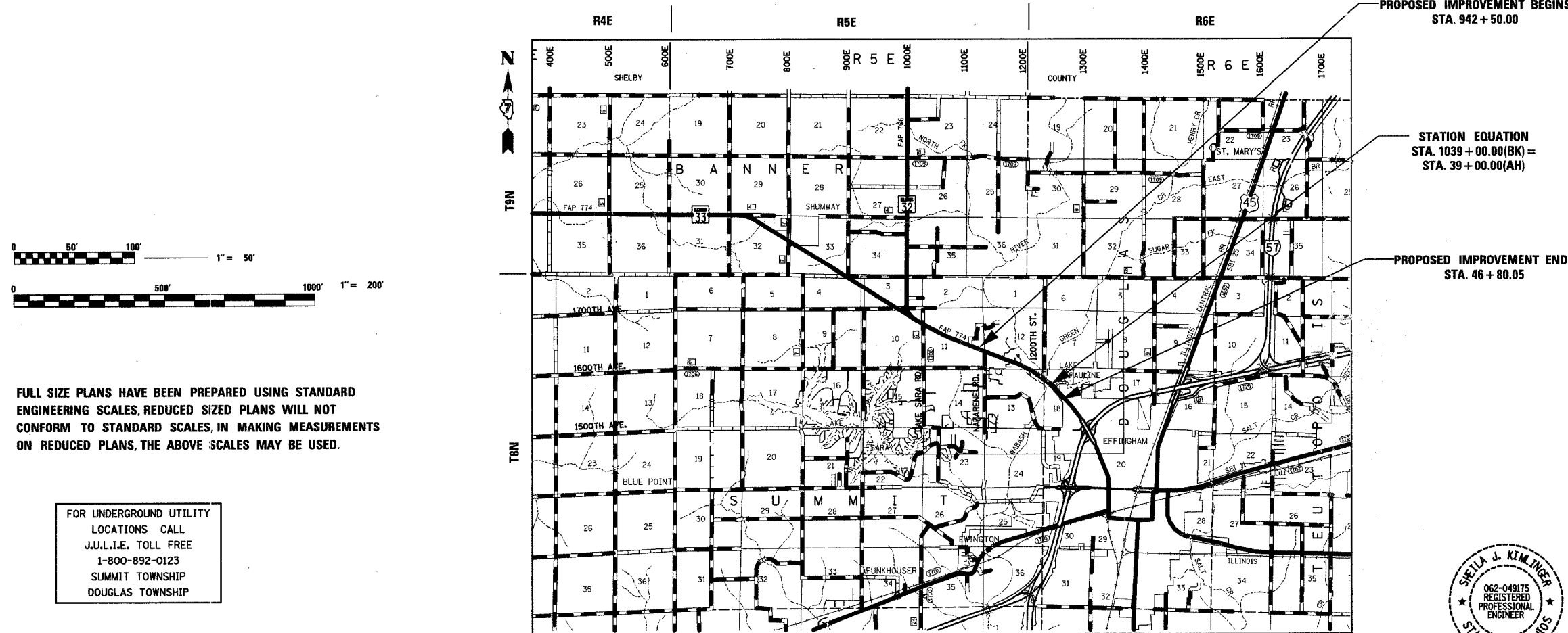

FULL SIZE PLANS HAVE BEEN PREPARED USING STANDARD ENGINEERING SCALES, REDUCED SIZED PLANS WILL NOT CONFORM TO STANDARD SCALES, IN MAKING MEASUREMENTS ON REDUCED PLANS, THE ABOVE SCALES MAY BE USED.

FOR UNDERGROUND UTILITY LOCATIONS CALL J.U.L.I.E. TOLL FREE 1-800-892-0123 SUMMIT TOWNSHIP DOUGLAS TOWNSHIP

CONTRACT NO. 74129
SUMMIT TOWNSHIP
DOUGLAS TOWNSHIP

LOCATION MAP
GROSS AND NET LENGTH OF PROJECT = 10,430 FT. = 1.98 MILES



Sheila J. Kim-Inger
SHEILA J. KIM-INGER, P.E.
DATE: 2-8-2006
EXPIRES: 11/30/2007

STATE OF ILLINOIS
DEPARTMENT OF TRANSPORTATION
DIVISION OF HIGHWAYS

SUBMITTED 3-31-2006
Christina M. Reed
DEPUTY DIRECTOR OF HIGHWAYS, REGION ENGINEER

20

ENGINEER OF PROJECT DEVELOPMENT AND IMPLEMENTATION
May 12, 2006
Mike Hine
ENGINEER OF DESIGN AND ENVIRONMENT

May 12, 2006
Milton R. Seas, P.E.
DIRECTOR, DIVISION OF HIGHWAYS

FHWA 20
DIVISION ADMINISTRATOR

PRINTED BY AUTHORITY
OF THE STATE OF ILLINOIS

PROJECT ENGINEER: BILL STANLEY
SQUAD LEADER:
TELEPHONE: 217-342-8320

F.A.P. RTE.	SECTION	COUNTY	TOTAL SHEETS	SHEET NO.
774	(107, 107Z) 1-2	EFFINGHAM	12	2
FED. ROAD DIST. NO. 7		ILLINOIS	FED. AID PROJECT	

CONTRACT NO. 74129

GENERAL NOTES

- THIS SECTION SHALL BE CONSTRUCTED IN ACCORDANCE WITH THE PLANS, THE "STANDARD SPECIFICATIONS FOR ROAD AND BRIDGE CONSTRUCTION", ADOPTED JANUARY 1, 2002; THE "SUPPLEMENTAL SPECIFICATIONS AND RECURRING SPECIAL PROVISIONS" INDICATED ON THE CHECK SHEET, AND "THE SPECIAL PROVISIONS" INCLUDED IN THE PROPOSAL.
- THE WORK INCLUDED IN THIS SECTION CONSISTS OF THE FINAL PAVEMENT MARKINGS ON APPROXIMATELY 1.98 MILES OF F.A.P. ROUTE 774 (IL RTE 32/33).
- THE PROPOSED PROJECT BEGINS 0.23 MILES WEST OF THE INTERSECTION OF IL ROUTE 32/33 AND NAZARENE RD AT STA. 942+50.00 AND EXTENDS IN AN EASTERLY DIRECTION TO A STATION EQUATION AT STA. 1039+00.00(BK) = STA. 39+00.00(AH), THEN CONTINUES TO STA. 46+80.05 EAST OF FORD AVE IN EFFINGHAM, IL, A TOTAL DISTANCE OF 1.98 MILES.
- RAISED REFLECTIVE PAVEMENT MARKERS SHALL BE PLACED IN ACCORDANCE WITH THE STANDARD SPECIFICATIONS, THE PLANS, AND AS DETERMINED BY THE ENGINEER. THE FINAL PAVEMENT MARKINGS SHALL BE PLACED PRIOR TO PLACING THE RAISED REFLECTIVE PAVEMENT MARKERS. ESTIMATED QUANTITIES:

CRYSTAL (MONODIRECTIONAL)	467 EACH
CRYSTAL (BIDIRECTIONAL)	0 EACH
AMBER (MONODIRECTIONAL)	449 EACH
AMBER (BIDIRECTIONAL)	36 EACH
TOTAL	952 EACH

- THIS PROJECT SHALL BE COORDINATED WITH CONSTRUCTION OF THE ROADWAY PROJECT IN THE SAME AREA. THE CONTRACTOR SHALL NOT START THIS PROJECT WITHOUT THE APPROVAL OF THE DISTRICT 7 PROJECT IMPLEMENTATION ENGINEER.

HIGHWAY STANDARDS

THE FOLLOWING STANDARDS ARE A PART OF THESE PLANS AND ARE INCLUDED AFTER SHEET NUMBER: 12

STANDARD NO.	DESCRIPTION
000001-04	STANDARD SYMBOLS, ABBREVIATION, AND PATTERNS
701426-02	LANE CLOSURE MULTILANE INTERMITTENT OR MOVING OPERATIONS FOR SPEEDS \geq 45 MPH
702001-00	TRAFFIC CONTROL DEVICES
780001-01	TYPICAL PAVEMENT MARKINGS
781001-02	TYPICAL APPLICATIONS RAISED REFLECTIVE PAVEMENT MARKERS

REVISIONS	
NAME	DATE
DRM	3/06

ILLINOIS DEPARTMENT OF TRANSPORTATION

GENERAL NOTES AND
HIGHWAY STANDARDS

DRAWN BY MLO
CHECKED BY SJK
DATE 5/05

F.A.P. RTE.	SECTION	COUNTY	TOTAL SHEETS	SHEET NO.
774	(107, 107Z) 1-2	EFFINGHAM	12	3
FED. ROAD DIST. NO. 7		ILLINOIS	FED. AID PROJECT	

CONTRACT NO. 74129

SUMMARY OF QUANTITIES				CONSTRUCTION TYPE CODE	
PAY CODE NUMBER	ITEM	UNIT	TOTAL QUANTITY	BY FED./BY STATE SFTY-ID	
				RURAL	URBAN
67100100	MOBILIZATION	L SUM	1	.7	.3
78005100	EPOXY PAVEMENT MARKING - LETTERS AND SYMBOLS	SQ FT	1,216.8	842.4	374.4
78005110	EPOXY PAVEMENT MARKING - LINE 4"	FOOT	49,074	36,124	12,950
78005130	EPOXY PAVEMENT MARKING - LINE 6"	FOOT	6,232	4,620	1,612
78005150	EPOXY PAVEMENT MARKING - LINE 12"	FOOT	1,650	1,555	95
78005180	EPOXY PAVEMENT MARKING - LINE 24"	FOOT	182	30	152
* 78100100	RAISED REFLECTIVE PAVEMENT MARKER	EACH	902	629	273
* 78100105	RAISED REFLECTIVE PAVEMENT MARKER (BRIDGE)	EACH	50	26	24
78300500	PAINT PAVEMENT MARKING REMOVAL	SQ FT	21,111	15,483	5,628

* SPECIALTY ITEMS

NOTE:

RURAL STA. 942+50.00 TO STA. 1016+00.00
 URBAN STA. 1016+00.00 TO STA. 46+80.05

* DENOTES SPECIALTY ITEM

REVISIONS		ILLINOIS DEPARTMENT OF TRANSPORTATION
NAME	DATE	
DRM	3/06	SUMMARY OF QUANTITIES DRAWN BY MLO CHECKED BY SJK DATE 5/05

RURAL

URBAN

F.A.P. RTE.	SECTION	COUNTY	TOTAL SHEETS	SHEET NO.
774	(107,107Z) I-2	EFFINGHAM	12	4
FED. ROAD DIST. NO. 7 ILLINOIS FED. AID PROJECT				

CONTRACT NO. 74129

LOCATION	EPOXY PAVEMENT MARKING						RAISED REFLECTIVE PAVEMENT MARKERS			
	LETTERS AND SYMBOLS	YELLOW 4"	WHITE 4"	WHITE 6"	YELLOW 12"	WHITE 12"	WHITE 24"	ONE WAY CRYSTAL EACH	ONE WAY AMBER EACH	TWO WAY AMBER EACH
STATION TO STATION	SQ. FT.	LIN. FT.	LIN. FT.	LIN. FT.	LIN. FT.	LIN. FT.	LIN. FT.	EACH	EACH	EACH
Q 942+50 TO Q 955+69		4988			489			16	62	
RT 942+50 TO RT 955+69			2190	92		352				
LT 942+50 TO LT 955+69			2269	92		352				
Q 955+69 TO Q 970+00		3699						77	51	16
RT 955+69 TO RT 970+00			1286	340						
LT 955+69 TO LT 970+00			1566	620						
Q 955+87	15.6 (TURN ARROW)									
Q 956+54	15.6 (TURN ARROW)									
Q 957+19	15.6 (TURN ARROW)									
Q 957+84	15.6 (TURN ARROW)									
Q 958+49	15.6 (TURN ARROW)									
Q 962+99	31.2 (2WLT)									
Q 965+99	31.2 (2WLT)									
Q 968+75	31.2 (2WLT)									
Q 970+00 TO Q 975+00		1064						24	22	
RT 970+00 TO RT 975+00			462	116						
LT 970+00 TO LT 975+00			462	116						
Q 970+40	31.2 (2WLT)									
Q 972+22	31.2 (2WLT)									
Q 974+03	31.2 (2WLT)									
Q 975+00 TO Q 977+84		455						12	10	
RT 975+00 TO RT 977+84			237	62						
LT 975+00 TO LT 977+84			238	62						
Q 975+58	31.2 (2WLT)									
Q 976+77	31.2 (2WLT)									
Q 977+84 TO Q 982+52		990						22	20	
RT 977+84 TO RT 982+52			427	108						
LT 977+84 TO LT 982+52			426	108						
Q 978+23	31.2 (2WLT)									
Q 979+90	31.2 (2WLT)									
Q 981+58	31.2 (2WLT)									
Q 982+52 TO Q 991+74		2244						43	40	
RT 982+52 TO RT 991+74			848	492						
LT 982+52 TO LT 991+74			848	492						
Q 983+36	15.6 (TURN ARROW)									
Q 984+01	15.6 (TURN ARROW)									
Q 984+67	15.6 (TURN ARROW)									
Q 985+32	15.6 (TURN ARROW)									
Q 988+19	15.6 (TURN ARROW)									
Q 988+85	15.6 (TURN ARROW)									
Q 989+50	15.6 (TURN ARROW)									
Q 990+16	15.6 (TURN ARROW)									
Q 990+78	15.6 (TURN ARROW)									
Q 991+74 TO Q 1015+30		5750			240			116	114	
RT 991+74 TO RT 1015+30			2356	869						
LT 991+74 TO LT 1015+30			2356	869						
Q 991+92	15.6 (TURN ARROW)									
Q 992+57	15.6 (TURN ARROW)									
Q 993+23	15.6 (TURN ARROW)									
Q 993+88	15.6 (TURN ARROW)									
Q 994+54	15.6 (TURN ARROW)									
Q 998+13	31.2 (2WLT)									
Q 1001+13	31.2 (2WLT)									
Q 1004+13	31.2 (2WLT)									
Q 1007+13	31.2 (2WLT)									
Q 1011+98	15.6 (TURN ARROW)									
Q 1012+53	15.6 (TURN ARROW)									
Q 1013+19	15.6 (TURN ARROW)									
Q 1013+84	15.6 (TURN ARROW)									
Q 1014+50	15.6 (TURN ARROW)									
Q 1015+30 TO Q 1016+00		151			45			4	4	
RT 1015+30 TO RT 1016+00			70	20						
LT 1015+30 TO LT 1016+00			70	20						
NAZARENE ROAD										
Q 82+36 TO Q 84+56		400								2
RT 82+36 TO RT 84+56			136	142		77	30			
LT 82+36 TO LT 84+56			136							
RURAL TOTALS	842.4	19,741	16,383	4,620	774	781	30	314	323	18

LOCATION	EPOXY PAVEMENT MARKING						RAISED REFLECTIVE PAVEMENT MARKERS			
	LETTERS AND SYMBOLS	YELLOW 4"	WHITE 4"	WHITE 6"	YELLOW 12"	WHITE 12"	WHITE 24"	ONE WAY CRYSTAL EACH	ONE WAY AMBER EACH	TWO WAY AMBER EACH
STATION TO STATION	SQ. FT.	LIN. FT.	LIN. FT.	LIN. FT.	LIN. FT.	LIN. FT.	LIN. FT.	EACH	EACH	EACH
Q 1016+00 TO Q 1024+19		1851						38	36	
RT 1016+00 TO RT 1024+19			771	194						
LT 1016+00 TO LT 1024+19			771	195						
Q 1016+50	31.2 (2WLT)									
Q 1020+73	31.2 (2WLT)									
Q 1023+19	31.2 (2WLT)									
Q 1024+19 TO Q 42+93		4624			95		42	91	80	10
RT 1024+19 TO RT 42+93			1720	595						
LT 1024+19 TO LT 42+93			1555	430						
Q 1024+54	31.2 (2WLT)									
Q 1027+54	31.2 (2WLT)									
Q 1030+54	31.2 (2WLT)									
Q 1033+54	31.2 (2WLT)									
Q 1036+92	31.2 (2WLT)									
Q 1038+09	31.2 (2WLT)									
Q 40+09	15.6 (TURN ARROW)									
Q 40+84	15.6 (TURN ARROW)									
Q 41+56	15.6 (TURN ARROW)									
Q 42+93 TO Q 46+80		1317					50	24	10	8
RT 42+93 TO RT 46+80			97							
LT 42+93 TO LT 46+80			244							
Q 43+11	15.6 (TURN ARROW)									
Q 43+77	15.6 (TURN ARROW)									
Q 44+40	15.6 (TURN ARROW)									
FORD AVENUE										
RT 184+43							30			
RT 185+48 TO LT 185+48			198							
LT 185+55							30			
URBAN TOTALS	374.4	7,792	5,158	1,612	95	0	152	153	126	18
TOTALS	1,216.8	27,533	21,541	6,232	869	781	182	467	449	36
GRAND TOTALS	1,216.8	49,074	6,232	1,650	182		952			

O:\Programs\Projects\74129\CADD FILES ADJUSTED BY D:\Pav_Markingsched.dgn
 mack\indr\...-DATE

REVISIONS	
NAME	DATE
DRM	3/06

ILLINOIS DEPARTMENT OF TRANSPORTATION
 PAVEMENT MARKING SCHEDULE
 DRAWN BY NJV
 CHECKED BY RMD
 DATE 3/03

F.A.P. RTE.	SECTION	COUNTY	TOTAL SHEETS	SHEET NO.
774	(107, 107Z) I-2	EFFINGHAM	12	5
FED. ROAD DIST. NO.		ILLINOIS	FED. AID PROJECT	

CONTRACT NO. 74129

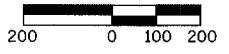
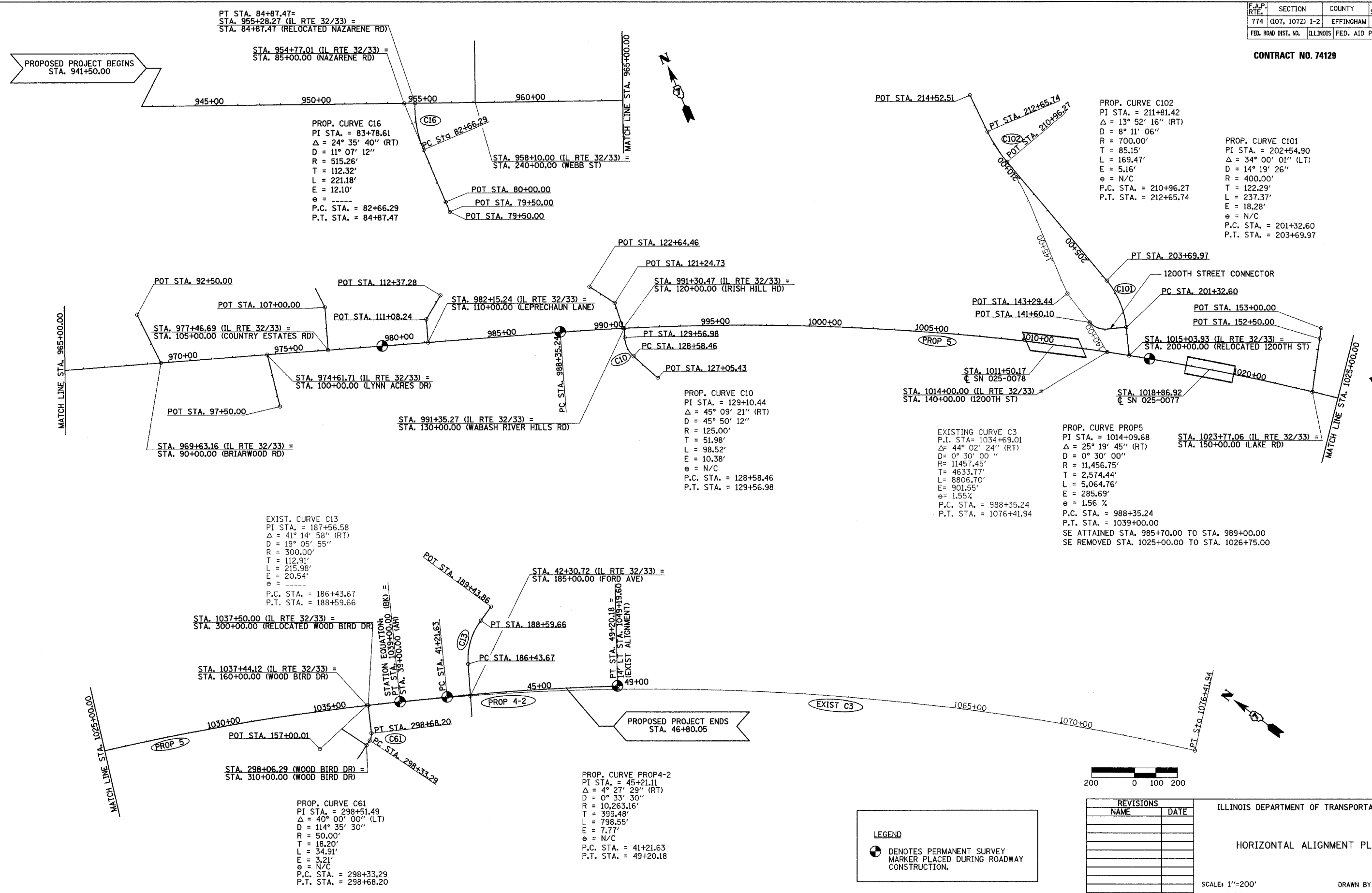

LEGEND
 ● DENOTES PERMANENT SURVEY MARKER PLACED DURING ROADWAY CONSTRUCTION.

REVISIONS	
NAME	DATE

ILLINOIS DEPARTMENT OF TRANSPORTATION
 HORIZONTAL ALIGNMENT PLAN
 SCALE: 1"=200'
 DATE 4/22/02
 DRAWN BY MLO
 CHECKED BY BKB

F.A.P. RTE.	SECTION	COUNTY	TOTAL SHEETS	SHEET NO.
774	(107, 107Z) I-2	EFFINGHAM	12	6
FED. ROAD DIST. NO.	ILLINOIS	FED. AID PROJECT		

CONTRACT NO. 74129

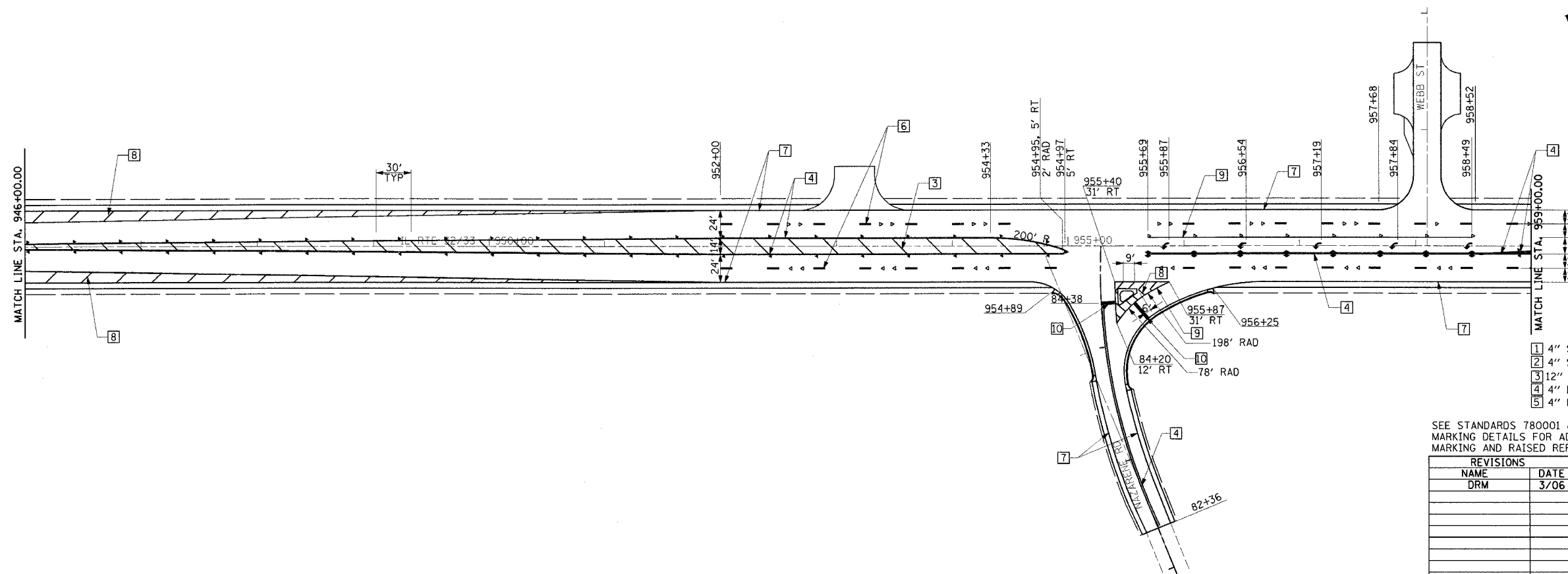
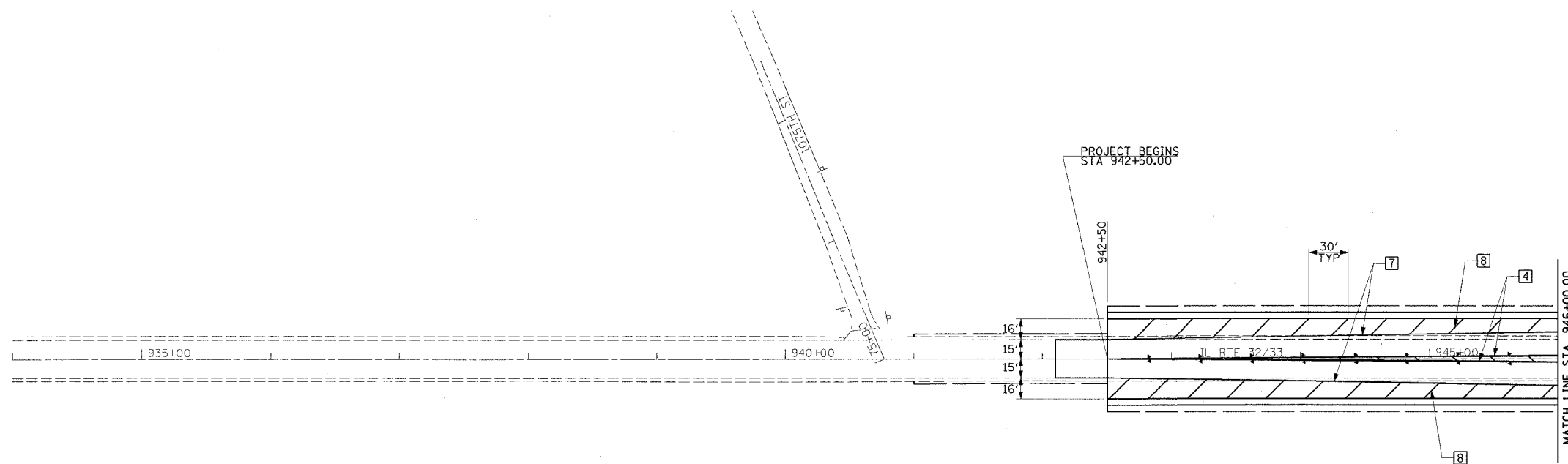
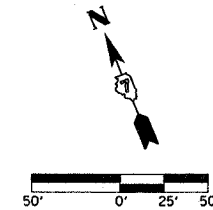

LEGEND

- RAISED REFL PAVT MKR AMBER BIDIRECTIONAL
- RAISED REFL PAVT MKR AMBER MONODIRECTIONAL
- RAISED REFL PAVT MKR CRYSTAL MONODIRECTIONAL
- ITEM 4 DOUBLE YELLOW (NARROW)
- ITEM 5 DOUBLE YELLOW (WIDE)

TYPICAL PAVEMENT MARKING LEGEND

- 1 4" SKIP-DASH YELLOW
- 2 4" SOLID YELLOW
- 3 12" DIAGONAL YELLOW
- 4 4" DOUBLE YELLOW NARROW
- 5 4" DOUBLE YELLOW WIDE
- 6 6" SKIP-DASH WHITE
- 7 4" SOLID WHITE
- 8 12" DIAGONAL WHITE
- 9 6" SOLID WHITE
- 10 24" STOP BAR WHITE

SEE STANDARDS 780001 & 781001 AND DISTRICT PAVEMENT MARKING DETAILS FOR ADDITIONAL DETAILS FOR PAVEMENT MARKING AND RAISED REFLECTIVE PAVEMENT MARKERS.

REVISIONS	
NAME	DATE
DRM	3/06

ILLINOIS DEPARTMENT OF TRANSPORTATION

PAVEMENT MARKING PLAN
SHEET 1 OF 5

DATE 8/02
DRAWN BY ASB
CHECKED BY SJK

F.A.P. RTE.	SECTION	COUNTY	TOTAL SHEETS	SHEET NO.
774	(107, 107Z) I-2	EFFINGHAM	12	7
FED. ROAD DIST. NO.	ILLINOIS	FED. AID PROJECT		

CONTRACT NO. 74129

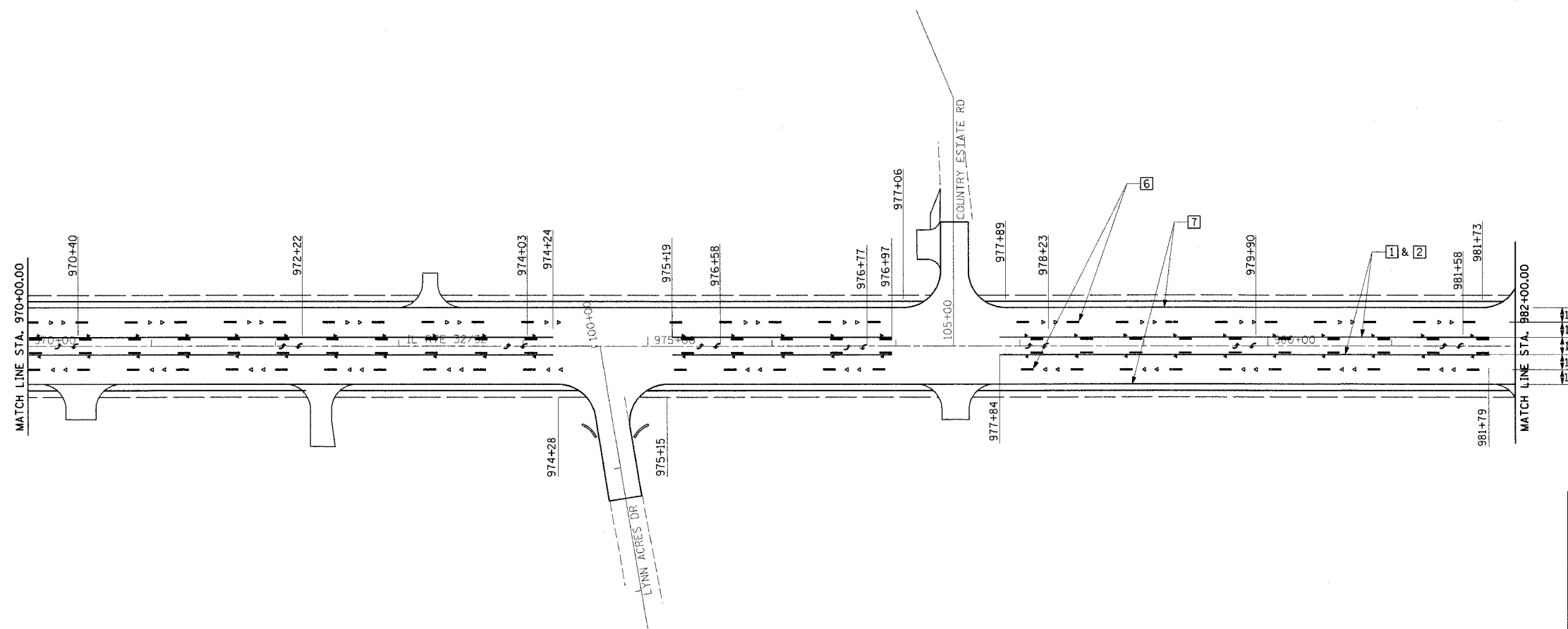
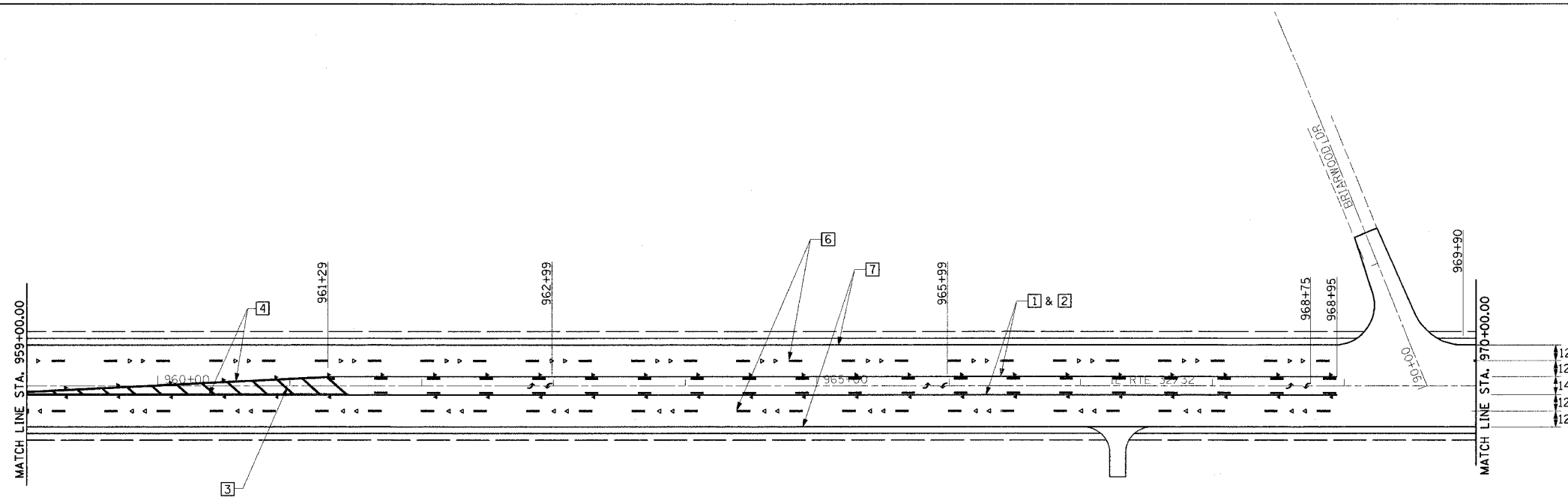
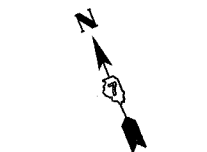

LEGEND

- RAISED REFL PAVT MKR AMBER BIDIRECTIONAL
- RAISED REFL PAVT MKR AMBER MONODIRECTIONAL
- RAISED REFL PAVT MKR CRYSTAL MONODIRECTIONAL

- ITEM [4] DOUBLE YELLOW (NARROW)
- ITEM [5] DOUBLE YELLOW (WIDE)

TYPICAL PAVEMENT MARKING LEGEND

- [1] 4" SKIP-DASH YELLOW
- [2] 4" SOLID YELLOW
- [3] 12" DIAGONAL YELLOW
- [4] 4" DOUBLE YELLOW NARROW
- [5] 4" DOUBLE YELLOW WIDE
- [6] 6" SKIP-DASH WHITE
- [7] 4" SOLID WHITE
- [8] 12" DIAGONAL WHITE
- [9] 6" SOLID WHITE
- [10] 24" STOP BAR WHITE

SEE STANDARDS 780001 & 781001 AND DISTRICT PAVEMENT MARKING DETAILS FOR ADDITIONAL DETAILS FOR PAVEMENT MARKING AND RAISED REFLECTIVE PAVEMENT MARKERS.

REVISIONS	
NAME	DATE
DRM	3/06

ILLINOIS DEPARTMENT OF TRANSPORTATION

PAVEMENT MARKING PLAN
SHEET 2 OF 5

DATE 8/02

DRAWN BY ASB
CHECKED BY SJM

F.A.P. RTE.	SECTION	COUNTY	TOTAL SHEETS	SHEET NO.
774	(107, 107Z) I-2	EFFINGHAM	12	8
FED. ROAD DIST. NO.		ILLINOIS	FED. AID PROJECT	

CONTRACT NO. 74129

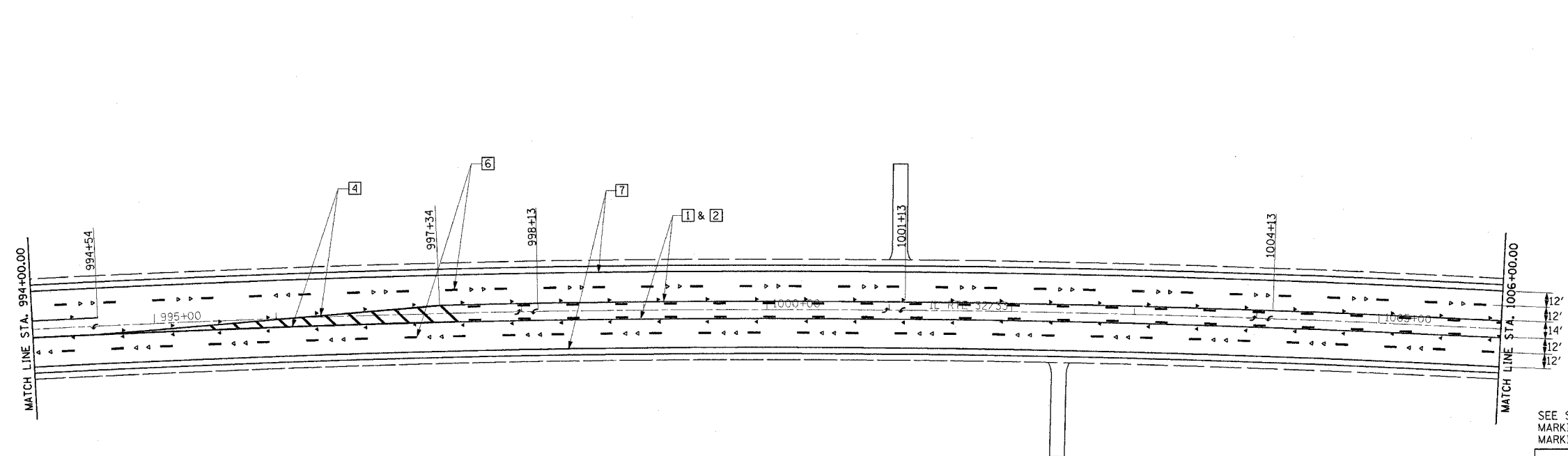
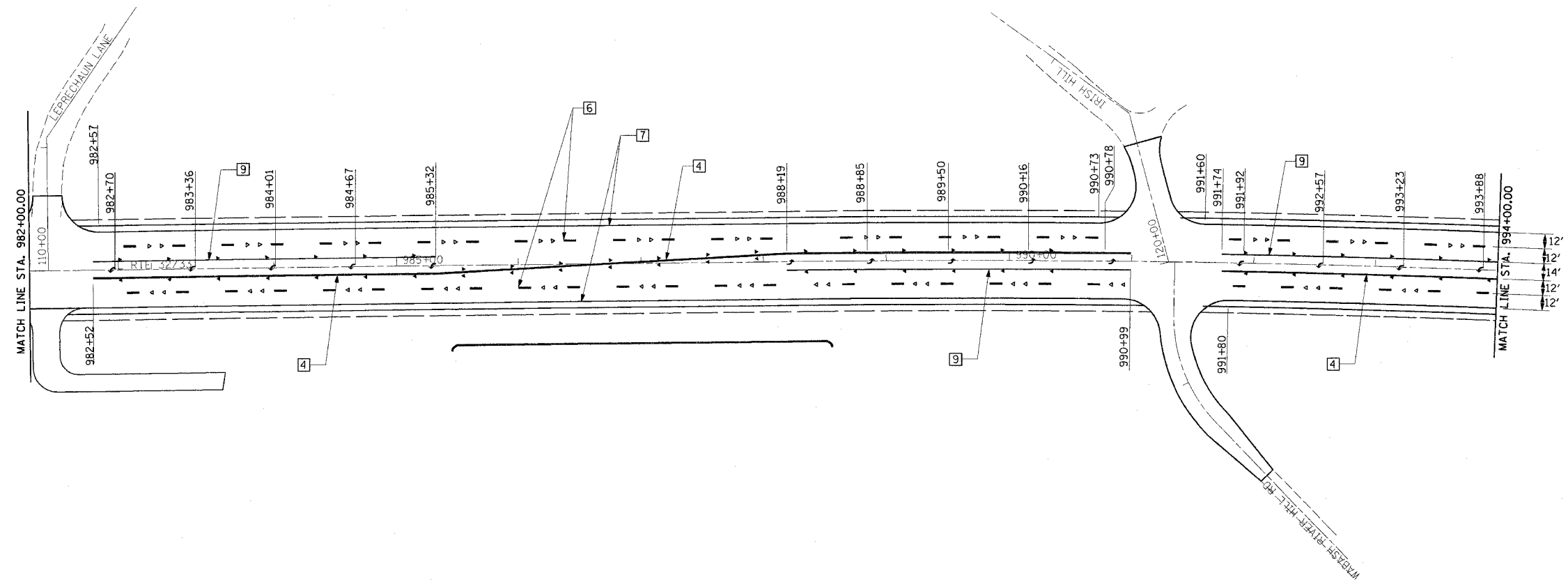
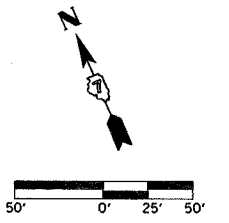

LEGEND

- RAISED REFL PAVT MKR AMBER BIDIRECTIONAL
- RAISED REFL PAVT MKR AMBER MONODIRECTIONAL
- RAISED REFL PAVT MKR CRYSTAL MONODIRECTIONAL
- ITEM 4 DOUBLE YELLOW (NARROW)
- ITEM 5 DOUBLE YELLOW (WIDE)

TYPICAL PAVEMENT MARKING LEGEND

- 1 4" SKIP-DASH YELLOW
- 2 4" SOLID YELLOW
- 3 12" DIAGONAL YELLOW
- 4 4" DOUBLE YELLOW NARROW
- 5 4" DOUBLE YELLOW WIDE
- 6 6" SKIP-DASH WHITE
- 7 4" SOLID WHITE
- 8 12" DIAGONAL WHITE
- 9 6" SOLID WHITE
- 10 24" STOP BAR WHITE

SEE STANDARDS 780001 & 781001 AND DISTRICT PAVEMENT MARKING DETAILS FOR ADDITIONAL DETAILS FOR PAVEMENT MARKING AND RAISED REFLECTIVE PAVEMENT MARKERS.

REVISIONS	
NAME	DATE
DRM	3/06

ILLINOIS DEPARTMENT OF TRANSPORTATION

PAVEMENT MARKING PLAN
SHEET 3 OF 5

DATE 8/02
DRAWN BY ASB
CHECKED BY SJK

F.A.P. RTE.	SECTION	COUNTY	TOTAL SHEETS	SHEET NO.
774	(107, 107Z) I-2	EFFINGHAM	12	9
FED. ROAD DIST. NO.	ILLINOIS	FED. AID PROJECT		

CONTRACT NO. 74129

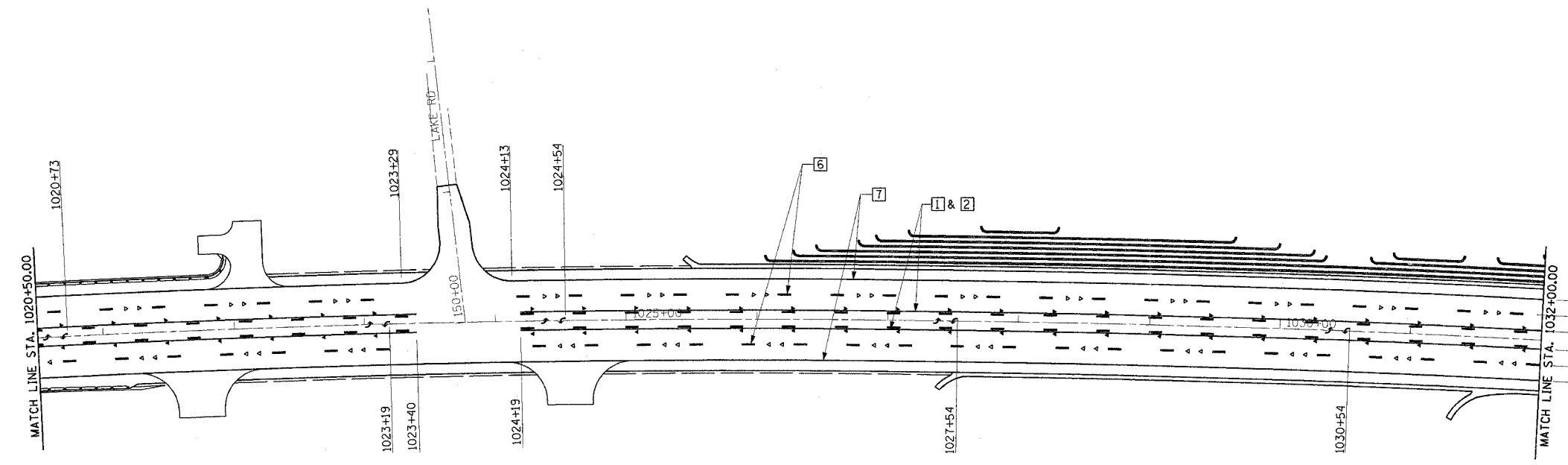
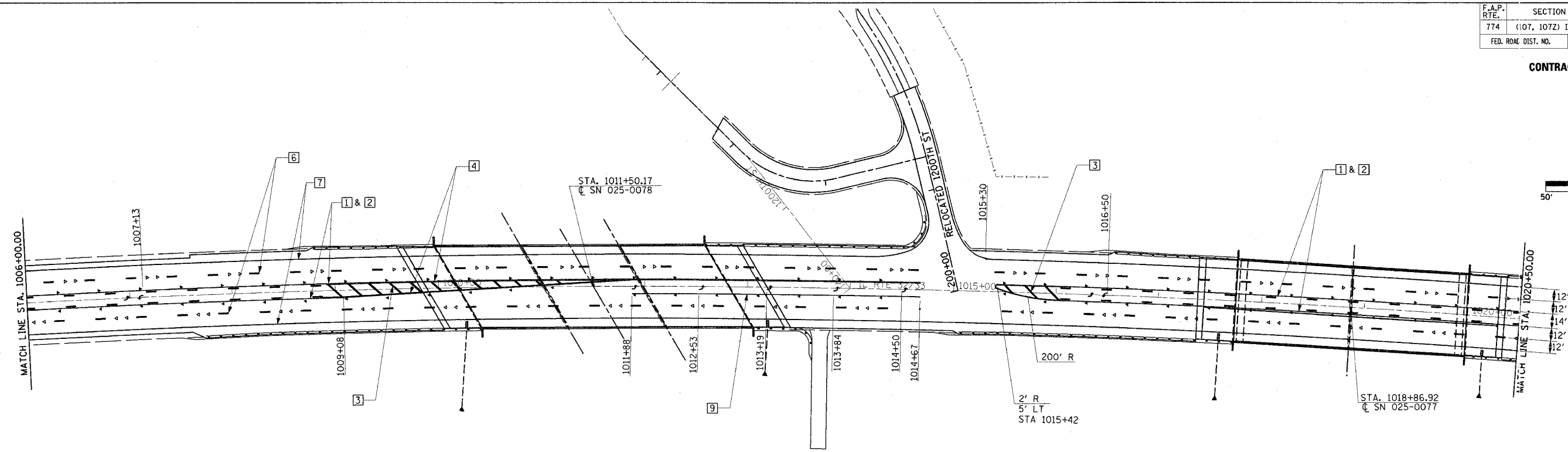
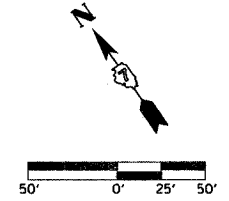

- LEGEND**
- RAISED REFL PAVT MKR AMBER BIDIRECTIONAL
 - RAISED REFL PAVT MKR AMBER MONODIRECTIONAL
 - RAISED REFL PAVT MKR CRYSTAL MONODIRECTIONAL
 - ITEM 4 DOUBLE YELLOW (NARROW)
 - ITEM 5 DOUBLE YELLOW (WIDE)

- TYPICAL PAVEMENT MARKING LEGEND**
- | | |
|---------------------------|-----------------------|
| 1 4" SKIP-DASH YELLOW | 6 6" SKIP-DASH WHITE |
| 2 4" SOLID YELLOW | 7 4" SOLID WHITE |
| 3 12" DIAGONAL YELLOW | 8 12" DIAGONAL WHITE |
| 4 4" DOUBLE YELLOW NARROW | 9 6" SOLID WHITE |
| 5 4" DOUBLE YELLOW WIDE | 10 24" STOP BAR WHITE |

SEE STANDARDS 780001 & 781001 AND DISTRICT PAVEMENT MARKING DETAILS FOR ADDITIONAL DETAILS FOR PAVEMENT MARKING AND RAISED REFLECTIVE PAVEMENT MARKERS.

REVISIONS	
NAME	DATE
DRM	3/06

ILLINOIS DEPARTMENT OF TRANSPORTATION

PAVEMENT MARKING PLAN
SHEET 4 OF 5

DATE 8/02

DRAWN BY ASB
CHECKED BY SJK

F.A.P. RTE.	SECTION	COUNTY	TOTAL SHEETS	SHEET NO.
774	(107, 107Z) I-2	EFFINGHAM	12	10
FED. ROAD DIST. NO.	ILLINOIS	FED. AID PROJECT		

CONTRACT NO. 74129

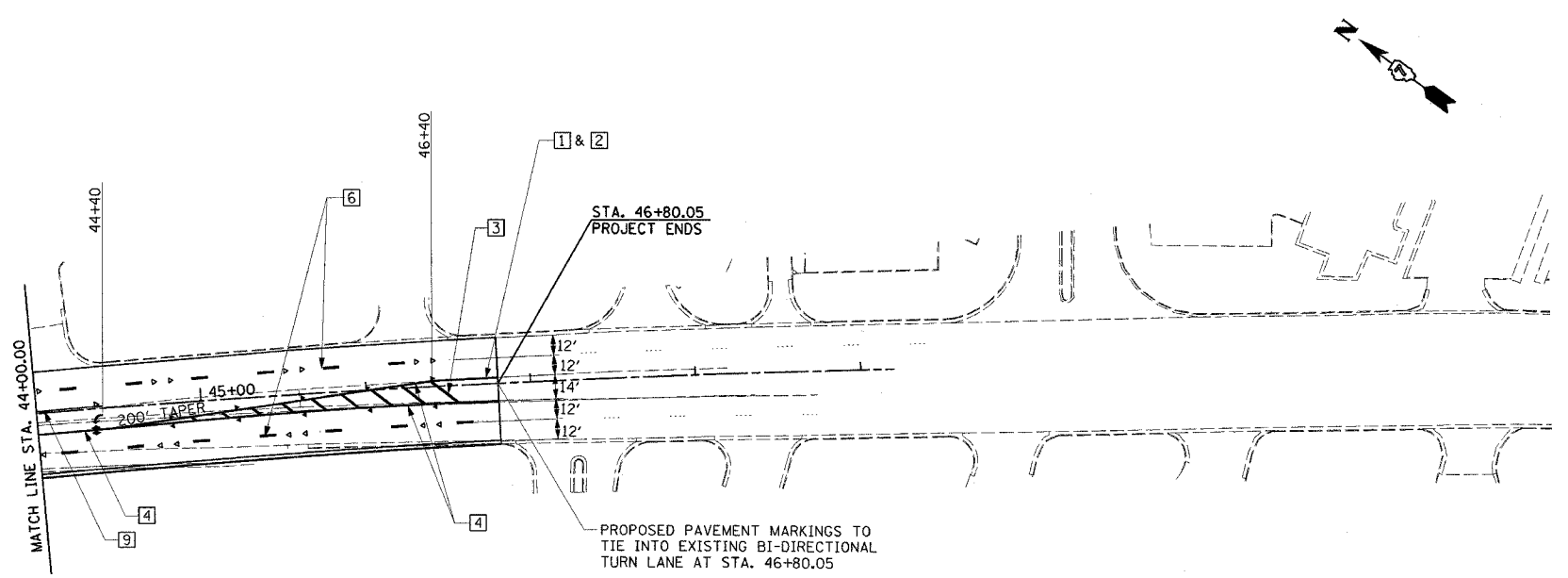
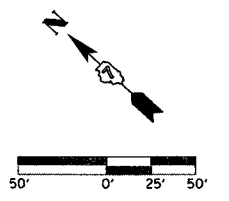
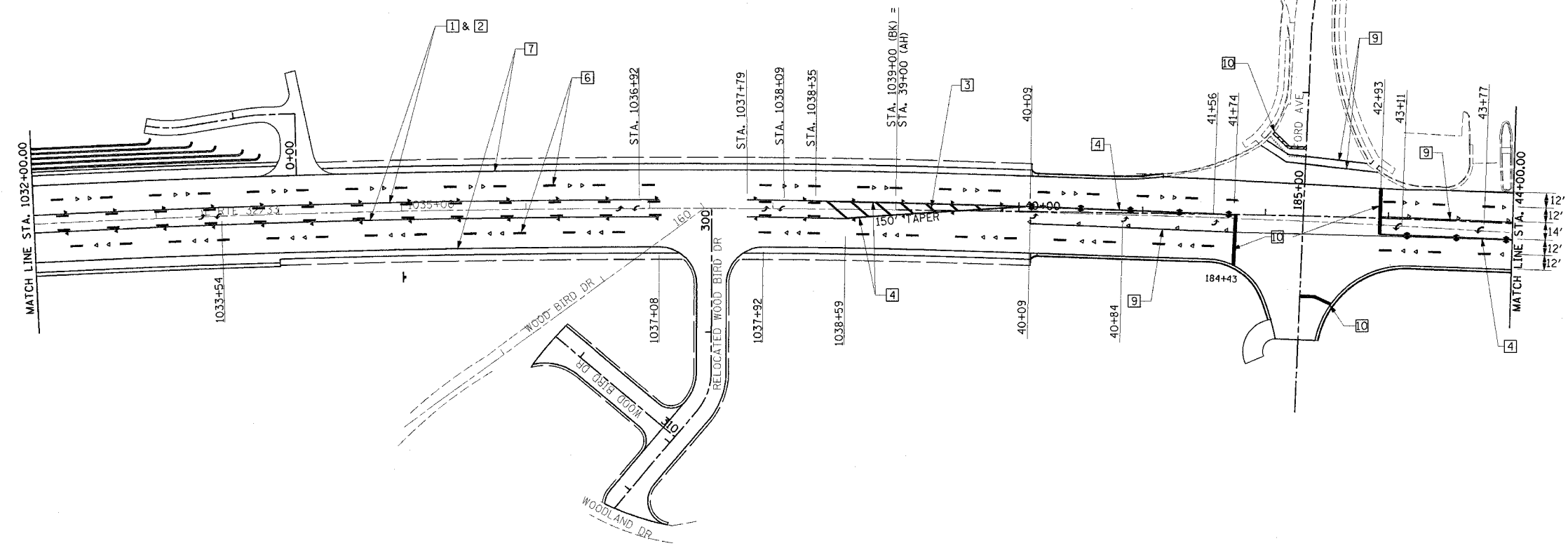

LEGEND

- RAISED REFL PAVT MKR AMBER BIDIRECTIONAL
- RAISED REFL PAVT MKR AMBER MONODIRECTIONAL
- RAISED REFL PAVT MKR CRYSTAL MONODIRECTIONAL
- ITEM 4 DOUBLE YELLOW (NARROW)
- ITEM 5 DOUBLE YELLOW (WIDE)

TYPICAL PAVEMENT MARKING LEGEND

- 1 4" SKIP-DASH YELLOW
- 2 4" SOLID YELLOW
- 3 12" DIAGONAL YELLOW
- 4 4" DOUBLE YELLOW NARROW
- 5 4" DOUBLE YELLOW WIDE
- 6 6" SKIP-DASH WHITE
- 7 4" SOLID WHITE
- 8 12" DIAGONAL WHITE
- 9 6" SOLID WHITE
- 10 24" STOP BAR WHITE

SEE STANDARDS 780001 & 781001 AND DISTRICT PAVEMENT MARKING DETAILS FOR ADDITIONAL DETAILS FOR PAVEMENT MARKING AND RAISED REFLECTIVE PAVEMENT MARKERS.

REVISIONS	
NAME	DATE
DRM	3/06

ILLINOIS DEPARTMENT OF TRANSPORTATION
PAVEMENT MARKING PLAN
SHEET 5 OF 5

DATE 8/02
DRAWN BY ASB
CHECKED BY SJK

1 2 3 4 5 6 7 8 9
 10 11 12 13 14 15 16 17 18 19 20 21 22 23 24 25 26 27
 28 29 30 31 32 33 34 35 36 37 38 39 40 41 42 43 44 45
 46 47 48 49 50 51 52 53 54
 55 56 57 58 59 60 61 62 63

\$\$\$DATE\$\$\$
 DGN-SPEC
 *MMO REV: 05-06-96

EPMD

RTL	SECTION	COUNTY	TOTAL SHEETS	SHEET NO.
774	(107, 107Z) I-2	EFFINGHAM	12	11
FED. ROAD DIST. NO. 7		ILLINOIS	FED. AID PROJECT NO.	

CONTRACT NO. 74129

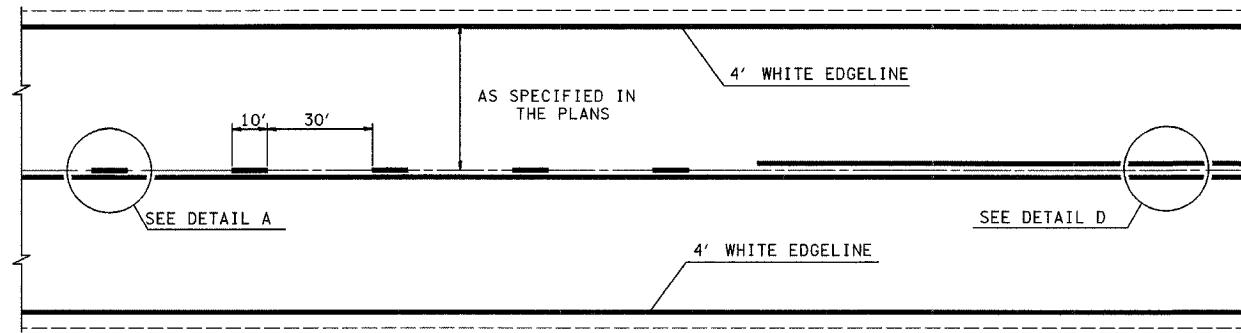

TYPICAL CENTERLINE, NO PASSING ZONE LINE (NPZ) & EDGELINE MARKINGS
 2-LANE PAVEMENT

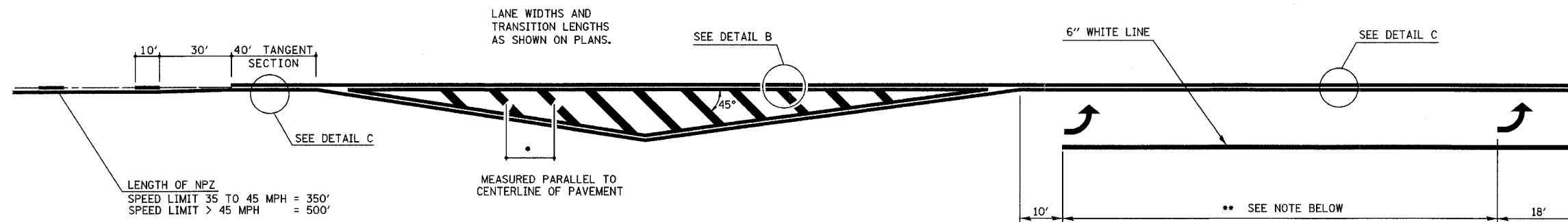

LENGTH OF NPZ
 SPEED LIMIT 35 TO 45 MPH = 350'
 SPEED LIMIT > 45 MPH = 500'

MEASURED PARALLEL TO CENTERLINE OF PAVEMENT

*DIAGONAL SPACING

SPEED LIMIT	< 30 MPH	= 15'
SPEED LIMIT	30 TO 45 MPH	= 20'
SPEED LIMIT	> 45 MPH	= 30'

** PLACE THE FIRST ARROW EVEN WITH THE BEGINNING OF THE TURN BAY.
 PLACE ANOTHER ARROW 18' BACK FROM THE STOP BAR, IF REQUIRED,
 ADD ADDITIONAL ARROWS TO MAINTAIN A MAXIMUM OF 80' SPACING.

NOTES:

1. OMIT EDGELINE THRU SIDE ROADS.
2. TAPER RATES, LANE WIDTHS, AND STORAGE LENGTHS AS SHOWN ON THE PLANS.
3. WHEN MEDIANS ARE PRESENT, PLACE A SINGLE YELLOW STRIPE AROUND ITS PERIMETER.

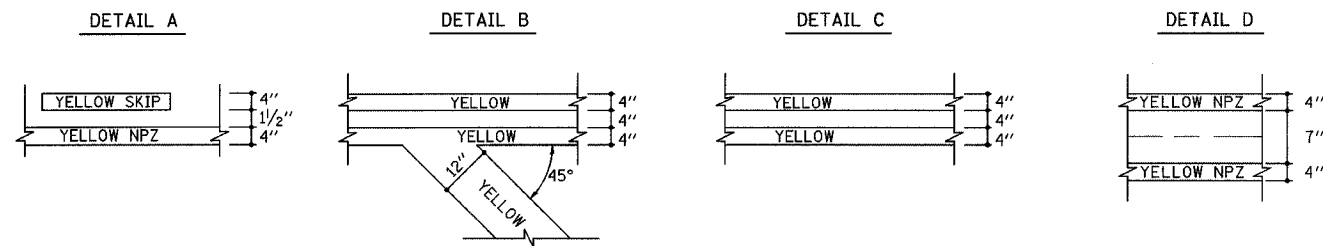

REVISIONS	
NAME	DATE
MMO	12-99
DRM	08-04

NOT TO SCALE

ILLINOIS DEPARTMENT OF TRANSPORTATION
TYPICAL APPLICATION OF PAVEMENT MARKINGS
SHEET 1 OF 2

SCALE: VERT. _____
 HORIZ. _____
 DATE _____ ISSUED: 05-06-96 DRAWN BY _____
 CHECKED BY _____

DGN-SPEC
 DATE

1 2 3 4 5 6 7 8 9
 10 11 12 13 14 15 16 17 18 19 20 21 22 23 24 25 26 27 28 29 30 31 32 33 34 35 36 37 38 39 40 41 42 43 44 45 46 47 48 49 50 51 52 53 54 55 56 57 58 59 60 61 62 63

\$\$\$DATE\$\$\$
 DGN-SPEC
 MMO REV: 05-06-96
EPMD 1

ATE.	SECTION	COUNTY	TOTAL SHEETS	SHEET NO.
774	(107, 107Z) 1-2	EFFINGHAM	12	12
FED. ROAD DIST. NO. 7		ILLINOIS	FED. AID PROJECT NO.	

CONTRACT NO. 74129

** PLACE THE FIRST ARROW EVEN WITH THE BEGINNING OF THE TURN BAY.
 PLACE ANOTHER ARROW 18' BACK FROM THE STOP BAR, IF REQUIRED.
 ADD ADDITIONAL ARROWS TO MAINTAIN A MAXIMUM OF 80' SPACING.

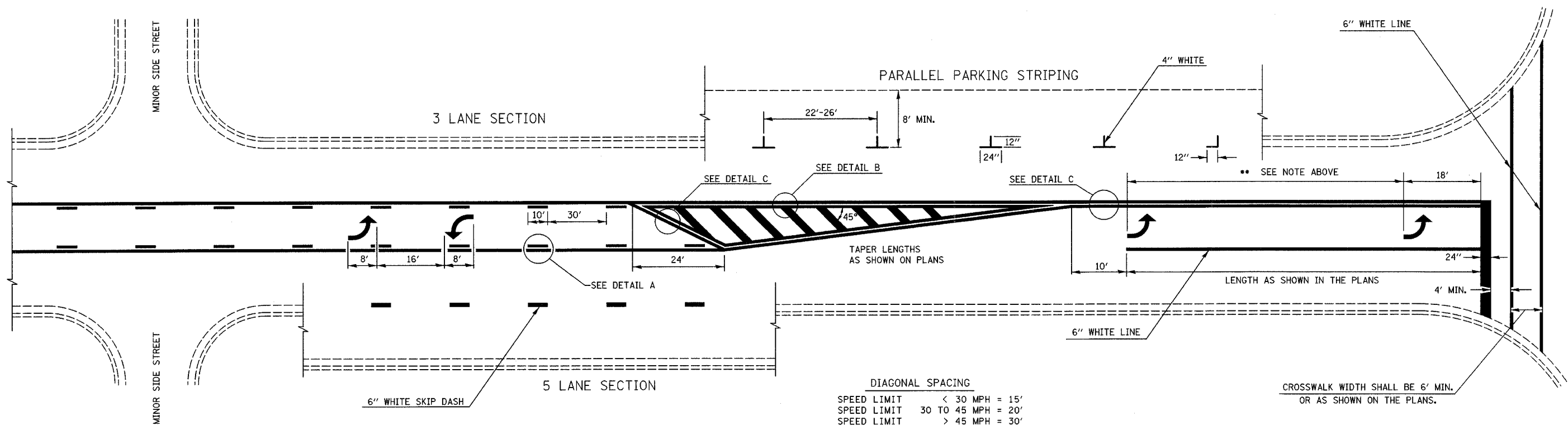

DIAGONAL SPACING

SPEED LIMIT	< 30 MPH	= 15'
SPEED LIMIT	30 TO 45 MPH	= 20'
SPEED LIMIT	> 45 MPH	= 30'

TYPICAL BI-DIRECTIONAL TURN LANE MARKINGS
 (SHOWING TRANSITION TO EXCLUSIVE LEFT TURN LANE)

- NOTES:
1. NO LESS THAN 2 ARROWS SHALL BE USED.
 2. TAPER RATES, LANE WIDTHS, AND STORAGE LENGTHS AS SHOWN ON THE PLANS.
 3. AVOID PLACING BI-DIRECTIONAL ARROWS IN INTERSECTIONS.
 4. BI-DIRECTIONAL ARROWS SHALL BE SPACED A MAXIMUM OF 250'.

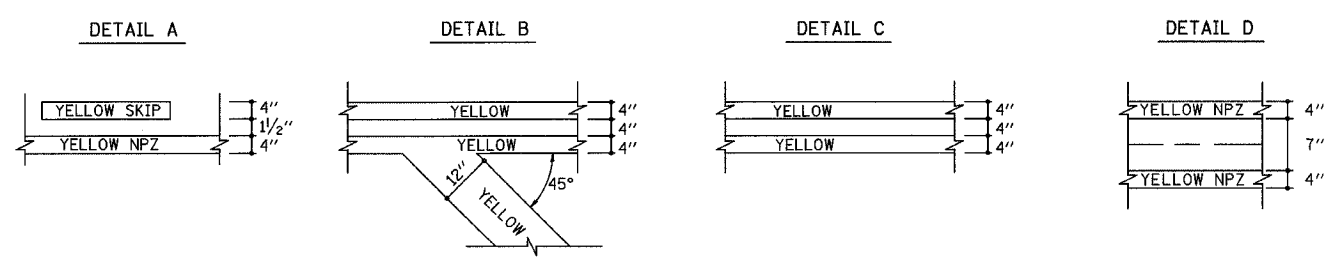

REVISIONS	
NAME	DATE
MMO	12-99
DRM	08-04

NOT TO SCALE

ILLINOIS DEPARTMENT OF TRANSPORTATION

TYPICAL APPLICATION OF PAVEMENT MARKINGS

SHEET 2 OF 2

SCALE: VERT. _____
 HORIZ. _____

DATE _____ DRAWN BY _____
 CHECKED BY _____

DGN-SPEC
 DATE