

F.A.P. RTE.	SECTION	COUNTY	TOTAL SHEETS	SHEET NO.
774	107 WRS-2, L	EFFINGHAM	127	30
FED. ROAD DIST. NO.	ILLINOIS	FED. AID PROJECT		

CONTRACT NO. 74130

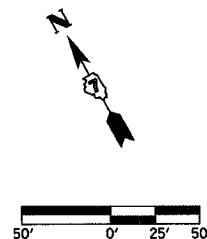

TYPICAL SECTION 13  
SHEET 15

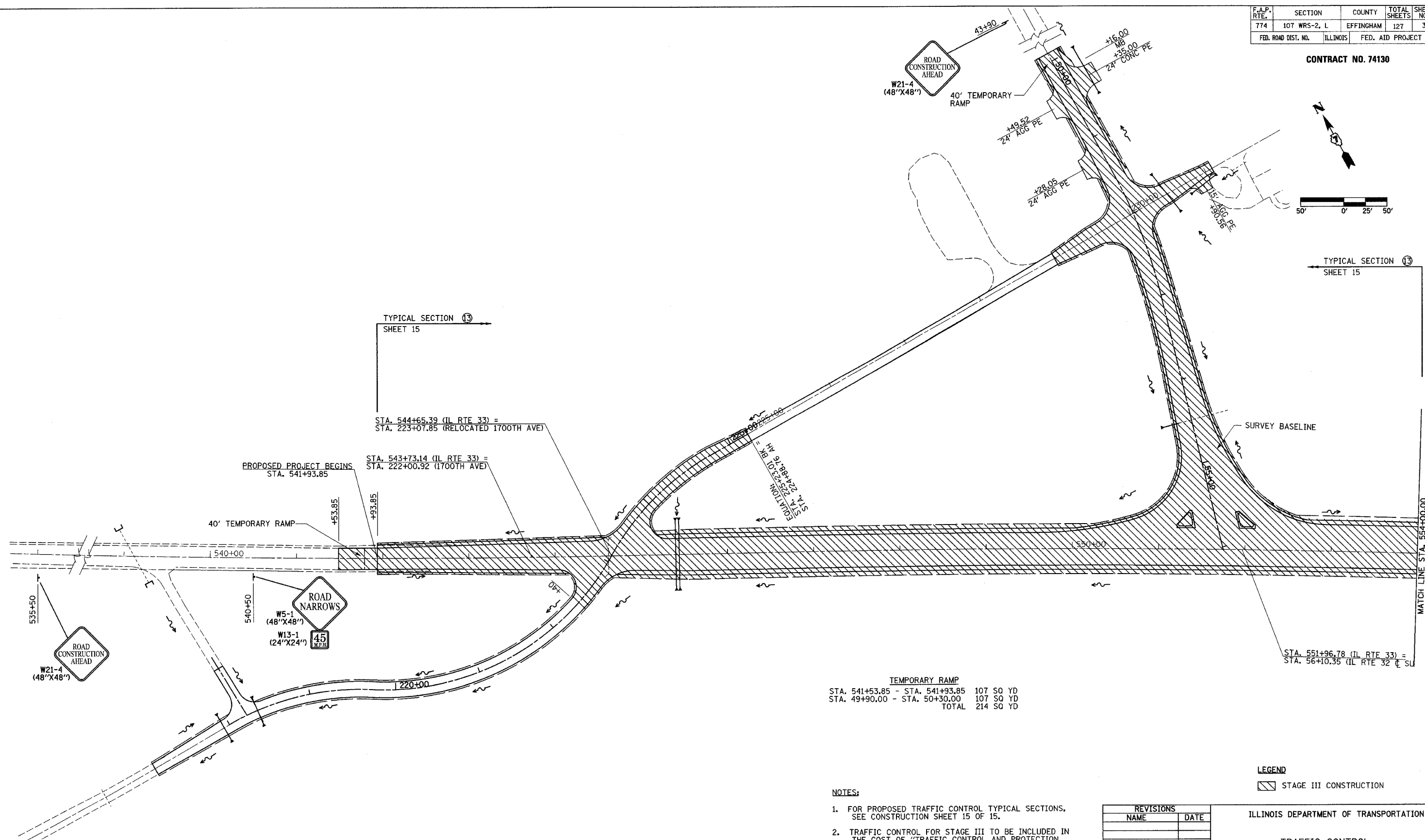

- NOTES:**
- FOR PROPOSED TRAFFIC CONTROL TYPICAL SECTIONS, SEE CONSTRUCTION SHEET 15 OF 15.
  - TRAFFIC CONTROL FOR STAGE III TO BE INCLUDED IN THE COST OF "TRAFFIC CONTROL AND PROTECTION (SPECIAL) LOCATION 3", EXCEPT THE FOLLOWING:  
- ALL TEMPORARY PAVEMENT MARKINGS  
- TEMPORARY RAMPS
  - TRAFFIC CONTROL FOR STAGE III SHALL USE SHORT TERM PAVEMENT MARKING AND WORK ZONE PAVEMENT MARKING REMOVAL ON ALL LANES.

REVISIONS	
NAME	DATE

**LEGEND**  
 STAGE III CONSTRUCTION

ILLINOIS DEPARTMENT OF TRANSPORTATION

TRAFFIC CONTROL  
STAGE III CONSTRUCTION  
SHEET 11 OF 15

DATE 8/02

DRAWN BY ASB  
CHECKED BY ROW