

F.A.P. RTE.	SECTION	COUNTY	TOTAL SHEETS	SHEET NO.
774	107 WRS-2, L	EFFINGHAM	127	59
FED. ROAD DIST. NO.	ILLINOIS	FED. AID PROJECT		

CONTRACT NO. 74130

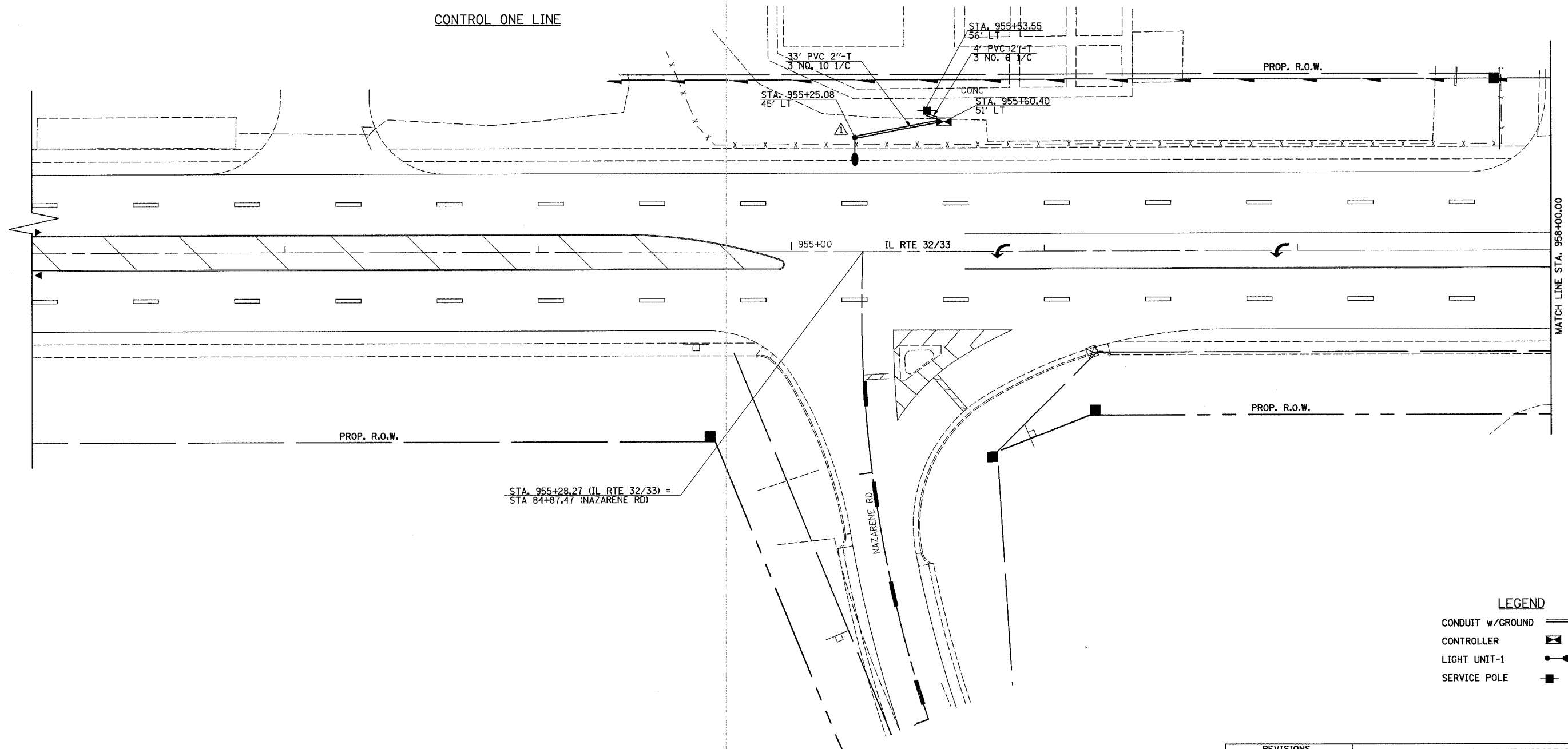
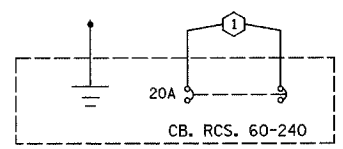
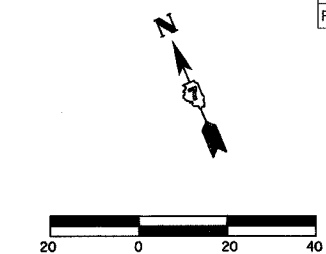

CONTROL ONE LINE

955+00 IL RTE 32/33

MATCH LINE STA. 958+00.00

PROP. R.O.W.

PROP. R.O.W.

STA. 955+28.27 (IL RTE 32/33) =  
STA. 84+87.47 (NAZARENE RD)

NAZARENE RD

LEGEND

- CONDUIT w/GROUND
- CONTROLLER
- LIGHT UNIT-1
- SERVICE POLE

LIGHT/CABLE LAYOUT

REVISIONS	
NAME	DATE

ILLINOIS DEPARTMENT OF TRANSPORTATION

NAZARENE ROAD  
LIGHTING PLANS  
SHEET 5 OF 6

DATE 8/02  
DRAWN BY ASB  
CHECKED BY BWD