

STATE OF ILLINOIS
DEPARTMENT OF TRANSPORTATION

ROUTE NO.	SECTION	COUNTY	SHEET	SHEET	SHEET NO. 2 8 SHEETS
FAP 774	107B-2	EFFINGHAM	27	21	
FED. ROAD DIST. NO. 7	ILLINOIS	FED. AID PROJECT-			

CONTRACT NO. 74131

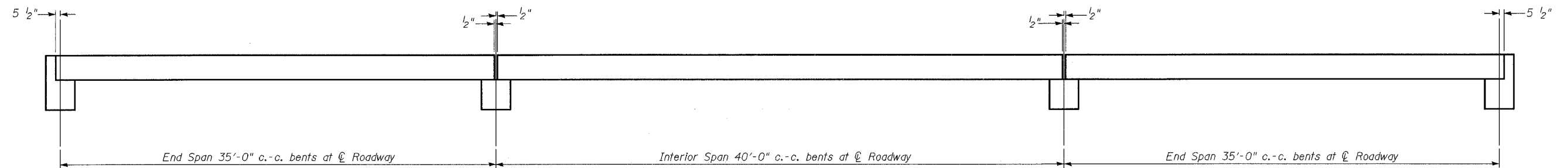

TYPICAL ELEVATION

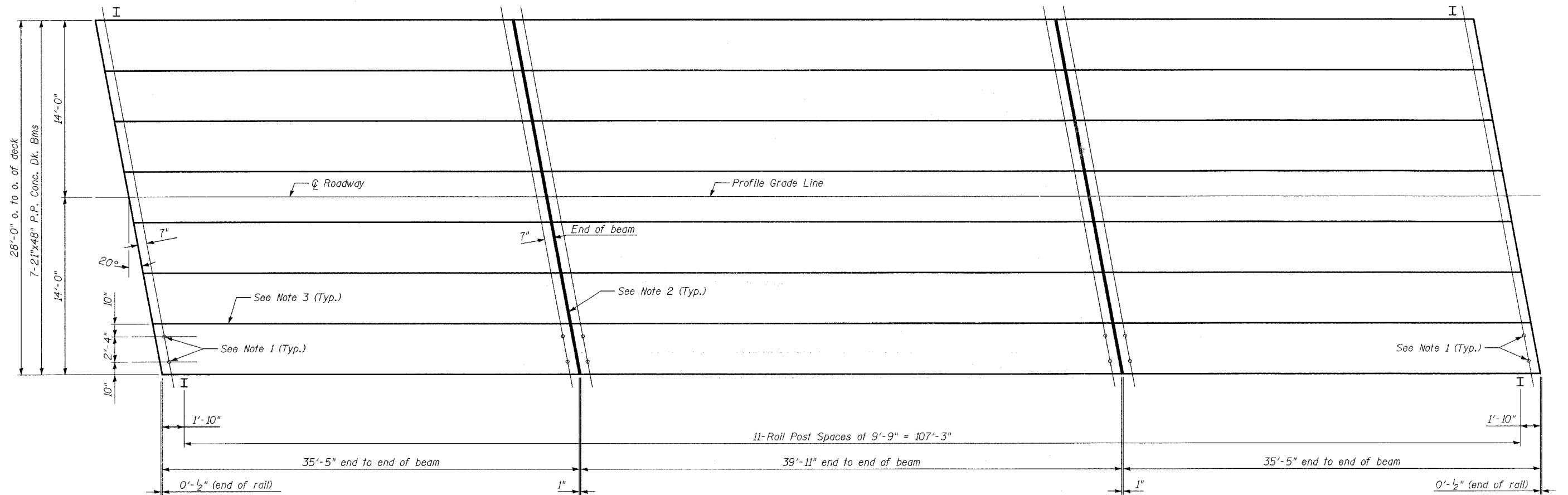

PLAN N

NOTES

1. After beams have been erected, holes shall be drilled into substructure and anchor dowels placed. Dowel holes shall be filled with non-shrink grout to top of beam and allowed to cure min. 24 hrs. prior to grouting to shear keys.
2. Nominal 1" joint at \odot pier to be filled with P.C. mortar mixture. Non-shrink grout may be used at contractor's option.
3. Longitudinal keys shall be grouted.

DESIGNED	TMM
CHECKED	KCM
DRAWN	CAR
CHECKED	TMM

P.P.C. DECK BEAM SUPERSTRUCTURE
1200th STREET OVER GREEN CREEK
FAP RTE. 774, SECTION 107B-2
EFFINGHAM COUNTY
STATION 204+33.91
S.N. 025-3309