

F.A.I. RTE.	SECTION	COUNTY	TOTAL SHEETS	SHEET NO.
64	82-BRS-1	ST. CLAIR	39	13
STA. 1050+00		TO STA. 1065+00		
FED. ROAD DIST. NO.		ILLINOIS FED. AID PROJECT		

EXIST. CURVE CURVE
 PI STA. = 158+05.00
 $\Delta = 18^\circ 19' 08''$ (RT)
 $D = 1^\circ 00' 00''$
 $R = 5,729.58'$
 $T = 923.83'$
 $L = 1,831.89'$
 $E = 74.00'$
 $e = \text{-----}$
 $T.R. = \text{-----}$
 $S.E. RUN = \text{-----}$
 $P.C. STA. = 148+81.17$
 $P.T. STA. = 167+13.06$

PLAN	SURVEYED	BY	DATE
NOTE BOOK NO.	GRADES CHECKED		
	ALIGNMENT CHECKED		
	ADD. FILE NAME		

PROFILE	SURVEYED	BY	DATE
NOTE BOOK NO.	GRADES CHECKED		
	ALIGNMENT CHECKED		
	ADD. FILE NAME		

PLOT DATE = 3/28/2006
 FILE NAME = c:\pws\meta\ad\8405\plan\plan10405.dgn
 SCALE = 1" = 50'
 REFERENCE = REF9

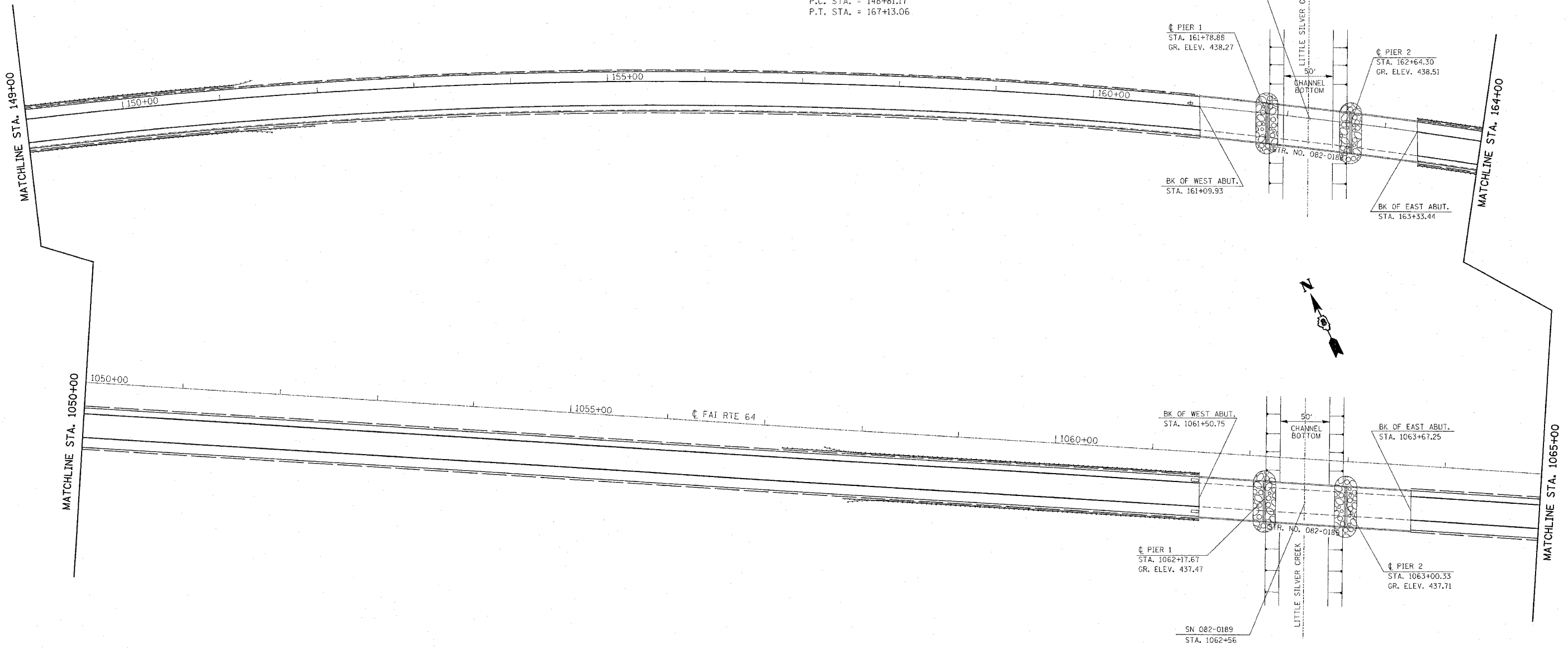

REVISIONS	
NAME	DATE

ILLINOIS DEPARTMENT OF TRANSPORTATION
PLAN SHEET
 FAI ROUTE 64
 SECTION 82-BRS-1
 ST. CLAIR COUNTY
 DRAWN BY: