

TR	SECTION	COUNTY	TOTAL SHEETS	SHEET NO.
336A	31BR	MADISON	11	5
STA.	N/A	TO STA.	N/A	
FED. ROAD DIST. NO. 8 ILLINOIS FED. AID PROJECT				

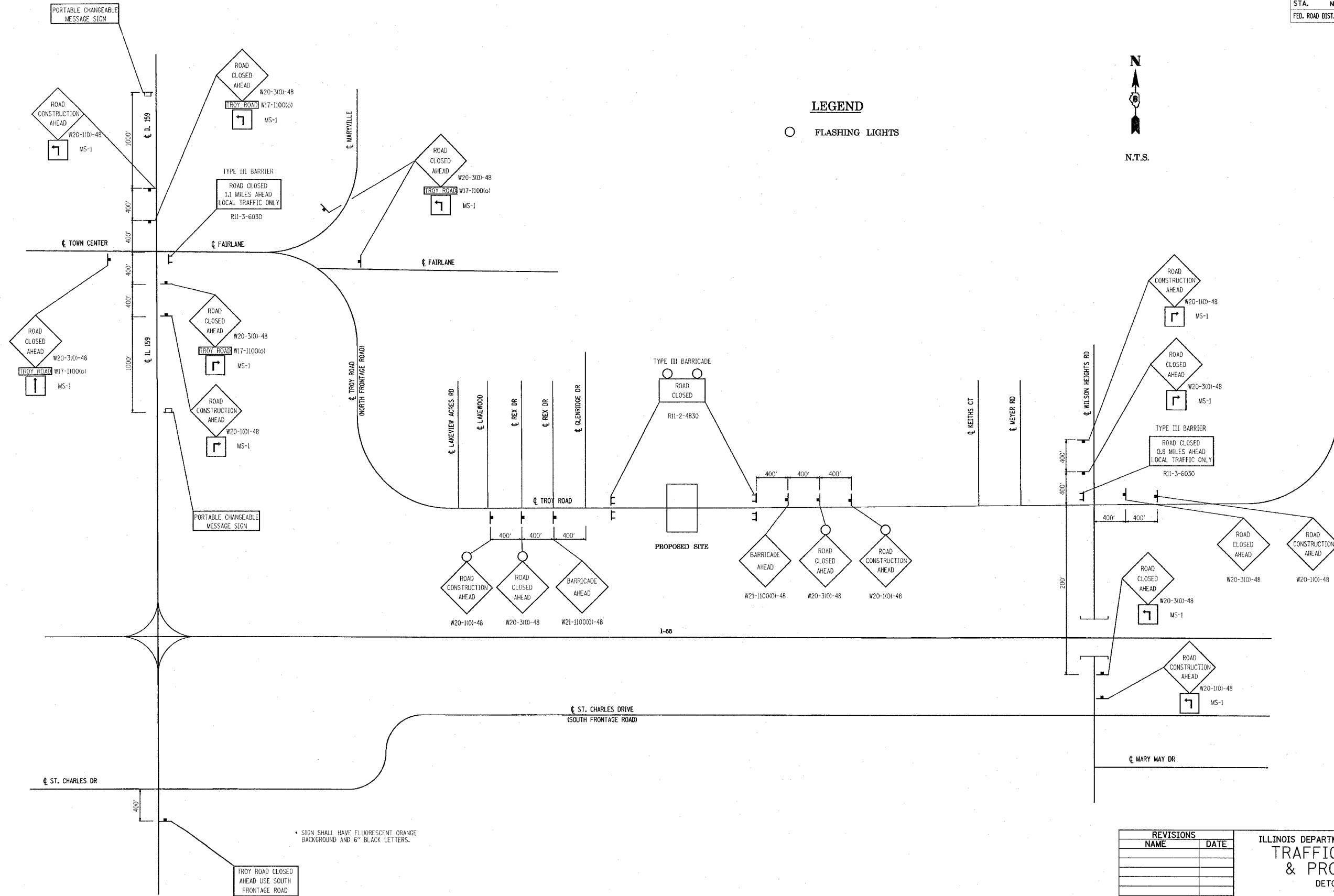

**LEGEND**

○ FLASHING LIGHTS



\* SIGN SHALL HAVE FLUORESCENT ORANGE BACKGROUND AND 6" BLACK LETTERS.

TROY ROAD CLOSED AHEAD USE SOUTH FRONTAGE ROAD

REVISIONS	
NAME	DATE

ILLINOIS DEPARTMENT OF TRANSPORTATION  
**TRAFFIC CONTROL & PROTECTION**  
 DETOUR SIGNING  
 TR 336A  
 SECTION 31BR  
 MADISON COUNTY

DATE \_\_\_\_\_ DRAWN BY \_\_\_\_\_ CHECKED BY \_\_\_\_\_