

F.A.P. RTE.	SECTION	COUNTY	TOTAL SHEETS	SHEET NO.
310	*	MADISON	452	121
STA. 34+300.000		TO STA. 35+000.000		
FED. ROAD DIST. NO.		ILLINOIS FED. AID PROJECT		

SECTION 60-14
SECTION 60-14-1B

SEDIMENT BASIN

INLET & PIPE PROTECTION

PROPOSED 0.9m X 0.6m REINFORCED CONCRETE BOX CULVERT BY OTHERS SECTION 60-14-1

PROPOSED SEMINARY ROAD

PROPOSED PIPE CULVERT, 600mm BY OTHERS SECTION 60-14-1

PROPOSED 1.8m X 1.2m REINFORCED CONCRETE BOX CULVERT (BY OTHERS)

PROPOSED PIPE CULVERT, 600mm (BY OTHERS)

INLET & PIPE PROTECTION

TEMPORARY DITCH CHECK

PROPOSED PIPE CULVERT, 600mm

PROPOSED PIPE CULVERT, 600mm

PROPOSED PIPE CULVERT, 600mm

PROPOSED PIPE CULVERT, 600mm

PROPOSED PIPE CULVERT, 600mm

PROPOSED PIPE CULVERT, 600mm

PROPOSED PIPE CULVERT, 600mm

PROPOSED PIPE CULVERT, 600mm

PROPOSED PIPE CULVERT, 600mm

PROPOSED PIPE CULVERT, 600mm

PROPOSED PIPE CULVERT, 600mm

PROPOSED PIPE CULVERT, 600mm

PROPOSED PIPE CULVERT, 600mm

PROPOSED PIPE CULVERT, 600mm

PROPOSED PIPE CULVERT, 600mm

PROPOSED PIPE CULVERT, 600mm

PROPOSED PIPE CULVERT, 600mm

PROPOSED PIPE CULVERT, 600mm

PROPOSED PIPE CULVERT, 600mm

PROPOSED PIPE CULVERT, 600mm

PROPOSED PIPE CULVERT, 600mm

PROPOSED PIPE CULVERT, 600mm

PROPOSED PIPE CULVERT, 600mm

PROPOSED PIPE CULVERT, 600mm

PROPOSED PIPE CULVERT, 600mm

PROPOSED PIPE CULVERT, 600mm

PROPOSED PIPE CULVERT, 600mm

PROPOSED PIPE CULVERT, 600mm

PROPOSED PIPE CULVERT, 600mm

PROPOSED PIPE CULVERT, 600mm

PROPOSED PIPE CULVERT, 600mm

PROPOSED PIPE CULVERT, 600mm

PROPOSED PIPE CULVERT, 600mm

PROPOSED PIPE CULVERT, 600mm

PROPOSED PIPE CULVERT, 600mm

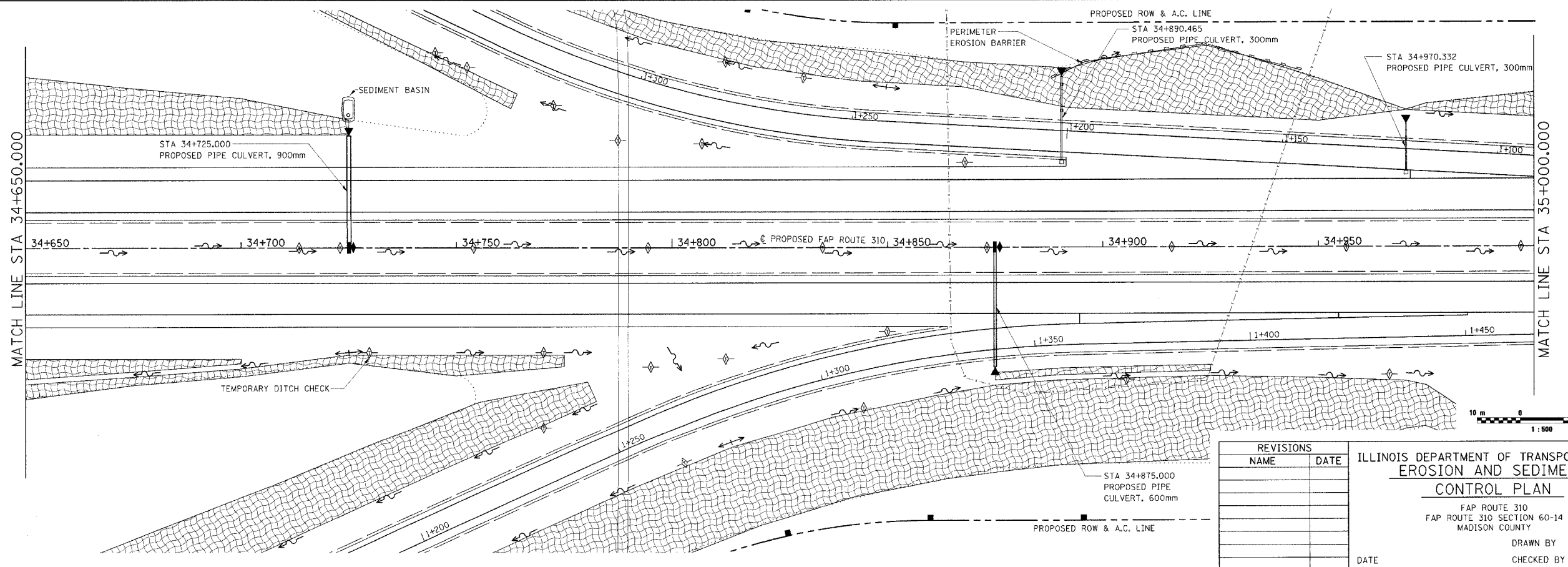
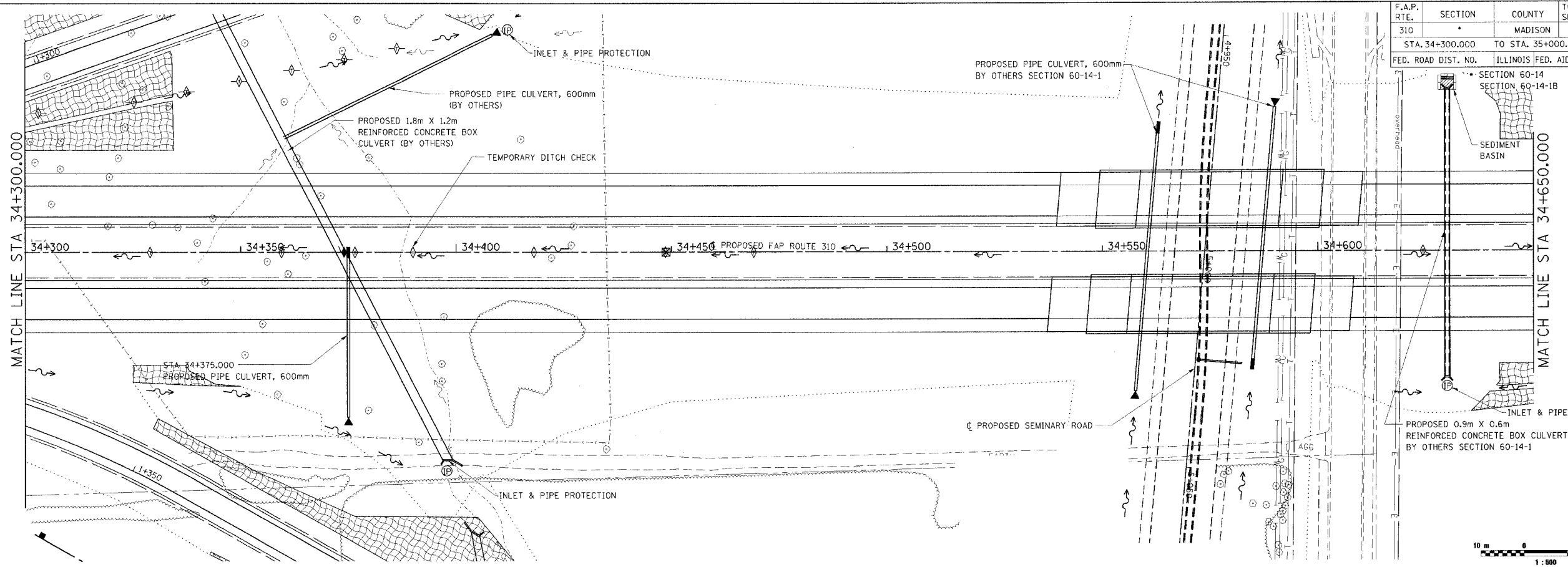

REVISIONS	
NAME	DATE

ILLINOIS DEPARTMENT OF TRANSPORTATION
EROSION AND SEDIMENT CONTROL PLAN
FAP ROUTE 310
FAP ROUTE 310 SECTION 60-14
MADISON COUNTY
DRAWN BY BANDY
CHECKED BY STEUART
DATE

EROSION AND SEDIMENT CONTROL PLAN, FAP ROUTE 310, STA. 34+300.000 TO STA. 35+000.000

I:\Projects\2006\06-17-2006\11-25-05.dwg
 06/17/2006 11:25:05 AM