

F.A.P. RTE.	SECTION	COUNTY	TOTAL SHEETS NO.
310		MADISON	452 170
STA. 31+350.000		TO STA. 31+500.000	
FED. ROAD DIST. NO.		ILLINOIS FED. AID PROJECT	
		SECTION 60-14	
		SECTION 60-14-1B	

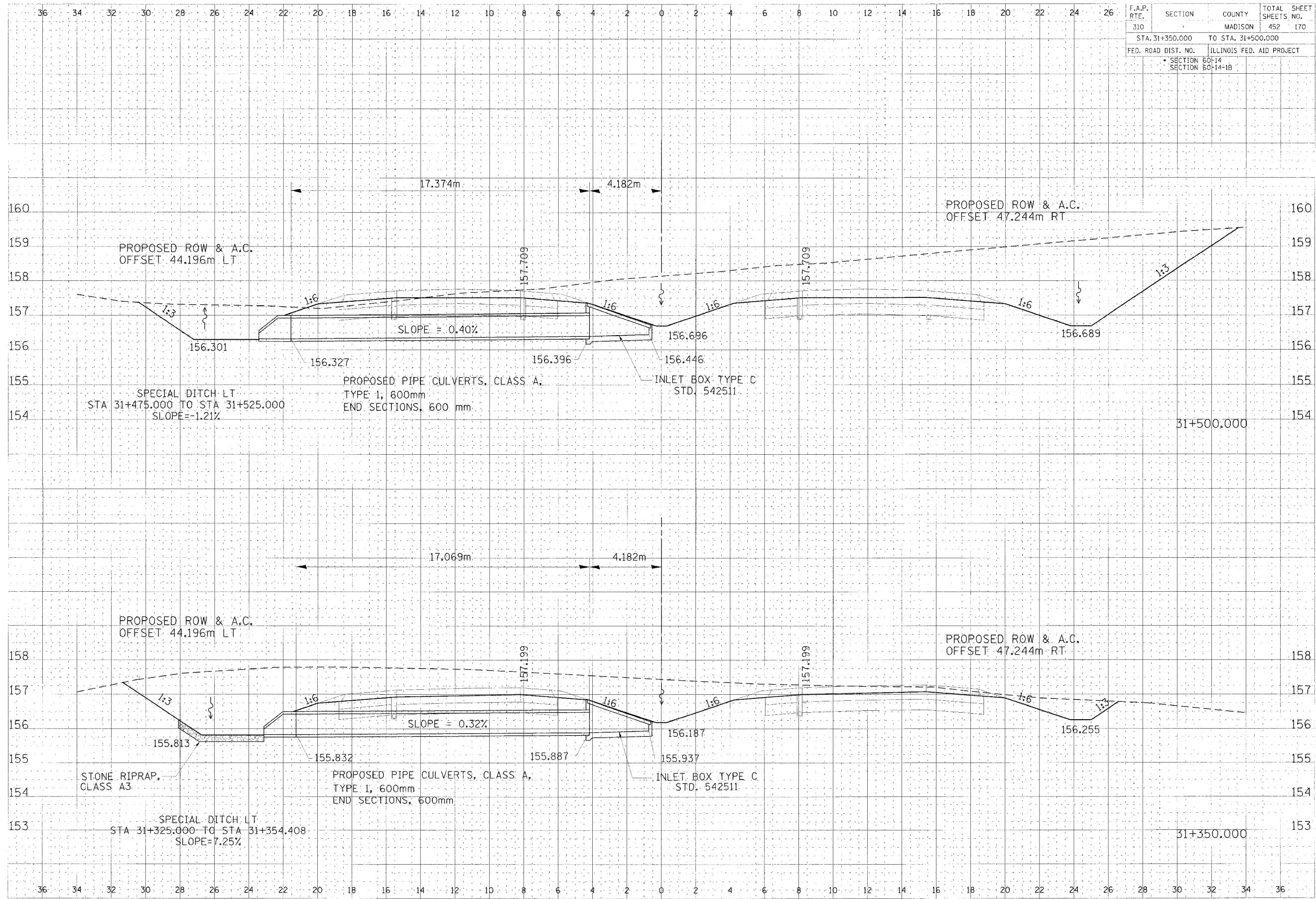

DATE	
BY	
CHKD	
APP'D	
DATE	
BY	
CHKD	
APP'D	
DATE	
BY	
CHKD	
APP'D	

DATE	
BY	
CHKD	
APP'D	
DATE	
BY	
CHKD	
APP'D	
DATE	
BY	
CHKD	
APP'D	

CULVERT PROFILE, FAP ROUTE 310, STA 31+350.000 TO STA. 31+500.000

D:\Projects\310\310.dwg 11/25/08 11:25:07 AM