

F.A.P. RTE.	SECTION	COUNTY	TOTAL SHEETS	SHEET NO.
310	*	MADISON	452	241
STA. 31+281.641		TO STA.		
FED. ROAD DIST. NO.		ILLINOIS FED. AID PROJECT		
* SECTION 60-14				
SECTION 60-14-1B				

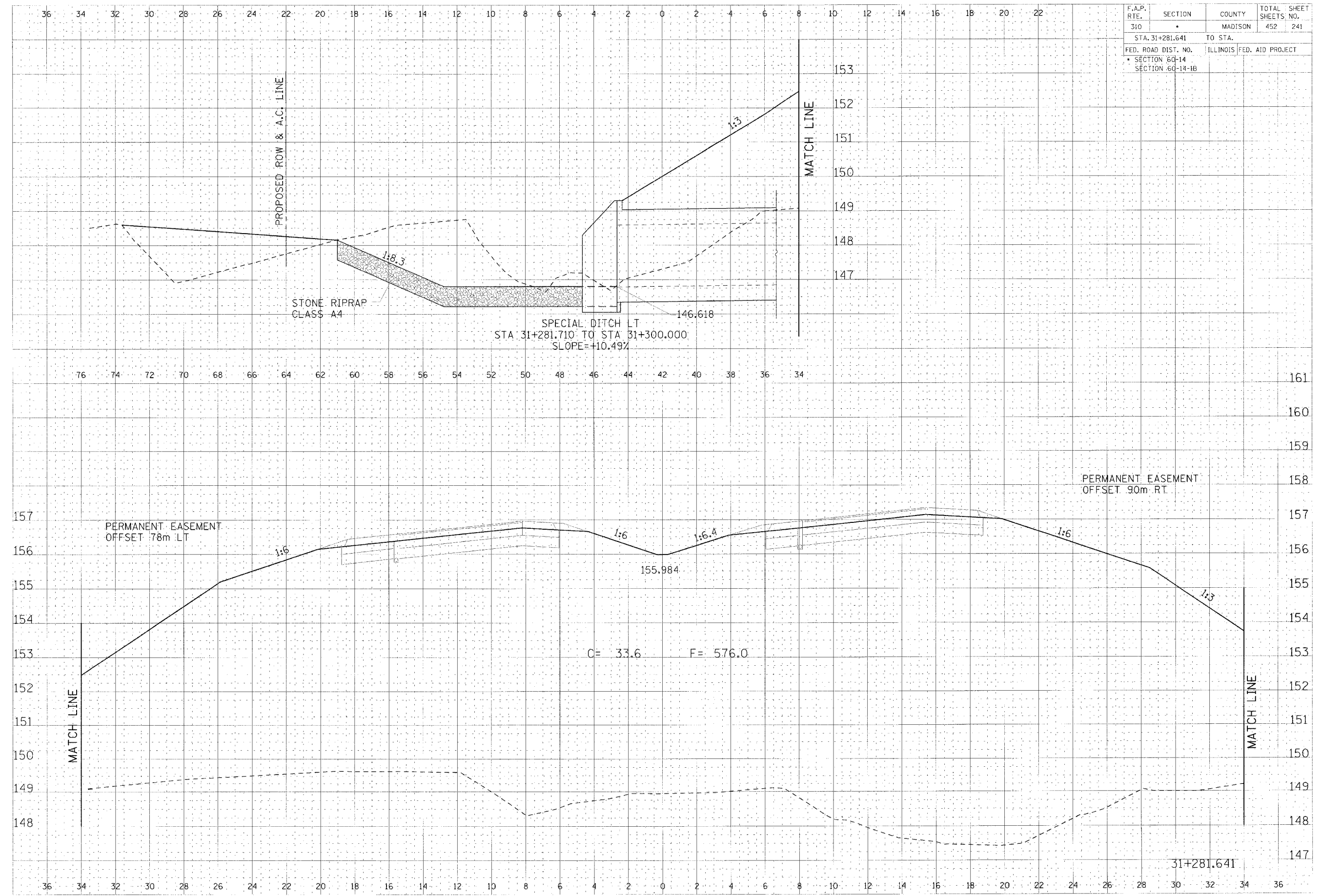

FINAL  
 DATE: 11/15/05  
 DRAWN BY: J. B. BOYD  
 CHECKED BY: J. B. BOYD

ORIGINAL  
 DATE: 11/15/05  
 DRAWN BY: J. B. BOYD  
 CHECKED BY: J. B. BOYD

CROSS SECTION, FAP ROUTE 310, STA 31+281.641