

F.A.P. RTE.	SECTION	COUNTY	TOTAL SHEETS	SHEET NO.
103	27-3BR	ST. CLAIR	22	9
STA. 85+32 TO STA. 86+08				
FED. ROAD DIST. NO. ILLINOIS FED. AID PROJECT				
CONTRACT NO. 76411				

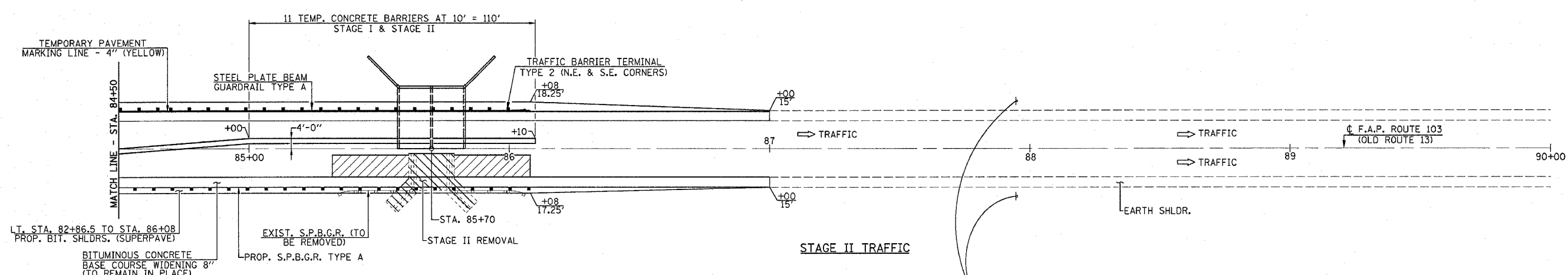
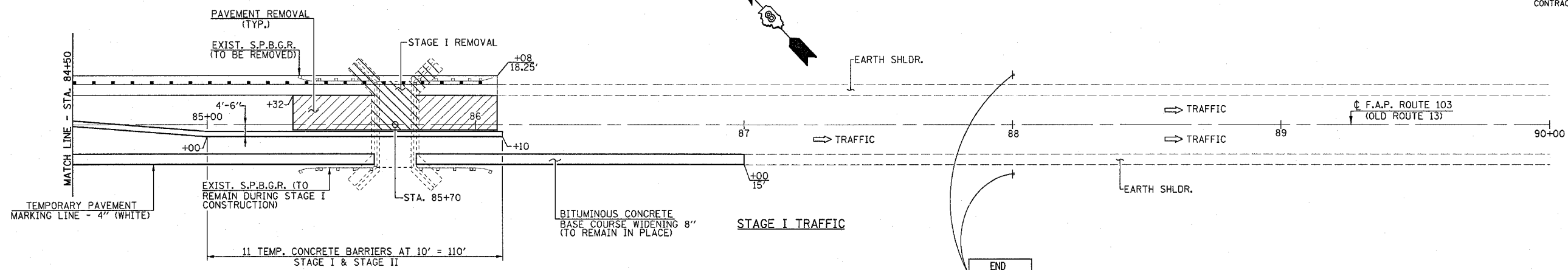

TRAFFIC CONTROL SCHEDULE

LOCATION STATION TO STATION	TEMP. CONC. BARRIER (FOOT)	RELOCATE TEMP. CONC. BARRIER (FOOT)	IMPACT ATTENUATORS (EACH)	RELOCATE IMPACT ATTENUATOR (EACH)
STAGE I				
STA. 83+85.4 TO STA. 84+00.4			2	
STA. 84+00.4 TO STA. 86+10	210			
STAGE II				
STA. 83+85.4 TO STA. 84+00.4				2
STA. 84+00.4 TO STA. 86+10		210		
TOTAL	210	210	2	2

SCHEDULE TEMPORARY PAVEMENT MARKING

LOCATION STATION TO STATION	TEMP. PAV'T. MARKING LINE - 4\"/>
STAGE I	
STA. 82+86.5 TO STA. 87+00 RT.	414
STAGE II	
STA. 82+86.5 TO STA. 87+00 LT.	414
TOTAL	828

SYMBOLS

- ↑ ARROW BOARD
- ▨ WORK AREA
- ⊙ DRUM WITH STEADY BURNING LIGHT
- ◇ TYPE C BIDIRECTIONAL REFLECTOR
- ▬ TEMPORARY CONCRETE BARRIER
- ▬ IMPACT ATTENUATOR
- ⊙ DIRECTIONAL INDICATOR BARRICADE WITH STEADY BURNING LIGHT
- ⊥ SIGN
- WHITE BI-DIRECTIONAL TEMPORARY PAVEMENT MARKER
- ⊥ TYPE III BARRICADE

FOR GENERAL NOTES SEE SHEET 8 OF 22 SHEETS.  
WORK THIS SHEET WITH SHEETS 7 & 8 OF 22 SHEETS.

STAGE CONSTRUCTION TRAFFIC DETAILS  
F.A.P. ROUTE 103 (OLD IL. ROUTE 13)  
OVER TRIBUTARY OF RICHLAND CREEK  
SECTION 27-3BR  
ST. CLAIR COUNTY  
STA. 85+70.00  
S.N. 082-2042



FILE NAME: SHT009 REV. 10/11/05