

| F.A.P. RTE. | SECTION | COUNTY | TOTAL SHEETS | SHEET NO. |
|---|---------|-----------|--------------|-----------|
| 103 | 27-3BR | ST. CLAIR | 22 | 13 |
| STA. 85+32 TO STA. 86+08 | | | | |
| FED. ROAD DIST. NO. ILLINOIS FED. AID PROJECT | | | | |
| CONTRACT NO. 76411 | | | | |

| DATE | BY |
|------|----|
| | |
| | |

| DATE | BY |
|------|----|
| | |
| | |

PLOT DATE: 3/22/2006
 FILE NAME: c:\p\proj\27-3br\13.dwg
 REFERENCE: #REF#

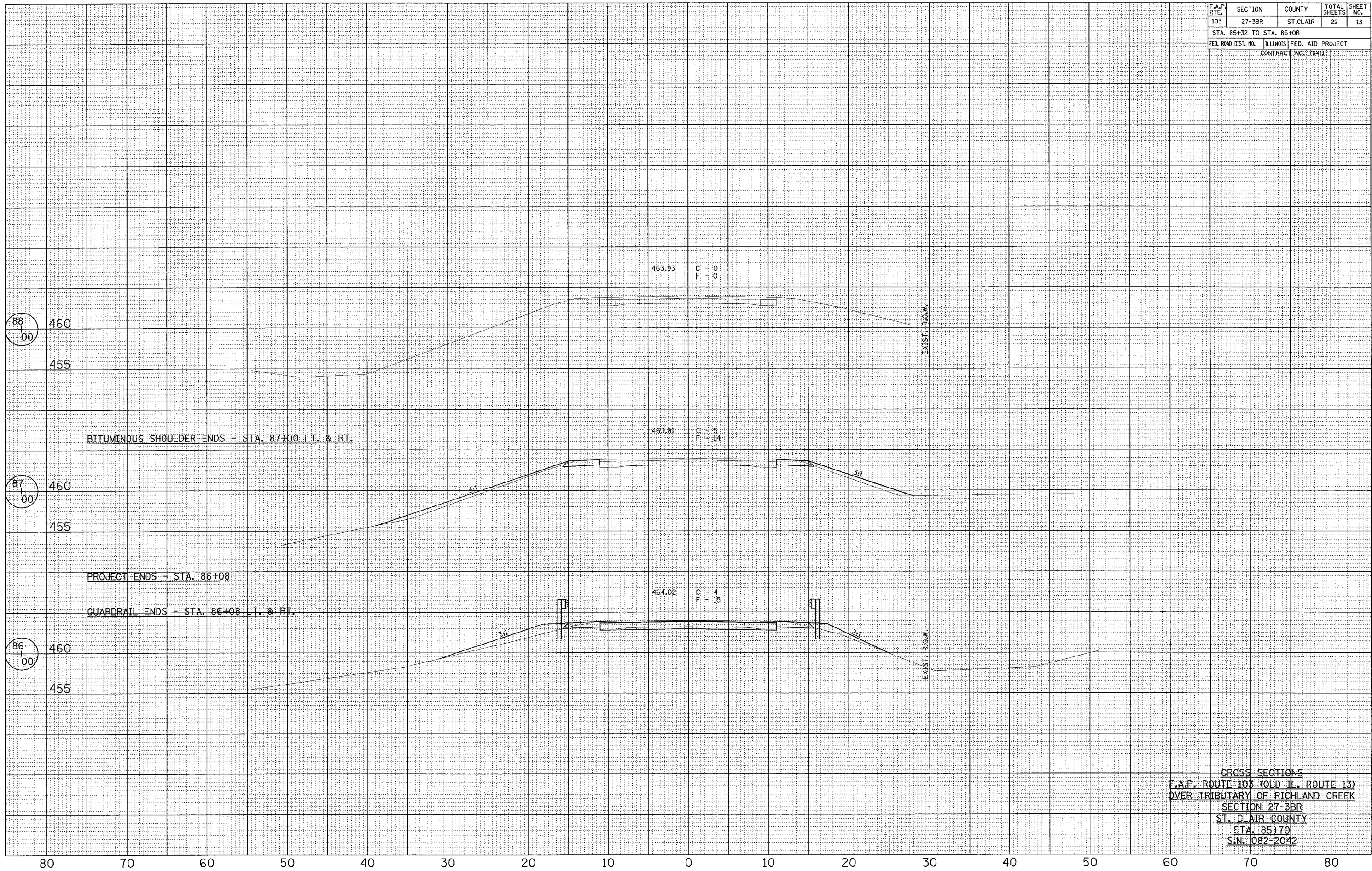

CROSS SECTIONS
 F.A.P. ROUTE 103 (OLD IL. ROUTE 13)
 OVER TRIBUTARY OF RICHLAND CREEK
 SECTION 27-3BR
 ST. CLAIR COUNTY
 STA. 85+70
 S.N. 082-2042