

**GENERAL NOTES - ALL STAGES**

- EMERGENCY VEHICLE ACCESS SHALL BE MAINTAINED AT ALL TIMES WITHIN THE CONSTRUCTION WORK ZONE.
- THE CONTRACTOR SHALL PROVIDE A WRITTEN "SEQUENCE OF CONSTRUCTION" PLAN WITHIN 10 DAYS OF THE CONTRACT AWARD. THE PLAN SHALL PROVIDE IN DETAIL HOW THE PROPOSED UNDERGROUND UTILITIES WILL BE CONSTRUCTED WHILE MAINTAINING EXISTING STORM, SANITARY, AND WATER SERVICE. THE PLAN MUST BE APPROVED BY THE ENGINEER PRIOR TO CONSTRUCTION. THIS WORK SHALL BE INCIDENTAL TO CONSTRUCTION.
- THE SUGGESTED SEQUENCE OF CONSTRUCTION FOR INTERSECTION RECONSTRUCTION'S INTENT IS TO COMPLETE STAGE III WITH MINIMAL LOSS OF ACCESS TO LOCAL BUSINESSES AND RESIDENCES, AND TO ASSURE THAT NO TWO-WAY CLOSURES ARE IN PLACE DURING WINTER SHUTDOWN SEASON IN COMPLIANCE WITH THE PROSECUTION AND PROGRESS SPECIAL PROVISION OF THE CONTRACT. TWO-WAY TRAFFIC IS TO BE OPENED AND MAINTAINED AT ALL TIMES UPON COMPLETION OF STAGE III. ALL WORK NECESSARY TO COMPLY WITH THE INTENT OF THE PLAN IS CONSIDERED INCIDENTAL TO THE ITEM OF TRAFFIC CONTROL AND PROTECTION. THE CONTRACTOR SHALL COMPLY WITH ARTICLE 442.04 OF THE STANDARD SPECIFICATIONS, AND WORK TO BE IN ACCORDANCE WITH APPLICABLE STANDARDS.
- FURNISHING, PLACEMENT, RELOCATION, AND REMOVAL OF ALL TRAFFIC SIGNS SHALL BE INCLUDED IN THE COST OF TRAFFIC CONTROL AND PROTECTION. ALL CONFLICTING SIGNS SHALL BE COVERED AS DIRECTED BY THE ENGINEER, AND SHALL BE INCIDENTAL TO TRAFFIC CONTROL AND PROTECTION.
- THE CONTRACTOR SHALL MAINTAIN A MINIMUM OF 11' CLEAR ROADWAY PER DIRECTION OF TRAFFIC FLOW. INGRESS AND EGRESS TO DRIVEWAYS AND SIDE STREETS SHALL BE MAINTAINED AT ALL TIMES. THIS WORK SHALL BE INCIDENTAL TO TRAFFIC CONTROL AND PROTECTION.
- ANY NECESSARY SHORT TERM ACTIVITY WHICH REQUIRES ENCROACHMENT INTO THE LANE(S) OPEN TO TRAFFIC SHALL BE RESTRICTED TO THE HOURS FROM 9:00 AM TO 3:00 PM. THESE CLOSURES SHALL BE IN ACCORDANCE WITH THE APPLICABLE STANDARDS.
- THE MAINTENANCE OF THE SHOULDERS AND DRAINAGE FACILITIES SHALL BE CONSIDERED INCIDENTAL TO EARTH EXCAVATION.
- TYPE B FLASHING LIGHTS CONFORMING TO THE "MANUAL ON UNIFORM TRAFFIC CONTROL DEVICES", LATEST EDITION, SHALL BE PLACED ON EACH TYPE III BARRICADE.
- ADDITIONAL SIGNS, BARRICADES, DELINEATORS, PAVEMENT MARKINGS, OR OTHER TRAFFIC CONTROL AND PROTECTION ITEMS TO BE PLACED PER APPLICABLE STANDARDS AND AS DIRECTED BY THE ENGINEER.
- BARRICADE SPACINGS SHALL BE 50' C-C ON TANGENTS, 25' C-C ON ALL TAPERS/SHIFTS, AND 12' C-C ON RADII.
- CONTRACTOR TO PROVIDE TEMPORARY ACCESS FROM JUSTAMERE ROAD TO GIBBONS GARDEN RESTAURANT AND THE COOK COUNTY FOREST PRESERVE AT ALL TIMES.

**SUGGESTED SEQUENCE OF CONSTRUCTION FOR INTERSECTION RECONSTRUCTION- STAGE I-PHASE 1**

- PROVIDE TRAFFIC CONTROL AND PROTECTION. CONSTRUCTION OPERATIONS INVOLVING THE TEMPORARY CLOSING OF ROADS SHALL NOT BEGIN WITHOUT AT LEAST THREE DAYS PRIOR NOTICE TO THE CITY BY THE CONTRACTOR.
- PROVIDE ALL NECESSARY EROSION CONTROL.
- CONSTRUCT FULL DEPTH BITUMINOUS SHOULDER AND PAVEMENT WIDENING ON NORTHBOUND OAK PARK AVENUE AND EASTBOUND 147TH STREET BETWEEN STATIONS 99+00 AND 102+00 AS SHOWN ON CONSTRUCTION PLANS.
- PROVIDE TEMPORARY PAVEMENT MARKING FOR NORTHBOUND OAK PARK AVENUE AND EASTBOUND 147TH STREET.

**SUGGESTED SEQUENCE OF CONSTRUCTION FOR INTERSECTION RECONSTRUCTION- STAGE I-PHASE 2**

- PROVIDE TRAFFIC CONTROL AND PROTECTION. INSURE THAT THE DETOUR ROUTES ARE CLEARLY MARKED BEFORE CLOSING JUSTAMERE ROAD, SOUTHBOUND OAK PARK AVENUE, AND EASTBOUND 147TH STREET.
- PROVIDE ALL NECESSARY EROSION CONTROL.
- REMOVE EXISTING PAVEMENT FROM INTERSECTION BETWEEN STATIONS 99+00 AND 102+00 AS INDICATED IN PLANS.
- REDIRECT NORTHBOUND OAK PARK AVENUE TO SOUTHBOUND LANE OVER CULVERT. CONSTRUCT EAST SIDE OF CULVERT EXTENSION INCLUDING ROADWAY REPAIR AND SHOULDER.
- CONSTRUCT SIGNAL INFRASTRUCTURE, FOUNDATIONS, AND POSTS.

**SUGGESTED SEQUENCE OF CONSTRUCTION FOR INTERSECTION RECONSTRUCTION- STAGE I-PHASE 3**

- CONSTRUCT AGGREGATE SUBBASE, COMBINATION CONCRETE CURB AND GUTTER, BITUMINOUS BASE COURSE, AND BITUMINOUS CONCRETE BINDER COURSE FOR RECONSTRUCTION AREA.
- CONSTRUCT WEST EXTENSION OF BOX CULVERT.
- REMOVE OR RELOCATE (AS NECESSARY) THE TRAFFIC CONTROL AND PROTECTION AND DETOUR ROUTES, OPENING RECONSTRUCTED BINDER TO TRAFFIC.
- INSTALL TEMPORARY PAVEMENT MARKINGS.
- OPEN ROADS TO TRAFFIC.

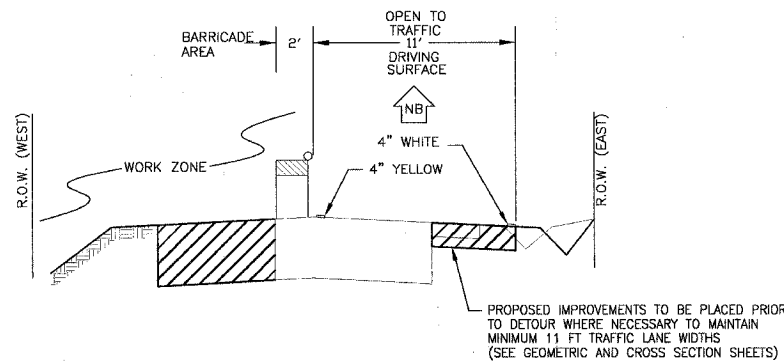

**DETOUR SIGN DETAILS**

(SEE LOCAL DETOUR PLAN FOR LOCATION)

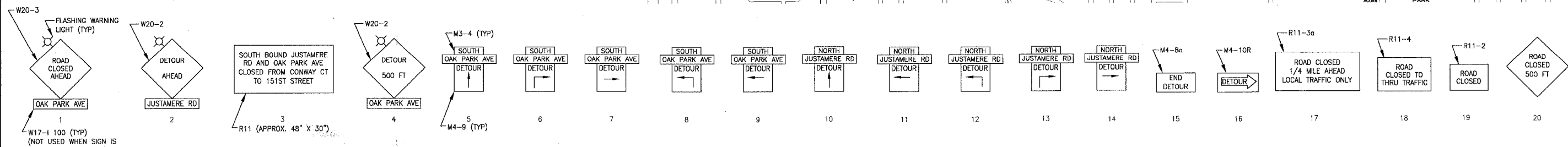

**LOCAL DETOUR PLAN LEGEND**

- Sign symbol: TYPE III BARRICADE(S) WITH 18 UNLESS OTHERWISE NOTED
- Sign symbol: ADDITIONAL M3-4 "JUSTAMERE RD" SIGN ADDED BELOW "OAK PARK AVE"
- \*\* WILL BE USED IN PHASES 1 & 2 ONLY.
- \* NO NAME PLATE NECESSARY.

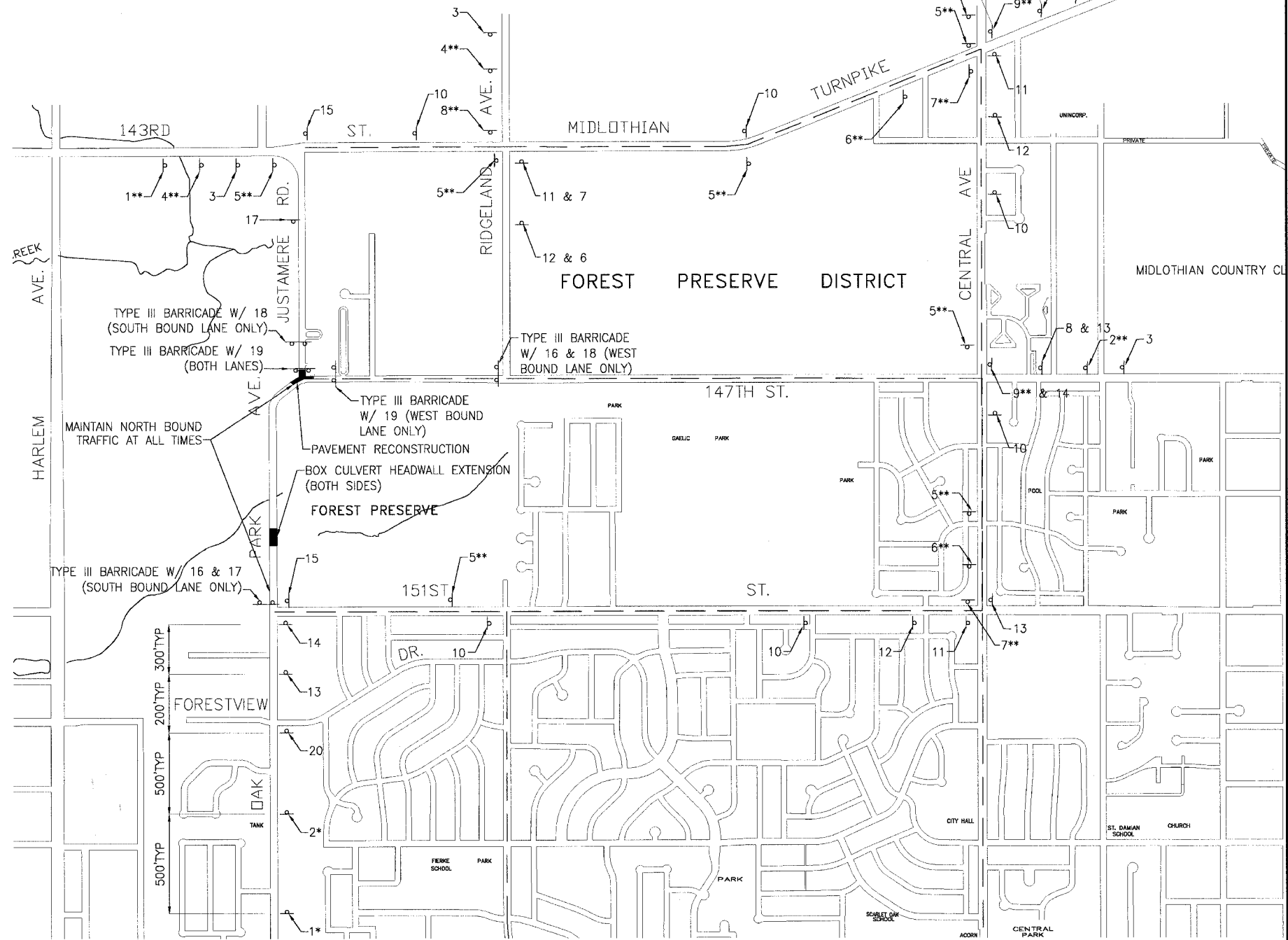
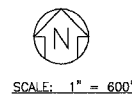

F.A.L. ROUTE NO.	SECTION	COUNTY	TOTAL SHEETS	SHEET NO.
2774	99-00073-00-WR	COOK	116	21
STA.	TO STA.			
FED. ROAD DIST. NO. 1	ILLINOIS	FED AID PROJECT		CMM-7003 (750)

CONTRACT NO. 83727

I:\OAKFT\020146\DWGS\20146-DETOUR-M3.dwg  
 Plotted: 5-08-06 @ 3:00pm By: 354jip  
 Copyright ©2004, By Baxter & Woodman, Inc.  
 State of Illinois - Professional Design Firm  
 License No. - 184-001121 - Expires 4-30-05

CONSULTANTS	REV. NO.	DATE	DESCRIPTION
BAXTER & WOODMAN	1	4-28-06	PER IDOT AND COOK COUNTY COMMENTS
	2	5-8-06	PER IDOT COMMENTS

**BAXTER & WOODMAN**  
 Consulting Engineers

*Baxter & Woodman*  
 Crystal Lake, Illinois 815.459.1860  
 Burlington, Wisconsin 262.763.7834  
 Mokena, Illinois 708.478.5090  
 DeKalb, Illinois 815.787.3111  
 Grayslake, Illinois 847.223.5088  
 Foxford, Illinois 815.489.1551  
 Plainfield, Illinois 815.609.7425

**CITY OF OAK FOREST, ILLINOIS**  
**OAK PARK AVENUE PROJECT**

**MAINTENANCE OF TRAFFIC**  
**TEMPORARY DETOUR**  
**STAGE I**

DESIGNED BY	NJP	SCALE	NONE
DRAWN BY	NJP	PROJECT NO.	020146
CHECKED BY	NJP	SHEET NO.	21 OF 116
DATE	1-20-05		